



## 480 Series Parallel Shaft DC

UP TO 1112 IN-LBS CONTINUOUS

Designed to replace motor-speed reducer combinations, Series 480 parallel shaft gearmotors are more economical and occupy less space.

### Specifications

Gearhead	Motor	Additional Information
Gearing: AGMA class 9 heat treated steel 1st-stage helical, balance spur steel	Motor Type: Permanent magnet Speed: Variable with appropriate control (1.37 form factor max)	
Housing: Precision machined die cast aluminum	Rotation: Reversible	
Lubrication: Lifetime oil bath, sealed and gasketed	Bearings: Ball	
Bearings: Needle and thrust ball, ball bearing outboard	Insulation: Class B	
Shafts: Hardened steel	Enclosures: 1/4 HP TENV 1/2 HP TEFC	
Mounting: Base, any angle		
Finish: Gloss black powder coat		

### 483 Series PMDC 90V

Part Number	Speed 90V RPM	Torque (in-lbs)	Input HP	Gear Ratio	Stages	OHL*	Amps	Shipping Wt.	Brush
011-483-4197	9	1087**	1/4	195.9	3	800	2.00	33.5	E
011-483-4131	14	960**	1/4	130.8	3	797	2.60	33.5	E
011-483-4087	20	727	1/4	86.5	3	667	2.70	33.5	E
011-483-4041	43	353	1/4	41.1	3	716	2.70	33.5	E
011-483-4028	63	238	1/4	27.8	3	636	2.70	33.5	E
011-483-4018	91	152	1/4	19.3	2	571	2.70	33.5	E
011-483-4012	148	101	1/4	11.8	2	491	2.70	33.5	E
011-483-2087	20	1112**	1/2	86.5	3	667	4.2	27.25	E
011-483-2058	34	822	1/2	50.3	3	682	5.0	27.25	E
011-483-2041	40	664	1/2	41.1	3	716	5.0	27.25	E
011-483-2028	60	464	1/2	27.8	3	636	5.0	27.25	E
011-483-2018	90	305	1/2	19.3	2	571	5.0	27.25	E
011-483-2012	144	202	1/2	11.8	2	491	5.0	27.25	E

\* Maximum overhung load on center of output shaft. \*\* Output torque is gear limited.

### 483 1/4 HP

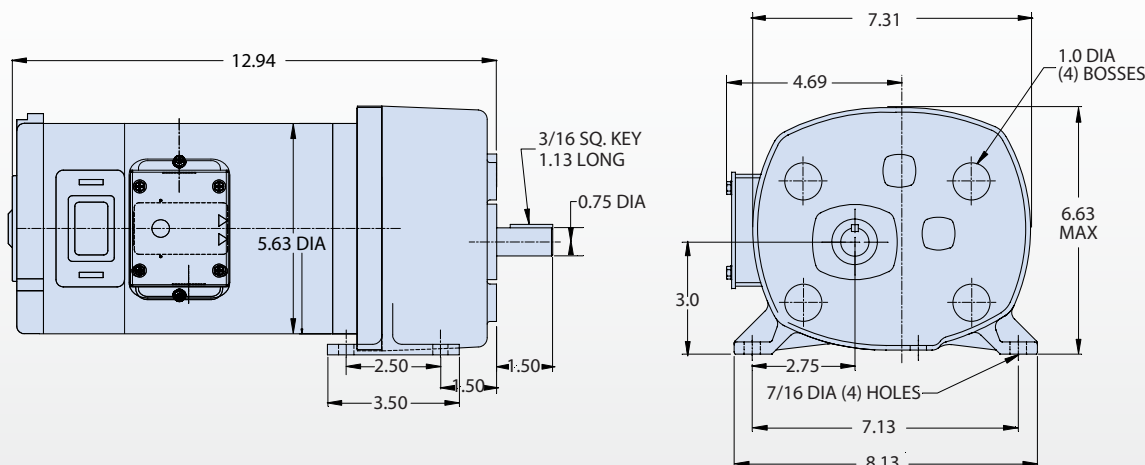

# Make sure it's a Bison.



## All Gearmotors are <sup>NOT</sup> Created Equal.



Just because many gearmotors may appear similar from the outside doesn't mean they're built the same on the inside. Take apart a Bison gearmotor, compare it to any others and you'll see the difference. Take permanent magnet DC brushes for instance. Bison's larger size and stainless steel springs mean longer life. Plus, changing brushes is a snap since they're designed for easy maintenance. It's just one small example of how Bison gearmotors are built to last. Bison's Robusticity™ design philosophy yields gearmotors that are built to be the best from the inside out. From components of the highest quality, to innovative design techniques and quality control measures like testing at full rated load and speed, customers have relied on Bison as the driving force behind their products for half a century.



### 483 1/2 HP

