

## Compression Connectors for Copper Conductor

### One-Hole Lugs — 45° Long Barrel 600V to 35kV

**Material:** High-Conductivity  
Wrought Copper  
**Finish:** Electro Tin Plate



**Peep Holes Available!**  
Add suffix **-PH**

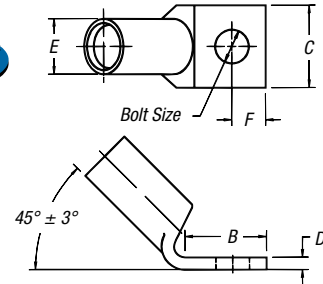

Connectors & Grounding — Blackburn® Compression Connectors Featuring the Color-Keyed® System

CAT. NO.	CODE	WIRE SIZE			DIMENSIONS (IN.)					DIE CODE	DIE COLOR
		FLEX CLASS	G, H, I, K, M <sup>†</sup>	BOLT SIZE	B	C	D	E	F		
54929BEUF	#8 AWG	23 Navy, #8 Flex		#10	.65	.42	.08	.26	¼	21	RED
54930BEUF		37/24 = 14.9 kcmil		¼	.65	.42	.08	.26	¼	21	RED
54904BEUF	#6 AWG	61/24 = 24.6 kcmil		#10	.65	.44	.08	.30	¼	24	BLUE
54905BEUF		#6 Flex, 30 Navy		¼	.65	.44	.08	.30	¼	24	BLUE
54908BEUF	#4 AWG	40-50 Navy, #4 Weld		#10	.65	.52	.10	.37	¼	29	GRAY
54906BEUF		#5, 91/24 = 36.7 kcmil		¼	.65	.52	.10	.37	¼	29	GRAY
54933BEUF	#2-3 AWG	125/24 = 50.4 kcmil		#10	.65	.59	.11	.41	¼	33	BROWN
54942BEUF		60 Navy, #3 Weld		⅝	.88	.59	.11	.41	⅜	33	BROWN
54945BEUF	#1 AWG	75 Navy, #2 Weld		#10	.65	.68	.11	.47	¼	37	GREEN
54947BEUF		150/24 = 60.5 kcmil		⅝	.88	.68	.11	.47	⅜	37	GREEN
54946BEUF	1/0 AWG	100 Navy		#10	.65	.75	.13	.52	¼	42	PINK
54949BEUF		225/24 = 90.8 kcmil		⅝	.88	.75	.13	.52	⅜	42	PINK
54909BEUF		#1 Weld		⅝	.93	.75	.13	.52	⅜	42	PINK
54950BEUF	2/0 AWG	125 Navy, 1/0 Weld		⅝	.93	.83	.13	.57	⅜	45	BLACK
54951BEUF		275/24 = 111 kcmil		½	1.25	.83	.13	.57	½	45	BLACK
54965BEUF	3/0 AWG	325/24 = 131 kcmil, 150 Navy, 2/0 Weld		½	1.25	.92	.13	.63	½	50	ORANGE
54970BEUF04	4/0 AWG	200 Navy		¼	1.00	1.03	.14	.70	¼	54	PURPLE
54970BEUF06		450/24 = 182 kcmil		⅝	1.13	1.03	.14	.70	⅜	54	PURPLE
54970BEUF		3/0 Weld		½	1.25	1.03	.14	.70	½	54	PURPLE
54913BEUF	250 kcmil	550/24 = 222 kcmil, 250 Navy, 4/0 Weld		½	1.25	1.13	.14	.77	½	62	YELLOW
54914BEUF	300 kcmil	300 Navy, 250 Weld, 262, 650/24		½	1.25	1.25	.15	.85	½	66	WHITE
54915BEUF	350 kcmil			½	1.25	1.36	.18	.93	½	71	RED
54916BEUF	400 kcmil	400 Navy, 300 Weld		½	1.25	1.41	.17	.96	½	76	BLUE
54917BEUF		775/24 = 313 kcmil, 350, 259 Str.		⅝	1.58	1.41	.17	.96	⅝	76	BLUE
54918BEUF	500 kcmil	925/24 = 373 kcmil		½	1.25	1.61	.22	1.10	½	87	BROWN
54919BEUF		400 Weld, 350, 3458 Str.		⅝	1.58	1.61	.22	1.10	⅝	87	BROWN
54921BEUF	600 kcmil	450 I, K		½	1.25	1.75	.24	1.20	½	94	GREEN
54920BEUF		1100/24 = 444 kcmil		⅝	1.58	1.75	.24	1.20	⅝	94	GREEN
54922BEUF	750 kcmil	1325/24 = 535 kcmil		½	1.25	1.94	.27	1.33	½	106	BLACK
54923BEUF		500 Weld		⅝	1.58	1.94	.27	1.33	⅝	106	BLACK
58984BEUF	900 kcmil	1600/24 = 646 kcmil		⅝	1.58	1.94	.27	1.33	⅝	106	YELLOW
58926BEUF		1925/24 = 777 kcmil		⅝	1.58	2.17	.31	1.50	⅝	115	YELLOW
54928BEUF	1000 kcmil			⅝	1.58	2.27	.30	1.55	⅝	125	N/A
54928BEUF12				⅞	1.83	2.37	.30	1.55	⅞	125	N/A

<sup>†</sup> Contact Technical Services for specific stranding listings

Tooling: pp. F-80-F-100 Die Selector Chart: pp. F-101-F-104