

# Straight Blade Devices



## Hospital Grade • Impact Resistant Plugs and Connectors



- Impact-resistant thermoplastic construction with automatic cord grip
- Transparent polycarbonate cover allows visual inspection of wire terminations without disassembly
- Pre-attached TPE (thermoplastic elastomer) dust seal helps prevent contaminants from entering wiring chamber
- Single side terminal screws reduce wiring time and are color coded for proper terminations

### Angled Plugs

All Bryant angle devices are ideally suited for any location where space restrictions or obstructions require the power cord to lay close to the wall or flat against the floor.

Bryant hospital grade transparent angle plugs are designed for straight blade applications in hospitals, as well as industrial, commercial and institutional environments – wherever attachment plugs must withstand severe abuse.

## 15A and 20A 125V and 20A 250V Plugs and Connectors, 2-Pole 3-Wire Inches (mm)



BRY8266NP

8266T

8295T

BRY8269NC

8269T

Device Type		Straight Plug		Angled Plug	Connector	
Rating	Cord Diameter	White Thermoplastic	Transparent Nylon/Polycarbonate	Transparent Nylon/Polycarbonate	White Thermoplastic	Transparent Nylon/Polycarbonate
NEMA 5-15, 15A 125V	.245"-.655" (6.2-16.6)	<b>BRY8266NP</b>	<b>8266T</b>	<b>8295T</b>	<b>BRY8269NC</b>	<b>8269T</b>
NEMA 5-20, 20A 125V	.245"-.655" (6.2-16.6)	<b>BRY8366NP</b>	<b>8366T</b>	<b>8395T</b>	<b>BRY8369NC</b>	<b>8369T</b>
NEMA 6-20, 20A 250V	.300"-.625" (7.6-15.9)	<b>BRY8466NP</b>	—	<b>8495T</b>	<b>BRY8469NC</b>	—

## Product Dimensions Inches (mm)

	Plug	Angled Plug	Connector
A	1.52" (38.6)	1.30" (33.0)	1.52" (38.6)
B	2.18" (55.4)	2.07" (52.6)	2.95" (74.9)
C	1.38" (35.1)	1.52" (38.6)	1.38" (35.1)

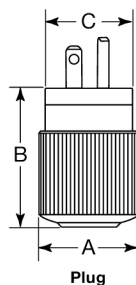

Plug

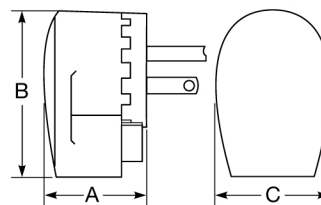

Angled Plug

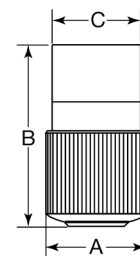

Connector