

- Suspend boxes or fixtures from beam flanges $\frac{1}{8}$ " to $\frac{3}{4}$ " thick.
- Provided with $\frac{1}{4}$ "-20 thread impression for quick and secure attachment.
- Simply installed with a hammer.

Universal Beam Fasteners



UPC/Part Number	Catalog Number	Flange Thickness	Box Qty.
78101119600	BU-2-4	$\frac{1}{8}$ " - $\frac{1}{4}$ "	100
78101119605	BU-5-8	$\frac{5}{16}$ " - $\frac{1}{2}$ "	100
78101119610	BU-9-12	$\frac{9}{16}$ " - $\frac{3}{4}$ "	100



20 x $\frac{3}{8}$ "
ked Stud

UPC/Part Number	Catalog Number	Flange Thickness	Box Qty.
78101119615	BU-2-4-S	$\frac{1}{8}$ " - $\frac{1}{4}$ "	100
78101119620	BU-5-8-S	$\frac{5}{16}$ " - $\frac{1}{2}$ "	100
78101119625	BU-9-12-S	$\frac{9}{16}$ " - $\frac{3}{4}$ "	100

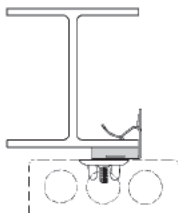
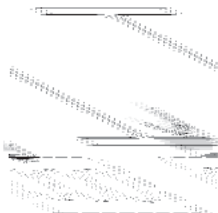

**Static
Load
Capacity**

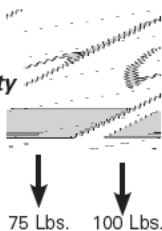

Note: Indicated loads are static load capacity and should not be combined.

*Read safety/installation instruction sheets in packages before use.
These products are designed for positioning only. No load rating.*