

Instrument Selector Switches

Panel mounted selector switches offer a 7-position voltmeter switch and a 4-position ammeter switch for reading line-to-line or line-to-neutral voltage and phase current. Each switch can be supplied with either numbered or coloured annotation.

Specifications

Loading capacity:	SO1 and SO2: 20A, 500V. SO3: 12A/480V
Switching capacity:	3kW at 220V, 5kW at 380V, 5.5kW at 500V
Isolating voltage:	SO1 and SO2: 500V AC. SO3: 480V AC
Operating temperature:	-20°C to + 70°C
Mounting installation:	Two point front fixing
Dimensions:	48mm x 48mm
Panel cut out:	3 drilled holes
Compliant with:	LVD and EMC
IP protection:	SO1 and SO2: IP65. SO3: IP54

Product Codes

SO1 Three hole fixing 20A	
SO1-SAB	4-position ammeter switch, L1-L2-L3-0
SO1-SAA	4-position ammeter switch, R-Y-B-O
SO1-SVE	7-position voltmeter switch, RY-YB-RB-0-RN-YN-BN
SO1-SVD	7-position voltmeter switch, L1L2-L2L3-L3L1-0-L1N-L2N-L3N
SO2 Single hole mount 20A	
SO2-SAB	4-position ammeter switch, L1-L2-L3-0
SO2-SAA	4-position ammeter switch, R-Y-B-O
SO2-SVE	7-position voltmeter switch, RY-YB-RB-0-RN-YN-BN
SO2-SVD	7-position voltmeter switch, L1L2-L2L3-L3L1-0-L1N-L2N-L3N
SO3 Three hole fixing 12A	
SO3-SAB	4-position ammeter switch, L1-L2-L3-0
SO3-SVD	7-position voltmeter switch, L1L2-L2L3-L3L1-0-L1N-L2N-L3N

Dimensions

SO1 Three Hole Fixing 20 Amp

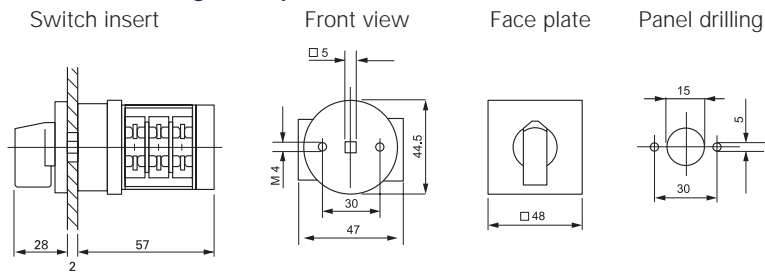

SO2 Single Hole Fixing 20 Amp

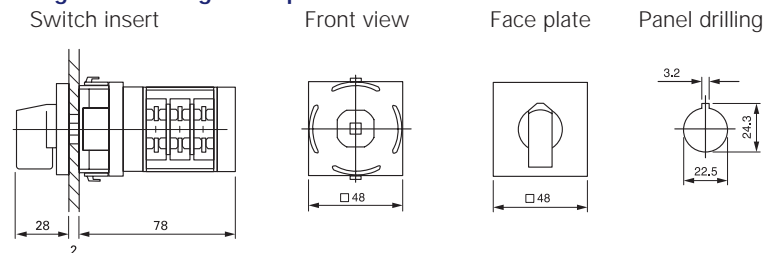

SO3 Three Hole Fixing 12 Amp

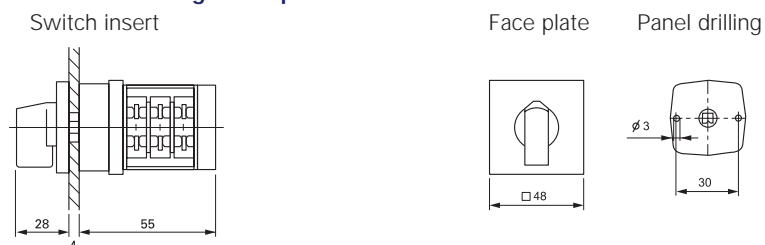

Connections

Voltmeter Change-over Switches

For measuring 3-interconnected voltages and 3-phase voltage against N.

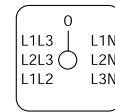

SO1 and SO2

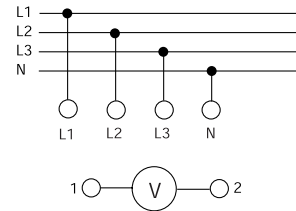

SO3



Ammeter-Change-over Switches

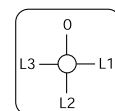

SO1 and SO2

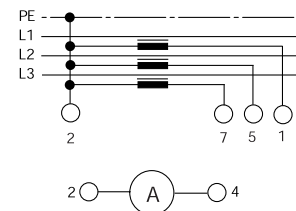

SO3

