

# HET200VB series

## Dimension drawing

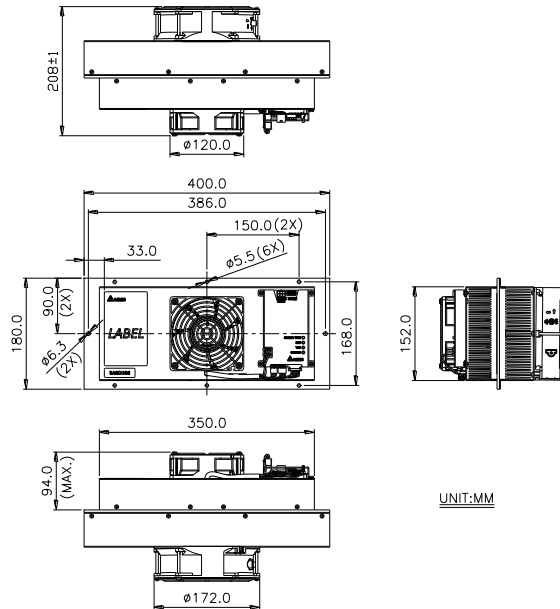

### Features

- ◆ IP55 waterproof at external side
- ◆ FAN / TEC / Control fail alarm
- ◆ Clear LED status indicator
- ◆ Standalone temperature control
- ◆ High efficiency and reliable fan modules

### Design

- ◆ High efficiency of cooling & Heating
- ◆ Thermal electric cooling module
- ◆ Rated voltage at 24V
- ◆ Built-in controller

Main feature	Unit	Model Number
		HET200VB
Outline dimension	mm	100 H x 180 W x 209 D
Weight	kg	9.0 ± 0.5
Cooling capacity ( $\Delta T = 0^{\circ}\text{C}$ )	W	200 (TYP.)
Heating capacity @ $-40^{\circ}\text{C}$	W	225 (TYP.)
Rated voltage	VDC	24 (TYP.)
Operating voltage range	VDC	21~27
Actuality Current	A	12.2 (TYP.)
Power Consumption	W	293
Operating temperature	$^{\circ}\text{C}$	-40 ~ +65
Internal airflow rate	CFM	100 (TYP.)
External airflow rate		120 (TYP.)
Acoustic noise at 1M : (Sound pressure)	dB-A	61.0 (TYP.)
		64.0 (Max.)

\* Specifications are subject to change without notice.