

REV. ECN NO.

00 -----

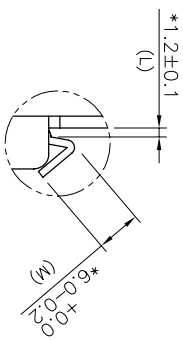

Detail "A"  
Scale 2:1

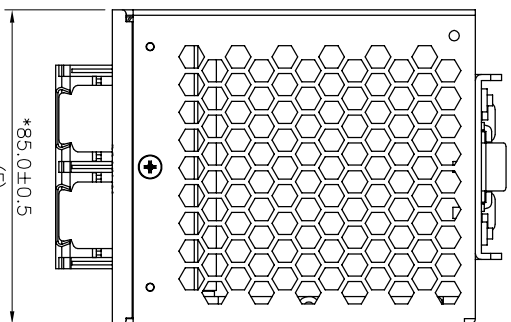

Detail "B"  
Scale 2:1

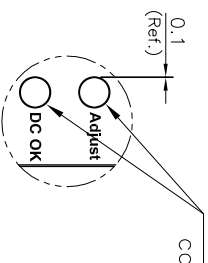

Label hole must be concentric with case hole.

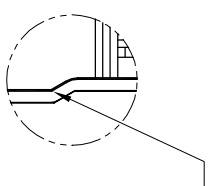

Label must be smooth with front panel.

Detail "C"  
Scale 2:1

SPRING FORCE  
For Latch: 1.0~2.5 Kgf.  
For Release: 2.5~4.0 Kgf. (Max Stroke)

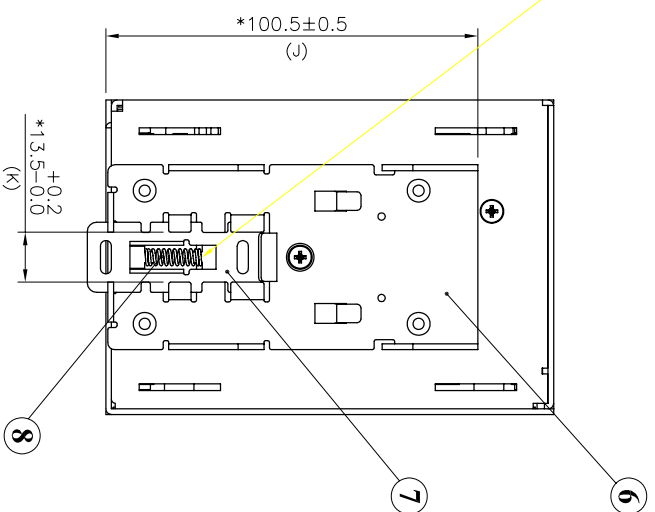
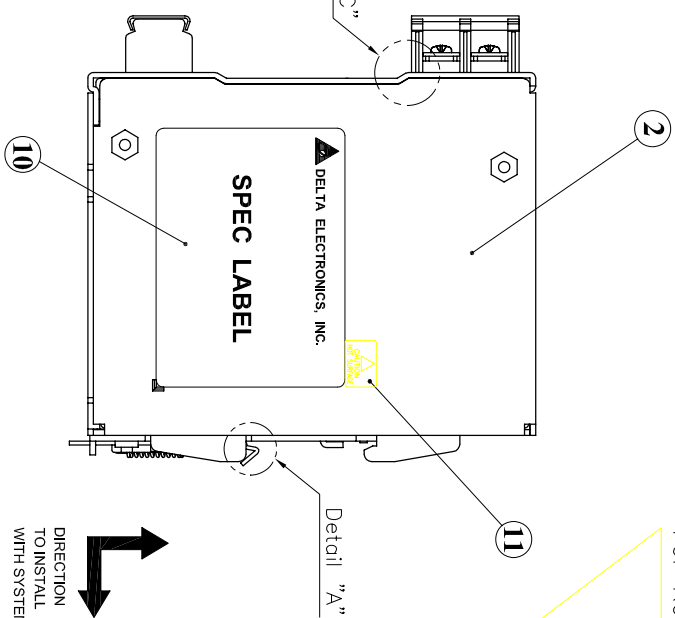
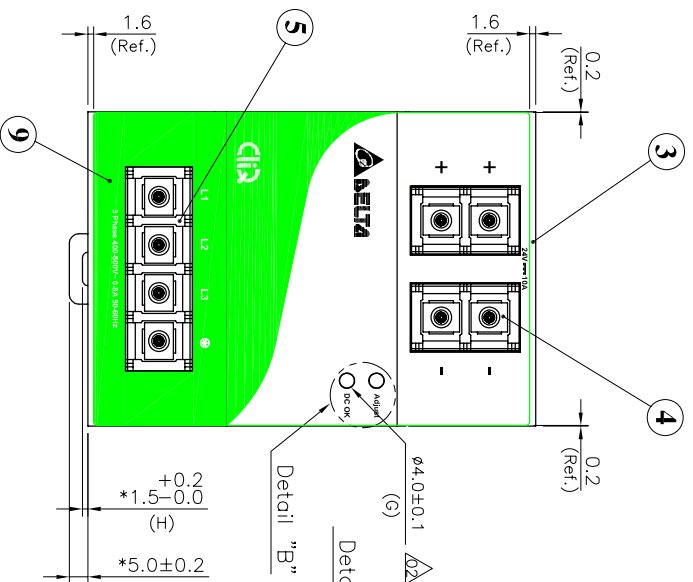
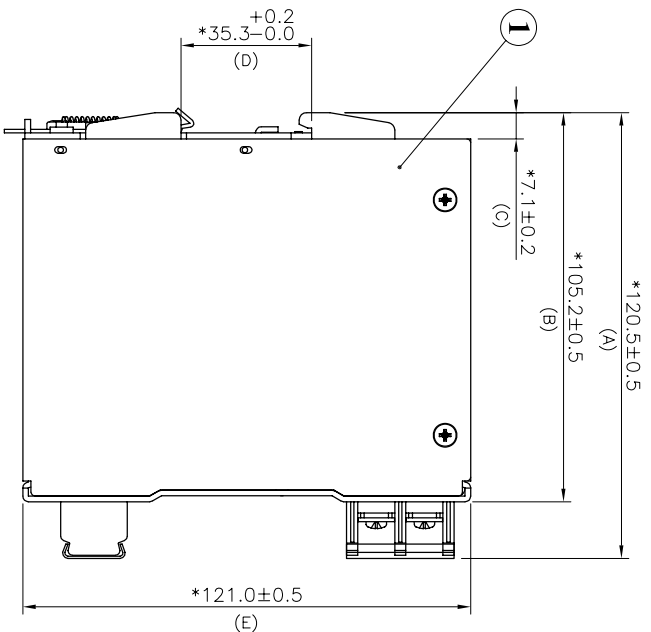

ITEM	DESCRIPTION	DELTA P/N	Q'TY
1	CASE COVER	33052007XX	1
2	CASE CHASSIS	33052009XX	1
3	FRONT PANEL	33052006XX	1
4	TERMINAL BLOCK 2 PIN	3072076446	2
5	TERMINAL BLOCK 3 PIN	3072076546	1
6	BASE BACK	34613037XX	1
7	LATCH	34600881XX	1
8	SPRING	34620262XX	1
9	FRONT LABEL	32630372XX	1
10	SPEC LABEL	32000919XX	1
11	CAUTION LABEL	32023152XX	1

NOTES:

1. " \* " IS CRITICAL DIMENSION MUST BE INSPECTED.
2. PRODUCT SURFACE SHOULD BE CLEAN.
3. SPEC LABEL DETAIL AND PRINTING CONTENTS REFER TO SN.
4. MUST MEET DELTA GENERAL STANDARD: 10000-0162.



THESE DRAWINGS AND SPECIFICATIONS ARE THE PROPERTY OF DELTA ELECTRONICS, INC. AND SHALL NOT BE REPRODUCED OR USED AS THE BASIS FOR THE MANUFACTURE OR SELL OF APPARATUS OR DEVICES WITHOUT PERMISSION.

DRAWING NAME:

PHYSICAL DIMENSION DRAWING

USED ON

DRAWN:	DESIGN:
DATE:	ECN NO.:

DIMENSIONAL TOLERANCES

( )	( )	( )	( )	ANGLES
DECIMALS <50	±0.1	<50	±0.15	<30° : ±0.1°
X : ±0.3	>50-100 : ±0.15	>50-100	±0.2	>30°-60° : ±0.3°
X.X : ±0.2	>100-200 : ±0.2	>100-200	±0.25	>60°-90° : ±0.5°
X.XX : ±0.1	>200- : ±0.2%	>200-	±0.25%	>90° : ±0.3%

DRAWING NAME:

PHYSICAL DIMENSION DRAWING

USED ON