



Cat. No. 5-D-1-1-R

Product Description

Model D Series are medium-duty stroke counters available with 4, 5 or 6 figures that have been designed for general service on small production machines. Although compact, Durant® "D" models are sturdily constructed and thoroughly tested for accuracy and efficient operation.

Technical Data and Specifications

- Figures: 4, 5 and 6
- Speed: 400 cpm
- Shaft: 0.25" (6.4 mm) diameter stainless steel, rustproof
- Drive: Nylon ratchet and Delrin drive plate. Right-hand drive standard; left-hand drive available
- Bearings: Oil-less, maintenance free
- Figure Size: 1/4" (6.4 mm) high, black-on-white background
- Reset: Wing nut
- Finish: Black frame and cover
- Operating lever: Adjustable to any position. Furnished complete with pull string

Product Selection

Table 54-8. Product Selection — D Series Stroke Counters

| No. of Figures | Drive | Reset | Mounting | Catalog Number | Order Number | Price U.S. \$ |
|----------------|------------|----------|----------|----------------|--------------|---------------|
| 4 | R.H. Lever | Wing Nut | Base | 4-D-1-1-R | 34269401 | |
| 5 | R.H. Lever | Wing Nut | Base | 5-D-1-1-R | 34269402 | |
| 6 | R.H. Lever | Wing Nut | Base | 6-D-1-1-R | 34269403 | |
| 4 | L.H. Lever | Wing Nut | Base | 4-D-1-1-L | 34269405 | |
| 5 | L.H. Lever | Wing Nut | Base | 5-D-1-1-L | 34269406 | |
| 6 | L.H. Lever | Wing Nut | Base | 6-D-1-1-L | 34269407 | |

When Ordering Specify

To determine a model number from the Product Selection table for Model D Series Stroke Counters, consider:

- Number of figures
- Drive lever

Dimensions

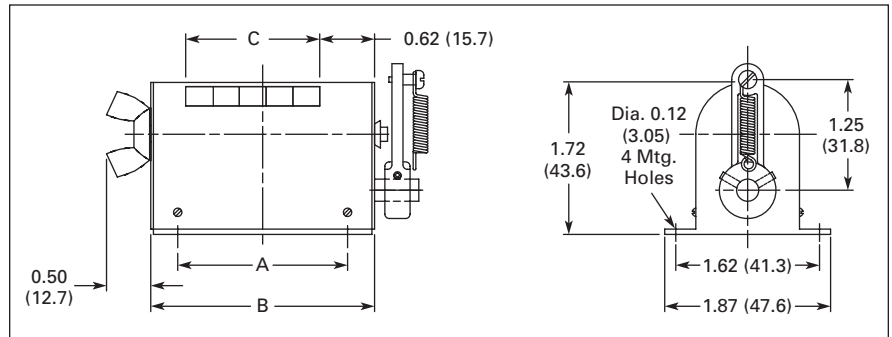

Figure 54-5. D Series — Approximate Dimensions in Inches (mm)

Table 54-9. D Series — Approximate Dimensions in Inches (mm)

| Model | A | B | C |
|----------|-------------|-------------|-------------|
| 4-D-1-1_ | 1.59 (40.4) | 2.20 (55.9) | 1.20 (30.6) |
| 5-D-1-1_ | 1.92 (48.8) | 2.53 (64.3) | 1.51 (38.5) |
| 6-D-1-1_ | 2.26 (57.5) | 2.87 (73.0) | 1.83 (46.4) |