

NZ2VZ-2131E-9C-DCX (ORDER NO. 098445)

Safety switch NZ.VZ, plug connector MR9

- ▶ Housing according to EN 50041
- ▶ Plug connector MR9



Description

Approach direction

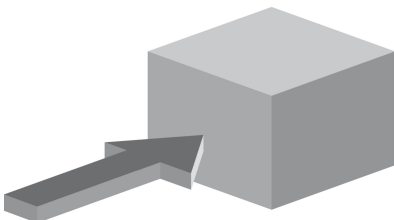

Figure

Horizontal

Can be adjusted in 90° steps

Switching element

2131H Slow-action switching contact 2 NC \rightarrow + 1 NO

Dimension drawing

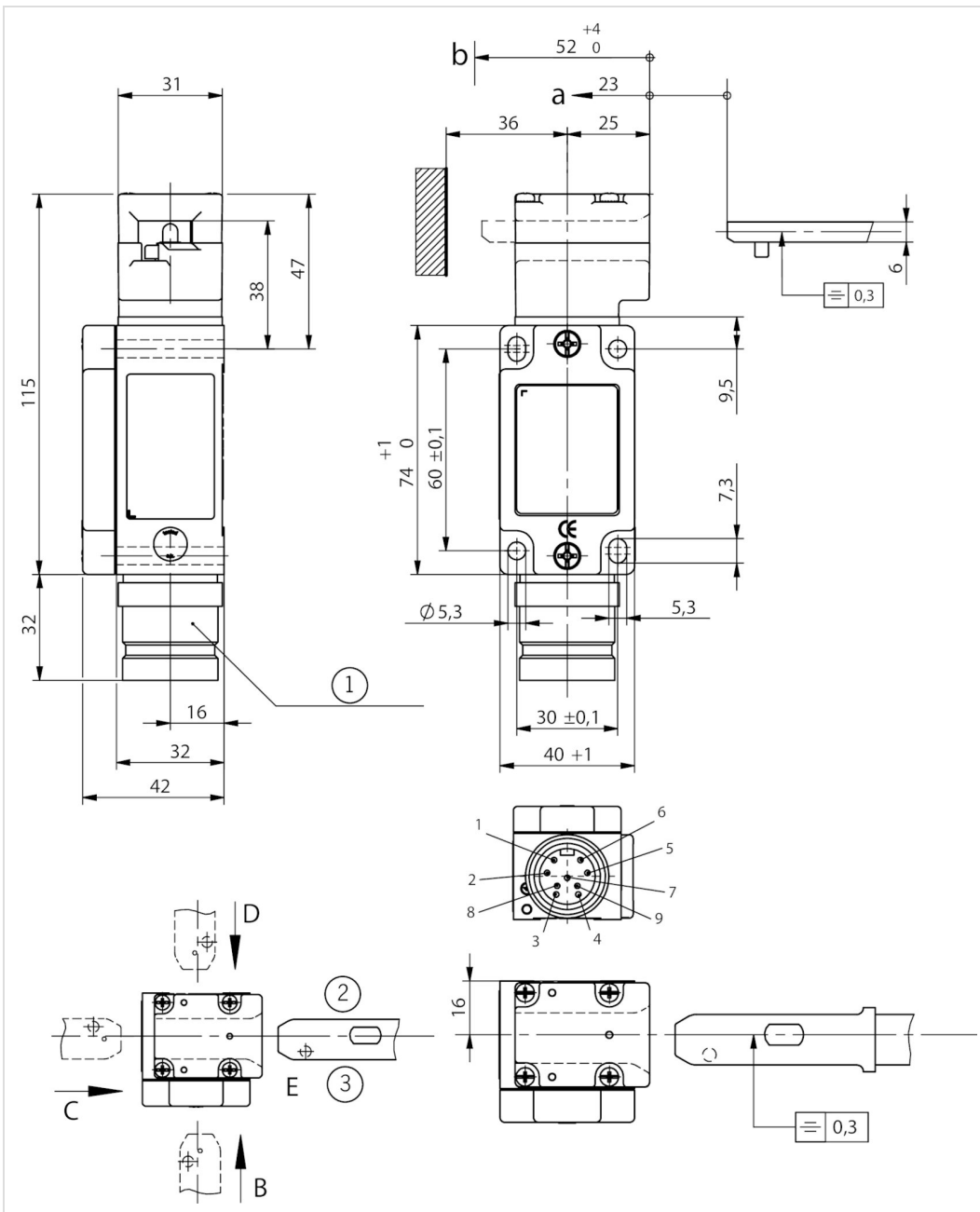

1 Plug connector aligned, MENCOR (9 pin) MIN-9MR-1-18-M20

2 Changing the approach direction

3 Standard (A)

2131H

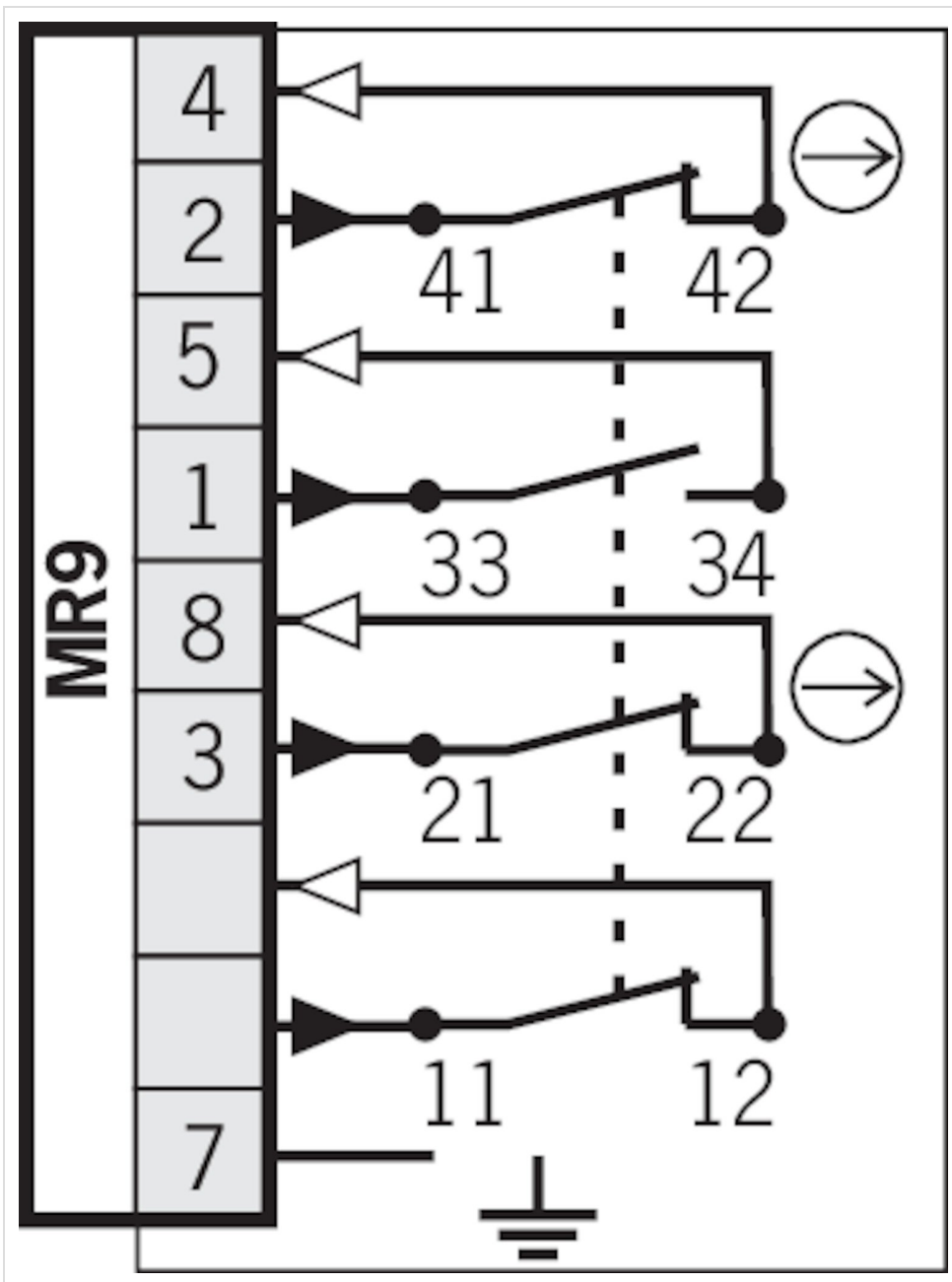

Switching functions

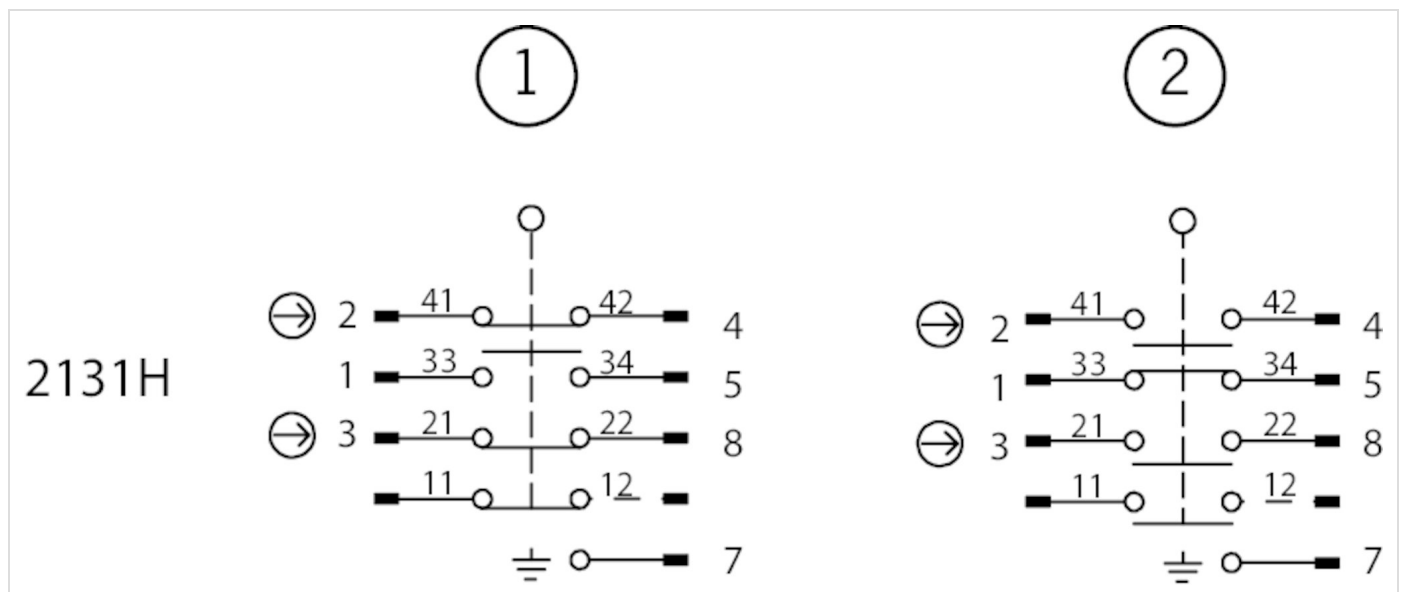

- 1 Actuator inserted
- 2 Actuator removed

Technical data

Approvals



Mechanical values and environment

Housing material	Housing	Anodized die-cast alloy
Weight	Net	0,3 kg
Ambient temperature		-25 ... 80 °C
Degree of protection		IP65
Mechanical life		2 x 10 ⁶
Contact material		Silver alloy, gold flashed
Switching principle		Slow-action switching contact
Installation orientation		Any
Number of door position positively driven contacts		1
Number of door position NO contacts		3
Connection	1 x	Plug connector BHA9 (8-pin + PE)
Approach speed		max.20 m/min
Actuation frequency		max.1200 1/h
Retention force		8 N
Extraction force		35 N
Actuating force		35 N
Insertion depth		52 mm
Electrical connection ratings		
Thermal rated current I _{th}		4 A
Utilization category acc. to EN 60947-5-1	AC-15	4A 230V
	DC-13	4A 24V
Short circuit protection according to IEC 60269-1		4A gG
Rated insulation voltage U _i	AC/DC	250 V
Rated impulse withstand voltage U _{imp}		1,5 kV
Switching voltage		12 V
Switching current	Min. at 24V	1 mA
Display module	AC	230 V (Red)

Reliability values according to EN ISO 13849-1

Monitoring of the safety guard position

B10 _D	4,5 x 10 ⁶
------------------	-----------------------

In combination with Actuator BETAETIGER-Z-G

Mechanical values and environment

Overtravel	4 mm
------------	------

In combination with Actuator BETAETIGER-Z-GN

Mechanical values and environment

Overtravel	16 mm
------------	-------

Accessories

Actuator

Actuators for safety switches NZ.VZ, NZ.VZ.VS and TZ



097436
BETAETIGER-Z-GME

- ▶ Made of solid stainless steel
- ▶ Two stainless safety screws per actuator



074411
BETAETIGER-Z-G/V25

- ▶ Two stainless safety screws per actuator
- ▶ Packaging unit 25 pieces



016849
BETAETIGER-Z-G

- ▶ Two stainless safety screws per actuator



072251
BETAETIGER-Z-GN

- ▶ Two stainless safety screws per actuator

Hinged actuator bottom for safety switches NZ.VZ, NZ.VZ.VS and TZ



048850
RADIUSBETAETIGER-Z-U

- ▶ Two stainless safety screws per actuator



074414
RADIUSBETAETIGER-Z-U/V25

- ▶ Two stainless safety screws per actuator
- ▶ Packaging unit 25 pieces

Hinged actuator left for safety switches NZ.VZ, NZ.VZ.VS and TZ

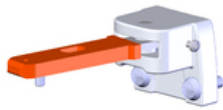

024298
RADIUSBETAETIGER-Z-L

- ▶ Two stainless safety screws per actuator



100407
RADIUSBETAETIGER-Z-L-C2194

- ▶ Two stainless safety screws per actuator
- ▶ Smaller door radii

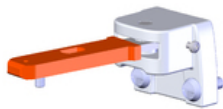

074413
RADIUSBETAETIGER-Z-L/V25

- ▶ Two stainless safety screws per actuator
- ▶ Packaging unit 25 pieces

Hinged actuator right for safety switches NZ.VZ, NZ.VZ.VS and TZ

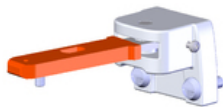

074412
RADIUSBETAETIGER-Z-R/V25

- ▶ Two stainless safety screws per actuator
- ▶ Packaging unit 25 pieces



100406
RADIUSBETAETIGER-Z-R-C2194

- ▶ Two stainless safety screws per actuator
- ▶ Smaller door radii

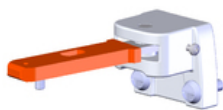

024299
RADIUSBETAETIGER-Z-R

- ▶ Two stainless safety screws per actuator

Hinged actuator top for safety switches NZ.VZ, NZ.VZ.VS and TZ

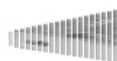

074415
RADIUSBETAETIGER-Z-O/V25

- ▶ Two stainless safety screws per actuator
- ▶ Packaging unit 25 pieces

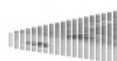

057950
RADIUSBETAETIGER-Z-O

- ▶ Two stainless safety screws per actuator

Bolt

Bolt BTC-NZVZ... with escape release for safety switches NZ.VZ and NZ.VZ.VS



104399
BTC-NZVZ-S-TH-01-F

- ▶ Die-cast aluminum bolt
- ▶ For doors hinged on the left or right
- ▶ Lever for escape release from the danger zone
- ▶ Can be locked in open position with padlocks
- ▶ Actuator included

Bolt BTC-NZVZ... without escape release for safety switches NZ.VZ and NZ.VZ.VS



104398
BTC-NZVZ-S-TH-00-X

- ▶ Die-cast aluminum bolt
- ▶ For doors hinged on the left or right
- ▶ Can be locked in open position with padlocks
- ▶ Actuator included

Bolt NZ-A... for safety switches NZ.VZ and NZ.VZ.VS



083890
RIEGEL NZ-AB

- ▶ Steel bolt
- ▶ For doors hinged on the right
- ▶ Ball detent mechanism in closed position
- ▶ Can be locked in open position with padlocks
- ▶ Actuator and switch bracket included



078455
RIEGEL NZ-AR2

- ▶ Steel bolt
- ▶ For doors hinged on the right
- ▶ Detent knob in open position
- ▶ Detent knob mechanism in closed position
- ▶ Can be locked in open position with padlocks
- ▶ Actuator and switch bracket included

Bolt NZ-AF with escape release for safety switches NZ.VZ



078451
RIEGEL NZ-AF

- ▶ Steel bolt
- ▶ For doors hinged on the right
- ▶ Lever for escape release from the danger zone
- ▶ Detent knob in open position
- ▶ Can be locked in open position with padlocks
- ▶ Actuator and switch bracket included

Bolt NZ-A for safety switches NZ.VZ and NZ.VZ.VS



057734
RIEGEL NZ-A

- ▶ Steel bolt
- ▶ For doors hinged on the right
- ▶ Can be locked in open position with padlocks
- ▶ Actuator and switch bracket included
- ▶ Bolt is not allowed to be used in conjunction with an escape release.

Bolt NZ-C... for safety switches NZ.VZ and NZ.VZ.VS



078456
RIEGEL NZ-CR2

- ▶ Steel bolt
- ▶ For doors hinged on the left
- ▶ Detent knob in open position
- ▶ Detent knob mechanism in closed position
- ▶ Can be locked in open position with padlocks



083892
RIEGEL NZ-CB

- ▶ padlocks
- ▶ Actuator and switch bracket included
- ▶ Steel bolt
- ▶ For doors hinged on the left
- ▶ Ball detent mechanism in closed position
- ▶ Can be locked in open position with padlocks
- ▶ Actuator and switch bracket included

Bolt NZ-CF with escape release for safety switches NZ.VZ



078452
RIEGEL NZ-CF

- ▶ Steel bolt
- ▶ For doors hinged on the left
- ▶ Lever for escape release from the danger zone
- ▶ Detent knob in open position
- ▶ Can be locked in open position with padlocks
- ▶ Actuator and switch bracket included

Bolt NZ-C for safety switches NZ.VZ and NZ.VZ.VS



057735
RIEGEL NZ-C

- ▶ Steel bolt
- ▶ For doors hinged on the left
- ▶ Can be locked in open position with padlocks
- ▶ Actuator and switch bracket included

Bolt NZ-GFK for safety switch NZ.VZ



096617
RIEGEL NZ-GFK

- ▶ Fiber glass reinforced plastic bolt
- ▶ For doors hinged on the left or right
- ▶ Can be locked in open position with padlocks
- ▶ Actuator included

Bolt NZ/TZ-ACF with escape release for safety switches NZ.VZ and TZ with escape release



083900
RIEGEL NZ/TZ-ACF

- ▶ Steel bolt
- ▶ For doors hinged on the right or left
- ▶ Lever for escape release from the danger zone
- ▶ Detent knob in open position
- ▶ Can be locked in open position with padlocks
- ▶ Bolt for two safety switches
- ▶ Actuator included

Bolts NZ/TZ-S1 and NZ/TZ-S2 for safety switches NZ.VZ, NZ.VZ.VS and TZ



028357
RIEGEL NZ/TZ-S1

- ▶ Aluminum bolt
- ▶ For doors hinged on the left or right. Cone grip bottom.
- ▶ Spring catch in open position
- ▶ Can be locked in open position with padlocks
- ▶ Actuator included



028359
RIEGEL NZ/TZ-S2

- ▶ Aluminum bolt
- ▶ For doors hinged on the left or right. Cone grip top.
- ▶ Spring catch in open position
- ▶ Can be locked in open position with padlocks
- ▶ Actuator included

Bolts NZ/TZ-S1/AF and NZ/TZ-S1/CF with escape release for safety switches NZ.VZ, NZ.VZ.VS and TZ with escape release

I Z WITH escape release



079786
RIEGEL NZ/TZ-S1/AF

- ▶ Aluminum bolt
- ▶ For doors hinged on the right
- ▶ Escape release
- ▶ Spring catch in open position
- ▶ Can be locked in open position with padlocks
- ▶ Actuator included



079785
RIEGEL NZ/TZ-S1/CF

- ▶ Aluminum bolt
- ▶ For doors hinged on the left
- ▶ Escape release
- ▶ Spring catch in open position
- ▶ Can be locked in open position with padlocks
- ▶ Actuator included

Connection material

Connection cable with plug connector MR9, 9-pin, 1.8m

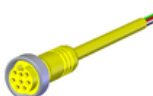

102502
C-MINF09-09X1,0PV01,8-MA-102502

- ▶ MR9 female plug, 9-pin
- ▶ Straight plug connector
- ▶ PVC cable
- ▶ Cable length 1.8 m
- ▶ With flying lead

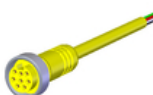

102510
C-MINF09-09X1,0PU01,8-MA-102510

- ▶ MR9 female plug, 9-pin
- ▶ Straight plug connector
- ▶ PUR cable
- ▶ Cable length 1.8 m
- ▶ With flying lead

Connection cable with plug connector MR9, 9-pin, 3.6m

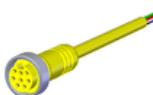

100948
C-MINF09-09X1,0PV03,6-MA-100948

- ▶ MR9 female plug, 9-pin
- ▶ Straight plug connector
- ▶ PVC cable
- ▶ Cable length 3.6 m
- ▶ With flying lead

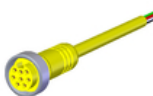

102511
C-MINF09-09X1,0PU03,6-MA-102511

- ▶ MR9 female plug, 9-pin
- ▶ Straight plug connector
- ▶ PUR cable
- ▶ Cable length 3.6 m
- ▶ With flying lead

Connection cable with plug connector MR9, 9-pin, 6m

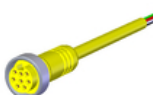

102503
C-MINF09-09X1,0PV06,0-MA-102503

- ▶ MR9 female plug, 9-pin
- ▶ Straight plug connector
- ▶ PVC cable
- ▶ Cable length 6 m
- ▶ With flying lead

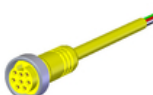

102512
C-MINF09-09X1,0PU06,0-MA-102512

- ▶ MR9 female plug, 9-pin
- ▶ Straight plug connector
- ▶ PUR cable
- ▶ Cable length 6 m
- ▶ With flying lead

Connection cable with plug connector MR9, 9-pin, 9.1m



102504
C-MINF09-09X1,0PV09,1-MA-102504

- ▶ MR9 female plug, 9-pin
- ▶ Straight plug connector
- ▶ PVC cable
- ▶ Cable length 9.1 m
- ▶ With flying lead



102513
C-MINF09-09X1,0PU09,1-MA-102513

- ▶ MR9 female plug, 9-pin
- ▶ Straight plug connector
- ▶ PUR cable
- ▶ Cable length 9.1 m
- ▶ With flying lead

Connection cable with plug connector MR9, 9-pin, 12.1m



103154
C-MINF09-09X1,0PV12,1-MA-103154

- ▶ MR9 female plug, 9-pin
- ▶ Straight plug connector
- ▶ PVC cable
- ▶ Cable length 0.91 m
- ▶ With flying lead



102514
C-MINF09-09X1,0PU12,1-MA-102514

- ▶ MR9 female plug, 9-pin
- ▶ Straight plug connector
- ▶ PUR cable
- ▶ Cable length 12.1 m
- ▶ With flying lead

Connection cable with plug connector MR9, 9-pin, 15.2m



102515
C-MINF09-09X1,0PU15,2-MA-102515

- ▶ MR9 female plug, 9-pin
- ▶ Straight plug connector
- ▶ PUR cable
- ▶ Cable length 15.2 m
- ▶ With flying lead

Connection cable with plug connector MR9, 9-pin, 18.2m



103156
C-MINF09-09X1,0PV18,2-MA-103156

- ▶ MR9 female plug, 9-pin
- ▶ Straight plug connector
- ▶ PVC cable
- ▶ Cable length 18.2 m
- ▶ With flying lead



103151
C-MINF09-09X1,0PU18,2-MA-103151

- ▶ MR9 female plug, 9-pin
- ▶ Straight plug connector
- ▶ PUR cable
- ▶ Cable length 18.2 m
- ▶ With flying lead

Function expansion

Lockout mechanism NZ.VZ/TZ, 3 holes



091305
SPERREINSATZ MIT KETTE

- ▶ Prevents unintentional closing of the door
- ▶ Can be secured with padlocks



046730
SPERREINSATZ-Z-046730

- ▶ Prevents unintentional closing of the door
- ▶ Can be secured with padlocks

Lockout mechanism NZ.VZ/TZ, 5 holes

086538
SPERREINSATZ-Z-086538

- ▶ Prevents unintentional closing of the door
- ▶ Can be secured with padlocks

Protective plate NZ.VZ/TZ

059136
SCHUTZBLECH NZ/TZ

Mounting accessories

Mounting plates EMP-B1 for actuators for safety switches CTP, TP...A, STA, STP, TX and TZ



093457
EMP-B1

Mounting plates EMP-B2 for actuators for safety switches CTP, TP...A, STA, STP, TX and TZ



093458
EMP-B2

Mounting plates EMP-SC for safety switches NM, NP...AS and NZ

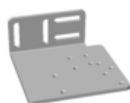

085753
EMP-SC

- ▶ For vertical and horizontal mounting of safety switches NM, NP...AS and NZ

Safety screws M4 x 14

074063
M4X14/V100

- ▶ Safety screws M4 x 14
- ▶ Packaging unit 100 pieces

Safety screws M5 x 10

073455
M5X10-NIRO/V100 NZ/TZ

- ▶ Safety screws M5 x 10
- ▶ Packaging unit 100 pieces

Safety screws M5 x 16

073456
M5X16/V100

- ▶ Safety screws M5 x 16
- ▶ Packaging unit 100 pieces

Safety screws for actuators, M5 x 25

073457
M5X25/V100

- ▶ Safety screws M5 x 25
- ▶ Packaging unit 100 pieces

Spare parts

076250
BETAETIGUNGSKOPF NZVZ

Contacts

🏠 EUCHNER GmbH + Co. KG
Kohlhammerstraße 16
70771 Leinfelden-Echterdingen

☎ +49 711 7597-0

📠 +49 711 753316

✉ info(at)euchner.de