

<b>ATTENTION</b>	The possibility exists that rapid flashing lights, under certain circumstances, might induce photosensitive epilepsy
<b>ATENCIÓN</b>	Existe la posibilidad que luces de intermitencia rápida, en determinadas circunstancias, podrían inducir epilepsia fotosensible
<b>ATTENTION</b>	Il est possible que des feux clignotants rapides, dans certaines circonstances, peuvent induire épilepsie photosensible

**TO BE INSTALLED BY QUALIFIED PERSONNEL ONLY**  
**LA INSTALACIÓN SÓLO DEBE SER REALIZADA POR PERSONAL CUALIFICADO - L'INSTALLATION DOIT ETRE EFFECTUEE PAR PERSONNEL QUALIFIE**

**NOT TO BE DISPOSED OF AS COMMON WASTE - NO ELIMINAR COMO DESECHO URBANO - NE PAS ELIMINER COMME DECHET URBAIN**

**INSTALLATION AND APPLICATION INSTRUCTIONS**  
**INSTRUCCIONES DE INSTALACIÓN Y EMPLEO - INSTRUCTIONS D' INSTALLATION ET D' UTILISATION**

SLM300  
SLM350  
SLM1400  
SLM1450

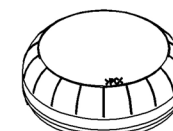

E162485  
VIS. APPLIANCE  
ENCLOSURE TYPE 4X  
FOR INDOOR/OUTDOOR

IP69K enclosure with SLM-RR

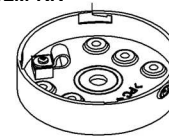

SLMBS-012-024

IP69K enclosure with SLM-RR

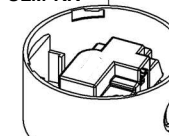

SLMBD-012-024  
SLMBD-PNP-012-024  
SLMBD-120-240

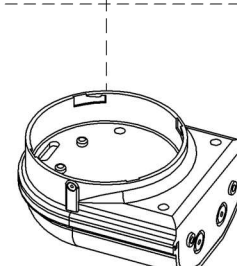

SLMBW-012-024  
SLMBW-PNP-012-024  
SLMBW-120-240

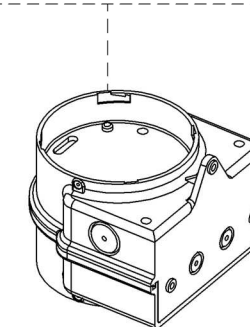

SLMBT-012-024  
SLMBT-PNP-012-024  
SLMBT-120-240

IP69K enclosure with SLM-RR

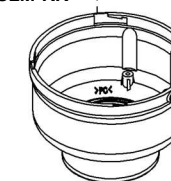

SLMBP-012-024  
SLMBP-PNP-012-024  
SLMBP-120-240

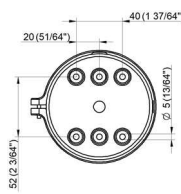

SLM300 + SLMBBS  
SLM350 + SLMBBS  
SLM1400 + SLMBBS  
SLM1450 + SLMBBS

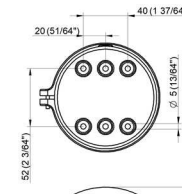

SLM300 + SLMBD  
SLM350 + SLMBD  
SLM1400 + SLMBD  
SLM1450 + SLMBD

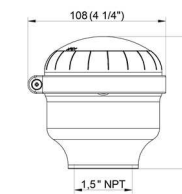

SLM300 + SLMBP  
SLM350 + SLMBP  
SLM1400 + SLMBP  
SLM1450 + SLMBP

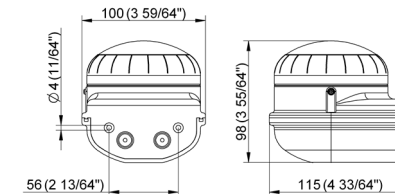

SLM300 + SLMBW  
SLM350 + SLMBW  
SLM1400 + SLMBW  
SLM1450 + SLMBW

All dims in mm unless otherwise noted  
 Todas las dimensiones son en mm, salvo que sea indicado de otra manera  
 Toutes les dimensions sont en mm, sauf indication contraire

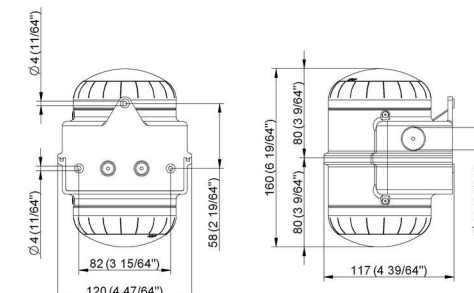

SLM300 + SLMBT  
SLM350 + SLMBT  
SLM1400 + SLMBT  
SLM1450 + SLMBT

**SLM300/SLM350**

V $\sim$	12-24
V $\sim$ 50/60Hz	
mA	300 270

**SLM300/SLM350**

V $\sim$ 50/60Hz	120-240
mA	80 50

**SLM1400/SLM 1450**

V $\sim$	12-24
V $\sim$ 50/60Hz	
mA	310 180

**SLM 1400/SLM 1450**

V $\sim$ 50/60Hz	120-240
mA	65 55

<b>FUSE WIRE PROTECTION</b>	On the power supply line the rating of the supply fuse must be according to the voltage
<b>FUSIBLE DE PROTECCIÓN</b>	En la línea de alimentación emplear fusibles de seguridad adecuados al voltaje
<b>FUSIBLE DE PROTECTION</b>	Sur la ligne d'alimentation utiliser des fusibles retardés dimensionnés selon la tension

<b>ATTENTION</b>	Disconnect power before servicing
<b>ATENCIÓN</b>	Desconecte la corriente antes de abrir el producto
<b>ATTENTION</b>	Débranchez l'alimentation avant de toute intervention sur le produit

