

POWER TOOL ACCESSORIES





Greenlee delivers power tool accessories that are second-to-none in the industry. From the double-flute cutting power of Kwik Stepper® step bits to Nail Eater® auger bits, Greenlee power tool accessories cut faster, last longer, and improve your productivity on the job site. Get through it with Greenlee.

CONTENTS

Selection Guide	106
Hole Saws.....	107
– Carbide-Tipped Hole Cutters	107
– Ultra Cutters	109
– Bi-Metal Hole Saws	110
– Carbide Grit Hole Saws	116
– Recessed Light Hole Saws	117
Step Bits	118
Drill/Tap Bits.....	120
Auger Bits	122
D'VersiBIT® Flexible Installer's Bits	125
Spade Bits.....	128
E-Z Bore® Wood Boring Bits	130
Reciprocating Saw Blades.....	131
Anchors and Fasteners.....	132

SELECTION GUIDES

Holemaking Selection Guide by Material/Application

MATERIAL APPLICATION TYPE	MATERIAL THICKNESS	NUMBER OF HOLES	PRODUCTS	APPLICATION CONSIDERATIONS	PAGE NO.
Mild Steel 	10 ga	Highest	Slug Splitter® Punches	Maximum durability and universal material usage Maximum hole size 4-1/2 inches	78 – 82
	–	–	SPEED PUNCH® Punches	Maximum hole size 4-1/2 inches	84 – 89
	10 ga	High	Slug-Buster® Punches	Maximum hole size 2-3/8 inches	60 – 63, 66 – 71
	10 ga	High	Standard Round Punches	Maximum hole size 6-3/8 inches	64 – 65, 72 – 73, 77
	8 ga	High	Carbide-Tipped Hole Cutters	Maximum hole size 4-1/2 inches	107 – 109
	10 ga	Medium-High	Ultra Cutters	Maximum hole size 2-1/2 inches	109
	10 ga	Medium-High	Step Bits	Maximum hole size 1-3/8 inches	118 – 119
	10 ga	Medium	Hole Saws	Maximum hole size 6 inches	110 – 112
Stainless Steel 	10 ga	Highest	Slug Splitter® Punches	Maximum durability and universal material usage Maximum hole size 2-3/8 inches	78 – 82
	10 ga	Highest	Lrg. Dia. Punches for Stainless	Hole size 2-1/2 – 4 inches	78 – 82
	8 ga	Medium-High	Carbide-Tipped Cutters	Maximum hole size 4-1/2 inches	107 – 109
Wood 	18"	High	Nail Eater® RT	Cuts through nails, good chip removal, Max hole size 1 inch	123
	18"	High	Nail Eater® Extreme Bits	Cuts through nails, good chip removal, Max hole size 1-1/4 inches	122 – 123
	2–2 x 4's	High	E-Z Bore® Bits	Self feed screw for hard or soft woods, Max hole size 4-5/8 inches	130
	2 x 4	High	Step Bits	Maximum hole size 1-3/8 inches, low chip removal	118 – 119
	16"	Medium	Spade Bits	Maximum hole size 1-1/2 inches	128 – 129
	1-5/8" or 2 x 4	High	Hole Saws	Maximum hole size 6 inches	110 – 112
Aluminum 	10 ga	Highest	Slug Splitter® Punches	Maximum durability and universal material usage Maximum hole size 2-3/8 inches	78 – 82
	–	–	SPEED PUNCH® Punches	Maximum hole size 2-3/8 inches	84 – 89
	10 ga	High	Slug-Buster® Punches	Maximum hole size 2-3/8 inches	60 – 63, 66 – 71
	10 ga	High	Standard Punches	Maximum hole size 6-3/8 inches	64 – 65, 72 – 73, 77
	10 ga	High	Ultra Cutters	Maximum hole size 2-1/2 inches	109
	10 ga	High	Step Bits	Maximum hole size 1-3/8 inches	118 – 119
	10 ga	Medium	Hole Saws	Maximum hole size 6 inches	110 – 112
	Fiberglass/Plastic  	approx. 1/8"	Highest	Slug Splitter® Punches	Maximum durability and universal material usage Maximum hole size 4-1/2 inches
		SPEED PUNCH® Punches		Maximum hole size 4-1/2 inches	84 – 89
approx. 1/8"		High	Slug-Buster® Punches	Maximum hole size 2-3/8 inches	60 – 63, 66 – 71
approx. 1/8"		High	Standard Punches	Maximum hole size 6-3/8 inches	64 – 65, 72 – 73, 77
–		High	Ultra Cutters	Maximum hole size 2-1/2 inches	109
–		Medium-High	Step Bits	Maximum hole size 1-3/8 inches	118 – 119
1-5/8"		Medium	Hole Saws	Maximum hole size 6 inches	110 – 112
Drywall/Ceiling Tile 	7/8"	High	Recessed Light Hole Saws	Replaceable blades	117
	7/8"	Medium-Low	Quick Cutter	Adjustable or fixed, sprinkler heads or lighting	117
	7/8"	Medium	Keyhole Saw	Non-round holes	147
Quazite® Enclosures	–	High	Slug-Buster® Punches	–	60-63, 66-71
	Approx. 1/8"	High	Carbide-Grit Hole Saws	–	116
Cement Board/Hardy Board Siding	–	High	Carbide-Grit Hole Saws	–	116
Existing Wall	–	–	D'versibits®	Remodeling, phone, cable, alarm installation	125 – 127
Non-Round	–	High	Non-Round Punches	Square, rectangular, electronic connector holes	92 – 96
	–	Medium	Reciprocating Blades	–	131
Metal Studs	20 ga	–	Stud Punches	–	98 – 100

HOLE SAWS



628

One-Piece and Quick-Change Carbide-Tipped Hole Cutters

- Split-Point Cobalt Steel Pilot Drill with stepped design – for fast, accurate cutting with less force
- Tungsten Carbide Teeth – optimized design for fast, easy cutting and maximum life in stainless steel – no oil required
- Flange Stop – eliminates over-drilling
- Slug Ejector Spring – quick, easy slug removal
- Cuts round, burr-free holes
- Maximum cutting depth: 8 ga (4 mm)

One-Piece Carbide-Tipped Hole Cutters

- Strong, durable one-piece construction for even longer life

ONE-PIECE CARBIDE-TIPPED HOLE CUTTER SETS

CAT NO.	UPC NO.	DESCRIPTION
628	783310064008	6PC Carbide-Tipped Hole Cutter Set (7/8" – 2-1/2")
635	783310035992	3PC Carbide-Tipped Hole Cutter Set (7/8", 1-1/8", 1-3/8")

ONE-PIECE CARBIDE-TIPPED HOLE CUTTERS

HOLE SIZE		CONDUIT SIZE	PG/ ISO	MINIMUM CHUCK SIZE	CAT. NO.	SET CAT. NO.	
IN	mm					628	635
3/4	19.1	-	Pg 11	3/8	625-3/4	-	-
7/8	22.2	1/2"	Pg 16		625-7/8	X	X
1	25.4	-	ISO-25		625-1	-	-
1-1/8	28.6	3/4"	Pg 21		625-1-1/8	X	X
1-7/32	30.5	-	-		625-1-7/32	-	-
1-3/8	34.9	1"	-		625-1-3/8	X	X
1-1/2	38.1	-	-		625-1-1/2	-	-
1-3/4	44.4	1-1/4"	-		625-1-3/4	X	-
2	50.8	1-1/2"	ISO-50		625-2	X	-
2-1/2	63.5	2"	ISO-63		625-2-1/2	X	-
3	76.2	2-1/2"	-	1/2	625-3 N	-	-
3-5/8	92.1	3"	-		625-3-5/8 N	-	-
4-1/8	104.8	3-1/2"	-		625-4-1/8 N	-	-
4-1/2	114.3	4"	-		625-4-1/2 N	-	-

ONE-PIECE CARBIDE-TIPPED HOLE CUTTER REPLACEMENT PARTS

CAT NO.	UPC NO.	DESCRIPTION
R 625-001	783310398721	Small pilot drill for 3/4" – 2" cutters
R 625-002	783310383901	Large pilot drill for 2-1/2" -- 4-1/2" cutters
R 54274	783310542742	6 mm Set Screw for 3/4" – 2" cutters
R 54295	783310542957	8 mm Set Screw for 2-1/2" – 4-1/2" cutters
R 03581G	783310035817	3 mm hex key for 3/4" – 2" cutters
R 04743G	783310047438	4 mm hex key for 2-1/2" – 4-1/2" cutters
R 55225	783310552253	Ejector spring



648

Quick-Change Carbide-Tipped Hole Cutters

- Switch quickly between cutter sizes without re-chucking with a simple push and turn connection
- Split-Point Cobalt Steel Pilot Drill with step design – for fast, accurate cutting with less force
- Tungsten Carbide Teeth – optimized design for fast, easy cutting and maximum life in stainless steel – no oil required
- Flange Stop – eliminates over-drilling
- Slug Ejector Spring – quick, easy slug removal
- Cuts round, burr-free holes

QUICK-CHANGE CARBIDE-TIPPED HOLE CUTTER SETS

CAT NO.	UPC NO.	DESCRIPTION
648	783310064015	8PC Quick-Change Carbide-Tipped Hole Cutter Set (7/8" - 2-1/2")
660	783310057666	6PC Quick-Change Carbide-Tipped Hole Cutter Set (7/8" - 2")
655	783310058205	4PC Quick-Change Carbide-Tipped Hole Cutter Set (7/8", 1-1/8", 1-3/8")

QUICK-CHANGE CARBIDE-TIPPED HOLE CUTTERS

HOLE SIZE		CONDUIT SIZE	PG/ISO	MINIMUM CHUCK SIZE	CAT. NO.	SET CAT. NO.		
IN	mm					648	660	655
5/8	15.9	–	–	3/8"	645-5/8	–	–	–
11/16	17.4	–	Pg 16		645-11/16	–	–	–
3/4	19.1	–	Pg 11		645-3/4	–	–	–
13/16	20.6	–	Pg 13, ISO-20		645-13/16	–	–	–
7/8	22.2	1/2"	Pg 16		645-7/8	X	X	X
1	25.4	–	ISO 25		645-1	–	–	–
1-1/16	27.0	–	–		645-1-1/16	–	–	–
1-1/8	28.6	3/4"	Pg 21		645-1-1/8	X	X	X
1-7/32	30.5	–	–		645-1-7/32	–	–	–
1-1/4	31.8	–	–		645-1-1/4	–	–	–
1-5/16	33.3	–	Pg 32		645-1-5/16	–	–	–
1-3/8	34.9	1"	–		645-1-3/8	X	X	X
1-7/16	36.5	–	–		645-1-7/16	–	–	–
1-1/2	38.1	–	–		645-1-1/2	–	–	–
1-3/4	44.4	1-1/4"	–		645-1-3/4	X	X	–
2	50.8	1-1/2"	ISO-50		645-2	X	X	–
2-1/8	54.0	–	–		645-2-1/8	–	–	–
2-1/4	57.2	–	–		645-2-1/4	–	–	–
2-3/8	60.3	–	–	645-2-3/8	–	–	–	
2-1/2	63.5	2"	ISO-63	645-2-1/2	X	–	–	
2-5/8	66.7	–	–	645-2-5/8	–	–	–	
3	76.2	2-1/2"	–	645-3	–	–	–	
3-5/8	92.1	3"	–	645-3-5/8 N	–	–	–	
4-1/8	104.8	3-1/2"	–	645-4-1/8 N	–	–	–	
4-1/2	114.3	4"	–	645-4-1/2 N	–	–	–	
645-011	Small Quick-Change Arbor (for 5/8" - 2-1/4" cutters) with pilot drill, set screw and 3 mm hex key					X	X	X
645-022	Large Quick-Change Arbor (for 2-3/8" - 4-1/2" cutters) with pilot drill, set screw and 4 mm hex key					X	–	–



Quick-Change Carbide-Tipped Hole Cutters (Cont.)

QUICK-CHANGE CARBIDE-TIPPED HOLE CUTTER ACCESSORIES AND REPLACEMENT PARTS

CAT NO.	UPC NO.	DESCRIPTION
A 645-011	783310057529	Small Quick-Change Arbor
A 645-022	783310057536	Large Quick-Change Arbor
R 645-001	783310057611	Small pilot drill for 645-011 arbor
R 645-002	783310057628	Large pilot drill for 645-022 arbor
R 54274	783310542742	6 mm set screw for 645-011 arbor
R 04744G	783310047445	8 mm set screw for 645-022 arbor
R 03581G	783310035817	3 mm hex key for 645-011 arbor
R 04743G	783310047438	4 mm hex key for 645-022 arbor
R 55225	783310552253	Ejector spring

Ultra Cutters

- Lasts 10 times longer than standard hole saws
- Precision-ground teeth cut smooth, burr-free holes with ease
- Cut up to 1/4" (6.35 mm) mild steel
- Split-point helps eliminate "walking" and makes accurate hole placement easy
- No tool required to change cutter sizes
- Manufactured from high-speed steel



930

ULTRA CUTTERS SET

CAT NO.	UPC NO.	DESCRIPTION
930	783310102144	7/8" to 2-1/2" cutters, two small arbors, large arbor, hex wrench and case. For conduit sizes 1/2" through 2".

ULTRA CUTTERS

CAT NO.	UPC NO.	HOLE SIZE		CONDUIT	PG/ ISO	COPPER PIPE
		IN	mm			
925-7/8	783310101574	7/8	22.5	1/2"	Pg 16	5/8"
925-1-1/8	783310101581	1-1/8	28.6	3/4"	Pg 21	-
925-1-7/32	783310016434	1-7/32	30.5	-	-	-
925-1-3/8	783310101598	3/8	35.0	1"	-	-
925-1-3/4	783310101604	1-3/4	44.4	1-1/4"	-	1-1/2"
925-2	783310101611	2	50.8	1-1/2"	ISO-50	-
925-2-1/2	783310101628	2-1/2	63.5	-	ISO-63	2"

ARBORS AND PILOT DRILLS

CAT NO.	UPC NO.	DESCRIPTION
R 925-011	783310101635	Small Arbor with Pilot Drill for 7/8" to 1-7/32" Size Cutter
R 925-022	783310101857	Large Arbor with Pilot Drill for 1-3/8" to 2-1/2" Size Cutter
R 925-001	783310101864	Small Pilot Drill
R 925-002	783310102113	Large Pilot Drill

NOTE: To extend the life of your tool, see Cutting/Threading Oil on page 133.



925-1-3/4



830

Bi-Metal Hole Saws

- Cut through steel, tin, aluminum, fiberglass, wood and plastics
- 1-5/8" (41.3 mm) cutting depth allows for cutting through 2" thick wood studs
- Bi-metal blade with steam oxide finish – saw runs cooler, no pait to gum up and slow cutting means longer saw life and better performance
- Extra-thick backplate minimizes vibration for smoother and easier cutting

BI-METAL HOLE SAW SETS

CAT NO.	UPC NO.	DESCRIPTION
830	783310191926	9-Piece hole saw set with 7/8" – 2-1/2" saws
834	783310199137	5-Piece hole saw set with 3" – 4-1/2" saws
835	783310275381	13-Piece hole saw set with 7/8" – 4-1/2" saws
889	783310034780	9-Piece plumber's hole saw set with 3-3/4" – 2-1/4" saws
890	783310034797	19-Piece industrial maintenance hole saw set with 3/4" – 4-3/4" saws
891	783310034803	12-Piece hole saw set with 3/4" – 2-1/2" saws

Quick-Change Bi-Metal Hole Saws

- Quick-change option for quick assembly and removal of hole saws – works with any brand hole saw

QUICK-CHANGE BI-METAL HOLE SAW SET

CAT NO.	UPC NO.	DESCRIPTION
830Q	783310028062	9-piece quick-change hole saw set with 7/8" – 2-1/2" saws

ACCESSORIES

CAT NO.	UPC NO.	DESCRIPTION
02800	783310028000	5/16" Quick-Change arbor
02801	783310028017	7/16" Quick-Change arbor
02803	783310028031	Small adapter (10 pack)
02804	783310028048	Large adapter (3 pack)
02805	783310028055	Bushing (5 pack)

PARTS LIST

CAT. NO.	UPC NO.	DESCRIPTION	SET CAT. NO.						
			830	834	835	889	890	891	830Q
825-3/4	783310191346	3/4" Hole Saw	-	-	-	X	X	X	-
825-7/8	783310191360	7/8" Hole Saw	X	-	X	X	X	X	X
825-1	783310191384	1" Hole Saw	-	-	-	-	X	-	-
825-1-1/8	783310191414	1-1/8" Hole Saw	X	-	X	X	X	X	X
825-1-3/8	783310191469	1-3/8" Hole Saw	X	-	X	-	X	X	X
825-1-1/2	783310191483	1-1/2" Hole Saw	-	-	-	X	X	X	-
825-1-3/4	783310191520	1-3/4" Hole Saw	X	-	X	X	X	X	X
825-2	783310191551	2" Hole Saw	X	-	X	-	X	X	X
825-2-1/4	783310191599	2-1/4" Hole Saw	-	-	-	X	X	X	-
825-2-1/2	783310191629	2-1/2" Hole Saw	X	-	X	-	X	X	X
825-3	783310191674	3" Hole Saw	-	X	X	-	X	-	-
825-3-1/4	783310191698	3-1/4" Hole Saw	-	-	-	-	X	-	-
825-3-5/8	783310191728	3-5/8" Hole Saw	-	X	X	-	X	-	-
825-3-3/4	783310191742	3-3/4" Hole Saw	-	-	-	-	X	-	-
825-4-1/8	783310191773	4-1/8" Hole Saw	-	X	X	-	X	-	-
825-4-1/2	783310191803	4-1/2" Hole Saw	-	X	X	-	-	-	-
825-4-3/4	783310191810	4-3/4" Hole Saw	-	-	-	-	X	-	-
38522	783310385226	Arbor w/Pilot Drill	X	-	-	-	-	-	-
37157	783310371571	Arbor w/Pilot Drill	-	-	X	-	-	-	-
37155	783310371557	Arbor w/Pilot Drill	-	-	X	X	X	X	-
37156	783310371564	Arbor w/Pilot Drill	X	X	X	X	X	X	-
38526	783310385264	Pilot Drill	-	-	-	X	X	X	-
02801	783310028017	7/16" Quick-Change arbor	-	-	-	-	-	-	X



Bi-Metal Hole Saws

HOLE SIZE		CONDUIT	PG/ISO	COPPER PIPE	CAT. NO.	UPC. NO.	BULK CAT. NO.	BULK UPC. NO.	BULK QTY.	USE WITH STD. ARBOR NO.	USE WITH QUICK-CHANGE ARBOR NO.
IN	mm										
5/8	15.9	-	-	-	825-5/8	783310191322	-	-	-	37157, 37155, or 38522	02800*
11/16	17.5	-	ISO-16	3/8"	825-11/16	783310191339	-	-	-		
3/4	19.0	-	Pg 11	1/2"	825-3/4	783310191346	825B-3/4	783310298281	25		
7/8	22.2	1/2"	Pg 16	3/4"	825-7/8	783310191360	825B-7/8	783310298298	50		
1	25.4	-	ISO-25	-	825-1	783310191384	825B-1	783310034476	50		
1-1/8	28.6	3/4"	Pg 21	1"	825-1-1/8	783310191414	825B-1-1/8	783310298311	50		
1-1/4	31.7	-	-	-	825-1-1/4	783310191445	825B-1-1/4	783310034568	24		
1-5/16	33.3	-	ISO-32	-	825-1-5/16	783310191452	-	-	-		
1-3/8	35.0	1"	-	-	825-1-3/8	783310191469	825B-1-3/8	783310298328	24		
1-7/16	36.5	-	-	-	825-1-7/16	783310191476	-	-	-		
1-1/2	38.1	-	-	1-1/4"	825-1-1/2	783310191483	-	-	-	37156 or 37154	
1-5/8	41.3	-	ISO-40	-	825-1-5/8	783310191506	-	-	-		
1-3/4	44.4	1-1/4"	-	1-1/2"	825-1-3/4	783310191520	825B-1-3/4	783310298342	24		
1-7/8	47.6	-	-	-	825-1-7/8	783310191544	-	-	-		
2	50.8	1-1/2"	ISO-50	-	825-2	783310191551	825B-2	783310298359	24		
2-1/8	54.0	-	-	-	825-2-1/8	783310191582	825B-2-1/8	783310380313	24		
2-1/4	57.2	-	-	-	825-2-1/4	783310191599	825B-2-1/4	783310034575	24		
2-3/8	60.3	-	-	-	825-2-3/8	783310191612	825B-2-3/8	783310380344	24		
2-1/2	63.5	2"	ISO-63	-	825-2-1/2	783310191629	825B-2-1/2	783310298366	24		
2-9/16	65.1	-	-	-	825-2-9/16	783310191636	825B-2-9/16	-	20		
2-5/8	66.7	-	-	2-1/2"	825-2-5/8	783310191643	825B-2-5/8	783310380368	18	37156	
2-3/4	69.8	-	-	-	825-2-3/4	783310191650	-	-	-		
2-7/8	73.0	-	-	-	825-2-7/8	783310191667	-	-	-		
3	76.2	2-1/2"	-	-	825-3	783310191674	825B-3	783310298373	18		
3-1/4	82.5	-	-	3"	825-3-1/4	783310191698	-	-	-		
3-3/8	85.7	-	-	-	825-3-3/8	783310191704	-	-	-		
3-1/2	88.9	-	-	-	825-3-1/2	783310191711	825B-3-1/2	783310034582	18		
3-5/8	92.1	3"	-	-	825-3-5/8	783310191728	825B-3-5/8	783310298380	18		
3-3/4	95.2	-	-	3-1/2"	825-3-3/4	783310191742	825B-3-3/4	783310380450	10		
3-7/8	98.4	-	-	-	825-3-7/8	783310191759	-	-	-		
4	101.6	-	-	-	825-4	783310191766	825B-4	783310034698	10	37156	
4-1/8	104.8	3-1/2"	-	-	825-4-1/8	783310191773	-	-	-		
4-1/4	108.0	-	-	4"	825-4-1/4	783310191780	825B-4-1/4	783310380498	10		
4-3/8	111.1	-	-	-	825-4-3/8	783310191797	-	-	-		
4-1/2	114.3	4"	-	-	825-4-1/2	783310191803	825B-4-1/2	783310380511	10		
4-3/4	120.6	-	-	4-1/2"	825-4-3/4	783310191810	-	-	-		
5	127.0	-	-	-	825-5	783310191827	825B-5	783310380535	5		
5-1/2	139.7	-	-	5"	825-5-1/2	783310191834	825B-5-1/2	783310380542	5		
6	152.4	-	-	-	825-6	783310191841	825B-6	783310034810	5		

*See page 114 for Quick Change adapter information

Recommended Hole Saw Cutting Speeds

HOLE SAW SIZE		RPM			
IN	mm	Mild Steel	Cast Iron	Brass	Aluminum
9/16	14.3	577	407	781	883
5/8	15.9	519	367	703	794
11/16	17.5	472	333	639	722
3/4	19.1	433	306	586	662
13/16	20.6	400	282	541	611
7/8	22.2	371	262	502	567
15/16	23.8	346	244	468	530
1	25.4	325	229	439	496
1-1/16	27.0	306	216	413	467
1-1/8	28.6	289	204	390	441
1-3/16	30.2	273	193	370	418
1-1/4	31.8	260	183	351	397
1-5/16	33.3	247	175	335	378
1-3/8	34.9	236	167	319	361
1-7/16	36.5	226	159	306	345
1-1/2	38.1	216	153	293	331
1-9/16	39.7	208	147	281	318
1-5/8	41.3	200	141	270	306
1-11/16	42.9	192	136	260	294
1-3/4	44.5	185	131	251	284
1-13/16	46.0	179	126	242	274
1-7/8	47.6	173	122	234	265
2	50.8	162	115	220	248
2-1/16	52.4	157	111	213	241
2-1/8	54.0	153	108	207	234
2-1/4	57.2	144	102	195	221

HOLE SAW SIZE		RPM			
IN	mm	Mild Steel	Cast Iron	Brass	Aluminum
2-5/16	58.7	140	99	190	215
2-3/8	60.3	137	96	185	209
2-1/2	63.5	130	92	176	199
2-9/16	65.1	127	89	171	194
2-5/8	66.7	124	87	167	189
2.677	68.3	121	85	163	185
2-3/4	69.9	118	83	160	181
2-7/8	73.0	113	80	153	173
2.913	74.6	111	78	150	169
3	76.2	108	76	146	165
3-1/8	79.4	104	73	141	159
3-1/4	82.6	100	71	135	153
3-3/8	85.7	96	68	130	147
3-1/2	88.9	93	65	125	142
3-5/8	92.1	90	63	121	137
3-3/4	95.3	87	61	117	132
3-7/8	98.4	84	59	113	128
4	101.6	81	57	110	124
4-1/8	104.8	79	56	106	120
4-1/4	108.0	76	54	103	117
4-3/8	111.1	74	52	100	113
4-1/2	114.3	72	51	98	110
4-3/4	120.7	68	48	92	105
5	127.0	65	46	88	99
5-1/2	139.7	59	42	80	90
6	152.4	54	38	73	83

Arbors and Pilot Drill Bits

- The best arbor in the industry ensures a solid connection without any gaps or wobbling
- Arbors include replaceable, high-speed steel pilot drill
- Pilot drills have unique split-point tip design
- Use with Greenlee bi-metal hole saws, recessed light hole saws and carbide-grit hole saws (carbide-tipped pilot drill sold separately)
- Can be used with Greenlee #901 or #904 bit extensions



ARBORS

	CAT. NO.						
Standard Pack	37157	38522	37155	37154	37156	N/A	N/A
POP Pack	38507	38524	38505	38504	38506	02800	02801
Bulk Pack	37157B	38522B	37155B	37154B	37156B	N/A	N/A
Shank	-	Hex	Hex	Hex	Hex	Hex	Hex
Shank Size	1/4" (6.4 mm)	5/16" (7.9 mm)	7/16" (11.1 mm)	5/16" (7.9 mm)	7/16" (11.1 mm)	5/16" (7.9 mm)	7/16" (11.1 mm)
Min. Chuck Size	1/4" (6.4 mm)	3/8" (9.5 mm)	1/2" (12.7 mm)	3/8" (9.5 mm)	1/2" (12.7 mm)	3/8" (9.5 mm)	1/2" (12.7 mm)
Locking Collar	No	No	No	Yes	Yes	No	No
Use With	9/16" – 1-3/16" (14.3 – 30.2 mm) Hole Saws	9/16" – 1-3/16" (14.3 – 30.2 mm) Hole Saws	9/16" – 1-3/16" (14.3 – 30.2 mm) Hole Saws	1-1/4" – 2" (31.8 – 50.8 mm) Hole Saws	1-1/4" – 6" (31.8 – 152.4 mm) Hole Saws and all Greenlee Recessed Light Hole Saws	9/16" – 2" (14.3 – 50.8 mm)	9/16"-6" (14.3 – 152.4 mm)



PILOT DRILL BITS

	CAT. NO.	
Standard Pack Qty: 6 per pack	37623	38526
POP Pack	39873	39893
Bulk Pack Qty: 50 per pack	37623B	38526B
Length	4-1/8" (104.8 mm)	3-1/4" (82.5 mm)
Diameter	1/4" (6.4 mm)	1/4" (6.4 mm)
Use With Greenlee Arbor #'s	37154, 37155, 37156 & 37157	37154, 37155, 37156 & 38522

CARBIDE-TIPPED PILOT DRILL BITS

	CAT. NO.
Standard Pack	325-001
Length	4-1/8" (104.8 mm)
Diameter	1/4" (6.4 mm)
Use With Greenlee Arbor #'s	37157, 37155, 37156 & 37154

Bit Extensions

- Extend bit lengths – Hole saw arbors, spade bits, auger bits, and step bits
- Use for boring deeper into wood



BIT EXTENSIONS

CAT NO.	UPC NO.	LENGTH		HEX SHANK		HOLE DIAMETER		HEAD DIAMETER	
		IN	mm	IN	mm	IN	mm	IN	mm
901-12	783310027065	12	304.8	1/4	6.4	1/4	6.4	9/16	14.3
902-18	783310027072	18	457.2	5/16	7.9	23/64	9.1	21/32	16.7
902-24	783310027089	24	609.6	5/16	7.9	23/64	9.1	21/32	16.7
904H-12	783310349808	12	304.8	7/16	11.1	**	–	23/32	18.3
904H-18	783310353560	18	457.2	7/16	11.1	**	–	23/32	18.3
904H-24	783310353584	24	609.6	7/16	11.1	**	–	23/32	18.3
904H2-5-1/2	783310012665	5-1/2"	140.0	7/16"	11.1	–	–	–	–

**For 7/16" Hex or 1/2" Round with 3 Flats, 1/4" Wide

REPLACEMENT PARTS

CAT NO.	UPC NO.	DESCRIPTION
R 3713GB	783310509622	Set Screw for 901-12
R 3678GB	783310507536	Set Screw for 902-18 and 902-24
R 3693GB	783310507659	Set Screw for 904H-12, 904H-18 and 904H-24

Deburring Tool

- Cleans burrs from both sides of the hole in seconds
- Works with any hole size or shape 3/4" or larger
- Deburrs up to 10 ga mild and stainless steel, copper, brass, aluminum
- 5/16" Shank
- Run tool clockwise to deburr, counterclockwise to clear chips



CAT NO.	UPC NO.	DESCRIPTION
11170	783310111702	Deburring Tool
R 11180	783310111801	Cutter 3-pack

NOTE: To extend the life of your tool, see Cutting/Threading Oil on page 133.



725-1-3/8

Carbide-Grit Hole Saws

- Long-lasting tungsten carbide-grit delivers extremely clean, smooth cuts through tile, cement board, and other abrasive materials
- Perfect for cutting holes in Quazite® enclosure or hardy board siding for 3-0 box installation
- Rugged construction for enduring performance
- Use with Arbors listed on page 114

CARBIDE GRIT HOLE SAWS		HOLE SIZE		CONDUIT	PG /ISO
CAT NO.	UPC NO.	IN	mm		
725-7/8	783310100720	7/8	22.2	1/2"	Pg 16
725-1-1/8	783310100737	1-1/8	28.6	3/4"	Pg 21
725-1-3/8	783310100751	1-3/8	35.0	1"	-
725-1-3/4	783310100775	1-3/4	44.4	1-1/4"	-
725-2	783310100782	2	50.8	1-1/2"	ISO-50
725-2-1/2	783310100805	2-1/2	63.5	2"	ISO-63
725-3-5/8	783310100812	3-5/8	92.1	3"	-
725-4-1/8	783310106876	4-1/8	104.8	3-1/2"	-
725-4-1/2	783310018797	4-1/2	114.3	4"	-

PILOT DRILL

CAT NO.	UPC NO.	DESCRIPTION
725-001	783310100829	1/4" Carbide Tipped Pilot Drill



35712

Recessed Light Hole Saws

- Industry's only interchangeable replacement blades
- Strong durable back plate
- Cut up to 7/8" (22.2 mm) thick plywood, wood, acoustical tile and ceiling tile
- Use with a power drill
- Use with arbors listed on page 114

CAT NO.	UPC NO.	DIAMETER	USE FOR	BLADE CAT NO.	BLADE UPC NO.
35712G	783310357124	4-3/8" (111 mm)	Mini Juno, and Capri	35720G R	783310357209
35728G	783310357285	5-3/8" (137 mm)	Capri, Juno, Lightolier, Progress and Precolite	35730G R	783310357308
35713	783310357131	6-3/8" (162 mm)	Halo and Capri	35721 R	783310357216
35714	783310357148	6-5/8" (168 mm)	Juno and Progress	35722 R	783310357223
35715	783310357155	6-7/8" (175 mm)	Lithonia and Marco	35723 R	783310357230

REPLACEMENT PARTS

CAT NO.	UPC NO.	DESCRIPTION
R 35708	783310357087	Set of 5 Blade Screws



06923

Quick Cutter™ Hole Saws

- Most affordable way to cut clean, precise holes in ceiling tile to help ensure proper fitting installations
- Self-sharpening, carbide-sprayed cutting tips can cut dozens of holes in very abrasive materials and still stay sharp
- Stabilizer spring balances cutting forces and offers more control of the tool when drilling drywall
- 5/16" shank that can be used with a cordless drill
- Included dust shield helps eliminate flying dust and debris

CAT NO.	UPC NO.	DESCRIPTION
06923	783310069232	Quick Cutter Recessed Hole Saw, Adjustable in 1/2" Increments for Cuts of 2-1/2" to 7"

STEP BITS



Step Bits

- Split-point tip - for quick penetration and easy, more accurate drilling
- Dual-flute design - two cutting edges help drill faster with less force
- Steam oxide finish - runs cooler and extends the life of the bit
- 3/8" hex shank
- XT Cobalt step bits are made from cobalt high speed steel for maximum life in stainless steel
- XT Cobalt step bits are capable of cutting up through 10 ga stainless steel, mild steel, copper, brass, aluminum, wood, plastic and laminates
- Kwik Stepper® step bits are capable of cutting up through 3/8" (9.5 mm) mild steel, copper, brass, aluminum, wood, plastic and laminates

XT COBALT STEP BIT SET

CAT NO.	UPC NO.	DESCRIPTION
35884C	783310057932	3-piece XT Cobalt Sep Bit Set – 1/2", 7/8", 1-1/8"

KWIK STEPPER® STEP BIT SETS

CAT NO.	UPC NO.	DESCRIPTION
35884	783310358848	3-piece Kwik Stepper® Step Bit Set – 1/2", 7/8", 1-1/8"
03607	783310036074	2-piece Kwik Stepper® Step Bit Set – 1/2", 7/8"



POWER TOOL ACCESSORIES

STEP BITS

CAT NO.	UPC NO.	BULK QTY. CAT NO. (QTY: 25)	BULK QTY. UPC NO.	DESCRIPTION	SET CAT. NO.		
					35884	03607	35884C
34401C	783310057895	-	-	1/2" XT Cobalt Step Bit with 13 sizes – 1/8", 5/32", 3/16", 7/32", 1/4", 9/32", 5/16", 11/32", 3/8", 13/32", 7/16", 15/32", 1/2"	-	-	X
34403C	783310057901	-	-	7/8" XT Cobalt Step Bit with 12 sizes – 3/16", 1/4", 5/16", 3/8", 7/16", 1/2", 9/16", 5/8", 11/16", 3/4", 13/16", 7/8"	-	-	X
30008C	783310057925	-	-	7/8" XT Cobalt Step Bit with 3 sizes – 1/2", 4/8", 1-1/8"	-	-	X
34410	783310344100	-	-	1/2" Kwik Stepper® Step Bit	X	X	
34401	783310344018	-	-	1/2" Kwik Stepper® Step Bit with 13 sizes – 1/8", 5/32", 3/16", 7/32", 1/4", 9/32", 5/16", 11/32", 3/8", 13/32", 7/16", 15/32", 1/2"	-	-	-
36402	783310364023	-	-	1/2" Kwik Stepper® Step Bit with 6 sizes – 3/16", 1/4", 5/16", 3/8", 7/16", 1/2"	-	-	-
30005	783310300052	-	-	13/16" Kwik Stepper® Step Bit with 11 sizes – 3/16", 1/4", 5/16", 3/8", 7/16", 1/2", 9/16", 5/8", 11/16", 3/4", 13/16"	-	-	-
34411	783310344117	-	-	7/8" Kwik Stepper® Step Bit	-	-	-
34403	783310344032	34403-B	783310015017	7/8" Kwik Stepper® Step Bit with 12 sizes – 3/16", 1/4", 5/16", 3/8", 7/16", 1/2", 9/16", 5/8", 11/16", 3/4", 13/16", 7/8"	X	X	-
30008	783310300083	30008-B	783310015000	7/8" Kwik Stepper® Step Bit with 3 sizes – 1/2", 4/8", 1-1/8"	X	-	-
36414	783310364146	36414-B	783310015024	1-3/8" Kwik Stepper® Step Bit with 6 sizes – 7/8", 1-1/8", 30.5 mm, 1-7/32", 1-1/4", 1-3/8"	-	-	-
36018G	783310360186	-	-	9.7 mm Kwik Stepper® Step Bit	-	-	-
36020	783310360209	-	-	30.5 mm Kwik Stepper® Step Bit with 8 sizes – 9.7 mm, 12.5 mm, 15.2 mm, 18.6 mm, 20.4 mm, 22.5 mm, 28.3 mm, 30.5 mm	-	-	-
36022	783310360223	-	-	32.5 mm Kwik Stepper® Step Bit with 4 sizes – 16.2 mm, 20.4 mm, 25.4 mm, 32.5 mm	-	-	-

DRILL/TAP BITS



DTAPKIT

Drill/Tap Bits

- Quickly drill, tap and countersink in one operation
- Tap holes up to 4X faster than traditional methods*
- One-piece Drill/Tap design ensures proper hole for tap size
- Split-tip resists walking and drills fast
- Back-taper prevents thread damage
- Drill and tap up to 1/8" mild steel, copper, brass, aluminum
- Hardened high-speed steel construction
- Fast, secure 1/4" quick-change hex shank
- Quick-change adapter included in all kits
- Most common coarse and fine thread available

DRILL/TAP BIT SETS

CAT NO.	UPC NO.	DESCRIPTION
DTAPKIT	783310176206	6-32 to 1/4-20 6-Piece Drill Tap Set
DTAPKITM	783310121510	Metric, M3-M10 6-Piece Drill/Tap Set



DTAP1/4-20

STANDARD DRILL/TAP BITS

CAT NO.	UPC NO.	DESCRIPTION	DTAPKIT
DTAP6-32	783310176114	6-32NC Drill/Tap Bit	X
DTAP8-32	783310176121	8-32NC Drill/Tap Bit	X
DTAP10-24	783310176138	10-24NC Drill/Tap Bit	X
DTAP10-32	783310176145	10-32NF Drill/Tap Bit	X
DTAP12-24	783310176152	12-24NC Drill/Tap Bit	X
DTAP1/4-20	783310176169	1/4-20NC Drill/Tap Bit	X
DTAP5/16-18	783310116271	5/16-18NC Drill/Tap Bit	-
DTAP3/8-16	783310116288	3/8-16NC Drill/Tap Bit	-



DRILL



TAP



COUNTERSINK

METRIC DRILL/TAP BITS

CAT NO.	UPC NO.	DESCRIPTION	DTAPKITM
DTAPM3C	783310121602	M3 X 0.50 Drill/Tap Bit	X
DTAPM4C	783310121619	M4 X 0.70 Drill/Tap Bit	X
DTAPM5C	783310121626	M5 X 0.80 Drill/Tap Bit	X
DTAPM6C	783310121633	M6 X 1.00 Drill/Tap Bit	X
DTAPM8C	783310121640	M8 X 1.25 Drill/Tap Bit	X
DTAPM10C	783310121657	M10 X 1.50 Drill/Tap Bit	X

*When compared to standard drill, tap, and countersink tools. *For best results, use Greenlee cutting oil with Drill/Tap bits. Always reverse drill rotation when backing bit out of hole. For material thicker than 1/4 ; stop and reverse drill to clear chips mid-way through tapping process.



DDKIT-1-68

Electrician's Drill/Driver Set

- 1/4" Quick Change technology
- Professional grade driver bits
- Titanium Nitride coated self-centering high speed drill bits
- High quality shock resistant case stays intact even after accidental drops
- Hammer drill rated carbide grade tips and hardened shank masonry drill bits
- Hardened forged magnetic nut drivers fit most TapCon® fasteners
- Quick release chuck for easy and precise fit
- Includes security bits that fit most security fasteners frequently used in public facilities

SPECIFICATIONS

Length	12.32" (313 mm)
Width	10.75" (273 mm)
Height	1.95" (49 mm)
Weight	2.35 lb (1.06 kg)

CAT NO.	UPC NO.	DESCRIPTION
DDKIT-1-68	783310263135	68-Piece Electrician's Drill/Driver Kit

AUGER BITS



Auger Bits

- Patented, self-feeding screw point tip draws the bit completely through the wood – no need to push the bit while drilling
- Design/Cutting Edge feature
- Over-center flude design for fast chip evacuation – no clogging or chip flyback
- Made from hardened carbon alloy steel for durability and longer life
- 7/16" hex shank with quick-change groove for impact drivers
- Nail Eater® design with patented cutting edge cuts nails and staples
- Nail Eater® bits made in the USA
- See "Bit Extensions" if more length is required (see page 115)



Nail Eater® Extreme

- 7-5/8" (5" twist) and 18" (15" twist) lengths available

NAIL EATER® EXTREME

CAT. NO.	UPC NO.	BULK CAT. NO.	BULK UPC NO.	BULK QTY.	HOLE DIA.		HEX SHANK	
					IN	mm	IN	mm
66PT-1/2	783310309154	–	–	–	1/2	12.7	5/16	7.9
66PT-5/8	783310309192	–	–	–	5/8	15.9	7/16	11.1
66PT-11/16	783310309215	–	–	–	11/16	17.5	7/16	11.1
66PT-3/4	783310309239	66PT-B-3/4	783310366591	24	3/4	19.1	7/16	11.1
66PT-13/16	783310020066	–	–	–	13/16	20.6	7/16	11.1
66PT-7/8	783310309277	66PT-B-7/8	783310366621	24	7/8	22.2	7/16	11.1
66PT-15/16	783310309291	–	–	–	15/16	23.8	7/16	11.1
66PT-1	783310309314	66PT-B-1	783310366645	24	1	25.4	7/16	11.1
66PT-1-1/8	783310309352	–	–	–	1/8	28.6	7/16	11.1
66PT-1-1/4	783310309376	–	–	–	1-1/4	31.8	7/16	11.1

SHORT NAIL EATER® EXTREME

CAT. NO.	UPC NO.	BULK CAT. NO.	BULK UPC NO.	BULK QTY.	HOLE DIA.		HEX SHANK	
					IN	mm	IN	mm
62PTS-5/8	783310317883	–	–	–	5/8	15.9	7/16	11.1
62PTS-11/16	783310317906	–	–	–	11/16	17.5	7/16	11.1
62PTS-3/4	783310317920	62PTS-B-3/4	783310366409	12	3/4	19.1	7/16	11.1
62PTS-13/16	783310317944	–	–	–	13/16	20.6	7/16	11.1
62PTS-7/8	783310317968	62PTS-B-7/8	783310366423	12	7/8	22.2	7/16	11.1
62PTS-1	783310317982	62PTS-B-1	783310366430	12	1	25.4	7/16	11.1
61/62PTS-1-1/8	783310304319	–	–	–	1-1/8	28.6	7/16	11.1
61/62PTS-1-1/4	783310304333	–	–	–	1-1/4	31.8	7/16	11.1



66RT-7/8

Nail Eater® RT

- No need to resharpen with the quick-change replaceable cutting edge and self-feed screw point tip

CAT NO.	UPC NO.	DESCRIPTION
66RT-7/8	783310125556	Auger Bit 7/8" x 18
66RT-1	783310125563	Auger Bit 1" x 18
63RT-7/8	783310125587	Auger Bit 7/8" x 8-5/8
63RT-1	783310125594	Auger Bit 1" x 8-5/8
PTR-7/8	783310125617	Replacement Tip 7/8"
PTR-1	783310125624	Replacement Tip 1"



37868

37868



Nail Eater® Extreme Impact Bits

- Quickly bore through creosoted and salt-treated utility poles

NAIL EATER® EXTREME

CAT NO.	UPC NO.	HARDWARE DIAMETER		HOLE DIAMETER		OVERALL LENGTH		HEX SHANK	
		IN	mm	IN	mm	IN	mm	IN	mm
37868	783310378686	9/16	14.3	5/8	15.9	18	457.2	7/16	11.1
37869	783310378693	11/16	17.5	3/4	19.1	18	457.2	7/16	11.1
37870G	783310378709	13/16	20.6	7/8	22.2	18	457.2	7/16	11.1
37871	783310378716	15/16	23.8	1	25.4	18	457.2	7/16	11.1



66TF-9/16

66TF-13/16



Nail Eater® Extreme Black Utility Auger Bits

- Teflon® coating resists heat and friction for fast and smooth operation

NAIL EATER® EXTREME BLACK UTILITY AUGER BITS

CAT NO.	UPC NO.	HARDWARE DIAMETER		HOLE DIAMETER		OVERALL LENGTH		HEX SHANK	
		IN	mm	IN	mm	IN	mm	IN	mm
66TF-9/16	783310020042	9/16	14.3	5/8	15.9	18	457.2	7/16	11.1
66TF-11/16	783310020059	11/16	17.5	3/4	19.1	18	457.2	7/16	11.1
66TF-13/16	783310020066	13/16	20.6	7/8	22.2	18	457.2	7/16	11.1
66TF-15/16	783310020073	15/16	23.8	1	25.4	18	457.2	7/16	11.1

Long Auger Bits

- Quickly and easily drill clean holes through salt-treated utility poles
- Cutting edge can be re-sharpened multiple times and continues to self feed
- Not a Nail Eater® – should not be used in wood with nails or other hard objects



70PT-11/16



70PT-13/16



70PT-15/16

CAT NO.	UPC NO.	DESCRIPTION
70PT-11/16	783310110972	11/16" x 24" Impact Auger Wood Bit
71PT-11/16	783310111009	11/16" x 30" Impact Auger Wood Bit
70PT-13/16	783310110989	13/16" x 24" Impact Auger Wood Bit
71PT-13/16	783310111016	13/16" x 30" Impact Auger Wood Bit
70PT-15/16	783310110996	15/16" x 24" Impact Auger Wood Bit
71PT-15/16	783310111023	15/16" x 30" Impact Auger Wood Bit

D'VersiBIT® FLEXIBLE INSTALL BITS

D'VersiBIT® System

- Drill and fishwire or cable through existing walls
- Flexible steel shaft will bend in the direction you want to drill
- Bits range from 3/8" to 1" (9.5 to 25.4 mm) in diameter and in shaft length from 54" and 72" (1372 to 1828.8 mm)



Type A, Auger



- Wood-type auger bit with screw point
- Pulls itself through wood, avoids walking or skidding
- Excellent for drilling in soft woods or through thin sections
- Slow back-taper allows for easy retrieval

Type B, Combination with Screw Point



- For aggressive chip removal in many types of woods
- Screw point for easy starting and pulling through wood
- With screw point removed, this bit can be ground to function like a standard combination bit

BIT DIAMETER IN (mm) COLOR CODE	SHAFT LENGTH		SHAFT DIAMETER		TYPE A AUGER		TYPE B COMBINATION WITH SCREW POINT	
	IN	cm	IN	mm	CAT. NO.	UPC NO.	CAT. NO.	UPC NO.
3/8" (9.5 mm) Black	54	137.16	3/16	4.8	06-03-54A	783310380689	06-03-54B	783310380931
	72	182.88	3/16	4.8	06-03-72A	783310380696	06-03-72B	783310380948
1/2" (12.7 mm) Green	54	137.16	3/16	4.8	08-03-54A	783310380733	08-03-54B	783310380986
	72	182.88	3/16	4.8	08-03-72A	783310380740	08-03-72B	783310380993
9/16" (14.3 mm) Orange	54	137.16	3/16	4.8	09-03-54A	783310380788	09-03-54B	783310381037
	72	182.88	3/16	4.8	09-03-72A	783310380795	09-03-72B	783310381044
3/4" (19.1 mm) Red	54	137.16	1/4	6.4	12-04-54A	783310380832	-	-
	72	182.88	1/4	6.4	12-04-72A	783310380849	-	-
1" (25.4 mm) White	54	137.16	1/4	6.4	16-04-54A	783310380887	-	-
	72	182.88	1/4	6.4	16-04-72A	783310380894	-	-



DBITKIT

D'VersiBIT® Starter Kit

- All the tools to complete a typical wiring job
- Includes 09-03-54B bit, 712P placement tool and 150 pulling grip



CAT NO.	UPC NO.	DESCRIPTION
DBITKIT	783310122784	D'VersiBIT® Kit with 9/16" Bit, Placement Tool and Grip for Pulling 1/2" OD Wire

Extensions

- Connect to chuck end of D'VersiBIT® shaft to increase the length of the bit



CAT NO.	UPC NO.	CONNECTING END DIA.	SHAFT DIA.	LENGTH
3XT-54	783310386865	7/16" (11.1 mm)	3/16" (4.8 mm)	54" (1371.6 mm)
4XT-54	783310386896	5/8" (15.9 mm)	1/4" (6.4 mm)	54" (1371.6 mm)

CAT NO.	UPC NO.	DESCRIPTION
 54333	783310543336	Screws for 3XT
 3678GB	783310507536	Screws for 4XT



Placement Tool

- Allows placement of the drill bit at any point within the wall
- Useful for vertical and horizontal placements

CAT NO.	UPC NO.	DESCRIPTION
712P	783310383505	D'VersiBIT® Placement Tool



Wire and Cable Pulling Grips

- Grip can attach to standard D'Versibit® or to any standard 1/4" Quick-Connect adapter for pulling wire, cable or fish tape through walls
- Swivel design reduces twisting
- Mesh design holds wire or cable during pull
- 100 lb pulling force capacity

CAT NO.	UPC NO.	DESCRIPTION
125Q	783310127918	Quick Change Grip for Pulling Single Wire with 3/8" to 1/2" (9.5 mm to 12.7 mm).
150Q	783310127925	Quick Change Grip for Pulling 1/2" (12.7 mm) OD Wire with 1/2" to 9/16" (12.7 to 14.3 mm).
168Q	783310127932	Quick Change Grip for Pulling 3/4" (19.1 mm) OD Wire with 3/4" to 1" (19.1 to 25.4 mm)



Quick Change D'VersiBIT® System Kit

- Flexible shaft allows easy access to difficult and tight areas
- Convenient 1/4" quick connect receiver accepts most standard quick change accessories
- Multiple extensions can be easily joined to create the perfect length for any job
- Capacity: Any 1/4" quick change accessory 3/4" diameter and under

QUICK-CHANGE D'VeRSIBIT® SETS

CAT NO.	UPC NO.	DESCRIPTION
941	783310313885	Quick-Change D'VersiBIT® Set, 1/4" shaft
921	783310124115	Quick-Change D'VersiBIT® Set, 3/16" shaft

QUICK-CHANGE EXTENSIONS

CAT NO.	UPC NO.	SHAFT LENGTH	SHAFT DIAMETER	941	921
921-18	783310124139	18"	3/16"	-	X
921-36	783310124153	36"	3/16"	-	X
941-18	783310313908	18"	1/4"	X	-
941-36	783310313892	36"	1/4"	X	-

GRIPS

CAT NO.	UPC NO.	SIZE	CAPACITY	941	921
125Q	783310127918	3/8"	100 lb	-	-
150Q	783310127925	1/2"	100 lb	X	X
168Q	783310127932	3/4"	100 lb	-	-

AUGER BITS

CAT NO.	UPC NO.	HOLE SIZE	941	921
60A-3/4	783310124177	3/4"	X	X
60A-7/8	783310124184	7/8"	-	-
60A-1	783310105381	1"	-	-

PLACEMENT TOOL

CAT NO.	UPC NO.	941	921
712P	783310383505	X	-



941

SPADE BITS



33AR-6

Spade Bits

- Bore hardwood, softwood, plywood and drywall
- Hole in top center of bit for wire pulling
- Forged and heat treated for long life
- 1/4" Quick change hex shank
- See "Bit Extensions" (page 115) if more length required

SPADE BIT SET

CAT NO.	UPC NO.	DESCRIPTION
33AR-6	783310203643	6-Piece Spade Bit Set, 3/8" - 1"

33A SPADE BITS – LENGTH 6-1/4" (158.8 mm)

CAT NO.	UPC NO.	HOLE DIAMETER		SET CAT. NO.
		IN	mm	33AR-6
33A-1/2	783310203483	1/2	12.7	X
33A-5/8	783310203506	5/8	15.9	X
33A-3/4	783310203520	3/4	19.1	X
33A-7/8	783310203544	7/8	22.2	X
33A-1	783310203575	1	25.4	X
33A-1-1/8	783310203582	1-1/8	28.6	-
33A-1-1/2	783310203612	1-1/2	38.1	-

33L SPADE BITS – LENGTH 16" (406.4 mm)

CAT NO.	UPC NO.	HOLE DIAMETER	
		IN	mm
33L-3/8	783310315360	3/8	9.5
33L-1/2	783310315377	1/2	12.7
33L-5/8	783310315391	5/8	15.9
33L-3/4	783310315407	3/4	19.1
33L-7/8	783310315414	7/8	22.2
33L-1	783310315421	1	25.4



34AR-6

Self-Feeding Spade Bits

- Innovative self-feeding design requires less effort and reduces vibration
- Unique tapered design allows existing hole enlargement

SELF-FEEDING SPADE BIT SET

CAT NO.	UPC NO.	DESCRIPTION
34AR-6	783310037101	6-Piece Self-Feeding Spade Bit Set, 3/8" - 1"

34A SPADE BITS – LENGTH 6-1/4" (158.8 mm)

CAT NO.	UPC NO.	HOLE DIAMETER	
		IN	mm
34A-3/8	783310037118	3/8	9.5
34A-1/2	783310037125	1/2	12.7
34A-5/8	783310037132	5/8	15.9
34A-3/4	783310037149	3/4	19.1
34A-7/8	783310037156	7/8	22.2
34A-1	783310037163	1	25.4



149H2KIT

E-Z Bore® Self-Feed Bits Set

- Double-end replaceable screw point. Choose the right feed for the material you are drilling. Fine thread for hardwoods, coarse thread for fast, effortless drilling even in soft, gummy woods
- Tapered backside for easier removal
- Open dual-flute design for faster chip evacuation
- Heavy-duty 7/16" three-flat shank

E-Z BORE® SELF-FEED BIT SET

CAT NO.	UPC NO.	DESCRIPTION
149H2KIT	783310012733	E-Z Bore® set with 1" to 2-3/4"



149H2-1-3/8

E-Z BORE® SELF-FEED BITS

HOLE DIAMETER		PIPE & CONDUIT SIZE			LENGTH		SET CAT. NO.
IN	mm				IN	mm	149HZKIT
1"	25.4	1/2"	149H2-1	783310012474	5"	127.0	X
1-1/8"	28.6	1/2"	149H2-1-1/8	783310012504	5"	127.0	X
1-1/4"	31.8	3/4"	149H2-1-1/4	783310012498	5"	127.0	X
1-3/8"	34.9	3/4"	149H2-1-3/8	783310012528	5"	127.0	-
1-1/2"	38.1	1"	149H2-1-1/2	783310012481	5"	127.0	X
1-3/4"	44.4	1-1/4"	149H2-1-3/4	783310012511	5"	127.0	X
2"	50.8	1-1/4"	149H2-2	783310012573	5"	127.0	-
2-1/8"	54	1-1/2"	149H2-2-1/8	783310012603	5"	127.0	X
2-1/4"	57.2	1-1/2"	149H2-2-1/4	783310012580	5"	127.0	-
2-9/16"	65.1	2"	149H2-2-9/16	783310012610	5"	127.0	X
3"	76.2	2-1/2"	149H2-3	783310012627	5"	127.0	-
3-5/8"	92.1	3"	149H2-3-5/8	783310012634	6-1/4"	158.8	-
4-5/8"	117.5	4"	149H2-4-5/8	783310012726	6-1/4"	158.8	-

REPLACEMENT PARTS

CAT NO.	UPC NO.	DESCRIPTION	SCREW POINT DIA.		LENGTH	
			IN	mm	IN	mm
R 149H2-1/4	783310012542	Screw Point	1/4"	6.4	2"	50.8
R 149H2-3/8	783310012719	Screw Point	3/8"	9.5	2-3/4"	69.9

RECIPROCATING SAW BLADES



BI-METAL BLADES

- Greenlee blades feature improved bi-metal material with added cobalt for increased toughness, durability and blade life
- Precision cutting teeth are designed to stay sharp and cut fast, saving valuable time on the job
- Available in a variety of blade types for cutting wood, nail embedded wood, metal, and other demanding construction materials

Reciprocating Saw Blades

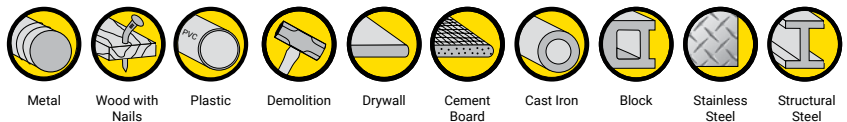

	CAT. NO.	LENGTH x WIDTH x THICKNESS IN / mm	MATERIAL	QTY/ PK	TEETH PER IN	SPEED AND QUALITY OF CUT
BI-METAL						
NOTE: Minimum blade length = Material width + 3"						
	353-624	6 x 3/4 x .035 / 152 x 19 x .9	BETTER for sheet metal (1/8" and less)	5	24T	
	353-818	8 x 3/4 x .035 / 203 x 19 x .9	BETTER for thin metal (1/16" - 3/16")	5	18T	
	353-618	6 x 3/4 x .035 / 152 x 19 x .9	BETTER for thin metal (1/16" - 3/16")	5	18T	
	353-814	8 x 3/4 x .050 / 203 x 19 x 1.3	BETTER for medium metal (3/32" - 3/8")	5	14T	
	353-614	6 x 3/4 x .035 / 152 x 19 x .9	BETTER for medium metal (3/32" - 3/8")	5	14T	
	353-110	12 x 3/4 x .050 / 305 x 19 x 1.3	BETTER for general purpose	5	10/14T	
	353-123	6 x 3/4 x .035 / 152 x 19 x .9	BETTER for general purpose	5	8/18T	
	353-969	9 x 7/8 x .063 / 229 x 22 x 1.6	BEST for demolition projects	5	8/10T	
	353-646	6 x 3/4 x .050 / 152 x 19 x 1.3	BETTER for clean wood and wood with nails	5	6T	
	353-656	6 x 3/4 x .050 / 153 x 19 x 1.3	BETTER for clean wood and wood with nails (plunge cutting)	5	6T	
	353-956	9 x 3/4 x .050 / 229 x 19 x 1.3	BETTER for clean wood and wood with nails (plunge cutting)	5	6T	
	353-156	12 x 3/4 x .050 / 305 x 19 x 1.3	BETTER for clean wood and wood with nails (plunge cutting)	5	6T	

ANCHORS AND FASTENERS



Screw Anchor Expanders for Calk-In™ Style Anchors

- Quickly and securely set expansive screw anchors in masonry, regardless of thickness
- Hardened alloy steel

SCREW ANCHOR EXPANDERS

CAT NO.	UPC NO.	EXPANSIVE BOLT SIZE	USE WITH ANCHOR NO.
866	783310026679	#10 – 24	84299
868	783310026693	1/4" – 20	84299
870	783310026716	3/8" – 16	84305

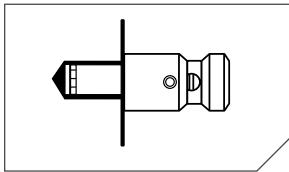

1. Drill hole of required size and put anchor screw on expander. Insert screw anchor into drilled hole.

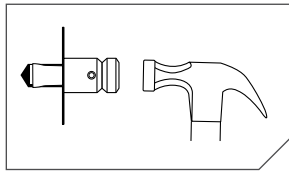

2. Strike head of expander with hammer or mallet until anchor is held securely in wall. Unscrew expander.

REPLACEMENT PARTS

CAT NO.	UPC NO.	DESCRIPTION
4451AV	783310051916	Anchor Screw for 866
4457AV	783310051978	Anchor Screw for 868
4717AV	783310053002	Anchor Screw for 870
1125GB	783310504238	Roll Pin 1/4" x 1-1/8"

Machine Screw Anchors

- Zinc alloy and lead anchor can be set flush or subset. Greenlee setting tool required
- Rustproof, use interior or exterior
- For setting in hollow block or for setting anchors at same depth, use Greenlee screw anchor expander



CAT. NO.	UPC NO.	THREAD SIZE	REQ. HOLE		QTY. PER BOX	WORKING LOAD PULLOUT	
			DIA.	MIN. DEPTH		LB	KG
84299	783310842996	1/4"-20	1/2"	7/8"	100	125	56.6
84305	783310843054	3/8"-16	3/4"	1-1/4"	50	312.5	141.6

*One Setting Tool included with each box of anchors. Approvals: Conforms to the description in Federal Specification FFS-325, Group I, Type 1, Class 1.

NOTE: Working load is one fourth the ultimate/maximum capacity. For critical or unusual applications, site testing is recommended.

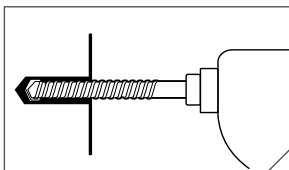

1. Drill hole in masonry.

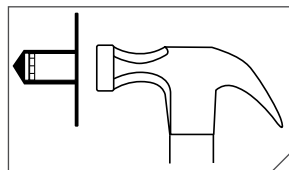

2. Insert anchor, conical end first, until flush with surface.

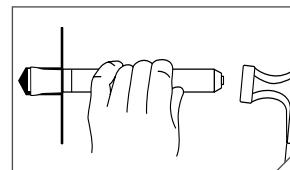

3. Using setting tool, caulk lead outer sleeve with sharp blows. Position fixture.

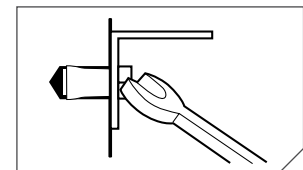

4. Insert screw or bolt and tighten.

Plastic Conical Anchors



- Light-duty, multi-size anchor for use in concrete, block, tile and brick
- Use with sheet metal, wood and lag screws
- Has collar for hollow materials
- Moisture and chemical resistant, for indoor/outdoor use
- Anchor kits include 100 anchors, 100 screws and one masonry bit

ANCHOR KITS

CAT. NO.	UPC NO.	ANCHOR SIZE	SCREW SIZE	TYPE	BIT SIZE
84012	783310840121	#10, #12	#10 x 1"		1/4"
84019	783310840190	#10, #12	#10 x 1"		1/4"

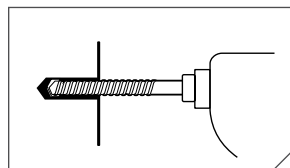

1. Drill hole full length of anchor or 1/8" deeper.

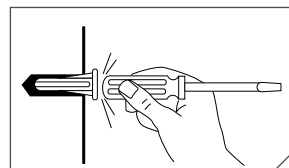

2. Tap anchor into hole flush with surface.

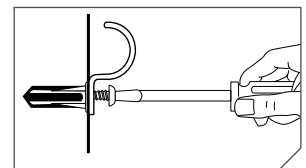

3. Insert screw through fixture into plastic plug and tighten.

Cutting/Threading Oil

- Premium quality, high lubricity for easier cutting and long tool life
- Choice of light or dark



SPECIFICATIONS

CAT. NO.	SIZE	WEIGHT
462-Q, 463-Q	1 Qt. (.9 l)	2.3 lb (1 kg)
462-1, 463-1	1 Gal. (3.8 l)	8.7 lb (4 kg)

CAT NO.	UPC NO.	DESCRIPTION
462-Q	783310282372	Dark Cutting/Threading Oil – 1 Qt.
462-1	783310260967	Dark Cutting/Threading Oil – 1 Gal
463-Q	783310282389	Light Cutting/Threading Oil – 1 Qt
463-1	783310282396	Light Cutting/Threading Oil – 1 Gal

Calk-In is a trademark of Powers Fasteners, Inc.
 Quazite is a registered trademark of Hubbell Inc.
 TapCon is a registered trademark of Illinois Tool Works Inc.
 Teflon is a registered trademark of E.I. DuPont de Nemours and Company