

7108 L CAP

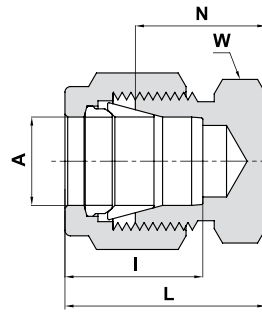

CAPPING END OF TUBE (METRIC)

Ordering Information	A Tube O.D.		W Hex. Flat	N		L		I	
	inch	mm	mm	inch	mm	inch	mm	inch	mm
7108L_2		2	12	.53	13.5	.92	20.1	.51	12.9
7108L_3		3	12	.53	13.5	.92	20.1	.51	12.9
7108L_4		4	12	.57	14.7	.98	21.3	.54	13.7
7108L_6		6	14	.63	15.7	1.06	23.1	.60	15.3
7108L_8		8	15	.69	17.0	1.14	24.5	.65	16.2
7108L_10		10	18	.75	19.0	1.22	26.6	.70	17.2
7108L_12		12	22	.79	19.0	1.28	29.1	.74	22.8
7108L_14		14	24	.83	19.8	1.34	29.9	.78	24.4
7108L_15		15	24	.83	19.8	1.34	29.9	.78	24.4
7108L_16		16	24	.83	19.8	1.34	29.9	.78	24.4
7108L_18		18	27	.89	21.3	1.42	31.4	.83	24.4
7108L_20		20	30	.93	23.9	1.48	34.0	.87	26.0
7108L_22		22	30	.93	23.9	1.48	34.0	.87	26.0
7108L_25		25	35	.99	26.2	1.56	38.5	.93	31.3
7108L_38		*38	55	1.14	37.8	1.81	65.4	1.08	49.4

CAPPING END OF TUBE (INCH)

Ordering Information	A Tube O.D.		W Hex. Flat	N		L		I	
	inch	mm	inch	inch	mm	inch	mm	inch	mm
7108L_1/16	1/16	1.58	5/16	.44	11.17	.59	14.98	.34	8.6
7108L_1/8	1/8	3.17	7/16	.53	13.46	.79	20.06	.50	12.7
7108L_3/16	3/16	4.76	7/16	.58	14.73	.84	21.84	.54	13.7
7108L_1/4	1/4	6.35	1/2	.63	16.00	.92	23.37	.60	15.2
7108L_5/16	5/16	7.93	9/16	.67	17.01	.96	24.38	.64	16.2
7108L_3/8	3/8	9.52	5/8	.72	18.28	1.01	26.65	.66	16.8
7108L_1/2	1/2	12.70	13/16	.75	19.05	1.15	29.21	.90	22.9
7108L_5/8	5/8	15.87	15/16	.78	19.81	1.18	29.97	.96	24.4
7108L_3/4	3/4	19.05	1 1/16	.84	21.33	1.24	31.49	.96	24.4
7108L_7/8	7/8	22.22	1 3/16	.94	23.88	1.34	34.04	1.02	25.9
7108L_1	1	25.40	1 3/8	1.03	26.16	1.51	38.35	1.23	31.2
7108L_1 1/4	*1 1/4	31.75	1 3/4	1.23	31.24	2.10	53.34	1.62	41.2
7108L_1 1/2	*1 1/2	38.10	2 1/8	1.47	37.33	2.54	64.52	1.97	50.0
7108L_2	*2	50.80	2 3/4	1.94	49.28	3.41	86.61	2.66	67.6

* Including low friction paste, see page 91

"D" - Dimension is minimum opening. Dimensions are for reference only, and are subject to change without notice.