

Bundling and Securing

Cable Tie Mounts

Screw Mounting Bases

Cable Tie Anchor Mounts

Anchor Mounts for cable ties are suitable for applications with minimal space. Anchors are mounted onto the equipment prior to cable installation and take up no more space than the cable itself. Choose between a four-way entry design that can be used either 'in line' or at 90 degrees to the cable run.

Features and Benefits

- Suitable for applications with minimal space.
- CTAM has 4-way entry design for use in line or at 90° angle to cable run.
- CTAM mounts are available in different sizes and materials.

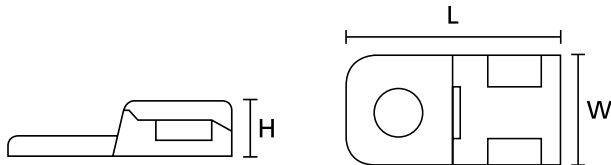

PART NO.	TYPE	Cable Tie Series	Mounting Screw Type	Length (L) in. (mm)	Width (W) in. (mm)	Height (H) in. (mm)	Material	Color	Pkg. Qty.
CTAM110C2*	CTAM1	T18 - T50	#8 (M4) Screw	0.8 (20.4)	0.4 (10.2)	0.2 (5.1)	PA66	White	100
CTAM10C2*		T18 - T50	#8 (M4) Screw	0.8 (20.4)	0.4 (10.2)	0.2 (5.1)	PA66	Black	100
CTAM10M4*		T18 - T50	#8 (M4) Screw	0.8 (20.4)	0.4 (10.2)	0.2 (5.1)	PA66	Black	1000
CTAM110M4*		T18 - T50	#8 (M4) Screw	0.8 (20.4)	0.4 (10.2)	0.2 (5.1)	PA66	White	1000
151-00757		T18 - T50	#8 (M4) Screw	0.8 (20.5)	0.4 (10.2)	0.2 (5.5)	PEEK	Beige	100
CTAM20C2*	CTAM2	T18 - T50	#10 (M5) Screw	0.8 (20.4)	0.4 (10.2)	0.2 (5.1)	PA66	Black	100
CTAM20M4*		T18 - T50	#10 (M5) Screw	0.8 (20.4)	0.4 (10.2)	0.2 (5.1)	PA66	Black	1000
CTAM210C2*		T18 - T50	#10 (M5) Screw	0.8 (20.4)	0.4 (10.2)	0.2 (5.1)	PA66	White	100
CTAM210M4*		T18 - T50	#10 (M5) Screw	0.8 (20.4)	0.4 (10.2)	0.2 (5.1)	PA66	White	1000
151-00758		T18 - T50	#10 (M5) Screw	0.8 (20.5)	0.4 (10.2)	0.2 (5.5)	PEEK	Beige	100
151-00997	MCCTAM1	MCT18 - MCT50	#8 (M4) Screw	0.8 (20.7)	0.4 (10.3)	0.2 (5.1)	PA66MP+	Blue	100

Dimensions are approximate and subject to technical changes. Use Part No. for ordering and Type for specification purposes.

*This product meets UL standards. Please see appendix for specific file numbers.



Please note! Not all products listed on this page may have this approval. Please check our website for latest approvals.