

M-13375

1

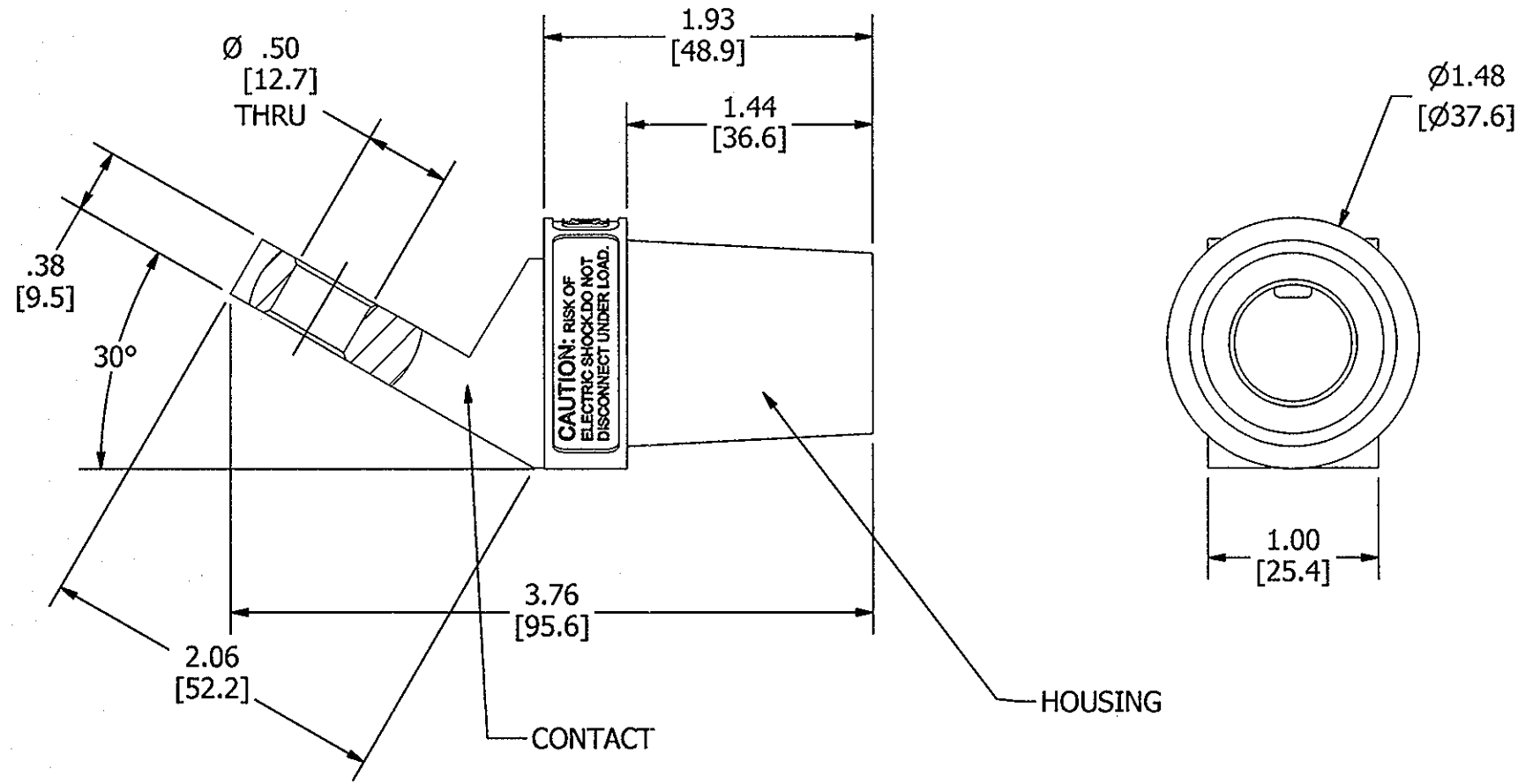

LIST OF PARTS

DESCRIPTION	MATERIAL	FINISH
HOUSING	TPE	SEE TABLE
CONTACT	BRASS	

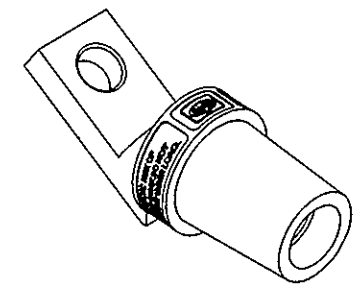

1/2 SCALE SHOWN

NOTES:

1. DIMENSIONS ARE IN INCHES ±.02 [mm] ±.5
2. RATING: 600VAC/250VDC, 400 AMP.
3. UL/c-ul SEE INSTRUCTION SHEET.

HUBBELL CAT. NO	COLOR
HBLFOABK	BLACK
HBLFOABL	BLUE
HBLFOABN	BROWN
HBLFOAGN	GREEN
HBLFOAO	ORANGE
HBLFOAR	RED
HBFOAW	WHITE
HBLFOAY	YELLOW

1	RELEASED PER DCN# 22075 CAC	CAC TLS	04/28/16
SYM	DESCRIPTION	APPROVED	DATE

THE DESIGN AND DIMENSIONS OF THE PRODUCT SHOWN ON THIS DRAWING ARE SUBJECT TO CHANGE WITHOUT NOTICE

TITLE
SINGLE POLE
OFFSET ANGLED FEMALE RECEPTACLE
W/BUS BAR

TOLERANCES UNLESS OTHERWISE SPECIFIED FRACTIONS ± 1/64 DECIMALS ± .030 ANGLES ± 2°	WIRING DEVICE-KELLEMS HUBBELL INCORPORATED SHELTON, CT	
	DR. BY CAC	APP. BY TLS
	TR. BY	SCALE 1:1
	CHK'D BY TLS	DATE 4/6/2016

DIMENSION SHEET FOR CAT. NO.

REPAIRABLE

NON-REPAIRABLE

B

M-13375

1