

Part number
CRM



Brief description:

dual coding and guide pins, for 16 codes, male pin, in stainless steel

Product description	
Series	multipole inserts accessories
Product type	dual coding and guide pins, for 16 codes
Style	male pin, in stainless steel
Family	accessories for multipole connectors
Further technical details	
Weight	2,13 g

General ordering information	
EAN13 code	8015747038676
Tariff number	85369095
Packaging Information	
Packaging length	112,00 mm
Packaging height	95,00 mm
Packaging width	117,00 mm
Packaging weight	0,85 kg
Packaging volume	1,24 dm ³
Packaging description	Carton box
Packaging quantity	400 Pcs
Packaging EAN code	8015747206761
Sub-packaging length	50,00 mm
Sub-packaging height	44,00 mm
Sub-packaging width	50,00 mm
Sub-packaging weight	0,11 kg
Sub-packaging volume	0,11 dm ³
Sub-packaging description	Plastic box
Sub-packaging quantity	50 Pcs
Sub-packaging EAN barcode	8015747038683

Part number

CRM



Catalogue drawings

CRM / CRM D

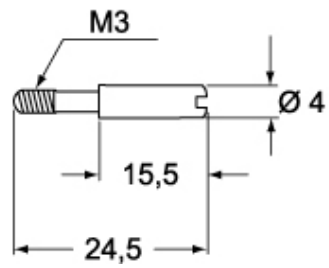

CRF / CRF D

