

# KTMB 183

## Grommets for KEL 183



1

Type	Order No. gray	Clamping range	PU
KTMB-O	41410	Blank grommet	1
KTMB-P	41415	34 - 44 mm	1
KTMB-Q	41420	44 - 54 mm	1
KTMB-R	41425	54 - 64 mm	1
KTMB-S	41430	64 - 75 mm	1

### Product Description

The grommets KTMB-P to KTMB-S are suitable for cable diameters up to 75 mm. These grommets can be used with the KEL 183 cable entry frames.

These multi-range grommets are not split and have a defined area for pushing the cable through.

The blank grommet KTMB-O can accept cable sizes within a specified range. The membrane of the KTMB-O can be pierced or cut (cable diameter minus 10 mm) for cables up to 55mm in diameter.

### Specifications

Material	Elastomer
Flame class	UL94-Vo
IP rating	IP54
NEMA type rating	NEMA type 12 (acc. to UL 50E)
Temperature	- 40°C to + 90°C (static) - 40°F to + 194°F (static)
Properties	Halogen-free, silicone-free

### Compatible with

KEL 183 Cable entry frames 32

# KT

## Grommets, small, single

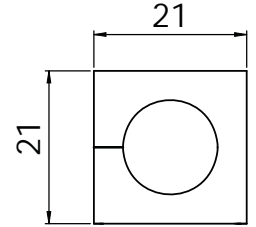

1

Description	Type	Order No gray	Order No black	Clamping range	PU
-------------	------	------------------	-------------------	----------------	----

### Product Description

Cable grommets KT small are used with the following cable entry frames:

KEL-U/KEL-ER/KEL (8 - 34) | KVT (38 - 42)

The model range KT small is designed for cable diameters from 2 to 17 mm.

### Assembly Note





When installing the grommets, the flat side should be facing the middle of the frame. This allows the flat sides of adjacent grommets to match up and provide a secure seal.

### Specifications KT gray

Material	Elastomer
Flame class	UL94-Vo
IP rating	KT round, single: up to IP65 (in combination with KEL-ER frame) KT special/blank: IP54
NEMA type rating	up to NEMA type 4X (acc. to UL 50E)
Temperature	- 30°C to + 90°C (static) - 40°F to + 194°F (static)
Properties	Halogen-free, silicone-free

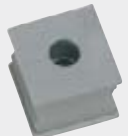
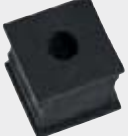
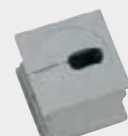
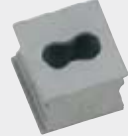
### Specifications KT black

Material	Elastomer
Flame class	UL94-HB
IP rating	KT round, single: up to IP65 (in combination with KEL-ER frame) KT special/blank: IP54
NEMA type rating	up to NEMA type 4X (acc. to UL 50E)
Temperature	- 30°C to + 90°C (static) - 40°F to + 194°F (static)
Properties	Higher chemical resistance

BTK		BTK	<input type="checkbox"/> 41251	<input checked="" type="checkbox"/> 41351	Blank grommet	10
KT round		KT 2	<input type="checkbox"/> 39934	<input checked="" type="checkbox"/> 41302	2 - 3 mm	10
		KT 3	<input type="checkbox"/> 41203	<input checked="" type="checkbox"/> 41303	3 - 4 mm	10
		KT 4	<input type="checkbox"/> 41204	<input checked="" type="checkbox"/> 41304	4 - 5 mm	10
		KT 5	<input type="checkbox"/> 41205	<input checked="" type="checkbox"/> 41305	5 - 6 mm	10
		KT 6	<input type="checkbox"/> 41206	<input checked="" type="checkbox"/> 41306	6 - 7 mm	10
		KT 7	<input type="checkbox"/> 41207	<input checked="" type="checkbox"/> 41307	7 - 8 mm	10
		KT 8	<input type="checkbox"/> 41208	<input checked="" type="checkbox"/> 41308	8 - 9 mm	10
		KT 9	<input type="checkbox"/> 41209	<input checked="" type="checkbox"/> 41309	9 - 10 mm	10
		KT 10	<input type="checkbox"/> 41210	<input checked="" type="checkbox"/> 41310	10 - 11 mm	10
		KT 11	<input type="checkbox"/> 41211	<input checked="" type="checkbox"/> 41311	11 - 12 mm	10
KT oval		KT 12	<input type="checkbox"/> 41212	<input checked="" type="checkbox"/> 41312	12 - 13 mm	10
		KT 13	<input type="checkbox"/> 41213	<input checked="" type="checkbox"/> 41313	13 - 14 mm	10
		KT 14	<input type="checkbox"/> 41214	<input checked="" type="checkbox"/> 41314	14 - 15 mm	10
		KT 15	<input type="checkbox"/> 41215	<input checked="" type="checkbox"/> 41315	15 - 16 mm	10
		KTs 16	<input type="checkbox"/> 39901	<input checked="" type="checkbox"/> 39912	16 mm	10
		KTs 17	<input type="checkbox"/> 39900	<input checked="" type="checkbox"/> 39913	17 mm	10
		KT oval		KT oval	<input type="checkbox"/> 39930	-
KT S1		KT S1	<input type="checkbox"/> 39931	-		10
KT tele		KT tele	<input type="checkbox"/> 39929	-	Telephone cable	10
KT tele1		KT tele1	<input type="checkbox"/> 41257	-	Data cable RJ12	10
KT tele2		KT tele2	<input type="checkbox"/> 41258	-	Data cable RJ10 / RJ45	10

\*Only valid for gray product types

### Accessories

ST Plugs 49

# KT

## Grommets, small, multi



Type	Order No gray	Order No black	Clamping range	PU	Description
------	------------------	-------------------	----------------	----	-------------

KT 2 2	<input type="checkbox"/> 39935	<input type="checkbox"/> 39936	2x $\varnothing$ 2 mm	10	
KT 2 3	<input type="checkbox"/> 39939	<input type="checkbox"/> 39940	2x $\varnothing$ 3 mm	10	
KT 2 4	<input type="checkbox"/> 39906	<input type="checkbox"/> 39907	2x $\varnothing$ 4 mm	10	
KT 2 5	<input type="checkbox"/> 41200	<input type="checkbox"/> 39904	2x $\varnothing$ 5 mm	10	
KT 2 6	<input type="checkbox"/> 41201	<input type="checkbox"/> 39905	2x $\varnothing$ 6 mm	10	
KT 2 7	<input type="checkbox"/> 41202	<input type="checkbox"/> 39916	2x $\varnothing$ 7 mm	10	
KT 2 8	<input type="checkbox"/> 39917	<input type="checkbox"/> 39918	2x $\varnothing$ 8 mm	10	

KT 4 2	<input type="checkbox"/> 39937	<input type="checkbox"/> 39938	4x $\varnothing$ 2 mm	10	
KT 4 3	<input type="checkbox"/> 39914	<input type="checkbox"/> 39915	4x $\varnothing$ 3 mm	10	
KT 4 4	<input type="checkbox"/> 39909	<input type="checkbox"/> 39911	4x $\varnothing$ 4 mm	10	
KT 4 5	<input type="checkbox"/> 39908	<input type="checkbox"/> 39910	4x $\varnothing$ 5 mm	10	
KT 4 6	<input type="checkbox"/> 39932	<input type="checkbox"/> 39933	4x $\varnothing$ 6 mm	10	

KT-ASI	<input type="checkbox"/> 39902	<input type="checkbox"/> 39903	1 ASI-cable	10	
KT-ASI2 rl	<input type="checkbox"/> 39922	<input type="checkbox"/> 39924	2 ASI-cables	10	
KT-ASI2 ll	<input type="checkbox"/> 39921	<input type="checkbox"/> 39923	2 ASI-cables	10	

KT ASI2 ll	<input type="checkbox"/> 39921	<input type="checkbox"/> 39923	2 ASI-cables	10	
------------	--------------------------------	--------------------------------	--------------	----	---

### Product description

Cable grommets KT small are used with the following cable entry frames:

KEL-U/KEL-ER/KEL (8 - 34) | KVT (38 - 42)

The model range KT small is designed for cable diameters from 2 to 17 mm.

### Assembly Note

When installing the grommets, the flat side should be facing the middle of the frame. This allows the flat sides of adjacent grommets to match up and provide a secure seal.

### Specifications KT gray

Material	Elastomer
Flame class	UL94-Vo
IP rating	KT round, multi: IP54 KT special, multi: IP54
NEMA type rating	NEMA type 12 (acc. to UL 50E)
Temperature	- 40°C to + 90°C (static) - 40°F to + 194°F (static)
Properties	Halogen-free, silicone-free

### Specifications KT black

Material	Elastomer
Flame class	UL94-HB
IP rating	KT round, multi: IP54 KT special, multi: IP54
NEMA type rating	NEMA type 12 (acc. to UL 50E)
Temperature	- 30°C to + 90°C (static) - 40°F to + 194°F (static)
Properties	Higher chemical resistance

\*Only valid for gray product types

# KT

## Grommets, large

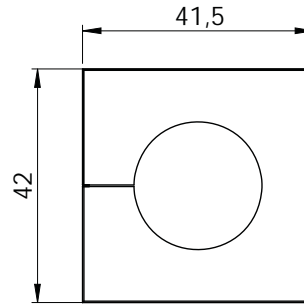

KT / KT-DPF large

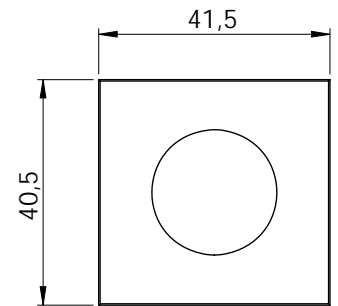

KTMB large

1

### Product description

Cable grommets KT large accept a wide range of cable diameters from 16 to 35 mm. They are used with the following cable entry frames:

KEL-U/KEL-ER/KEL (8 - 34) | KVT (38 - 42)

ATG adapter grommets provide the possibility to hold a small KT grommet to reduce the clamping range down to 2 mm.



### Specifications KT gray

**Material** Elastomer  
**Flame class** UL94-Vo  
**IP rating** KT round, single: up to IP65 (in combination with KEL-ER frame)  
 ATG/BTG: IP54  
**NEMA type rating** up to NEMA type 4X (acc. to UL 50E)  
**Temperature** - 40°C to + 90°C (static)  
 - 40°F to + 194°F (static)  
**Properties** Halogen-free, silicone-free

### Specifications KT black

**Material** Elastomer  
**Flame class** UL94-HB  
**IP rating** KT round, single: up to IP65 (in combination with KEL-ER frame)  
 ATG/BTG: IP54  
**NEMA type rating** up to NEMA type 4X (acc. to UL 50E)  
**Temperature** - 30°C to + 90°C (static)  
 - 40°F to + 194°F (static)  
**Properties** Higher chemical resistance

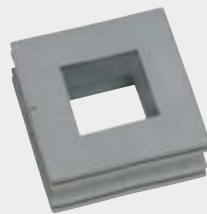
Description	Type	Order No. gray	Order No. black	Clamping range	PU
-------------	------	----------------	-----------------	----------------	----

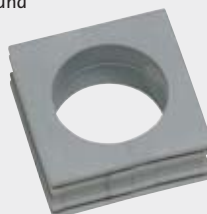
ATG		ATG	<input type="checkbox"/> 41253 <input checked="" type="checkbox"/> 41353	Adapter grommet	10
BTG		BTG	<input type="checkbox"/> 41252 <input checked="" type="checkbox"/> 41352	Blank grommet or 5 - 20 mm	10
KT round		KT 16	<input type="checkbox"/> 41216 <input checked="" type="checkbox"/> 41316	16 - 17 mm	10
		KT 17	<input type="checkbox"/> 41217 <input checked="" type="checkbox"/> 41317	17 - 18 mm	10
		KT 18	<input type="checkbox"/> 41218 <input checked="" type="checkbox"/> 41318	18 - 19 mm	10
		KT 19	<input type="checkbox"/> 41219 <input checked="" type="checkbox"/> 41319	19 - 20 mm	10
		KT 20	<input type="checkbox"/> 41220 <input checked="" type="checkbox"/> 41320	20 - 21 mm	10
		KT 21	<input type="checkbox"/> 41221 <input checked="" type="checkbox"/> 41321	21 - 22 mm	10
		KT 22	<input type="checkbox"/> 41222 <input checked="" type="checkbox"/> 41322	22 - 23 mm	10
		KT 23	<input type="checkbox"/> 41223 <input checked="" type="checkbox"/> 41323	23 - 24 mm	10
		KT 24	<input type="checkbox"/> 41224 <input checked="" type="checkbox"/> 41324	24 - 25 mm	10
		KT 25	<input type="checkbox"/> 41225 <input checked="" type="checkbox"/> 41325	25 - 26 mm	10
		KT 26	<input type="checkbox"/> 41226 <input checked="" type="checkbox"/> 41326	26 - 27 mm	10
		KT 27	<input type="checkbox"/> 41227 <input checked="" type="checkbox"/> 41327	27 - 28 mm	10
		KT 28	<input type="checkbox"/> 41228 <input checked="" type="checkbox"/> 41328	28 - 29 mm	10
		KT 29	<input type="checkbox"/> 41229 <input checked="" type="checkbox"/> 41329	29 - 30 mm	10
		KT 30	<input type="checkbox"/> 41230 <input checked="" type="checkbox"/> 41330	30 - 31 mm	10
		KT 31	<input type="checkbox"/> 41231 <input checked="" type="checkbox"/> 41331	31 - 32 mm	10
		KT 32	<input type="checkbox"/> 41232 <input checked="" type="checkbox"/> 41332	32 - 33 mm	10
		KT 33	<input type="checkbox"/> 41233 <input checked="" type="checkbox"/> 41333	33 - 34 mm	10
		KT 34	<input type="checkbox"/> 41234 <input checked="" type="checkbox"/> 41334	34 - 35 mm	10

\*Only valid for gray product types

# KT-DPF | KTMB

## Grommets, Multi-Range

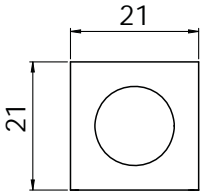

KT-DPF / KTMB small



KT-DPF-B



1

Type	Order No.	Size KT	Clamping range	PU	Description
------	-----------	------------	----------------	----	-------------

KT-DPF-A	<input type="checkbox"/> 41260 <input type="checkbox"/> 41360	KT small	3 - 12 mm	10	 <p>KT-DPF-A</p>
KT-DPF-B	<input type="checkbox"/> 41261 <input type="checkbox"/> 41361	KT large	4 - 18 mm	10	
KT-DPF-C	<input type="checkbox"/> 41262 <input type="checkbox"/> 41362	KT large	14 - 26 mm	10	 <p>KT-DPF-C</p>
KTMB-A	41432	KT small	2.5 - 6.5 mm	10	
KTMB-B	41434	KT small	4 - 7.5 mm	10	 <p>KTMB-D</p>
KTMB-C	41436	KT small	6.5 - 10 mm	10	
KTMB-D	41438	KT small	9.5 - 13 mm	10	
KTMB-E	41440	KT small	13 - 16 mm	10	 <p>Cross section KTMB</p>
KTMB-G	41460	KT large	13 - 18 mm	10	
KTMB-H	41465	KT large	18 - 23 mm	10	
KTMB-I	41470	KT large	23 - 28 mm	10	 <p>KTMB-I</p>
KTMB-J	41475	KT large	28 - 33 mm	10	
KTMB-K	41480	KT large	2x 13 - 18 mm	10	 <p>KTMB-K</p>

\*Only valid for gray product types

### Product description

The KT-DPF / KTMB grommets accept a wide range of cable diameters. A great benefit when the exact cable diameter is not known in advance. The KTMB grommets are not split and therefore only usable for cables without connectors. Cutting of KT-DPF grommets: Cable diameter less 20%.

### Specifications gray

Material	Elastomer
Flame class	UL94-Vo
IP rating	IP54
NEMA type rating	NEMA type 12 (acc. to UL 50E)
Temperature	- 40°C to + 90°C (static) - 40°F to + 194°F (static)
Properties	Halogen-free, silicone-free

### Specifications black

Material	Elastomer
Flame class	UL94-HB
IP rating	IP54
NEMA type rating	NEMA type 12 (acc. to UL 50E)
Temperature	- 30°C to + 90°C (static) - 40°F to + 194°F (static)
Properties	Higher chemical resistance

### KMS Cable template

The correct size of the KT grommets can easily be determined by using the stainless steel cable template.

- Determining the diameter of the cable
- Selecting the KT grommets according
- to the data on the cable template

Order No. 39800



# DT

## Membrane Cable Grommets



1

### Product Description

The DT cable grommets are designed for cables without preassembled connectors. A large number of cables can be routed utilizing minimal space.

DT grommets are designed to fit in KT large grommet spaces of the following products:

KEL-U/KEL-ER/KEL (8 - 34) | KVT (38 - 42)

The DT grommets are also perfectly suitable for the assembly of subsequently terminated cable harnesses.

### Advantages & Benefits

- Combination of routing pre-terminated cables and cables without connectors with one cable entry frame
- Enables subassembly of cable harnesses
- High cable density

### Specifications

Material	Elastomer
Flame class	UL94-Vo
IP rating	IP54
NEMA type rating	NEMA type 12 (acc. to UL 50E)
Temperature	- 40°C to + 90°C (static) - 40°F to + 194°F (static)
Properties	Halogen-free, silicone-free

### Accessories

ST-B Plugs 76

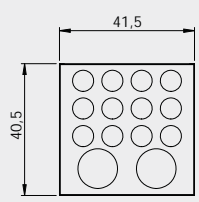
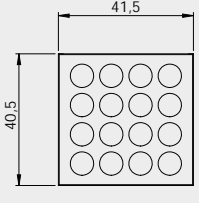
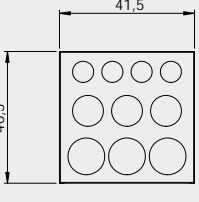
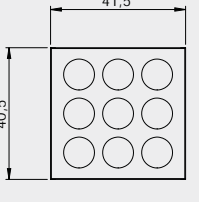
Description	Type	Order No.	Number of cables	PU
	DT 1	41500	12× max. 6.5 mm 2× max. 12.2 mm	10
	DT 2	41510	16× max. 7.1 mm	10
	DT 3	41520	4× max. 6.5 mm 3× max. 9.5 mm 3× max. 11.3 mm	10
	DT 4	41530	9× max. 9.5 mm	10