

Model 3P2

Current Transformer Window Diameter 0.69"

Application

3 phase metering and other switchboard applications and for current to voltage conversion by use of a loading resistor as illustrated in the graph below and having low primary current input.

Frequency

50-400 Hz.

Insulation level

600 Volts, 10 kV BIL full wave.

Continuous Thermal Current Rating Factor

Models 3P2-500 - 3P2-201:
1.33 at at 30°C. ambient.
1.0 at 55°C. ambient.

Models 3P2-1000T:
350A at 30°C amb., 250A at 55°C amb.,

Terminals are brass studs No. 8-32 with one flatwasher, lockwasher and regular nut.

Transformers can be ordered with secondary leads configured in various ways (consult factory).

Load resistors may be mounted directly on terminals thus providing a "space saver" feature.

Approximate weight 1.5 lbs.

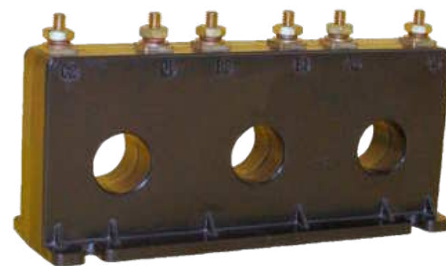

For Horizontal Mounting

REGULATORY AGENCY APPROVALS
 E93779  LR89403
 Manufactured to meet the requirements of ANSI/IEEE C57.13.
 Classified by U.L. in accordance with IEC 44-1

DATA TABLE Model 3P2

Catalog Number	Current Ratio	Accuracy at 60 Hz	Burden VA 60 Hz
3P2-500	50:5	± 2%	0.75
3P2-600	60:5	± 2%	0.75
3P2-750	75:5	± 2%	1.0
3P2-800	80:5	± 2%	1.0
3P2-101	100:5	± 1%	1.0
3P2-121	120:5	± 1%	1.0
3P2-1250	125:5	± 1%	1.0
3P2-151	150:5	± 1%	1.5
3P2-201	200:5	± 1%	2.0
3P2-1000T		See Performance Graph	



Model 3P2

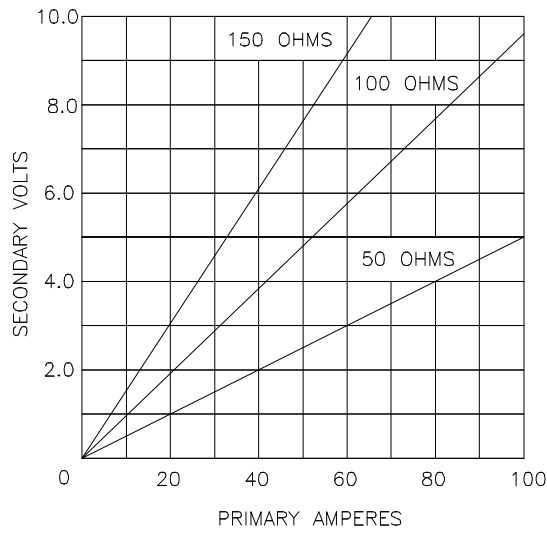

The graph illustrates voltage output capacity, and over the ranges shown, will maintain + 3% linearity.

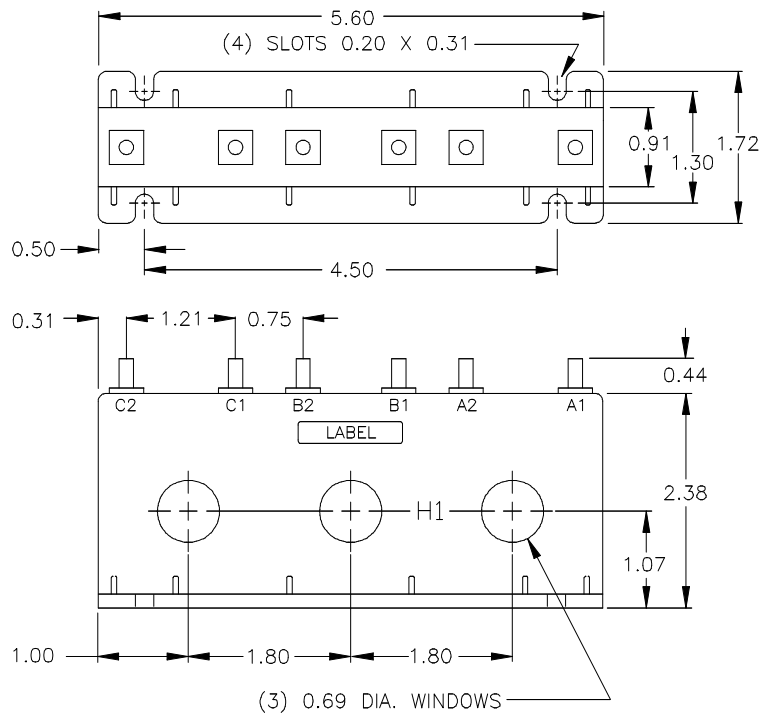

Grid-AIS-L4-ITL_Model_3P2-1532-2017_04-EN. © Copyright 2017. General Electric Company and Instrument Transformers LLC reserve the right to change specifications of described products at any time without notice and without obligation to notify any person of such changes.

