

Oval Connectors

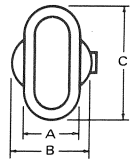

PLUG

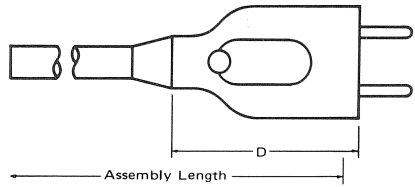
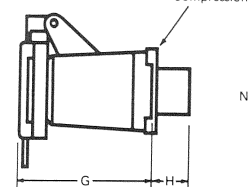
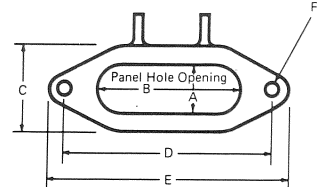
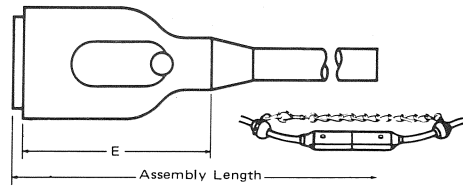

RECEPTACLE

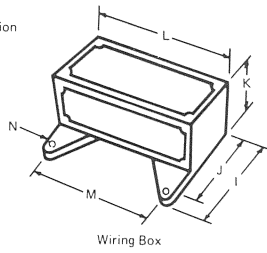

NOTE: Refer to price list for identification of stock items.

No. of Cont.	ELECTRICAL DATA		DESCRIPTION	DIMENSIONS (Approx. Inches)					Asy. Lgth.	PLUG PART NUMBERS				RECEPTACLE PART NUMBERS With Covers		Asy. * Lgth.	DIMENSIONS (Approx. Inches)								PART NUMBER	DIMENSIONS (Approx. Inches)						Input Cond. Open.					
	CABLE AWG Type	Max. Cable Rating Amp Volts		Polarized by	Type of Seal	A	B	C		D	E	Without Safety Chain		With Safety Chain			Male	Female	Male	Female	A	B	C	D		E	F	G	H	Wiring Box	I		J	K	L	M	N
												Male	Female	Male	Female																						
TWO POLE																																					
2	14	SO	15	600	Pin Size	Short Male Shroud	7/8	1 1/4	1 3/4	3 1/8	3 1/16	12" 10'	X8020-3	X8020-4	X8020-8 X8020-134	X8020-9 X8020-136	X8020-38	X8020-34	Term. Back	7/8	1 1/4	1 5/8	3	3 5/8	3/32	2 1/2	3/4	SBM4135	2 1/2	2 1/16	2	3 7/8	3 1/8	5/16	1/2		
2	14	SO	15	600	Not Pol.	Short Male Shroud	7/8	1 1/4	1 3/4	3 1/8	3 1/16	12" 6'	X8015-1 X8015-135	X8015-5	X8015-20	X8015-21	X8015-32	X8015-33	Term. Back	7/8	1 1/4	1 5/8	3	3 5/8	3/32	2 1/2	3/4	SBM4135	2 1/2	2 1/16	2	3 7/8	3 1/8	5/16	1/2		
2	12	SO	20	600	Pin Size	Short Male Shroud	1	1 1/2	2 1/8	4 1/8	4 3/8	12" 10'	X8021-2	X8021-3	X8021-122	X8021-124	X8021-32	X8021-31	Term. Back	1	2 1/8	1 3/4	3 3/8	4	3/32	3 3/8	5/8	SBM4136	2 5/8	2 1/4	2	4 1/8	3 3/8	5/16	3/4		
2	10	SO	25	600	Not Pol.	Short Male Shroud	1	1 1/2	2 1/8	4 1/8	4 3/8	12" 10'	X8016-16	X8016-17	X8016-23 X8016-126	X8016-6 X8016-128	X8016-44	X8016-43	Term. Back	1	2 1/8	1 3/4	3 3/8	4	3/32	3 3/8	5/8	SBM4136	2 5/8	2 1/4	2	4 1/8	3 3/8	5/16	3/4		
2	6	W	50	600	Pin Size	Short Male Shroud	1 1/4	1 3/4	2 5/8	5 1/4	5 7/8	18"	X8024-6	X8024-7	X8024-5	X8024-4	X8024-14	X8024-15	Term. Back	1 1/4	2 5/8	2	4 1/8	5	3/8	4 3/4	1 7/16	SBM4138	3 3/4	3 1/4	2 7/8	5 3/8	4 3/8	3/8	1 1/4		
2	6	W	50	600	Not Pol.	Short Male Shroud	1 1/8	1 1/2	2 1/2	4 7/16	4 7/8	18" 10'	X8017-17 X8017-143	X8017-18 X8017-144	X8017-8 X8017-142	X8017-3 X8017-145	X8017-27	X8017-28	Term. Back	1 1/8	2 1/2	1 3/4	3 7/8	4 5/8	3/32	3 7/8	1 1/16	SBM4137	3 1/16	2 7/8	2 5/8	5	4 1/8	3 3/8	1		
2	2	W	95	600	Pin Size	Short Male Shroud	1 3/8	1 7/8	2 7/8	5 1/4	6 1/4	18" 10'	X8026-93	X8026-95	X8026-45 X8026-97	X8026-2 X8026-99	X8026-19	X8026-20	Term. Back	1 3/8	3 1/8	2 3/8	5	6	3/8	5 7/16	1 3/8	SBM4139	4 1/4	3 3/4	3 1/4	6 7/8	5 7/8	7/16	1 1/4		
2	2	PD	95	600	Pin Size	Short Male Shroud	1 3/8	1 7/8	2 7/8	5 1/4	6 1/4	18"	X8026-11	X8026-10	X8026-1	X8026-43	X8026-19	X8026-20	Term. Back	1 3/8	3 1/8	2 3/8	5	6	3/8	5 7/16	1 3/8	SBM4139	4 1/4	3 3/4	3 1/4	6 7/8	5 7/8	7/16	1 1/4		
2	2	W	95	600	Not Pol.	Short Male Shroud	1 1/4	1 3/4	2 5/8	5 1/8	5 7/8	18" 6'	X8018-9	X8018-10	X8018-19 X8018-117	X8018-20 X8018-119	X8018-31	X8018-32	Term. Back	1 1/4	2 5/8	2	4 1/8	5	3/8	4 3/4	1 3/4	SBM4138	3 3/4	3 1/4	2 7/8	5 3/8	4 3/8	3/8	1 1/4		
2	2	W	95	600	Not Pol.	Short Male Shroud	1 3/8	1 7/8	2 7/8	5 1/4	6 1/4	18" 6'			X8019-16 X8019-96	X8019-3 X8019-98	X8019-27	X8019-28	Term. Back	1 3/8	3 1/8	2 3/8	5	6	3/8	5 7/16	1 3/8	SBM4139	4 1/4	3 3/4	3 1/4	6 7/8	5 7/8	7/16	1 1/4		
2	2	PD	95	600	Not Pol.	Short Male Shroud	1 3/8	1 7/8	2 7/8	5 1/4	6 1/4	18"	X8019-14	X8019-15	X8019-53	X8019-51	X8019-27	X8019-28	Term. Back	1 3/8	3 1/8	2 3/8	5	6	3/8	5 7/16	1 3/8	SBM4139	4 1/4	3 3/4	3 1/4	6 7/8	5 7/8	7/16	1 1/4		
THREE POLE																																					
3	14	SO	15	600	Pin Size	Short Male Shroud	7/8	1 1/8	2 1/8	2 13/16	3 1/8	12" 6'	X8041-2	X8041-3	X8041-11 X8041-164	X8041-12 X8041-166	X8041-56	X8041-55	Term. Back	1	2 1/8	1 3/4	3 3/8	4	3/32	3 3/8	5/16	SBM4136	2 5/8	2 1/4	2	4 1/8	3 3/8	5/16	3/4		
3	14	SO	15	600	Not Pol.	Short Male Shroud	7/8	1 1/8	2 1/8	2 13/16	3 1/8	12" 6'	X8036-5 X8036-109	X8036-13 X8036-111			X8036-38	X8036-37	Term. Back	1	2 1/8	1 3/4	3 3/8	4	3/32	3 3/8	5/8	SBM4136	2 5/8	2 1/4	2	4 1/8	3 3/8	5/16	3/4		
3	12	SO	20	600	Pin Size	Short Male Shroud	1	1 3/8	2 3/4	4	4 3/8	12" 6'	X8042-3 X8042-82	X8042-5 X8042-83	X8042-95	X8042-96	X8042-8	X8042-25	Term. Back	1	2 3/4	1 5/8	4	4 5/8	3/32	3 3/16	1 3/16	SBM4140	3 1/8	2 3/4	2 3/8	5	4 1/4	5/16	3/4		
3	12	SO	20	600	Pin Size	Full Male Shroud	1 3/8	1 3/8	2 7/8	4 5/16	2 3/8	16"	X8053-20	X8053-21	X8053-14	X8053-12			Term. Back																		
3	10	SO	25	600	Pin Size	Short Male Shroud	1	1 3/8	2 3/4	4	4 3/8	12" 6'	X8043-2 X8043-116	X8043-1 X8043-127	X8043-12	X8043-11	X8043-50	X8043-10	Term. Back	1	2 3/4	1 5/8	4	4 5/8	3/32	3 3/16	9/16	SBM4140	3 1/8	2 3/4	2 3/8	5	4 1/4	5/16	3/4		
3	10	SO	25	600	Not Pol.	Short Male Shroud	1	1 3/8	2 3/4	4	4 3/8	12" 10'	X8037-12	X8037-7	X8037-94	X8037-96	X8037-25	X8037-26	Term. Back	1	2 3/4	1 5/8	4	4 5/8	3/32	3 3/16	3/4	SBM4140	3 1/8	2 3/4	2 3/8	5	4 1/4	5/16	3/4		
3	8	W	35	600	Pin Size	Short Male Shroud	1 1/8	1 1/2	3 1/8	4 5/8	5 1/8	12" 10'	X8044-10	X8044-16	X8044-107	X8044-109	X8044-28	X8044-29	Term. Back	1 1/8	3 1/4	1 3/4	4 1/2	5 1/4	3/8	4 1/8	1 3/8	SBM4141	3 7/16	3	2 5/8	5 1/2	4 5/8	3/8	1 1/4		
3	6	W	50	600	Pin Size	Short Male Shroud	1 1/4	1 5/8	3 1/2	5 3/8	6 1/2	18" 10'	X8045-2 X8045-103	X8045-3 X8045-100	X8045-8 X8045-104	X8045-9 X8045-106	X8045-30	X8045-10	Term. Back	1 1/4	3 1/2	2	5 1/4	6 1/4	3/8	5 3/8	1 3/8	SBM4142	3 3/8	3 1/8	2 7/8	6 3/8	5 3/8	7/16	1 1/4		
3	6	W	50	600	Not Pol.	Short Male Shroud	1 1/8	1 1/2	3 1/8	4 5/8	5 1/8	18"	X8038-7	X8038-6	X8038-4	X8038-5	X8038-24	X8038-25	Term. Back	1 1/8	3 1/4	1 3/4	4 1/2	5 1/4	3/8	4 1/8	1 3/8	SBM4141	3 7/16	3	2 5/8	5 1/2	4 5/8	3/8	1 1/4		

*Cable rating based on conductor temperature of 60°C and maximum ambient temperature of 40°C.

*Cable lengths are subject to standard Joy tolerances.