

Three Phase Motors Totally Enclosed

**Three Phase Motors – General Purpose – Totally Enclosed –
208-230/460V & 460V Rigid Mount – ¼ HP – 400 HP
Steel Frame – Cast Iron Frame – Aluminum Frame**



- Standard, EPAct and Premium efficient ratings
- Inverter-rated
- Class B insulation systems – 42, 48 and 56 frames
- Class F insulation system – 140 frame and higher
- Shielded ball bearings for direct coupled applications
Contact your local sales office for belted load applications
- Continuous duty
- Dynamically balanced rotors
- 1-year warranty on Standard efficient motors
- 2-year warranty on EPAct efficient motors
- 3-year warranty on Premium efficient motors
- Torques exceed NEMA performance standards
- UL recognized and CSA certified



Applications:

- For use where exposure to water, dust and corrosives exists. Ideally suited for use on pumps, compressors, fans, blowers, conveyors, machine tools and other industrial applications.



Three Phase Motors Totally Enclosed Fan Cooled

General Purpose - Standard, EPAct and Premium Efficient - Three Phase Motors

Three Phase - TEFC - Rigid Base

HP	SYN RPM 60 Hz	NEMA Frame	▼ Catalog Number	Stock	Model Number	App. Wgt. (lbs)	Voltage	F. L. Amps @ 230 V	% F.L. Eff.	Service Factor	"C" Dim. (Inches)	♥Notes
1/4	1800	48	101646.00	✓	C4T17FB9	18	208-230/460	1.4	58.0	1.15	9.31	S, MX
	1800	48	LM24929	✓	SPF4S0.25T61	17	230/460	1.3	62.5	1.15	9.59	S, MX
1/3	3600	48	102684.00	✓	C4T34FB5	18	208-230/460	1.4	68.0	1.00	8.81	S, US
	1800	48	101647.00	✓	C4T17FB10	21	208-230/460	1.6	64.3	1.15	9.31	S, MX
	1800	S56	101079.00	✓	C4T17FH6	22	208-230/460	1.6	64.3	1.15	9.69	S, MX
	1800	S56	LM24107	✓	SRF4S0.33T61	16	230/460	1.6	65.5	1.15	10.22	S, MX
	1800	S56	103019.00	✓	C4T17FH12	24	208-230/460	1.3	77.0	1.25	10.19	S, MX
	1200	56	110441.00	✓	C6T11FB5	23	208-230/460	1.6	65.0	1.15	10.81	S, US
1/2	3600	48	100905.00	✓	C4T34FB2	18	208-230/460	1.8	69.0	1.00	9.94	S, US
	3600	56	LM24165	✓	SRF2S0.5T61	22	230/460	2.2	69.0	1.15	11.82	S, US
	1800	48	100961.00	✓	C4T17FB4	21	208-230/460	2.0	73.0	1.15	9.56	S, MX
	1800	S56	100913.00	✓	C4T17FH1	24	208-230/460	2.0	73.0	1.15	9.94	S, MX
	1800	S56	LM24073	✓	SRF4S0.5T61	18	230/460	2.2	70.0	1.15	10.72	S, MX
	1800	S56	103020.00	✓	C4T17FH13	27	208-230/460	1.8	77.0	1.25	10.69	S, MX
	1200	56	110353.00	✓	C6T11FB2	26	208-230/460	2.4	70.0	1.15	11.31	S, US
	1200	56	LM24105	✓	SRF6S0.5T61	24	230/460	2.7	68.0	1.15	11.82	S, MX
	900	56	114618.00	✓	C6T8FB11	31	208-230/460	2.4	69.0	1.15	11.81	S, US
	900	143T	LM24291	C/A	SSF8S0.5T61	31	230/460	2.6	66.0	1.15	13.37	S, US
3/4	3600	48	100960.00	✓	C4T34FB3	21	208-230/460	2.4	79.0	1.00	10.44	S, US
	3600	56	110313.00	✓	C6T34FB2	22	208-230/460	2.4	75.5	1.15	10.81	S, US
	3600	56	LM24133	✓	SRF2S0.75T61	23	230/460	3.2	74.0	1.15	11.82	S, US
	1800	56	110034.00	✓	C6T17FB1	22	208-230/460	2.8	77.0	1.15	10.81	S, US
	1800	S56	LM24075	✓	SRF4S0.75T61	30	230/460	2.8	75.5	1.15	11.22	S, MX
	1800	56	116739.00	✓	C6T17FB152	31	208-230/460	2.4	81.5	1.25	11.31	S, US
	1200	56	110275.00	✓	C6T11FB3	33	208-230/460	3.0	75.5	1.15	11.81	S, US
	1200	56	LM24136	✓	SRF6S0.75T61	28	230/460	3.2	74.0	1.15	12.32	S, MX
	1200	143T	121009.00	✓	C143T11FB2	34	208-230/460	3.0	75.5	1.15	12.75	S, US
	1200	143T	LM24103	✓	SSF6S0.75T61	29	230/460	3.2	74.0	1.15	12.37	S, MX
	900	145T	121199.00	✓	C145T8FB5	21	208-230/460	3.1	70.0	1.15	12.75	S, US
	900	145T	LM24276	✓	SSF8S0.75T61	49	230/460	4.8	70.0	1.15	14.87	S, US

Green items are Premium Efficient

▼ LM Numbers are Lincoln Models

C/A - Check Availability

Specifications are subject to change without notice

♥ Note listing on inside back flap

Continued On Next Page



Tech Information

Single Phase
ODP Motors

Single Phase
TEFC Motors

Single Phase
C Face Motors

Three Phase
ODP Motors

Three Phase
TEFC Motors

Three Phase
C Face Motors

Inverter Duty
Motors

Severe Duty
Motors

Three Phase Motors Totally Enclosed Fan Cooled

General Purpose - Standard,
 EPAct and Premium Efficient - Three Phase Motors

Three Phase - TEFC - Rigid Base

HP	SYN RPM 60 Hz	NEMA Frame	▼ Catalog Number	Stock	Model Number	App. Wgt. (lbs)	Voltage	F. L. Amps @ 230 V	% F.L. Eff.	Service Factor	"C" Dim. (Inches)	♥Notes
1	3600	56	110145.00	✓	C6T34FB1	24	208-230/460	3.2	77.0	1.15	10.81	S, US
	3600	56	LM24094	✓	SRF2S1T61	24	230/460	3.7	74.0	1.15	11.82	S, US
	3600	56	116129.00	✓	C6T34FB49	24	208-230/460	2.8	80.0	1.25	11.31	S, US
1800	56	110035.00	✓	C6T17FB2	30	208-230/460	3.8	77.0	1.15	1.15	11.31	S, US
	56	LM24078	✓	SRF4S1T61	27	230/460	3.6	77.0	1.15	1.15	12.32	S, MX
	56	116757.00	✓	C6T17FB151	32	208-230/460	3.2	85.5	1.25	1.25	12.81	S, US
1800	56HZ	115830.00	✓	C6T17FB120	33	208-230/460	3.8	77.0	1.15	1.15	12.75	S, US, 5
	143T	120921.00	✓	C143T17FB13	32	208-230/460	3.2	85.5	1.25	1.25	13.25	S, US
	143T	LM32796	✓	SSF4B1T61	41	230/460	3.2	85.5	1.25	1.25	12.93	S, MX
1800	143T	171640.60	✓	C145T17FB25	61	208-230/460	3.2	85.5	1.15	1.15	13.46	C, CN
	143T	LM24102	✓	CCN3BIT61	56	230/460	3.0	85.5	1.25	1.25	10.43	C, US
	1200	56	113933.00	✓	C6T11FB13	35	208-230/460	4.0	77.0	1.15	12.31	S, US
1200	56H	LM24159	✓	SRF6S1T61	35	230/460	4.0	78.5	1.15	1.15	12.82	S, MX
	145T	121520.00	✓	C145T11FB20	47	208-230/460	3.8	82.5	1.25	1.25	13.75	S, US
	145T	LM33121	✓	SSF6B1T61	35	230/460	3.8	82.5	1.15	1.15	14.87	S, MX
1200	145T	171643.60	✓	C145T11FB25	58	208-230/460	3.8	82.5	1.25	1.25	13.46	C, CN
	900	182T	G131478.00	✓	C182T8FB9	57	230/460	4.2	74.0	1.15	12.96	S, MX
	1 1/2	3600	56	110745.00	✓	C6T34FB16	30	208-230/460	4.2	81.5	1.15	11.81
3600		56	LM24144	✓	SRF2S1.5T61	34	230/460	4.6	80.0	1.15	11.82	S, US
3600		56	116758.00	✓	C6T34FB50B	33	208-230/460	4.0	84.0	1.25	12.81	S, US
3600	143T	121518.00	✓	C143T34FB1	33	208-230/460	4.0	84.0	1.25	1.25	13.25	S, US
	143T	LM33122	✓	SSF2B1.5T61	32	230/460	4.0	84.0	1.25	1.25	13.37	S, US
	143T	171642.60	✓	C143T34FB5	49	208-230/460	4.0	84.0	1.15	1.15	13.46	C, CN
1800	56	110444.00	✓	C6T17FB14	30	208-230/460	5.0	78.5	1.15	1.15	11.81	S, US
	56H	LM24118	✓	SRF4S1.5T61	30	230/460	4.8	80.0	1.15	1.15	12.32	S, MX
	56	116759.00	✓	C6T17FB150	34	208-230/460	4.8	86.5	1.25	1.25	13.31	S, US
1800	56HZ	115829.00	✓	C6T17FB121	37	208-230/460	5.0	78.5	1.15	1.15	12.75	S, US, 5
	145T	120922.00	✓	C145T17FB33	34	208-230/460	4.8	86.5	1.15	1.15	13.75	S, US
	145T	LM33123	✓	SSF4B1.5T61	45	230/460	4.8	86.5	1.25	1.25	13.43	S, MX
1800	145T	171646.60	✓	C145T17FB78	69	208-230/460	4.8	86.5	1.15	1.15	13.46	C, CN
	145T	LM25637	✓	CCN4B1.5T61	62	230/460	4.4	84.0	1.25	1.25	11.43	C, US
	1200	56H	114930.00	✓	C6T11FB17	48	208-230/460	5.7	77.0	1.15	13.31	S, US
1200	56HZ	116591.00	✓	C6T11FB24	45	208-230/460	5.7	77.0	1.15	1.15	13.75	S, US, 5
	182T	131980.00	✓	C182T11FB9	89	208-230/460	5.6	87.5	1.15	1.15	15.96	S, MX
	182T	199001.00	✓	C182T11FB1	113	230/460	4.8	87.5	1.15	1.15	14.80	C, CN
1200	182T	LM15648	✓	AAF6B1.5T61	83	230/460	4.4	87.7	1.25	1.25	15.19	A, US
	900	184T	G131479.00	✓	C184T8FB6	68	230/460	5.6	77.0	1.15	13.96	S, MX
	900	184T	LM32798	✓	AAF8P1.5T61	71	230/460	6.2	77.0	1.15	15.19	A, US

Green items are Premium Efficient

♥ Note listing on inside back flap

▼ LM Numbers are Lincoln Models

Continued On Next Page

C/A - Check Availability

Specifications are subject to change without notice



Three Phase Motors Totally Enclosed Fan Cooled

General Purpose - Standard,

EPAct and Premium Efficient - Three Phase Motors

Three Phase - TEFC - Rigid Base

HP	SYN RPM 60 Hz	NEMA Frame	▼ Catalog Number	Stock	Model Number	App. Wgt. (lbs)	Voltage	F. L. Amps @ 230 V	% F.L. Eff.	Service Factor	"C" Dim. (Inches)	♥Notes
2	3600	56	111916.00	✓	C6T34FB24	33	208-230/460	5.6	82.5	1.15	12.31	S, US
	3600	56	116760.00	✓	C6T34FB51	44	208-230/460	4.8	85.5	1.25	13.31	S, US
	3600	145T	121519.00	✓	C145T34FB33	44	208-230/460	4.8	85.5	1.25	13.75	S, US
	3600	145T	LM33124	✓	SSF2BT61	31	230/460	4.8	85.5	1.25	13.43	S, US
	3600	145T	171648.60	✓	C145T34FB37	56	208-230/460	4.8	85.5	1.25	13.46	C, CN
	1800	56H	113026.00	✓	C6T17FB65	35	208-230/460	6.2	81.5	1.15	12.31	S, US
	1800	56H	LM24097	✓	SRF4S2T61	40	230/460	5.8	82.5	1.15	13.82	S, MX
	1800	56HZ	115828.00	✓	C6T17FB119	37	208-230/460	6.2	81.5	1.15	12.75	S, US
	1800	56H	116761.00	✓	C6T17FB154	45	208-230/460	5.8	86.5	1.25	14.32	S, US
	1800	145T	120923.00	✓	C145T17FB32	45	208-230/460	5.8	86.5	1.25	14.76	S, US
	1800	145T	LM33125	✓	SSF4B2T61	41	230/460	6.5	86.5	1.25	13.93	S, MX
	1800	145T	171647.60	✓	C145T17FB79	68	208-230/460	5.8	86.5	1.15	13.46	C, CN
	1800	145T	LM24127	✓	CCN4B2T61	64	230/460	6.0	85.5	1.15	11.43	C, US
	1200	184T	131981.00	✓	C184T11FB20	89	208-230/460	7.2	88.5	1.15	15.96	S, MX
	1200	184T	199002.00	✓	C184T11FB1	125	230/460	6.0	88.5	1.15	15.81	C, CN
	1200	184T	LM15651	✓	AAF6B2T61	92	230/460	6.0	88.5	1.25	16.19	A, US
	1200	184T	LM33563	✓	AAF6B2T61AP26	92	230/460	6.0	88.5	1.25	16.19	A, MX
	900	213T	G140516.00	✓	C213T8FB3	114	230/460	8.0	82.5	1.15	18.22	S, MX
	900	213T	LM32799	✓	AF8P2T61	101	230/460	7.3	82.5	1.15	17.20	A, US
3	3600	56H	114614.00	✓	C6T34FB35	40	208-230/460	7.6	84.0	1.15	13.25	S, US, 5
	3600	145T	121968.00	✓	C145T34FB49	48	208-230/460	8.0	86.5	1.15	13.93	S, US
	3600	182T	131985.00	✓	C182T34FB72	66	208-230/460	7.6	86.5	1.25	13.96	S, MX
	3600	182T	199003.00	✓	C182T34FB1	94	230/460	7.6	86.5	1.15	14.80	C, CN
	3600	182T	LM15646	✓	AAF2B3T61	83	230/460	7.6	87.5	1.25	15.19	A, US
	3600	182T	LM33262	C/A	SSF2B3T61	75	230/460	7.6	87.5	1.15	13.46	S, MX
	1800	56HZ	116594.00	✓	C6T17FB144	45	208-230/460	8.6	82.5	1.00	14.26	S, US
	1800	182T	131463.00	✓	C182T17FB32	80	208-230/460	7.8	89.5	1.15	13.96	S, MX
	1800	182T	LM15647	✓	AAF4B3T61	83	230/460	8.0	89.5	1.25	15.19	A, US
	1800	182T	LM33486	✓	AAF4B3T61AP26	83	230/460	8.0	89.5	1.25	15.19	A, MX
	1800	182T	LM32741	✓	SSF4B3T61	77	230/460	7.8	89.5	1.15	13.96	S, MX
	1800	182T	171320.60	✓	C182T17FB42	108	208-230/460	7.8	89.5	1.25	15.89	C, CN
	1800	182T	199004.00	✓	C182T17FB1	102	230/460	7.8	89.5	1.15	14.80	C, CN
	1200	213T	171378.60	✓	C213T11FB1	166	208-230/460	9.4	89.5	1.25	18.19	C, CN
	1200	213T	199005.00	✓	C213T11FB1	173	230/460	8.6	89.5	1.15	18.23	C, CN
	1200	213T	LM16030	✓	AF6B3T61	127	230/460	9.0	87.5	1.15	17.20	A, US
	1200	213T	LM60027	D	CCF6B3T61AP21	170	230/460	9.6	89.5	1.25	18.19	C, CN
	900	215T	G151809.22	C/A	C215T8FB1	171	208-230/460	11.4	84.0	1.15	19.61	C, CA

Green items are Premium Efficient

▼ LM Numbers are Lincoln Models

C/A - Check Availability

Specifications are subject to change without notice

♥ Note listing on inside back flap

Continued On Next Page



Tech Information

Single Phase ODP Motors

Single Phase TEFC Motors

Single Phase C Face Motors

Three Phase ODP Motors

Three Phase TEFC Motors

Three Phase C Face Motors

Inverter Duty Motors

Severe Duty Motors

Three Phase Motors Totally Enclosed Fan Cooled

General Purpose - Standard,
EPAct and Premium Efficient - Three Phase Motors

Three Phase - TEFC - Rigid Base

HP	SYN RPM 60 Hz	NEMA Frame	▼ Catalog Number	Stock	Model Number	App. Wgt. (lbs)	Voltage	F. L. Amps @ 230 V	% F.L. Eff.	Service Factor	"C" Dim. (Inches)	♥Notes
5	3600	184T	131987.00	✓	C184T34FB20	88	208-230/460	12.0	88.5	1.25	16.46	S, MX
	3600	184T	LM15649	✓	AAF2BT61	89	230/460	11.8	89.5	1.25	16.19	A, US
	3600	184T	199006.00	✓	C184T34FB1	109	230/460	12.0	88.5	1.15	15.81	C, CN
	3600	184T	LM15869	C/A	CCF2BT61	108	230/460	11.8	88.5	1.15	15.81	C, US
1800	184T	184T	131464.00	✓	C184T17FB42	87	208-230/460	12.8	89.5	1.15	14.96	S, MX
	184T	184T	LM15650	✓	AAF4B5T61	104	230/460	12.4	90.2	1.25	16.19	A, US
	184T	184T	171322.60	✓	C184T17FB43	112	208-230/460	12.8	89.5	1.25	16.80	C, CN
	184T	184T	199007.00	✓	C184T17FB1	117	230/460	12.4	90.2	1.15	15.81	C, CN
1200	215T	215T	171379.60	✓	C215T11FB1	176	208-230/460	14.4	89.5	1.25	19.61	C, CN
	215T	215T	199008.00	✓	C215T11FB1	203	230/460	14.0	90.2	1.15	19.73	C, CN
	215T	215T	LM16033	✓	AF6B5T61	138	230/460	13.8	89.5	1.15	18.70	A, US
	215T	215T	LM32802	✓	SSF6BT61	140	230/460	14.0	90.2	1.15	20.23	S, US
900	254T	254T	G151355.22	✓	C254T8FB5	188	208-230/460	14.4	88.3	1.15	23.23	C, CA
	254T	254T	LM32803	✓	AF8P5T61	159	230/460	15.0	87.5	1.15	23.40	A, US
7 1/2	3600	213T	170158.60	✓	C215T11FB11	156	208-230/460	18.0	91.0	1.25	18.19	C, CN
	3600	213T	199009.00	✓	C213T34FB1	185	230/460	17.8	89.5	1.15	18.23	C, CN
	3600	213T	LM28968	✓	AF2B7.5T61	127	230/460	17.8	91.7	1.25	20.65	A, US
	3600	213T	LM60031	D	CCF2B7.5T61AP21	147	230/460	20.0	91.0	1.15	18.19	C, CN
	3600	213T	140756.00	✓	C213T34FB1	156	208-230/460	17.8	90.2	1.15	19.84	S, MX
	1800	213T	140450.00	✓	C213T17FB6	153	208-230/460	21.4	91.7	1.25	18.70	S, MX
1800	213T	213T	LM32805	✓	SSF4B7.5T61	144	230/460	19.4	91.7	1.15	20.23	S, US
	213T	213T	LM16029	✓	AF4B7.5T61	127	230/460	19.2	91.1	1.25	18.70	A, US
	213T	213T	170157.60	✓	C213T17FB43	158	208-230/460	18.6	91.7	1.25	18.19	C, CN
	213T	213T	199010.00	✓	C213T17FB1	194	230/460	18.6	91.7	1.15	18.23	C, CN
	213T	213T	LM24209	✓	CCF4B7.5T61	180	230/460	19.2	91.7	1.25	19.70	C, US
	213T	213T	LM60032	D	CCF4B7.5T61AP21	155	230/460	18.8	91.9	1.15	18.19	C, CN
	1200	254T	170122.60	✓	C254T11FB3	259	208-230/460	22.2	91.7	1.25	23.19	C, CN
	1200	254T	199011.00	✓	C254T11FB1	223	230/460	20.4	91.0	1.15	23.70	C, CN
	1200	254T	LM15672	✓	AF6B7.5T61	209	230/460	19.8	91.0	1.25	23.40	A, US
	900	256T	256T	G151356.22	✓	C256T8FB42	300	208-230/460	20.0	87.7	1.15	24.96
900	256T	256T	LM32807	✓	AF8P7.5T61	195	230/460	23.0	86.5	1.15	25.15	A, US

Green items are Premium Efficient

▼ LM Numbers are Lincoln Models

C/A - Check Availability

Specifications are subject to change without notice

♥ Note listing on inside back flap

Continued On Next Page



Three Phase Motors Totally Enclosed Fan Coolec

General Purpose - Standard,
EPAct and Premium Efficient - Three Phase Motors

Three Phase - TEFC - Rigid Base

HP	SYN RPM 60 Hz	NEMA Frame	▼ Catalog Number	Stock	Model Number	App. Wgt. (lbs)	Voltage	F. L. Amps @ 230 V	% F.L. Eff.	Service Factor	"C" Dim. (Inches)	♥ Notes	
10	3600	215T	140755.00	✓	C215T34FB11	170	208-230/460	23.6	91.7	1.15	21.09	S, MX	
	3600	215T	LM32808	✓	SSF2B10T61	172	230/460	23.6	91.7	1.15	21.48	S, US	
	3600	215T	170159.60	✓	C215T34FB47	181	208-230/460	23.4	91.7	1.25	19.61	C, CN	
	3600	215T	199012.00	✓	C215T34FB1	217	230/460	22.8	90.2	1.15	19.73	C, CN	
	3600	215T	LM16031	✓	AF2B10T61	185	230/460	23.6	91.7	1.25	19.70	A, US	
	1800	215T	140451.00	✓	C215T17FB18	161	208-230/460	26.6	91.7	1.25	19.70	S, MX	
	1800	215T	LM32809	✓	SSF4B10T61	168	230/460	26.0	91.7	1.25	21.48	S, US	
	1800	215T	170140.60	✓	C215T17FB43	196	208-230/460	25.0	91.7	1.25	19.61	C, CN	
	1800	215T	199013.00	✓	C215T17FB1	225	230/460	24.4	91.7	1.15	19.73	C, CN	
	1800	215T	LM16032	✓	AF4B10T61	160	230/460	26.9	91.7	1.25	18.70	A, US	
	1800	215T	LM60035	D	CCF4B10T61AP21	177	230/460	25.0	91.7	1.15	19.61	C, CN	
	1200	256T	170123.60	✓	C256T11FB4	310	208-230/460	29.0	91.7	1.25	24.92	C, CN	
	1200	256T	199014.00	✓	C256T11FB1	368	230/460	26.8	91.0	1.15	25.43	C, CN	
	1200	256T	LM15675	✓	AF6B10T61	236	230/460	26.2	91.0	1.25	25.15	A, US	
	900	284T	G150282.22	✓	C284T8FB2	346	208-230/460	26.0	88.8	1.15	26.26	C, CA	
15	3600	215T	170615.60	✓	C215T34FB13	223	208-230/460	35.0	92.4	1.15	19.61	C, CN	
	3600	254T	170062.60	✓	C254T34FB4	292	208-230/460	35.0	92.4	1.25	23.19	C, CN	
	3600	254T	199015.00	✓	C254T34FB1	350	230/460	34.0	91.0	1.15	23.70	C, CN	
	3600	254T	LM15670	✓	AAF2B15T61	215	230/460	35.0	91.7	1.25	23.40	A, US	
	3600	254T	LM60037	D	CCF2B15T61AP21	282	230/460	34.5	92.4	1.15	23.19	C, CN	
	1800	254T	170066.60	✓	C254T17FB10	290	208-230/460	36.0	92.4	1.25	23.19	C, CN	
	1800	254T	199016.00	✓	C254T17FB1	375	230/460	37.0	92.4	1.15	23.70	C, CN	
	1800	254T	LM15671	✓	AAF4B15T61	209	230/460	37.5	92.4	1.25	23.40	A, US	
	1800	254T	LM24208	✓	CCF4B15T61	322	230/460	37.5	92.4	1.25	23.52	C, US	
	1800	254T	LM60038	D	CCF4515T61AP21	280	230/460	36.5	93.4	1.15	23.19	C, CN	
	1200	284T	170068.60	✓	C284T11FB4	380	208-230/460	40.6	92.4	1.25	26.26	C, CN	
	1200	284T	199017.00	✓	C284T11FB1	475	230/460	39.5	91.7	1.15	27.83	C, CN	
	900	286T	G150261.22	✓	G150261.22	480	208-230/460	40.0	91.0	1.15	27.83	C, CA	
	20	3600	256T	170033.60	✓	C256T34FB10	332	208-230/460	46.0	92.4	1.15	24.92	C, CN
		3600	256T	199018.00	✓	C256T34FB1	375	230/460	46.0	91.0	1.15	27.80	C, CN
3600		256T	LM15673	✓	AF2B0T61	325	230/460	47.0	92.4	1.25	25.15	A, US	
3600		256T	LM60040	D	CCF2B20T61AP21	316	230/460	46.0	92.4	1.15	24.92	C, CN	
1800		256T	170007.60	✓	C256T17FB4	332	208-230/460	49.0	93.0	1.15	24.92	C, CN	
1800		256T	199019.00	✓	C256T17FB1	425	230/460	48.0	93.0	1.15	27.80	C, CN	
1800		256T	LM15674	✓	AAF4B20T61	295	230/460	48.0	93.0	1.25	25.15	A, US	
1800		256T	LM60041	D	CCF4B20T61AP21	322	230/460	49.0	93.0	1.15	24.92	C, CN	
1200		286T	170001.60	✓	C286T11FB6	406	208-230/460	54.0	91.7	1.15	27.83	C, CN	
1200		286T	199020.00	✓	C286T11FB1	550	230/460	52.0	91.7	1.15	31.34	C, CN	
900		324T	G150263.22	C/A	C324T8FB3	640	208-230/460	54.0	91.0	1.15	29.53	C, CA	

Green items are Premium Efficient

▼ LM Numbers are Lincoln Models

C/A - Check Availability

Specifications are subject to change without notice

♥ Note listing on inside back flap
Continued On Next Page



Tech Information

Single Phase
ODP Motors

Single Phase
TEFC Motors

Single Phase
C Face Motors

Three Phase
ODP Motors

Three Phase
TEFC Motors

Three Phase
C Face Motors

Inverter Duty
Motors

Severe Duty
Motors

Three Phase Motors Totally Enclosed Fan Cooled

General Purpose - Standard,
EPA and Premium Efficient - Three Phase Motors

Three Phase - TEFC - Rigid Base

HP	SYN RPM 60 Hz	NEMA Frame	▼ Catalog Number	Stock	Model Number	App. Wgt. (lbs)	Voltage	F. L. Amps @ 230 V	% F.L. Eff.	Service Factor	"C" Dim. (Inches)	♥ Notes
25	3600	284TS	170035.60	√	C284T34FB5	393	208-230/460	56.8	93.0	1.15	24.88	C, CN
			199021.00	√	C284T34FB1	475	230/460	55.5	91.7	1.15	28.82	C, CN
			LM13960	√	AF2B25TS61Y	385	230/460	56.0	92.4	1.25	25.25	A, US
			LM60043	D	CCF2B25T61AP21	383	230/460	56.5	93.0	1.15	24.86	C, CN
			LM32811	C/A	AF2B25T61Y	433	230/460	56.0	92.4	1.25	26.62	A, US
1800	284T	284T	170011.60	√	C284T17FB5	395	208-230/460	59.0	93.6	1.15	26.26	C, CN
			199022.00	√	C284T17FB1	500	230/460	62.0	93.6	1.15	30.16	C, CN
			LM13961	√	AF4B25T61Y	495	230/460	64.0	93.6	1.25	26.62	A, US
			170003.60	√	C324T11FB3	555	208-230/460	66.0	93.0	1.15	29.53	C, CN
			199023.00	√	C324T11FB1	675	230/460	66.0	93.0	1.15	32.68	C, CN
900	326T	G150265.22	C/A	C326T8FB2	700	208-230/460	63.0	90.2	1.15	31.02	C, CA	
30	3600	286TS	170037.60	√	C286T34FB4	423	208-230/460	67.0	93.0	1.15	26.46	C, CN
			199024.00	√	C286T34FB1	500	230/460	66.0	91.7	1.15	30.00	C, CN
			LM60046	D	CCF2B30TS61AP21	385	230/460	69.0	94.1	1.15	26.36	C, CN
			LM32813	√	AF2B30T61Y	438	230/460	66.0	92.4	1.25	28.12	A, US
			170015.60	√	C286T17FB5	442	208-230/460	70.0	94.1	1.15	27.83	C, CN
1800	286T	286T	199025.00	√	C286T17FB1	525	230/460	73.0	93.6	1.15	31.34	C, CN
			LM13964	√	AF4B30T61Y	426	230/460	75.0	93.6	1.25	28.12	A, US
			170005.60	√	C326T11FB3	624	208-230/460	77.0	93.6	1.15	31.02	C, CN
			199026.00	√	C326T11FB1	725	230/460	80.0	93.0	1.15	33.86	C, CN

Green items are Premium Efficient

♥ Note listing on inside back flap

▼ LM Numbers are Lincoln Models

Continued On Next Page

C/A - Check Availability

Specifications are subject to change without notice

Single Phase ODP Motors

Single Phase TEFC Motors

Single Phase C Face Motors

Three Phase ODP Motors

Three Phase TEFC Motors

Three Phase C Face Motors

Inverter Duty Motors

Severe Duty Motors



Three Phase Motors Totally Enclosed Fan Cooled

General Purpose - Standard,

EPAct and Premium Efficient - Three Phase Motors

Three Phase - TEFC - Rigid Base

HP	SYN RPM 60 Hz	NEMA Frame	▼ Catalog Number	Stock	Model Number	App. Wgt. (lbs)	Voltage	F. L. Amps @ 230 V	% F.L. Eff.	Service Factor	"C" Dim. (Inches)	♥ Notes	
40	3600	324TS	170039.60	✓	C324T34FB3	510	208-230/460	89.0	93.6	1.25	28.03	C, CN	
			199027.00	✓	C324T34FB1	675	230/460	88.0	92.4	1.15	31.26	C, CN	
	3600	324TS	LM60049	D	CCF2B40TS61AP21	504	230/460	90.0	93.6	1.15	38.03	C, CN	
			LM32671	C/A	SF2B40T61Y	535	230/460	88.0	93.6	1.25	28.50	S, US	
	1800	324TS	LM32686	✓	SF4B40TS61Y	504	230/460	101.0	94.1	1.25	27.00	S, US	
			170019.60	✓	C324T17FB5	539	230/460	92.0	94.1	1.15	29.53	C, CN	
	1800	324T	199028.00	✓	C324T17FB1	750	230/460	94.0	94.1	1.15	32.68	C, CN	
			LM13699	✓	SF4B40T61Y	504	230/460	101.0	94.1	1.25	28.50	S, US	
	1200	364T	170096.60	✓	C364T11FB4	875	208-230/460	102.0	94.1	1.15	32.64	C, CN	
			199029.00	✓	C364T11FB1	950	230/460	94.0	94.1	1.15	36.61	C, CN	
	50	3600	326TS	170041.60	✓	C326T34FB4	564	208-230/460	111.0	94.5	1.25	29.53	C, CN
				199030.00	✓	C326T34FB1	725	230/460	109.0	93.0	1.15	32.44	C, CN
3600		326T	LM32669	C/A	SF2B50T61Y	558	230/460	111.0	94.1	1.25	30.00	S, US	
			LM32815	C/A	SF4B50TS61Y	558	230/460	127.0	94.5	1.25	34.50	S, US	
1800		326T	170023.60	✓	C326T17FB7	587	208-230/460	117.0	94.5	1.15	31.02	C, CN	
			199031.00	✓	C326T17FB1	775	230/460	119.0	94.5	1.15	33.86	C, CN	
1800		326T	LM13701	✓	SF4B50T61Y	585	230/460	127.0	94.5	1.25	36.00	S, US	
			170097.60	✓	C365T11FB5	893	208-230/460	124.0	94.1	1.15	33.62	C, CN	
1200		365T	199032.00	✓	C365T11FB1	1000	230/460	117.0	94.1	1.15	38.39	C, CN	
			LM60054	D	CCF6B50T61AP21	672	230/460	126.0	94.1	1.15	32.50	C, CN	
60		3600	364TS	170043.60	✓	C364T34FB3	849	208-230/460	136.0	94.1	1.15	30.51	C, CN
				199033.00	✓	C364T34FB1	925	230/460	132.0	93.6	1.15	34.57	C, CN
	1800	364T	170027.60	✓	C364T17FB6	988	208-230/460	137.0	95.4	1.15	32.64	C, CN	
			199034.00	✓	C364T17FB1	1000	230/460	138.0	95.0	1.15	36.61	C, CN	
	1800	364T	LM14809	✓	SF4B60T61Y	765	230/460	144.0	95.0	1.25	31.90	S, US	
			LM60056	D	CCF4B60T61AP21	666	230/460	139.0	95.4	1.15	31.50	C, CN	
	1200	404T	170098.60	✓	C404T11FB3	1035	208-230/460	142.0	94.5	1.25	36.42	C, CN	
			199035.00	✓	C404T11FB1	1200	230/460	140.0	94.5	1.15	42.72	C, CN	
	1200	404T	LM60057	D	CCF6B60T61AP21	870	230/460	142.0	95.0	1.15	36.42	C, CN	

Green items are Premium Efficient

▼ LM Numbers are Lincoln Models

C/A - Check Availability

Specifications are subject to change without notice

♥ Note listing on inside back flap

Continued On Next Page



Tech Information

Single Phase
ODP Motors

Single Phase
TEFC Motors

Single Phase
C Face Motors

Three Phase
ODP Motors

Three Phase
TEFC Motors

Three Phase
C Face Motors

Inverter Duty
Motors

Severe Duty
Motors

Three Phase Motors Totally Enclosed Fan Cooled

General Purpose - Standard,
EPA and Premium Efficient - Three Phase Motors

Three Phase - TEFC - Rigid Base

HP	SYN RPM 60 Hz	NEMA Frame	▼ Catalog Number	Stock	Model Number	App. Wgt. (lbs)	Voltage	F. L. Amps @ 460V	% F.L. Eff.	Service Factor	"C" Dim. (Inches)	♥Notes
75	3600	365TS	170045.60	✓	C365T34FB3	889	208-230/460	169.0	94.5	1.15	31.50	C, CN
	3600	365TS	199036.00	✓	C365T34FB1	1025	230/460	164.0	94.1	1.15	36.34	C, CN
	3600	365TS	LM60058	D	CCF2B75TS61AP21	780	230/460	167.0	94.5	1.15	31.50	C, CN
1800	365TS	LM32672	✓	SF4B75TS61Y	822	230/460	178.0	95.4	1.25	30.77	S, US	
	365T	170031.60	✓	C365T17FB4	1050	208-230/460	171.0	95.8	1.15	33.62	C, CN	
	365T	199037.00	✓	C365T17FB1	1100	230/460	170.0	95.4	1.15	38.39	C, CN	
1800	365T	LM14811	✓	SF4B75T61Y	822	230/460	178.0	95.4	1.15	32.90	S, US	
	405T	170099.60	✓	C405T11FB5	995	208-230/460	176.0	95.0	1.25	37.91	C, CN	
	405T	199038.00	✓	C405T11FB1	1300	230/460	174.0	94.5	1.15	42.72	C, CN	
1200	405T	LM60060	D	CCF6B75T61AP21	975	230/460	176.0	95.0	1.15	37.91	C, CN	
	3600	405TS	170160.60	✓	C405T34FB5	975	208-230/460	218.0	95.0	1.25	34.92	C, CN
	3600	405TS	199039.00	✓	C405T34FB1	1250	230/460	216.0	94.5	1.15	39.76	C, CN
3600	405TS	LM60061	D	CCF2B100TS61AP21	955	230/460	218.0	95.0	1.15	34.92	C, CN	
	1800	405TS	LM32819	✓	SF4B100TS61Y	1052	230/460	244.0	95.4	1.15	35.40	S, US
	1800	405T	170087.60	✓	C405T17FB4	1090	208-230/460	225.0	95.4	1.15	37.91	C, CN
1800	405T	199040.00	✓	C405T17FB1	1375	230/460	224.0	95.4	1.15	42.72	C, CN	
	405T	LM13940	✓	SF4B100T61Y	1052	230/460	244.0	95.4	1.15	38.40	S, US	
	444T	170256.60	✓	C444T11FB6	1457	460	121.0*	95.0	1.25	42.87	C, CN	
1200	444T	199041.00	✓	C444T11FB1	2000	230/460	228.0	95.0	1.15	50.79	C, CN	
	3600	444TS	171580.60	✓	C444T34FB8	1373	460	132.0*	95.0	1.25	39.10	C, CN
	3600	444TS	199042.00	✓	C444T34FB1	1750	460	136.0*	95.0	1.15	47.05	C, CN
3600	444TS	LM60064	D	CCF2B125TS64AP21	1950	460	136.0*	95.4	1.25	37.00	C, CN	
	1800	444TS	LM32820	C/A	SF4B125TS64Y	1351	460	146.0*	96.2	1.15	37.83	S, US
	1800	444T	170369.60	✓	C444T17FB5	1576	460	137.0*	95.4	1.25	42.87	C, CN
1800	444T	199043.00	✓	C444T17FB1	1850	460	140.0*	95.4	1.15	50.79	C, CN	
	444T	LM13704	✓	SF4B125T64Y	1351	460	146.0*	96.2	1.15	41.58	S, US	
	444T	LM60065	✓	CCF4B125T64AP21	1950	460	137.0*	95.4	1.15	42.87	C, CN	
1200	445T	170260.60	✓	C445T11FB5	1596	460	155.0*	95.4	1.25	44.88	C, CN	
	445T	199044.00	✓	C445T11FB1	2050	460	142.0*	95.0	1.15	50.79	C, CN	
	445T	LM60066	D	CCF6B125T64AP21	1316	460	160.0*	95.5	1.15	43.00	C, CN	

Green items are Premium Efficient

* F.L. Amps at 230V

▼ LM Numbers are Lincoln Models

C/A - Check Availability

Specifications are subject to change without notice

♥ Note listing on inside back flap

Continued On Next Page



Three Phase Motors Totally Enclosed Fan Cooled

General Purpose - Standard, EAct and Premium Efficient - Three Phase Motors

Three Phase - TEFC - Rigid Base

HP	SYN RPM 60 Hz	NEMA Frame	▼ Catalog Number	Stock	Model Number	App. Wgt. (lbs)	Voltage	F. L. Amps @ 460 V	% F.L. Eff.	Service Factor	"C" Dim. (Inches)	♥ Notes
150	3600	445TS	171578.60	✓	C445T34FB3	1445	460	163.0	95.0	1.15	44.88	C, CN
		445TS	199045.00	✓	C445T34FB1	2050	460	162.0	95.0	1.15	47.05	C, CN
		445TS	LM60067	D	CCF2B150T64AP21	1627	460	163.0	95.0	1.15	39.49	C, CN
	1800	445TS	LM32679	C/A	SF4B150TS64Y	1504	460	168.0	96.2	1.15	39.49	S, US
		445T	170371.60	✓	C445T17FB8	1627	460	163.0	95.8	1.15	44.88	C, CN
		445T	199046.00	✓	C445T17FB1	2050	460	165.0	95.8	1.15	50.79	C, CN
		445T	LM13707	✓	SF4B150T64Y	1531	460	168.0	96.2	1.15	43.58	S, US
		445T	LM60068	D	CCF4B150T64AP21	2230	460	164.0	95.8	1.15	43.00	C, CN
		447T	171315.60	✓	C447T11FB1	2230	460	185.0	95.8	1.25	48.00	C, CN
1200	447T	199047.00	✓	C447T11FB1	2500	460	170.0	95.8	1.15	55.91	C, CN	
	447T	LM60069	D	CCF6B150T64AP21	1445	460	186.0	96.2	1.15	46.50	C, CN	
	200	3600	447TS	171579.60	✓	C447T34FB3	2100	460	216.0	95.4	1.25	48.00
447TS			199048.00	✓	C447T34FB1	2300	460	215.0	95.4	1.15	52.17	C, CN
445TS			LM13709	✓	SF2B200TS64Y	1531	460	211.0	95.4	1.15	39.49	S, US
1800		447TS	LM60070	D	CCF2B200T64AP21	2227	460	216.0	95.4	1.15	51.00	C, CN
		447T	170352.60	✓	C447T17FB8	2785	460	216.0	96.2	1.15	48.00	C, CN
		447T	199049.00	✓	C447T17FB1	2350	460	225.0	96.2	1.15	55.91	C, CN
		445T	LM13710	✓	SF4B200T64Y	1531	460	227.0	95.0	1.15	43.58	S, US
		449T	171316.60	✓	C449T11FB1	2542	460	241.0	96.2	1.25	52.80	C, CN
		449T	199050.00	✓	C449T11FB1	2900	460	228.0	95.8	1.15	55.91	C, CN
250	3600	449TS	LM16222	C/A	SF2P250TS64Y	2185	460	263.0	95.8	1.15	47.99	S, US
		447TS	LM13556	C/A	SF2P250TS64Y	1812	460	263.0	95.4	1.15	42.99	S, US
	1800	449T	G151516.60	✓	C449T17FB3	2541	460	274.0	95.0	1.15	52.80	C, CN
		447T	LM13713	C/A	SF4B250T64Y	1812	460	282.0	95.4	1.15	47.08	S, US
		447T	LM13557	✓	SF4P250T64Y	1812	460	283.0	95.0	1.15	47.08	S, US
		449T	LM30826	C/A	CCF6P250T64Y	3408	460	300.0	95.4	1.15	51.86	C, US

Green items are Premium Efficient

▼ LM Numbers are Lincoln Models

C/A - Check Availability

Specifications are subject to change without notice

♥ Note listing on inside back flap

Continued On Next Page



Tech Information

Single Phase
ODP Motors

Single Phase
TEFC Motors

Single Phase
C Face Motors

Three Phase
ODP Motors

Three Phase
TEFC Motors

Three Phase
C Face Motors

Inverter Duty
Motors

Severe Duty
Motors

Three Phase Motors Totally Enclosed Fan Cooled

General Purpose - Standard,
EPAct and Premium Efficient - Three Phase Motors

Three Phase - TEFC - Rigid Base

HP	SYN RPM 60 Hz	NEMA Frame	▼ Catalog Number	Stock	Model Number	App. Wgt. (lbs)	Voltage	F. L. Amps @ 460 V	% F.L. Eff.	Service Factor	"C" Dim. (Inches)	♥Notes
300	3600	449TS	LM13715	C/A	SF2B300TS64Y	2185	460	314.0	95.8	1.15	47.99	S, US
		449TS	LM13559	C/A	SF2P300TS64Y	2185	460	315.0	95.4	1.15	47.99	S, US
	1800	449TS	LM18347	C/A	SF4P300TS64Y	2185	460	338.0	95.0	1.15	47.99	S, US
		449T	G151529.60	√	C449T17FB9	2558	460	327.0	95.4	1.15	52.80	C, CN
		447T	LM13716	C/A	SF4B300T64Y	2185	460	352.0	95.8	1.15	47.08	S, US
		449T	LM17953	√	SF4P300T64Y	1812	460	338.0	95.4	1.15	52.08	S, US
1800	447T	LM13560	√	SF4P300T64Y	2185	460	353.0	95.4	1.00	47.08	S, US	
350	3600	449TS	LM13719	C/A	SFB350TS64Y	2185	460	370.0	95.8	1.15	47.99	S, US
		449TS	LM13562	C/A	SF2350TS64Y	2185	460	367.0	95.4	1.00	47.99	S, US
		449TS	LM19577	C/A	CCF2P350TS64Y	3050	460	380.0	95.4	1.15	48.09	C, US
	1800	449T	G151530.60	√	C449T17FB10	2710	460	402.0	95.4	1.15	52.80	C, CN
		449T	LM13563	C/A	SF4P350T64Y	2185	460	395.0	95.4	1.15	52.08	S, US
		449TS	LM13721	C/A	SF2B400TS64Y	2185	460	420.0	95.4	1.00	47.99	S, US
400	3600	449TS	LM13564	C/A	SF2P400TS64Y	2185	460	424.0	94.1	1.00	47.99	S, US
		449T	LM33803	C/A	CCF4B400T64YE3	3558	460	460.0	96.5	1.15	56.71	C, US
	1800	449T	LM13565	C/A	SF4P400T64Y	2185	460	447.0	95.4	1.00	52.08	S, US

Green items are Premium Efficient

♥ Note listing on inside back flap

▼ LM Numbers are Lincoln Models

C/A - Check Availability

Specifications are subject to change without notice



Three Phase Motors Totally Enclosed

Resilient Base Motors - Three Phase General Purpose or Fan & Blower Service

Features:

- Industrial duty designs
- Suitable for belt driven or fan-on-shaft applications
- Ball bearings



Three Phase - Totally Enclosed - Resilient Base

HP	SYN RPM 60 Hz	NEMA Frame	Catalog Number	Stock
1/2	1800	56	111917.00	√
1	1800	56	111918.00	√

Model Number	App. Wgt. (lbs)	Voltage	F. L. Amps @ 230 V	% F.L. Eff.	Service Factor	"C" Dim. (Inches)	♥Notes
C6T17NR1	25	208-230/460	1.8	78.5	1.15	11.31	S, US, 6, 12
C6T17FR1	29	208-230/460	3.8	77.0	1.15	12.51	S, US, 6, 13

Note 12 - TENV

Specifications are subject to change without notice

♥ Note listing on inside back flap

Tech Information

Single Phase
ODP Motors

Single Phase
TEFC Motors

Single Phase
C Face Motors

Three Phase
ODP Motors

Three Phase
TEFC Motors

Three Phase
C Face Motors

Inverter Duty
Motors

Severe Duty
Motors



Three Phase Motors Totally Enclosed Compressor Duty

General Specifications:

Motors designed for air compressor, pump, fan and blower duty applications which require high breakdown torque and rugged mechanical construction.



Mechanical Features:

- Double shielded ball bearings
- Designed for belted loads
- Class F insulation

Three Phase - TEFC - Rigid Base

HP	SYN RPM 60 Hz	NEMA Frame	▼ Catalog Number	Stock
3	1800	182T	131463.00	✓
		182T	LM32741	✓
5	1800	182T	131464.00	✓
		182T	LM33266	✓
7 1/2	1800	213T	140450.00	✓
		213T	LM32805	✓
10	1800	215T	140451.00	✓
		215T	LM32809	✓
15	1800	254T	170066.60	✓
		254T	LM24208	✓
20	1800	256T	170007.60	✓

Model Number	App. Wgt. (lbs)	Voltage	F. L. Amps @ 230 V	% F.L. Eff.	Service Factor	"C" Dim. (Inches)	♥Notes
C182T17FB32	80	208-230/460	7.8	89.5	1.15	13.96	S, MX
SSF4B3T61	77	208-230/460	7.8	89.5	1.15	13.96	S, MX
C184T17FB42	94	208-230/460	12.8	89.5	1.15	15.96	S, MX
SSF4B5T61	85	208-230/460	12.6	89.5	1.15	14.96	S, MX
C213T17FB6	144	208-230/460	21.4	91.7	1.25	18.70	S, MX
SSF4B7.5T6	115	208-230/460	19.4	91.7	1.25	20.23	S, MX
C215T17FB18	161	208-230/460	26.6	91.7	1.25	19.70	S, MX
SSF4B10T6	135	208-230/460	26.0	91.7	1.25	21.48	S, MX
C254T17FB10	280	208-230/460	36.0	92.4	1.25	23.19	C, CN
CCF4B15T6	322	208-230/460	37.5	92.4	1.25	25.27	C, US
C256T17FB4	322	208-230/460	49.0	93.0	1.15	24.92	C, CN

Green items are Premium Efficient

▼ LM Numbers are Lincoln Models

C/A - Check Availability

Specifications are subject to change without notice

♥ Note listing on inside back flap

Three Phase Motors Totally Enclosed TENV Motors - Three Phase - Rigid Base



Three Phase - TENV - Rigid Base

HP	SYN RPM 60 Hz	NEMA Frame	Catalog Number	Stock
1/6	3600	42	092014.00	C/A
	1800	42	092015.00	✓
1/4	3600	42	092016.00	C/A
	1800	48	100123.00	✓
	1800	S56	101649.00	✓
1/3	3600	48	101013.00	✓
	1800	48	100443.00	✓
	1800	S56	102920.00	✓
1/2	3600	56	110143.00	✓
	1800	S56	102918.00	✓
3/4	1800	56	114309.00	✓
1	1800	143T	121098.00	✓
1 1/2	1800	145T	121099.00	✓

Model Number	App. Wgt. (lbs)	Voltage	F. L. Amps @ 230 V	% F.L. Eff.	Service Factor	"C" Dim. (Inches)	♥ Notes
C42T34NB2	13	208-230/460	0.7	65.0	1.00	7.56	S, US
C42T17NB1	14	208-230/460	0.9	61.0	1.00	7.81	S, US
C42T34NB3	15	208-230/460	0.9	62.0	1.00	8.06	S, US
C4T17NB3	16	208-230/460	1.0	78.0	1.15	9.18	S, MX
C4T17NH8	16	208-230/460	1.0	78.0	1.15	9.56	S, MX
C4T34NB3	17	208-230/460	1.2	72.0	1.15	9.06	S, US
C4T17NB5	19	208-230/460	1.4	78.0	1.15	9.56	S, MX
C4T17NH13	20	208-230/460	1.3	77.0	1.15	9.56	S, MX
C6T34NB1	25	208-230/460	1.5	67.0	1.15	10.38	S, US
C4T17NH12	21	208-230/460	1.8	77.0	1.15	10.06	S, MX
C6T17NB53	30	208-230/460	2.5	80.0	1.15	10.89	S, US
C143T17NB6	35	208-230/460	3.2	80.0	1.15	11.83	S, US
C145T17NB9	47	208-230/460	4.2	80.0	1.15	13.33	S, US

Specifications are subject to change without notice

♥ Note listing on inside back flap

Tech Information

Single Phase
ODP Motors

Single Phase
TEFC Motors

Single Phase
C Face Motors

Three Phase
ODP Motors

Three Phase
TEFC Motors

Three Phase
C Face Motors

Inverter Duty
Motors

Severe Duty
Motors

Three Phase Motors Totally Enclosed

F2 Conduit Box Mount Motors - TEFC - Three Phase

General Purpose Applications



Three Phase - TEFC - Rigid Base

HP	SYN RPM 60 Hz	NEMA Frame	Catalog Number	Stock
3	1800	182T	132237.00	✓
5	1800	184T	132236.00	✓
7 1/2	1800	213T	140832.00	C/A

Model Number	App. Wgt. (lbs)	Voltage	F. L. Amps @ 230 V	% F.L. Eff.	Service Factor	"C" Dim. (Inches)	Inverter speed range	♥Notes
C182T17FB50	80	208-230/460	7.8	89.5	1.15	14.96	S, MX	S, MX
C184T17FB62	94	208-230/460	12.8	89.5	1.15	15.96	S, MX	S, MX
C213T17FB18	154	208-230/460	21.4	91.7	1.25	18.70	S, MX	S, MX

Green items are Premium Efficient

♥ Note listing on inside back flap

Note: For larger F2 mount motors, G150 & 170 Series cast iron motors may be converted to F2 by reassembly. Contact factory for F2 mounting for Lincoln Brand motors

C/A - Check Availability

Specifications are subject to change without notice



Three Phase Motors Totally Enclosed

SUB-FHP MOTORS - Inverter Rated - Three Phase

Features:

- Designed with the exclusive inverter rated insulation system (IRIS)
- Provides superior protection against voltage spikes induced by variable frequency drives
- Double shielded motor ball bearings
- Needle bearings in the parallel shaft gearboxes
- Ball bearings in the Right angle (worm) gearboxes
- Steel conduit box provided as standard
- Finished in high gloss hardened black enamel paint

Application Notes:

- Designed with high temperature insulation (Class F) to prevent overheating when operated with a PWM inverter down to a 10:1 speed range from the printed motor's speed range

Three Phase - 230 Volt - Totally Enclosed

HP	SYN RPM 60 Hz	NEMA Frame	Catalog Number	Stock
1/15	1725	38	M1140171.00	√
1/6	1725	38	M1140173.00	C/A
1/4	1725	38	M1140172.00	C/A

Model Number	App. Wgt. (lbs)	Voltage	F. L. Amps @ 230	♥Notes
CM38T17NK1	7	230	0.4	S, US, 12
CM38T17NK2	8	230	0.7	S, US, 12
CM38T17FK3	9	230	1.1	S, US, 13

C/A - Check Availability
Note 12 - TENV

Specifications are subject to change without notice

♥ Note listing on inside back flap

38 Frame NEMA C-Face With Base Dimensions

Catalog Number	AG	P	U	AH	BB	AJ	TAP	R	AK	BB	D	BA	E	F	H
M1140171.00	5.14	3.85	0.5	1.63	1	3.75	1/3/16	4.25	3.0	0.1	3.00	2.50	2.125	1.375	11/32 Slot
M1140173.00	6.14	3.85	0.5	1.63	1	3.75	1/3/16	4.25	3.0	0.1	3.00	2.50	2.125	1.375	11/32 Slot
M1140172.00	7.56	4.43	0.5	1.63	1	3.75	1/3/16	4.25	3.0	0.1	3.00	2.50	2.125	1.375	11/32 Slot

Specifications are subject to change without notice

AC 38 48C ALL DIMENSIONS IN INCHES

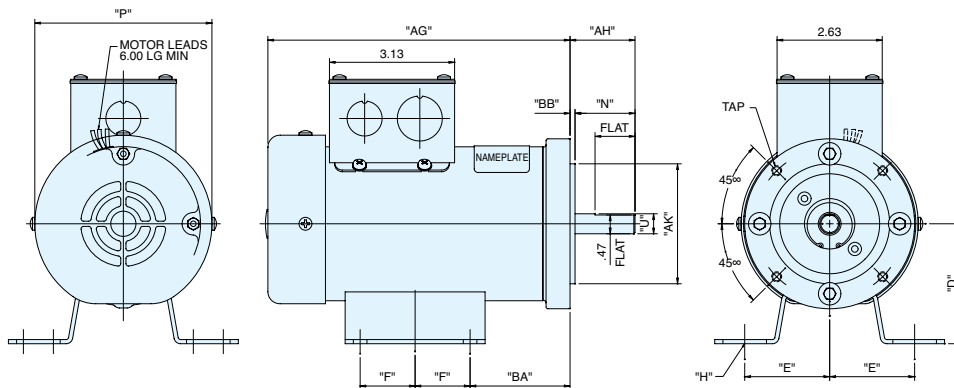

Both motors only and gearmotors will have inverter rated printed on the nameplate.
UL and CSA recognition for both motors only and gearmotors



Tech Information

Single Phase
ODP Motors

Single Phase
TEFC Motors

Single Phase
C Face Motors

Three Phase
ODP Motors

Three Phase
TEFC Motors

Three Phase
C Face Motors

Inverter Duty
Motors

Severe Duty
Motors