

# PRODUCT INFORMATION PACKET

Model No: 056T17V5326  
Catalog No: N640  
1/4, 1800, TENV, 56C, 3/60/208-230/460  
Washdown Duty



Regal and Marathon are trademarks of Regal Beloit Corporation or one of its affiliated companies.

©2018 Regal Beloit Corporation, All Rights Reserved. MC017097E





### Nameplate Specifications

Output HP	<b>0.25 Hp</b>	Output KW	<b>0.19 kW</b>
Frequency	<b>60 Hz</b>	Voltage	<b>208-230/460 V</b>
Current	<b>1.1/0.55 A</b>	Speed	<b>1725 rpm</b>
Service Factor	<b>1.15</b>	Phase	<b>3</b>
Efficiency	<b>68 %</b>	Duty	<b>Continuous</b>
Insulation Class	<b>F</b>	Design Code	<b>B</b>
KVA Code	<b>L</b>	Frame	<b>56C</b>
Enclosure	<b>Totally Enclosed Non Ventilated</b>	Overload Protector	<b>No</b>
Ambient Temperature	<b>40 °C</b>	Drive End Bearing Size	<b>6205</b>
Opp Drive End Bearing Size	<b>6203</b>	UL	<b>Recognized</b>
CSA	<b>Y</b>	CE	<b>Y</b>
IP Code	<b>55</b>		

### Technical Specifications

Electrical Type	<b>Squirrel Cage Inverter Rated</b>	Starting Method	<b>Line Or Inverter</b>
Poles	<b>4</b>	Rotation	<b>Reversible</b>
Mounting	<b>Round</b>	Motor Orientation	<b>Horizontal</b>
Drive End Bearing	<b>Ball</b>	Opp Drive End Bearing	<b>Ball</b>
Frame Material	<b>Stainless Steel</b>	Shaft Type	<b>NEMA 56</b>
Overall Length	<b>9.56 in</b>	Frame Length	<b>4.50 in</b>
Shaft Diameter	<b>0.625 in</b>	Shaft Extension	<b>1.94 in</b>
Assembly/Box Mounting	<b>F1 Only</b>		
Outline Drawing	<b>028834ME-450</b>	Connection Diagram	<b>005010-01ME</b>

RBC PROPRIETARY AND CONFIDENTIAL INFORMATION

This document is the property of REGAL BELOIT CORPORATION ("RBC") including its subsidiaries and divisions and contains proprietary information of RBC. This document is loaned on the express condition that neither it nor the information contained therein shall be disclosed to others without the express written consent of RBC, and that the information shall be used by the recipient only as approved expressly by RBC. This document shall be returned to RBC upon its request. This document may be subject to certain restrictions under U.S. export control laws and regulations.

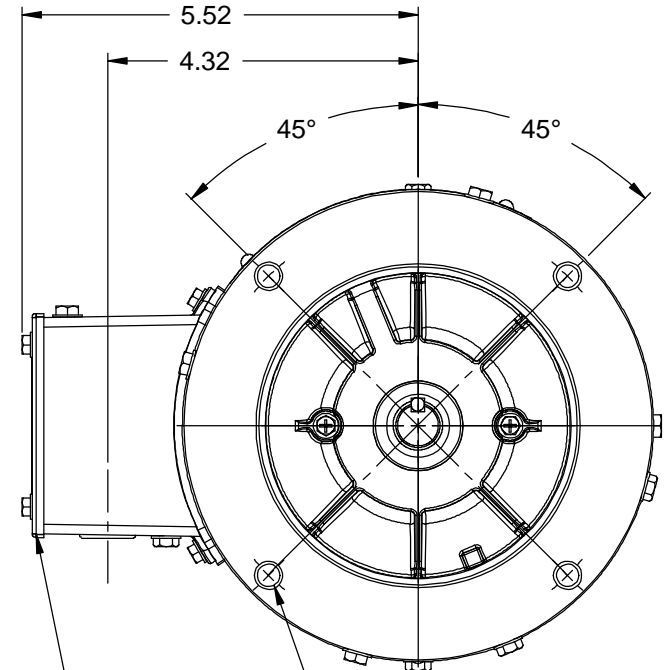
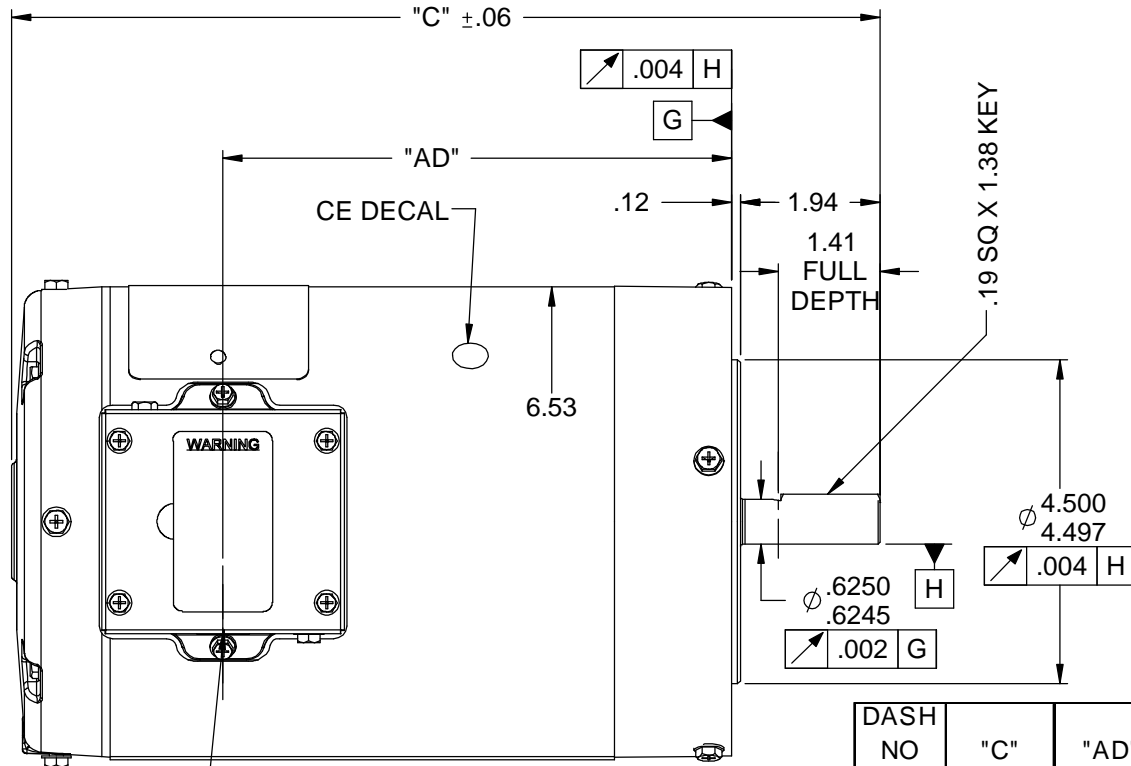

DASH NO	"C"	"AD"
450	9.56	4.50
500	10.06	5.00
550	10.56	5.50
600	11.06	6.00
650	11.56	6.50
700	12.06	7.00
750	12.56	7.50
800	13.06	8.00

- NOTE:
- 1) SHAFT SEALS & V-RINGS
  - 2) PLUGGED DRAIN HOLES IN BOTH ENDBELLS & CONDUIT BOX
  - 3) GASKETS THROUGHOUT
  - 4) STAINLESS STEEL SHAFT, HARDWARE & NAMEPLATE

		TOLERANCES UNLESS SPECIFIED		MARATHON ELECTRIC	DRAWN DJ 04/21/08	
		DEC	INCHES		CHK LST 04/22/08	
		.X	±.1	TITLE OUTLINE - 56C FRAME TENV - "C" FACE	APPR	
		.XX	±.03		SCALE 3:8	
		.XXX	±.005		REF	
		.XXXX	±.0005		MAT'L WASHGUARD	
01	ADDED PLUGGED TO DRAIN HOLE NOTE ISAAC 12-4474	GS	9/17/12	FINISH	FMF 56T17V5326	
NO	REVISION	BY & DATE	CHK ANG ±1/2°	RFP	PAGE	OF
THIRD ANGLE PROJECTION				PREV	SIZE	DRAWING NO
					A	028834ME
						REV 01

VIEW FROM OUTSIDE OF MOTOR AT SWITCH END.

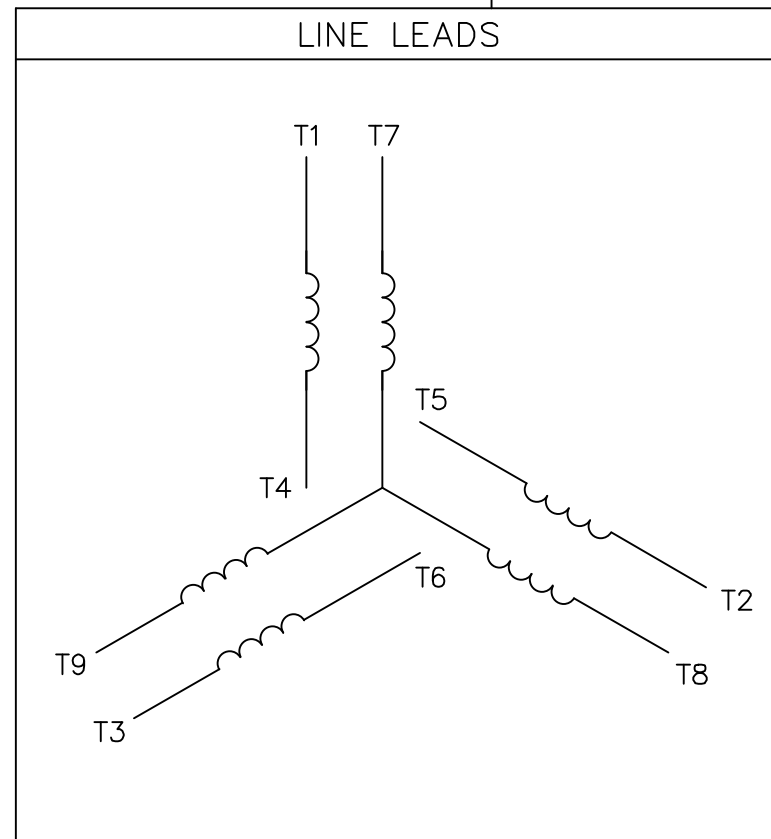
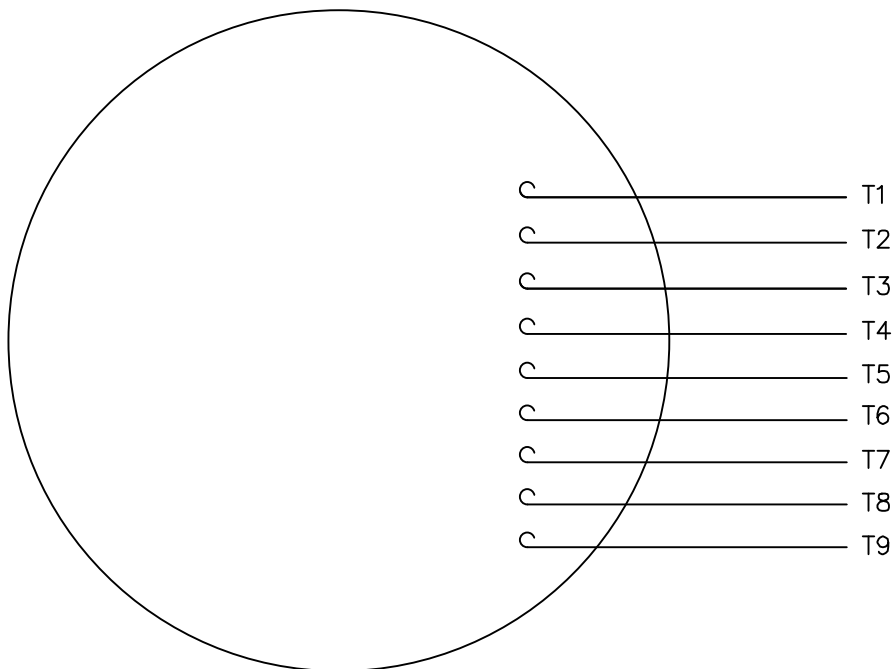

VOLTAGE	L1	L2	L3	JOIN & INSULATE
HIGH	T1	T2	T3	(T4,T7) (T5,T8) (T6,T9)
LOW	T1,T7	T2,T8	T3,T9	T4,T5,T6

		TOLERANCES UNLESS SPECIFIED		DRAWN RDW 04/12/02	
		DEC.	INCHES	CHK	
		.X	±.1	APPD	
		.XX	±.01	TITLE EXTERNAL WIRING DIAGRAM 3 PHASE W/O PROTECTOR	
		.XXX	±.005	SCALE 1=1	
		.XXXX	±.0005	REF FIG.2-51	
		NO.	REVISION	BY & DATE	CHK ANG ±1/2'
				MAT'L. DECAL - 004014	
				FINISH	
				PREV	
		RFP	04/12/02	CAD FILE	00501001ME
				SIZE	DRAWING NO.
				A	005010-01ME
				REV.	
				DIST	

THIS DRAWING IN DESIGN AND DETAIL IS OUR PROPERTY AND MUST NOT BE USED EXCEPT IN CONNECTION WITH OUR WORK ALL RIGHTS OF DESIGN AND INVENTION ARE RESERVED THIS IS AN ELECTRONICALLY GENERATED DOCUMENT - DO NOT SCALE THIS PRINT

