

# PRODUCT INFORMATION PACKET

Model No: 145TTGN6576

Catalog No: U039A

1 HP Explosion Proof Motor, 3 phase, 1200 RPM, 230/460 V, 145T Frame, EPFC  
Explosion Proof NEMA Motors



Regal and Marathon are trademarks of Regal Beloit Corporation or one of its affiliated companies.  
©2020 Regal Beloit Corporation, All Rights Reserved. MC017097E

**REGAL**

### Nameplate Specifications

Output HP	1 Hp	Output KW	0.75 kW
Frequency	60 Hz	Voltage	230/460 V
Current	3.6/1.8 A	Speed	1155 rpm
Service Factor	1.15	Phase	3
Efficiency	82.5 %	Power Factor	63
Duty	Continuous	Insulation Class	F
Design Code	B	KVA Code	K
Frame	145T	Enclosure	Explosion Proof Fan cooled
Thermal Protection	Thermostats (N/C)	Ambient Temperature	40 °C
Drive End Bearing Size	6205	Opp Drive End Bearing Size	6203
UL	UL Listed And CSA Certified	CSA	Y
CE	N	IP Code	54
Hazardous Location	EXP PROOF CL I GR D CL II GR F&G T3B		

### Technical Specifications

Electrical Type	Squirrel Cage Inverter Rated	Starting Method	Line Or Inverter
Poles	6	Rotation	Reversible
Resistance Main	0 Ohms	Mounting	Rigid base
Motor Orientation	Horizontal	Drive End Bearing	Ball
Opp Drive End Bearing	Ball	Frame Material	Cast Iron
Shaft Type	T	Overall Length	14.73 in
Frame Length	7.50 in	Shaft Diameter	0.875 in
Shaft Extension	2.31 in	Assembly/Box Mounting	F1 ONLY
Outline Drawing	A-108734-750	Connection Drawing	A-EE7308T

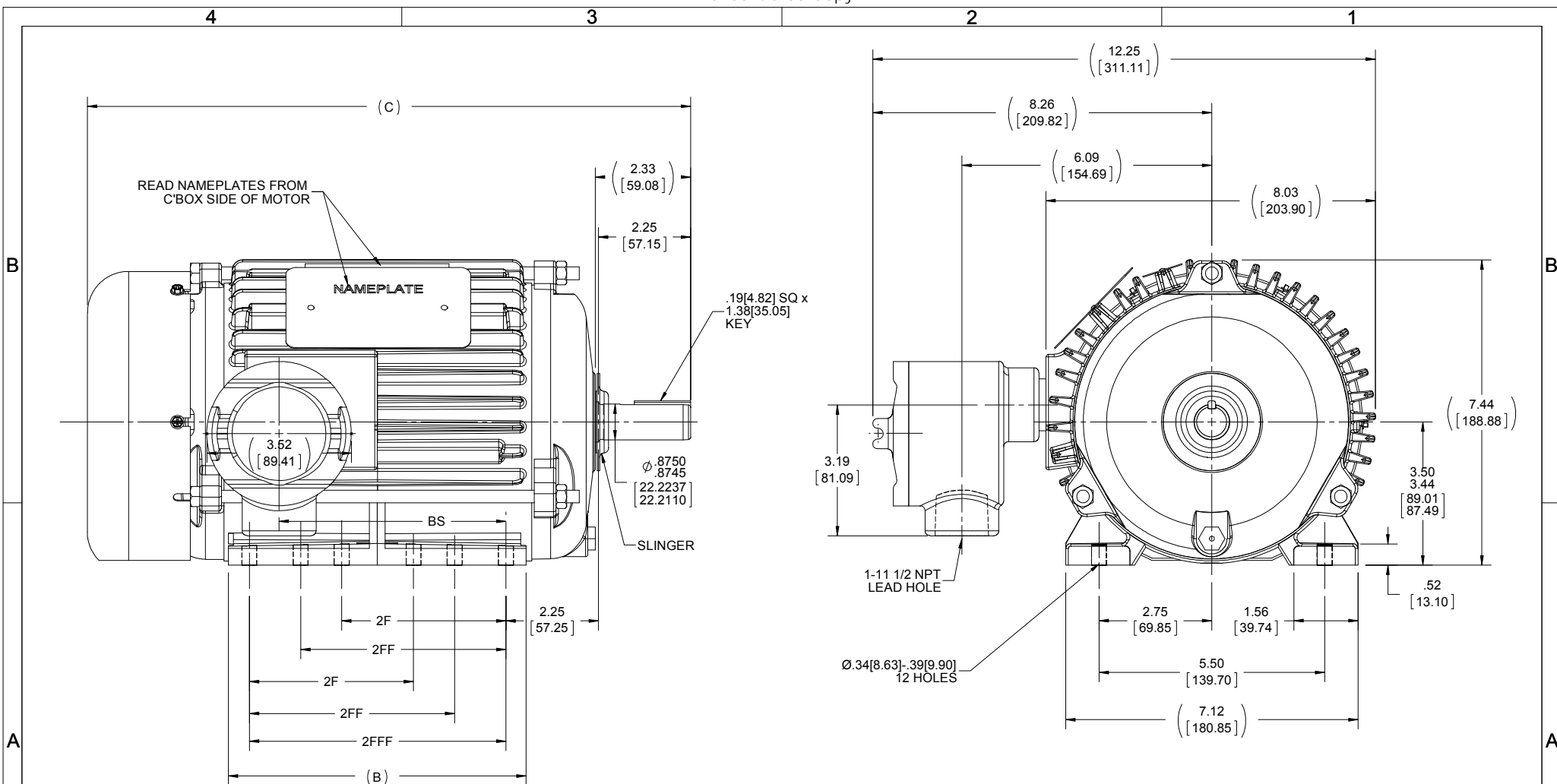

DASH	C	B	BS	2F	2FF	2FFF
750	14.70[373.38]	7.25[184.15]	5.53[140.46]	4.00[101.60]	5.00[127]	6.25[158.75]

DRAWING REVISION B	REVISION BY KHADHAR	DATE 01-29-2019
ECO ECO-0160238	APPROVED BY UD	DATE 01-29-2019
ECO DESCRIPTION ADDED SLINGER		

TOLERANCES UNLESS OTHERWISE SPECIFIED:

DEC.	INCH	mm	ANGLE
.X	+0.1	[+2.5]	±7-30°
.XX	+0.03	[+0.76]	
.XXX	+0.005	[+0.127]	
.XXXX	+0.0005	[+0.0127]	

REMOVE BURRS & BREAK SHARP EDGES: .003/.015 [.076/.381] X 45°  
CORNER FILLETS: R.02 [.51]  
MACHINED SURFACES: 200 5.1  
INCH mm  
mm SHOWN IN [BRACKETS]

DRAWN BY H. ADIKE	Regal Beloit America, Inc.
DATE 5/22/2018	
APPROVED BY JD	DESCRIPTION <b>OUTLINE</b> 140 FR. - EXP.PR - (629 NEW DESIGN)
DATE 7/16/2018	MATERIAL
REFERENCE 104607	PROCESS/FINISH
THIRD ANGLE PROJECTION	SIZE B
	DRAWING NUMBER 108734
	SHEET 1 OF 1

NOTE:  
1.BOX CAN ONLY BE ROTATED CLOCKWISE UP TO 270° FROM ITS ORIGINAL POSITION.

**HIGH VOLTAGE**

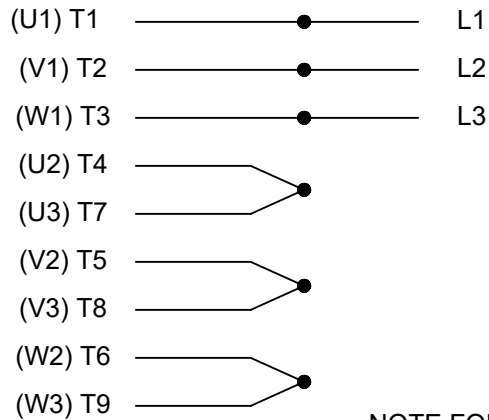

**THREE PHASE  
DUAL VOLTAGE MOTOR**

THERMO-PROTECTORS  
CONNECTED IN SERIES

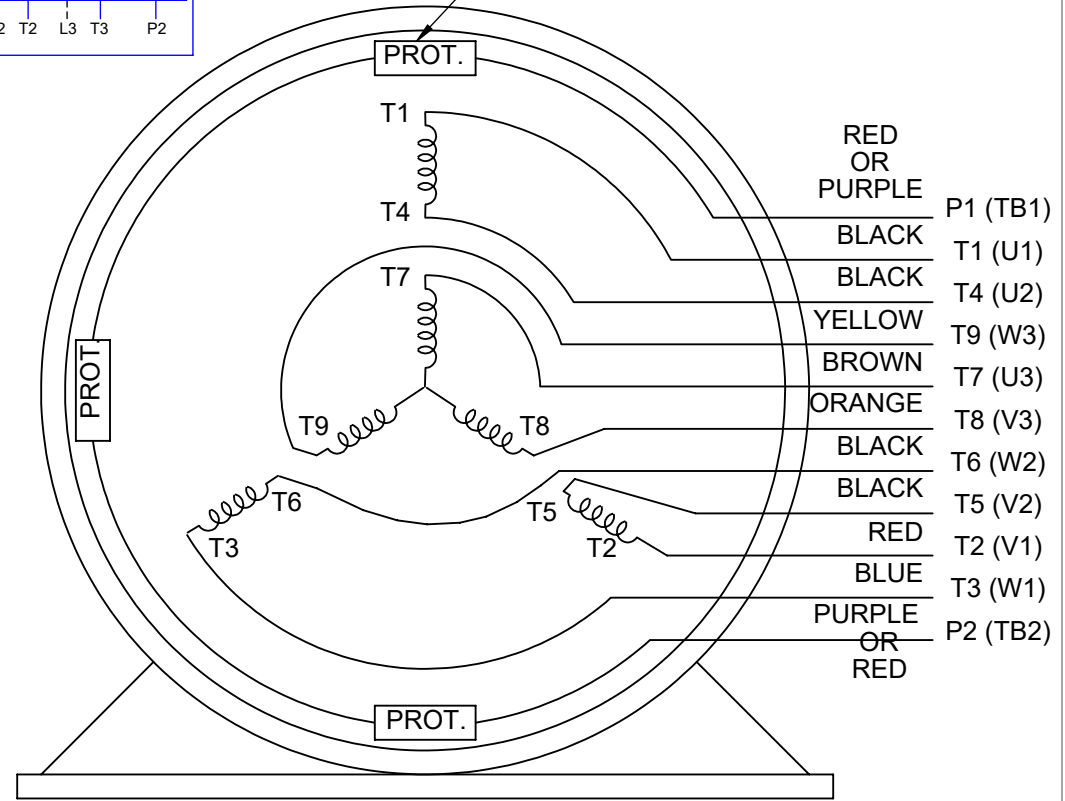

**NOTE FOR FACTORY USE ONLY:  
TO SURGE TEST FOR COMMON CONNECT:  
HIGH VOLT: CONNECT P1 TO T1  
THEN P2 TO L1  
LOW VOLT: CONNECT P1 TO T1 & T7,  
THEN P2 TO L1**

**LOW VOLTAGE**

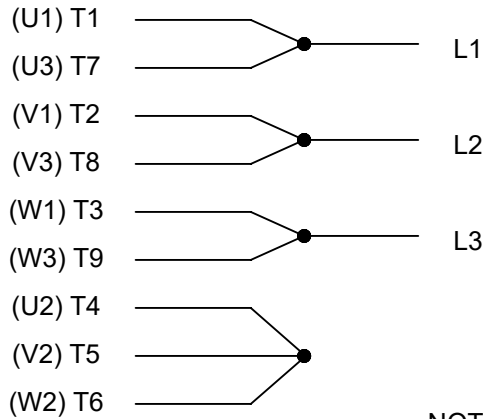

**VIEW OF TERMINAL END**

**NOTE: LEAD'S COLOR CAN BE YELLOW OR WHITE FOR MT2 PLANT**

DRAWING REVISION <b>T</b>	REVISION BY <b>ZR</b>	DATE <b>01-14-2019</b>		DRAWN BY <b>SMC</b>	Regal Beloit America, Inc.
ECO <b>ECO-0159915</b>	APPROVED BY <b>DR</b>	DATE <b>01-15-2019</b>		DATE <b>05-13-1992</b>	
ECO DESCRIPTION <b>ADDED TERMINAL CONNECTION DIAGRAM</b>				APPROVED BY <b>TB</b>	DESCRIPTION <b>CONN DIAGRAM-INTERNAL</b> 3 PHASE - DUAL VOLTAGE MOTOR
<small>COPYRIGHT REGAL BELOIT AMERICA, INC. ALL RIGHTS RESERVED. PROPRIETARY AND CONFIDENTIAL INFORMATION - THIS DOCUMENT IS THE PROPERTY OF REGAL BELOIT AMERICA, INC. ("OWNER") AND CONTAINS OWNER'S PROPRIETARY INFORMATION. ANY PERSON, CORPORATION OR OTHER FIRM RECEIVING IT IS DEEMED, BY RECEIVING IT, TO AGREE THAT IT, AND/OR ANY PART OF IT, SHALL NOT BE DISCLOSED TO ANY PERSON, CORPORATION OR OTHER ENTITY, DUPLICATED, AND/OR USED, EXCEPT AS EXPRESSLY APPROVED IN WRITING IN ADVANCE BY OWNER. THIS DOCUMENT SHALL BE RETURNED TO OWNER UPON REQUEST. IT MAY BE SUBJECT TO CERTAIN RESTRICTIONS UNDER APPLICABLE EXPORT CONTROL LAWS AND REGULATIONS.</small>			DATE <b>05-13-1992</b>	MATERIAL	PROCESS/FINISH
			REFERENCE <b>EE7308/EE7300</b>	THIRD ANGLE PROJECTION	SIZE <b>A</b>



\*\* Subject to change without notice.

Data Sheet

145TTGN6576



Submittal  
Data @ 460 V

Date: 6/29/2017

Customer:  
Attention:  
Submitted by:

FAREEDA DUDEKULA

Motor Load Data

Load	0%	25%	50%	75%	100%	115%	125%	LR
Current (Amps)	1.25	1.30	1.40	1.60	1.80	1.90	2.00	11.0
Torque (ft-lb)	0.00	1.66	2.20	3.4	4.5	5.2	5.7	11.4
RPM	1200	1190	1180	1170	1155	1145	1140	0
Efficiency (%)		67.3	78.7	81.9	82.5	82.2	82.0	
P.F. (%)	8.0	34.0	41.5	54.0	63.0	66.5	69.7	63.0

Motor Speed Data

	LR	Pull-Up	BD	Rated	Idle
Speed (rpm)	0	105	835	1155	1200
Current (Amps)	11.0	10.7	6.7	1.80	1.25
Torque (ft-lb)	11.4	11.4	16.7	4.5	0.00

Information Block

HP	1.0
Sync. RPM	1200
Frame	145
Enclosure	EPC
Construction	TEN
Voltage	30/460#190/38 V
Frequency	60 HZ
Design	B
LR Code letter	K
Service Factor	1.15
Temp Rise @ FL	35 °C
Duty	CONT
Ambient	40 °C
Elevation	1,000 feet
Rotor/Shaft wkt	0.14 Lb-Fe
Rel Wdg	ZT6140 NONE
Sound Pressure @ 1M	62 dBA
VFD Rating	CONSTANT 10:1
Outline Dwg	A-104607-750
Conn. Diag	A-EE7308T
Additional Specifications:	
0	
EQUIV CKT (OHMS / PHASE)	
R1	R2
0.0000	0.0000
X1	X2
0.0000	0.0000
Xm	Xm
0.0000	0.0000

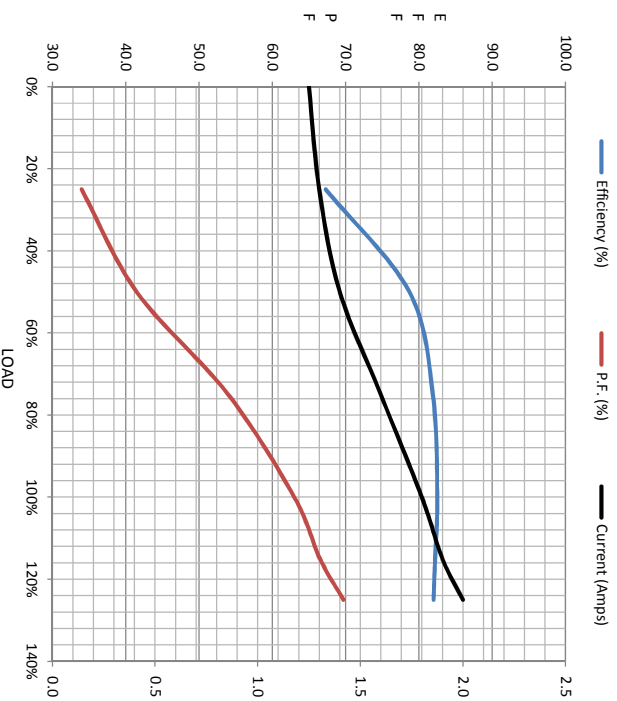

Speed - Torque Curve

