

PRODUCT INFORMATION PACKET

marathon[®]
Motors

Model No: 056C17F15537
Catalog No: F1204
1,1725,TEFC,56NZ,1/60/115/208-230
Auger Drive



Regal and Marathon are trademarks of Regal Beloit Corporation or one of its affiliated companies.
©2018 Regal Beloit Corporation, All Rights Reserved. MC017097E

REGAL[®]



Nameplate Specifications

Output HP	1 Hp	Output KW	0.75 kW
Frequency	60 Hz	Voltage	115/230 V
Current	13.4/6.7 A	Speed	1725 rpm
Service Factor	1	Phase	1
Efficiency	72 %	Duty	Continuous
Insulation Class	F	Design Code	L
KVA Code	M	Frame	56NZ
Enclosure	Totally Enclosed Fan Cooled	Overload Protector	Manual
Ambient Temperature	40 °C	Drive End Bearing Size	6203
Opp Drive End Bearing Size	6203	UL	Recognized (Not Protector)
CSA	Y	CE	Y
IP Code	43		

Technical Specifications

Electrical Type	Capacitor Start Induction Run	Starting Method	Across The Line
Poles	4	Rotation	Selective Counterclockwise
Mounting	Round	Motor Orientation	Horizontal
Drive End Bearing	Ball	Opp Drive End Bearing	Ball
Frame Material	Rolled Steel	Shaft Type	Special Extension Both Sides
Overall Length	13.38 in	Frame Length	7.56 in
Shaft Diameter	0.625 in	Shaft Extension	2.06 in
Assembly/Box Mounting	F1 Only		
Outline Drawing	A-107206-756	Connection Diagram	A-102005-90

This is an uncontrolled document once printed or downloaded and is subject to change without notice. Date Created: 06/29/2018

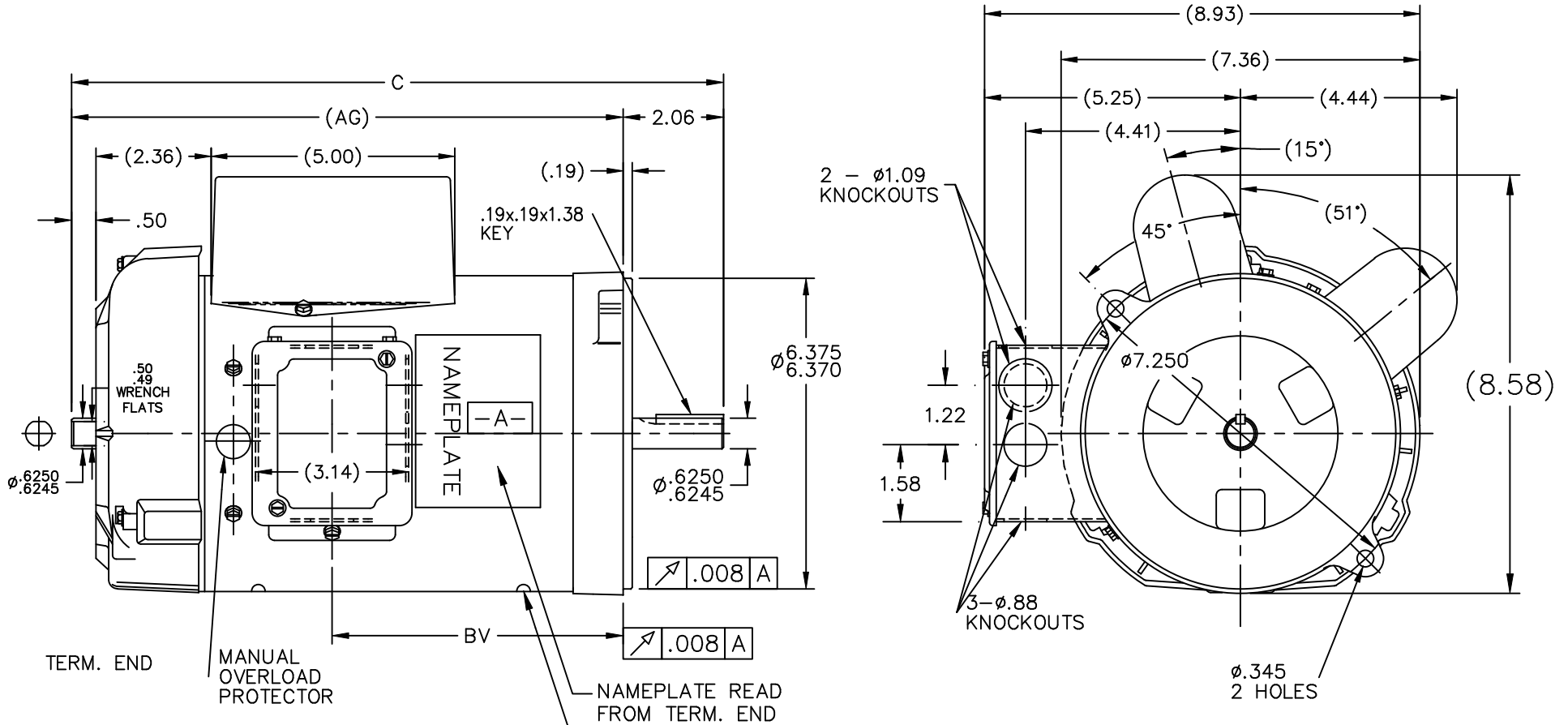

DASH	FRAME	C	AG	BV
756	56-75	13.38	11.32	5.97

NOTE:
CONDUIT BOX CAN BE ROTATED 180°.

				TOLERANCES UNLESS SPECIFIED		MARATHON ELECTRIC	DRAWN TJW 6/21/2006	
				DEC.	INCHES		CHK	VL 03-02-2007
				.X	±.1	TITLE OUTLINE 56 FR. - TEFC - N'FLANGE - 1φ	APPD	VL 03-02-2007
				.XX	±.03		SCALE	5=16
				.XXX	±.005		REF	
				.XXXX	±.0005		MAT'L.	FMF MU76803
NO.	REVISION	BY & DATE	CHK	ANG	±7'30"	FINISH	PREV	ME060124
THIS DRAWING IN DESIGN AND DETAIL IS OUR PROPERTY AND MUST NOT BE USED EXCEPT IN CONNECTION WITH OUR WORK ALL RIGHTS OF DESIGN AND INVENTION ARE RESERVED THIS IS AN ELECTRONICALLY GENERATED DOCUMENT - DO NOT SCALE THIS PRINT			RFP	03-02-2007	CAD FILE	107206	SIZE	DRAWING NO. PAGE OF REV.
			DIST	WP			A	107206

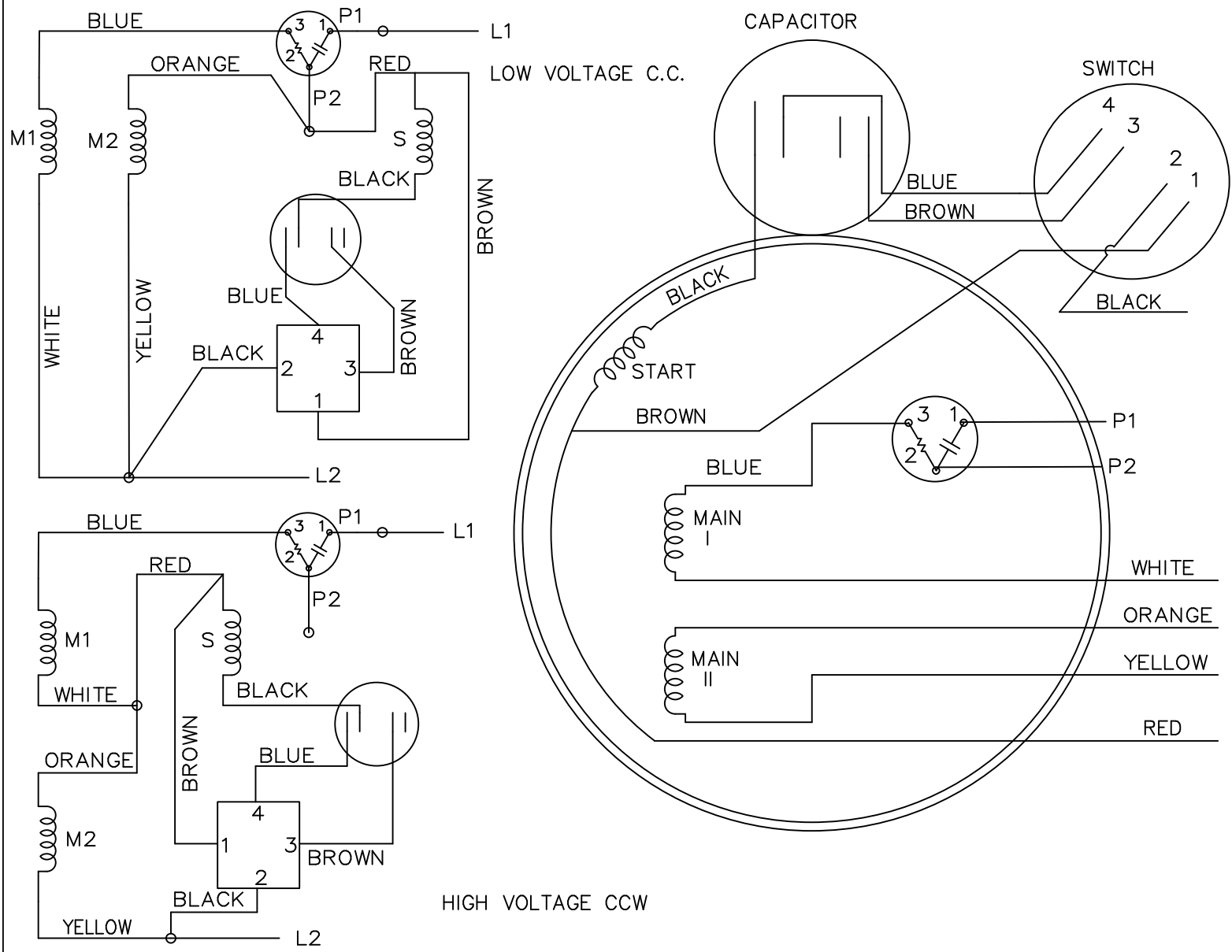

DUAL VOLTAGE
CAPACITOR START
OVERLOAD
SELECT ROTATION

LOW VOLT. CCW ROT.

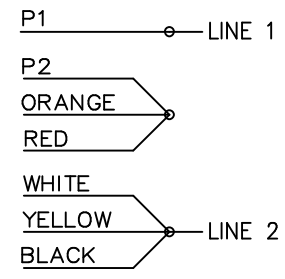

HIGH VOLT. CCW ROT.

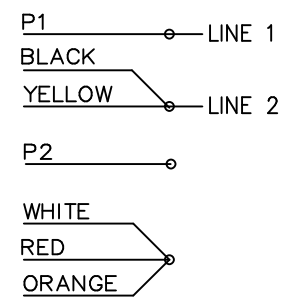

FOR CW ROT. EITHER
VOLTAGE INTERCHANGE
RED WITH BLACK LEAD.

		TOLERANCES UNLESS SPECIFIED			DRAWN DJK 08-02-1993	
		DEC.	INCHES		CHK ML 08-03-1993	
		.X	± -		APPD MJ 08-05-1993	
		.XX	± -		SCALE 1=1	
		.XXX	± -		REF 102005-93	
1	CONVERTED TO AUTOCAD	VL	03-01-2007	.XXXX	± -	FMF 4054403
NO.	REVISION	BY & DATE	CHK	ANG	± -	PREV
THIS DRAWING IN DESIGN AND DETAIL IS OUR PROPERTY AND MUST NOT BE USED EXCEPT IN CONNECTION WITH OUR WORK ALL RIGHTS OF DESIGN AND INVENTION ARE RESERVED THIS IS AN ELECTRONICALLY GENERATED DOCUMENT - DO NOT SCALE THIS PRINT				RFP	CAD FILE 102005_90	
				DIST WP	SIZE A	DRAWING NO. 102005-90
					PAGE OF	REV. 1

CERTIFICATION DATA SHEET

Model#: 56C17F15537 B **WINDING#:** ZC407 NONE 3
CONN. DIAGRAM: A-102005-90 **ASSEMBLY:** F1 ONLY
OUTLINE: A-107206-756

TYPICAL MOTOR PERFORMANCE DATA

HP	KW	SYNC. RPM	F.L. RPM	FRAME	ENCLOSURE	KVA CODE	DESIGN
1	.75	1800	1725	56NZ	TEFC	M	L

PH	Hz	VOLTS	FL AMPS	START TYPE	DUTY	INSL	S.F	AMB°C	ELEVATION
1	60	115/230	13.4/6.7	ACROSS THE LINE	CONTINUOUS	F3	1.0	40	3300

FULL LOAD EFF: 72	3/4 LOAD EFF: 70	1/2 LOAD EFF: 64.3	GTD. EFF	ELEC. TYPE	NO LOAD AMPS
FULL LOAD PF: 69.5	3/4 LOAD PF: 60.5	1/2 LOAD PF: 49	0	CAP START IND RUN	8.8 / 4.4

F.L. TORQUE	LOCKED ROTOR AMPS	L.R. TORQUE	B.D. TORQUE	F.L. RISE°C
48.3 LB-FT	69.4 / 34.7	145 LB-FT 0	122 LB-FT 0	0

SOUND PRESSURE @ 3 FT.	SOUND POWER	ROTOR WK^2	MAX. WK^2	SAFE STALL TIME	STARTS /HOUR	APPROX. MOTOR WGT
0 dBA	10 dBA	0 LB-FT^2	0 LB-FT^2	0 SEC.	0	0 LBS.

***** SUPPLEMENTAL INFORMATION *****

DE BRACKET TYPE	ODE BRACKET TYPE	MOUNT TYPE	ORIENTATION	SEVERE DUTY	HAZARDOUS LOCATION	DRIP COVER	SCREENS	PAINT
N-FLANGE	BRAKE	ROUND	HORIZONTAL	FALSE	NONE	FALSE	NONE	BLACK (POWDER)

BEARINGS		GREASE	SHAFT TYPE	SPECIAL DE	SPECIAL ODE	SHAFT MATERIAL	FRAME MATERIAL
DE	OPE						
BALL	BALL	POLYREX EM	DBL SPL EXT	0.625 x 2.06 IN SEK	RELIEF FLATS FOR 1/2 WRENCH	1144 STRESSPROOF (C-223)	ROLLED STEEL
6203	6203						

THERMO-PROTECTORS				THERMISTORS	CONTROL	SPACE /n HEATERS
THERMOSTATS	PROTECTORS	WDG RTDs	BRG RTDs			
NONE	MANUAL	NONE	NONE	NONE	FALSE	NONE VOLTS

If Inverter equals NONE, contact factory for further information

INVERTER TORQUE: NONE
INV. HP SPEED RANGE: NONE
ENCODER: NONE
NONE NONE
NONE NONE PPR
BRAKE: PROVISIONS FOR KIT NONE
NONE P/N NONE
NONE NONE
NONE FT-LB NONE V NONE Hz

*
N
O
T
E
S
*

DATE: 06/27/2017 06:57:05 AM
 FORM 3531 REV.3 02/07/99
 ** Subject to change without notice.