

PRODUCT INFORMATION PACKET

Model No: 056T17G5320

Catalog No: G846

1 HP Explosion Proof Motor, 3 phase, 1800 RPM, 575 V, 56C Frame, EPFC
Explosion Proof NEMA Motors





Nameplate Specifications

Output HP	1 Hp	Output KW	.75 kW
Frequency	60 Hz	Voltage	575 V
Current	1.45 A	Speed	1725 rpm
Service Factor	1	Phase	3
Efficiency	78.5 %	Duty	CONTINUOUS
Insulation Class	B	Design Code	B
KVA Code	L	Frame	56C
Enclosure	EPFC	Thermal Protection	Automatic
Ambient Temperature	40 °C	Drive End Bearing Size	6203
Opp Drive End Bearing Size	6203	UL	Recognized
CSA	N	CE	N
IP Code	54	Hazardous Location	EXP PROOF CL I GR C&D CL II GR F&G T3B

Technical Specifications

Electrical Type	SQ CAGE IND RUN	Starting Method	ACROSS THE LINE
Poles	4	Rotation	REV
Mounting	ROUND	Motor Orientation	HORIZONTAL
Drive End Bearing	BALL	Opp Drive End Bearing	BALL
Frame Material	ROLLED STEEL	Shaft Type	T
Overall Length	13.94 in	Frame Length	6.81 in
Shaft Diameter	.63 in	Shaft Extension	2.06 in
Assembly/Box Mounting	F1 Only		

This is an uncontrolled document once printed or downloaded and is subject to change without notice. Date Created:01/11/2019

NAMEPLATES TO BE READ FROM SHAFT EXT. END.

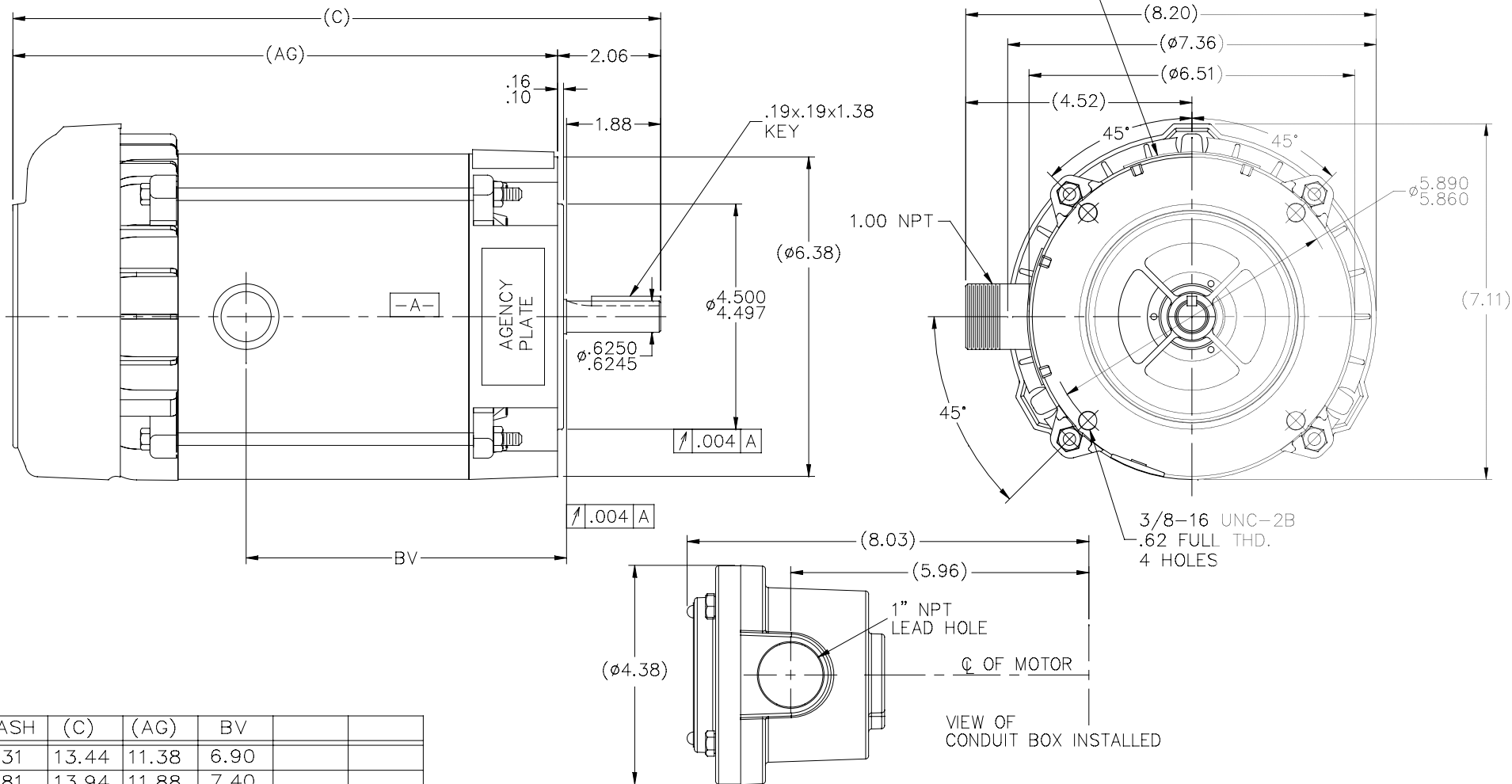

DASH	(C)	(AG)	BV		
631	13.44	11.38	6.90		
681	13.94	11.88	7.40		
731	14.44	12.38	7.90		
781	14.94	12.88	8.40		
831	15.44	13.38	8.90		
881	15.94	13.88	9.40		
931	16.44	14.38	9.90		
981	16.94	14.88	10.40		

NO.	REVISION	BY & DATE	CHK	ANG	TOLERANCES UNLESS SPECIFIED	FINISH	PREV
6		SL 09/15/15					
5	COND. BOX INSTALLED VIEW UPDATED PER ECR-0044571	UD 10/10/13	ST	DEC.	INCHES		
4	REVISED C'BOX PER CN40784A	JJB 02/23/2007	ML	.X	±.1		
3	REDRAWN IN AUTOCAD	TAT 06-28-2004	ML	.XX	±.03		
2	ADDED CONDUIT BOX VIEW	CN 26686 MRB 03-22-1999		.XXX	±.005		
1	NEW DRAWING	CN 23099 MH 12-02-1996	SM	.XXXX	±.0005		
			CHK	ANG	±7'30"		

THIS DRAWING IN DESIGN AND DETAIL IS OUR PROPERTY AND MUST NOT BE USED EXCEPT IN CONNECTION WITH OUR WORK ALL RIGHTS OF DESIGN AND INVENTION ARE RESERVED THIS IS AN ELECTRONICALLY GENERATED DOCUMENT - DO NOT SCALE THIS PRINT		RFP	CAD FILE 104188	SIZE	DRAWING NO.	PAGE	OF	REV.
		DIST	WP	B	104188			6

REGAL™ Regal Beloit America, Inc.

TITLE OUTLINE - 'C' FACE
56C/145TCZ FR - EXP PR.

SINGLE VOLTAGE – THREE PHASE WITH OVERLOAD PROTECTOR

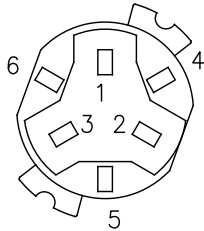

NOTE:
ACTUAL PROTECTOR
TERMINAL LOCATIONS
FOR LEAD CONNECTIONS

NOTE:

WEST PLAINS

LEADS WITH TERMINALS
SHOULD BE CONNECTED
TO INBOARD SIDE OF
TERMINAL BOARD.

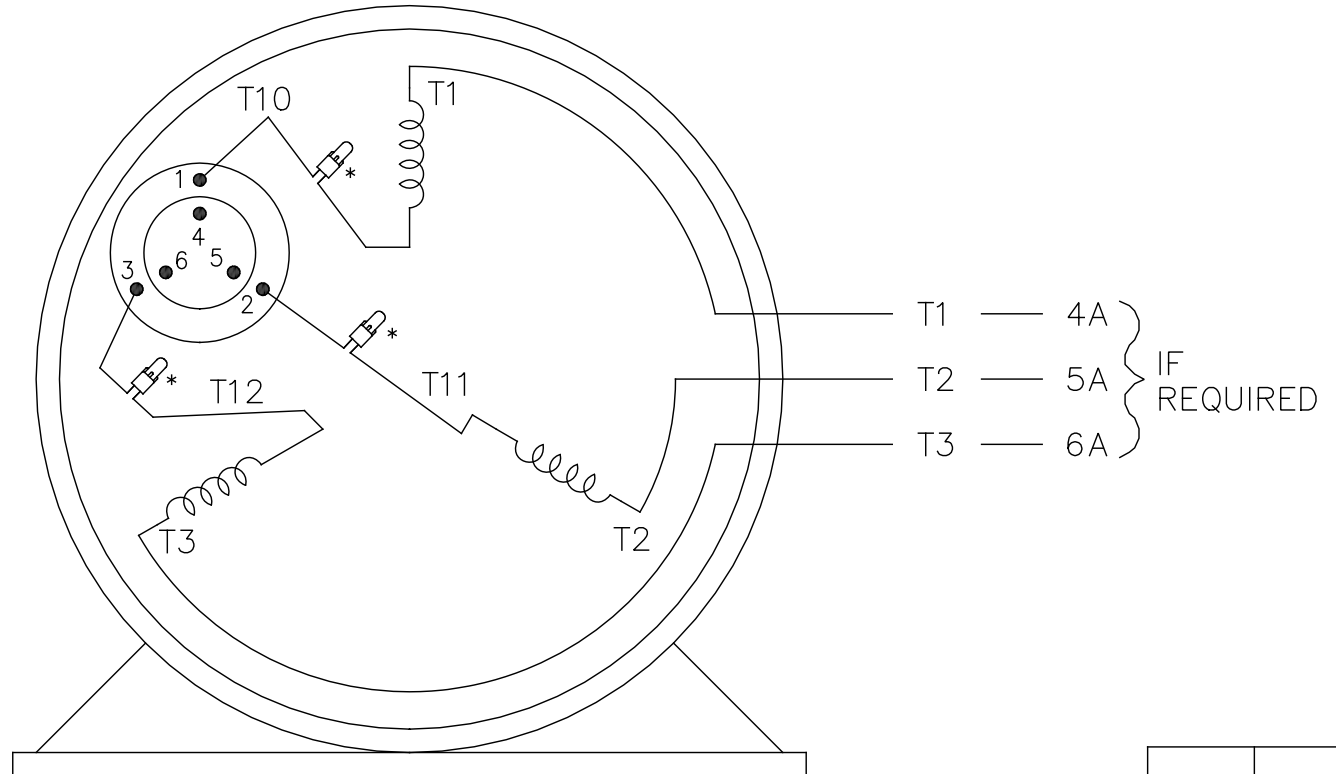

VIEW OF TERMINAL END

OPTIONAL CORD
CONNECTION

L1 WHITE
L2 RED
L3 BLACK

		T6CK
T6CA		T6BM
T4CC		T4AY
T4C		T2DL
T6D		T2H

–TO REVERSE ROTATION–
INTERCHANGE ANY TWO
LINE LEAD CONNECTIONS

*USE PRESSURE CONNECTORS FOR MT2 PLANT ONLY

NO.	REVISION	BY & DATE	CHK	ANG	±	–	FINISH	PREV
11	ADDED THE OPTIONAL CORD CONNECTION	JAH 11-12-2014	RD					
10	PRESSURE CONNECTORS ADDED (QTY 3)	PVR 07-09-2014	GR					
9	ADDED 4A, 5A, & 6A "IF REQUIRED" MU44987	MSG 01-07-2002	SAS	.X	±	–		
8	ADDED ACTUAL PROTECTOR VIEW CN 17481	KL 05-18-1994		.XX	±	–	TITLE CONNECTION DIAGRAM	SCALE 1=1
7	REWORDED WEST PLAINS NOTE – PER WEST PLAINS	DD 01-12-1994		.XXX	±	–	SINGLE VOLT – 3Ø WITH OVERLOAD PROT.	REF
6	REDRAWN ON CAD – "WEST PLAINS" NOTE ADDED	KL 08-26-1993		.XXXX	±	–	MAT'L.	FMF

THIS DRAWING IN DESIGN AND DETAIL IS OUR PROPERTY AND MUST NOT BE USED EXCEPT
IN CONNECTION WITH OUR WORK ALL RIGHTS OF DESIGN AND INVENTION ARE RESERVED
THIS IS AN ELECTRONICALLY GENERATED DOCUMENT – DO NOT SCALE THIS PRINT

RFP	CAD FILE EE7335B
DIST LB-WP	

SIZE	DRAWING NO.	PAGE	OF	REV.
A	EE7335B			11