

9030 Locking Circuit Tester

30A 125V. Used to check for no power, no ground, hot or ground reversal and reverse polarity.

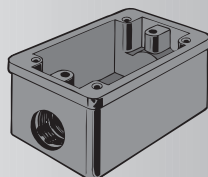

6080 - FS Box

Black non-metallic, with **two 3/4" K.O. holes**. Will accept all 15A, 20A and 30A receptacles and 7420CRS and 7423CRS covers.

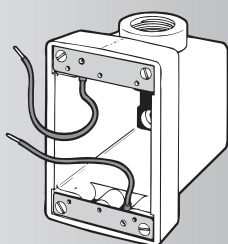

6083CR - FD Box

Yellow fiberglass, with **two 3/4" K.O. holes**. Will accept all 15A, 20A, 30A and 50A receptacles and 7420CRS, 7788CRS and 7423CRS covers.

6084CR - FD Box

Yellow fiberglass, with **two 1" K.O. holes**. Will accept all 15A, 20A, 30A and 50A receptacles and 7420CRS, 7788CRS and 7423CRS covers.

6085 - PVC Adapter

3/4" pipe thread, for use with 6083CR and 6080 boxes. *(not illustrated)*

6086 - PVC Adapter

1" pipe thread, for use with 6084CR. *(not illustrated)*

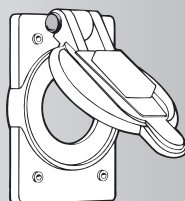

7420CRS Weather-Resistant Cover

Yellow, gray (7420GY), and black (7420BL) Lexan® with lift lid. Fits single receptacles. *Also available in .OEM packaging.*

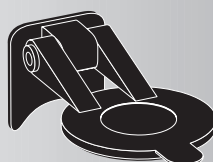

2030FL Weather-Resistant Cover

Low cost, quick assembly. Spring-loaded flip lid. Fits 3-, 4- and 5-wire, single receptacles. Black plastic. *Also available in .OEM packaging.*



Space-Saving Right-Angle Adapters: 3WRA & 45WRA

For 3-, 4- and 5-wire plugs and connectors. Allows end-users to plug in 20A and 30A devices close to walls without bending or damaging power cords. The power cord exits parallel to the wall receptacle—plus, the adapters rotate 360° in 18 intervals so the end-user can direct the cord to the most convenient direction.

Smaller than other adapters on the market, the Marincor Right-Angle Adapter nevertheless handles a broader range of cord sizes:

- 3-wire model accommodates **.275" to .780"** cords. These specification grade adapters can be used with **14** different Marincor 20 and 30 amp 3-wire NEMA locking plugs and connectors.
- 4- and 5-wire model accommodates **.456" to 1.150"** cords. These specification grade adapters can be used with **24** different Marincor 20 and 30 amp 4- and 5-wire NEMA locking plugs and connectors.

**See pages 34 & 35 for
right-angle devices
and adapters**

**See page 38 for
Weather-Resistant
Covers**