

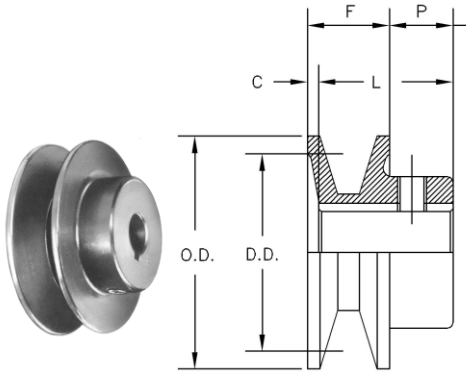

Hi-Q® cast iron sheaves-single groove for both "O" (3L) and "A" (4L) v-belts

STYLE 1



2150 - AK23

STYLE 2

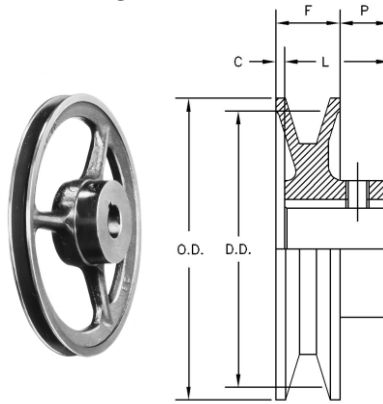

2240 - AK41

STYLE 3

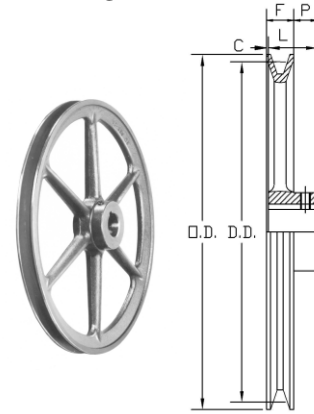

AK44 - AK184

DIAMETERS IN INCHES			Part Number	Original Maurey Number	STOCK BORES MARKED "X" ^										DIMENSIONS IN INCHES				Overall Length Inches	Approx. Weight in LBS.
Outside	Datum "A" Belt	Datum "O" Belt			1/2	5/8	3/4	7/8	1	1-1/8	1-3/16	1-1/4	1-3/8	1-7/16	F	L	P	C		
1.50	1.3	---	2150	---	X	X+								5/8	1-1/16	7/16	0	1-1/16	0.2	
1.75	1.5	---	AK17	2175	X	X	2175**							21/32	15/16	7/16	5/32	1-3/32	0.2	
2.00	1.7	---	AK20	2200	X	X	X	2200**						21/32	15/16	7/16	5/32	1-3/32	0.3	
2.10	1.8	1.5	AK21	2210	X	X	X	2210**						21/32	15/16	7/16	5/32	1-3/32	0.4	
2.20	2.0	1.7	AK22	2225	X	X	X	2225**	2225**					21/32	15/16	7/16	5/32	1-3/32	0.5	
2.30	2.1	1.8	AK23	---	X	X	X	X						21/32	15/16	7/16	5/32	1-3/32	0.5	
2.40	2.1	1.8	2240	---	X	X	X	X	X					3/4	1-1/8	9/16	3/16	1-5/16	0.8	
2.50	2.2	1.9	AK25	2250	X	X	X	X	2250**					21/32	15/16	7/16	5/32	1-3/32	0.5	
2.60	2.3	2.0	AK26	2260	X	X	X	X	2260**					21/32	15/16	7/16	5/32	1-3/32	0.5	
2.70	2.5	2.2	AK27	2275	X	X	X	X	X					21/32	15/16	7/16	5/32	1-3/32	0.6	
2.80	2.6	2.3	AK28	---	X	X	X	X	X					21/32	15/16	7/16	5/32	1-3/32	0.7	
3.00	2.7	2.4	2300	---	X	X	X	X	X					3/4	1-1/8	9/16	3/16	1-5/16	1.1	
3.05	2.8	2.5	AK30	AC31	X	X	X	X	X	X				21/32	15/16	7/16	5/32	1-3/32	0.7	
3.25	3.0	2.7	AK32	AC33	X	X	X	X	X	X				21/32	15/16	7/16	5/32	1-3/32	0.7	
3.45	3.2	2.9	AK34	AC35	X	X	X	X	X	X				21/32	15/16	7/16	5/32	1-3/32	0.9	
3.75	3.5	3.2	AK39	AC38	X	X	X	X	X	X				3/4	1-5/32	15/32	1/16	1-7/32	1.4	
3.95	3.7	3.4	AK41	AC40	X	X	X	X	X	X				3/4	1-5/32	15/32	1/16	1-7/32	1.5	
4.25	4.0	3.7	AK44	AC43	X	X	X	X	X	X				3/4	1-5/32	15/32	1/16	1-7/32	1.5	
4.45	4.2	3.9	AK46	AC45	X	X	X	X	X	X				3/4	1-5/32	15/32	1/16	1-7/32	1.5	
4.75	4.5	4.2	AK49	AC48	X	X	X	X	X	X				3/4	1-5/32	15/32	1/16	1-7/32	1.7	
4.95	4.7	4.4	AK51	AC50	X	X	X	X	X	X				3/4	1-5/32	15/32	1/16	1-7/32	1.7	
5.25	5.0	4.7	AK54	AC53	X	X	X	X	X	X	X			3/4	1-5/32	15/32	1/16	1-7/32	1.8	
5.45	5.2	4.9	AK56	AC55	X	X	X	X	X	X	X			3/4	1-5/32	15/32	1/16	1-7/32	1.9	
5.75	5.5	5.2	AK59	AC58	X	X	X	X	X	X	X			3/4	1-5/32	15/32	1/16	1-7/32	2.0	
5.95	5.7	5.4	AK61	AC60	X	X	X	X	X	X	X			3/4	1-5/32	15/32	1/16	1-7/32	2.1	
6.25	6.0	5.7	AK64	AC63	X	X	X	X	X	X				3/4	1-5/32	15/32	1/16	1-7/32	2.2	
6.45	6.2	5.9	AK66	AC65	X	X	X	X	X	X	X			3/4	1-5/32	15/32	1/16	1-7/32	2.3	
6.75	6.5	6.2	AK69	AC68			X		X	X				3/4	1-15/32	23/32	0	1-15/32	3.5	
6.95	6.7	6.4	AK71	AC70	X	X	X	X	X	X	X			3/4	1-15/32	23/32	0	1-15/32	3.8	
7.25	7.0	6.7	AK74	AC73	X*	X*	X*	X*	X*	X*	X	X		3/4	1-15/32	23/32	0	1-15/32	3.4	
7.75	7.5	7.2	AK79	AC78			X		X	X			X	3/4	1-15/32	23/32	0	1-15/32	4.0	
7.95	7.7	7.4	AC80	---	X	X	X	X	X	X	X			3/4	1-5/8	7/8	0	1-5/8	3.9	
8.25	8.0	7.7	AK84	AC83	X*	X*	X*	X*	X*	X	X			3/4	1-15/32	23/32	0	1-15/32	3.8	
8.75	8.5	8.2	AK89	---			X		X	X			X	3/4	1-15/32	23/32	0	1-15/32	4.3	
8.95	8.7	8.4	AC90	---	X	X	X	X	X	X	X			3/4	1-5/8	7/8	0	1-5/8	4.4	
9.25	9.0	8.7	AK94	AC93		X*	X*	X*	X*	X	X			3/4	1-15/32	23/32	0	1-15/32	4.5	
9.75	9.5	9.2	AK99	---			X		X				X	3/4	1-15/32	23/32	0	1-15/32	5.3	
9.95	9.7	9.4	AC100	---		X	X	X	X	X	X			3/4	1-5/8	7/8	0	1-5/8	5.6	
10.25	10.0	9.7	AK104	AC103		X*	X*	X*	X*	X	X			3/4	1-15/32	23/32	0	1-15/32	5.1	
10.75	10.5	10.2	AK109	---			X		X				X	3/4	1-15/32	23/32	0	1-15/32	5.8	
10.95	10.7	10.4	AC110	---			X		X	X	X			3/4	1-5/8	7/8	0	1-5/8	5.9	
11.25	11.0	10.7	AK114	AC113		X*	X*	X*	X*	X	X		X	3/4	1-15/32	23/32	0	1-15/32	5.6	
11.95	11.7	11.4	AC120	---	X	X	X	X	X	X	X	X		3/4	1-5/8	7/8	0	1-5/8	6.4	
12.25	12.0	11.7	AK124	AC123		X*	X*	X*	X*	X	X		X	3/4	1-15/32	23/32	0	1-15/32	6.5	
12.95	12.7	12.4	AC130	---			X		X	X				7/8	1-5/8	7/8	0	1-5/8	7.3	
13.25	13.0	12.7	AK134	AC133			X		X	X	X		X	3/4	1-15/32	23/32	0	1-15/32	7.5	
13.95	13.7	13.4	AK140	---		X	X		X	X	X			7/8	1-5/8	7/8	0	1-5/8	9.7	
14.25	14.0	13.7	AK144	AC143		X	X		X	X	X		X	3/4	1-15/32	23/32	0	1-15/32	8.5	
14.95	14.7	14.4	AC150	---					X	X			X	7/8	1-3/4	1	0	1-3/4	10.4	
15.25	15.0	14.7	AK154	AC153			X		X				X	3/4	1-15/32	23/32	0	1-15/32	9.8	
18.25	18.0	17.7	AK184	AC183			X		X				X	3/4	1-15/32	23/32	0	1-15/32	12.1	

+ No Keyway

^ For Standard Keyway Dimension Refer to Page A-2

* 1" Bore and Smaller C=1/16 and P=25/32

** Bore Size Available in Only Maurey Original Design. Specify Original Maurey Part Number When Ordering.