

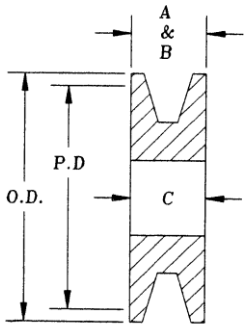

Hi-Q® bar steel no hub sheaves for "O" (3L), "A" (4L) and "B" (5L) v-belts

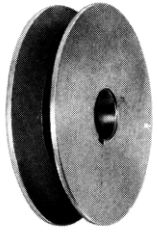

FIXED BORE TYPE

No hub sheaves are zinc phosphated for rust resistance

When ordering specify bore with part number:

For example order NH4300 x 1/2"

for "O" (3L) and "A" (4L) v-belts												
DIAMETER, INCHES			PART NO.	STOCK BORES MARKED "X"							Overall Width Inches	Approx. Weight Lbs.
O.D.	D.D. 4L ("A")	D.D. 3L ("O")		3/8 In	1/2 In	5/8 In	3/4 In	7/8 In	1 In	1-1/8 In		
2.0	1.7		NH2200	X	X	X*	X*				5/8	0.3
2.1	1.8	1.5	NH2210	X	X	X*	X*				5/8	0.3
2.2	1.9	1.6	NH2220		X	X*	X*				5/8	0.3
2.3	2.0	1.7	NH2230		X	X*	X*				5/8	0.4
2.5	2.2	1.9	NH2250		X	X	X	X*	X*	X*	5/8	0.5
2.6	2.3	2.0	NH2260		X	X	X	X			5/8	0.6
2.7	2.4	2.1	NH2270		X	X	X	X	X*		5/8	0.7
2.8	2.5	2.2	NH2280		X	X	X	X	X		5/8	0.7
3.0	2.7	2.4	NH2300		X	X	X	X	X	X	5/8	0.9
3.2	2.9	2.6	NH2320		X	X	X	X	X	X	5/8	1.0
3.4	3.1	2.8	NH2340		X	X	X	X	X	X	5/8	1.2

for "A" (4L) and "B" (5L) v-belts												
DIAMETER, INCHES			PART NO.	STOCK BORES MARKED "X"							Overall Width Inches	Approx. Weight Lbs.
O.D.	D.D. 5L ("B")	D.D. 4L ("A")		3/8 In	1/2 In	5/8 In	3/4 In	7/8 In	1 In	1-1/8 In		
2.4	2.0		NH4240	X	X	X*	X*	X*			3/4	0.5
2.5	2.1		NH4250	X	X	X*	X*	X*	X*		3/4	0.5
2.6	2.2	1.8	NH4260		X	X	X*				3/4	0.6
2.7	2.3	1.9	NH4270		X	X	X*	X*	X*		3/4	0.6
2.8	2.4	2.0	NH4280		X	X	X	X*	X*		3/4	0.7
2.9	2.5	2.1	NH4290		X	X	X	X	X*	X*	3/4	0.9
3.0	2.6	2.2	NH4300		X	X	X	X	X*	X*	3/4	1.0
3.2	2.8	2.3	NH4320		X	X	X	X	X*	X*	3/4	1.1
3.4	3.0	2.4	NH4340		X	X	X	X	X	X	3/4	1.3
3.6	3.2	2.6	NH4360		X	X	X	X	X	X	3/4	1.4
3.8	3.4	2.8	NH4380		X	X	X	X	X	X	3/4	1.5
4.0	3.6	3.2	NH4400		X	X	X	X	X	X	3/4	2.2

One Setscrew - Hollow Head, Cup Point

*Setscrew @ 90 Degrees to Keyway (No Setscrew Over Keyway)

For Standard Keyway Dimensions Refer to Table on Page A-2



Hi-Q® reducing bushings for light duty sheaves

type XA bushing

For all 1" Fixed Bore Single Groove Sheaves. Packed and labeled five to a carton. Order in multiples of five (not sold in broken lots)

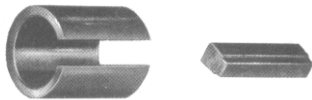

Part Number	O.D. Inches	Stock Bores Inches	Wt Each
XA	1	1/2, 5/8, 3/4, 7/8	.2 lbs

* 1/2 and 5/8 Bores Have No Keyway Through Bushing

steel reducing bushings

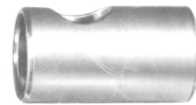

Each bushing ground to fit and has clearance hole for set screw

Order In Multiples of 5 pcs. Not Sold in Broken Lots.

Inside diameter has no keyway

PART NUMBER	DIAMETER		LENGTH INCHES
	O.D.	I.D.	
1401	1/2	1/4	1-1/8
1402	1/2	5/16	1-1/8
1403	1/2	3/8	1-1/8
1426	1/2	7/16	1-1/4
1404	5/8	7/16	1-1/4
1405	5/8	1/2	1-1/8
1406	3/4	1/2	1-1/4
1408	3/4	5/8	1-1/4
1419	7/8	5/8	1-1/4
1420	7/8	3/4	1-1/4
1418	1	5/8	1-1/4
1410	1	3/4	1-1/4
1412	1	7/8	1-1/4
1427	1-1/8	1	1-1/4
1423	1-3/16	1	1-1/4
1425	1-1/4	3/4	1-1/4
1428	1-1/4	7/8	1-1/4
1414	1-1/4	1	1-1/4
1416	1-1/4	1-1/8	1-1/4



Hi-Q® cast iron sheaves-single groove for "O" (3L) v-belts

STYLE 1

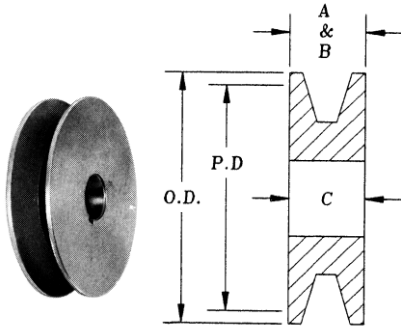

STYLE 2

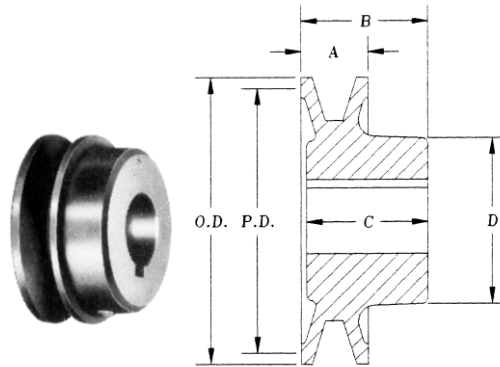

STYLE 3

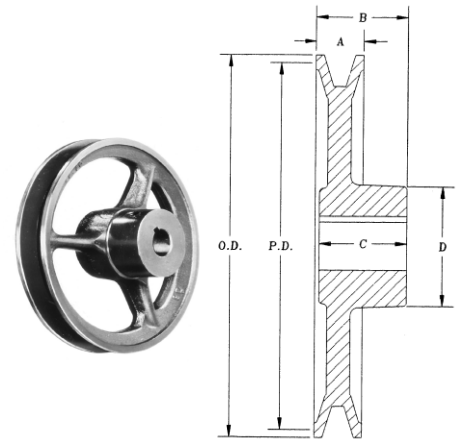

Solid Bar Steel OS14-OS27

Solid Cast Iron OS32 and OS37

Spoked Cast Iron OS42-OS102

DIAMETER		PART NUMBER	STYLE	STOCK BORES MARKED "X" ^						MAX BORE INCHES	DIMENSION v - Inches				APPROX. WT LBS.
O.D. INCHES	P.D. INCHES			3/8	1/2	5/8	3/4	7/8	1		A	B	C	D	
1.42	1.25	OS14	1	X	X					1/2	1/2	1/2		.3	
1.67	1.50	OS17	1	X	X	X				3/4	1/2	1/2		.4	
1.92	1.75	OS19	1	X	X	X	X			3/4	1/2	1/2		.4	
2.17	2.00	OS22	1	X	X	X	X			3/4	1/2	1/2		.4	
2.42	2.25	OS24	1	X	X	X	X			3/4	1/2	1/2		.5	
2.67	2.50	OS27	1		X	X	X	X		7/8	1/2	1/2		.7	
3.17	3.00	OS32	2		X	X	X	X	X	1	5/8	1-1/16	1-1/16	1-53/64	1.1
3.67	3.50	OS37	2		X	X	X	X	X	1	5/8	1-1/16	1-1/16	1-53/64	1.3
4.17	4.00	OS42	3		X	X	X	X	X	1	5/8	1-1/16	1-1/16	1-5/8	1.6
4.67	4.50	OS47	3	X	X	X	X	X	X	1	5/8	1-1/16	1-1/16	1-5/8	1.7
5.17	5.00	OS52	3		X	X	X	X	X	1	5/8	1-1/16	1-1/16	1-5/8	1.9
6.17	6.00	OS62	3		X	X	X	■	X	1	5/8	1-3/16	1-1/8	1-7/8	2.2
7.17	7.00	OS72	3		X	X	X	■	X	1	5/8	1-3/16	1-1/8	1-7/8	2.4
8.17	8.00	OS82	3		X	X	X	■	X	1	5/8	1-3/16	1-1/8	1-7/8	2.7
9.17	9.00	OS92	3		X	X	X	■	X	1	5/8	1-3/16	1-1/8	1-7/8	3.1
10.17	10.00	OS102	3			X	X	■	X	1	5/8	1-3/16	1-1/8	1-7/8	3.6

^ For Standard Keyway Dimension Refer to Table Below

Setscrews-Hollow Head, Cup Point

■ Non-Stock Bores are Special and Noncancellable (Additional Charges Apply)

v Held to Commercially Acceptable Tolerances

STANDARD KEYWAYS FOR LIGHT DUTY SHEAVES

BORE (INCHES)	KEYSEAT
3/8, 7/16, 1/2, 9/16	NONE
5/8, 11/16, 3/4, 13/16, 7/8	3/16 x 3/32
15/16, 1, 1-1/16, 1-1/8, 1-3/16, 1-1/4	1/4 x 1/8
1-15/16, 1-3/8	5/16 x 5/32
1-7/16, 1-1/2	3/8 x 3/16

BORE (mm)	KEYSTOCK
14, 15, 16	5 x 5
18, 19, 20, 22	6 x 6
24, 25, 28, 30	8 x 7
32, 35, 38	10 x 8



Hi-Q® cast iron sheaves-single groove for both "O" (3L) and "A" (4L) v-belts

STYLE 1

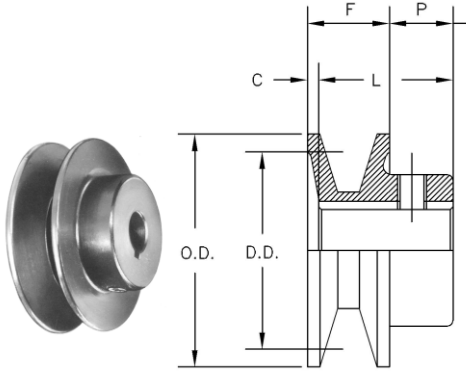

2150 - AK23

STYLE 2

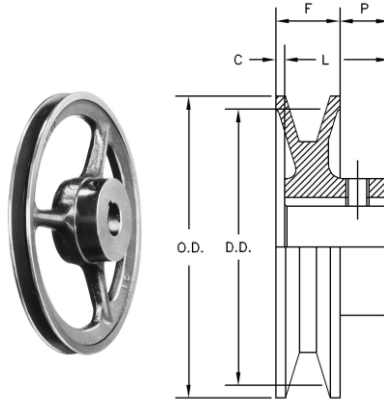

2240 - AK41

STYLE 3

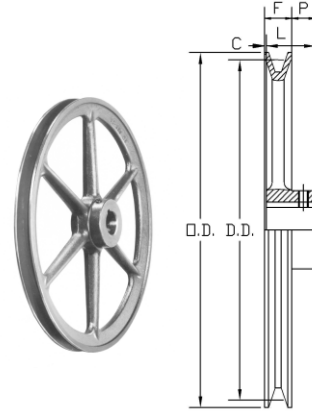

AK44 - AK184

DIAMETERS IN INCHES			Part Number	Original Maurey Number	STOCK BORES MARKED "X" ^										DIMENSIONS IN INCHES				Overall Length Inches	Approx. Weight in LBS.
Outside	Datum "A" Belt	Datum "O" Belt			1/2	5/8	3/4	7/8	1	1-1/8	1-3/16	1-1/4	1-3/8	1-7/16	F	L	P	C		
1.50	1.3	---	2150	---	X	X+								5/8	1-1/16	7/16	0	1-1/16	0.2	
1.75	1.5	---	AK17	2175	X	X	2175**							21/32	15/16	7/16	5/32	1-3/32	0.2	
2.00	1.7	---	AK20	2200	X	X	X	2200**						21/32	15/16	7/16	5/32	1-3/32	0.3	
2.10	1.8	1.5	AK21	2210	X	X	X	2210**						21/32	15/16	7/16	5/32	1-3/32	0.4	
2.20	2.0	1.7	AK22	2225	X	X	X	2225**	2225**					21/32	15/16	7/16	5/32	1-3/32	0.5	
2.30	2.1	1.8	AK23	---	X	X	X	X						21/32	15/16	7/16	5/32	1-3/32	0.5	
2.40	2.1	1.8	2240	---	X	X	X	X	X					3/4	1-1/8	9/16	3/16	1-5/16	0.8	
2.50	2.2	1.9	AK25	2250	X	X	X	X	2250**					21/32	15/16	7/16	5/32	1-3/32	0.5	
2.60	2.3	2.0	AK26	2260	X	X	X	X	2260**					21/32	15/16	7/16	5/32	1-3/32	0.5	
2.70	2.5	2.2	AK27	2275	X	X	X	X	X					21/32	15/16	7/16	5/32	1-3/32	0.6	
2.80	2.6	2.3	AK28	---	X	X	X	X	X					21/32	15/16	7/16	5/32	1-3/32	0.7	
3.00	2.7	2.4	2300	---	X	X	X	X	X					3/4	1-1/8	9/16	3/16	1-5/16	1.1	
3.05	2.8	2.5	AK30	AC31	X	X	X	X	X	X				21/32	15/16	7/16	5/32	1-3/32	0.7	
3.25	3.0	2.7	AK32	AC33	X	X	X	X	X	X				21/32	15/16	7/16	5/32	1-3/32	0.7	
3.45	3.2	2.9	AK34	AC35	X	X	X	X	X	X				21/32	15/16	7/16	5/32	1-3/32	0.9	
3.75	3.5	3.2	AK39	AC38	X	X	X	X	X	X				3/4	1-5/32	15/32	1/16	1-7/32	1.4	
3.95	3.7	3.4	AK41	AC40	X	X	X	X	X	X				3/4	1-5/32	15/32	1/16	1-7/32	1.5	
4.25	4.0	3.7	AK44	AC43	X	X	X	X	X	X				3/4	1-5/32	15/32	1/16	1-7/32	1.5	
4.45	4.2	3.9	AK46	AC45	X	X	X	X	X	X				3/4	1-5/32	15/32	1/16	1-7/32	1.5	
4.75	4.5	4.2	AK49	AC48	X	X	X	X	X	X				3/4	1-5/32	15/32	1/16	1-7/32	1.7	
4.95	4.7	4.4	AK51	AC50	X	X	X	X	X	X				3/4	1-5/32	15/32	1/16	1-7/32	1.7	
5.25	5.0	4.7	AK54	AC53	X	X	X	X	X	X	X			3/4	1-5/32	15/32	1/16	1-7/32	1.8	
5.45	5.2	4.9	AK56	AC55	X	X	X	X	X	X	X			3/4	1-5/32	15/32	1/16	1-7/32	1.9	
5.75	5.5	5.2	AK59	AC58	X	X	X	X	X	X	X			3/4	1-5/32	15/32	1/16	1-7/32	2.0	
5.95	5.7	5.4	AK61	AC60	X	X	X	X	X	X	X			3/4	1-5/32	15/32	1/16	1-7/32	2.1	
6.25	6.0	5.7	AK64	AC63	X	X	X	X	X	X				3/4	1-5/32	15/32	1/16	1-7/32	2.2	
6.45	6.2	5.9	AK66	AC65	X	X	X	X	X	X	X			3/4	1-5/32	15/32	1/16	1-7/32	2.3	
6.75	6.5	6.2	AK69	AC68			X		X	X				3/4	1-15/32	23/32	0	1-15/32	3.5	
6.95	6.7	6.4	AK71	AC70	X	X	X	X	X	X	X			3/4	1-15/32	23/32	0	1-15/32	3.8	
7.25	7.0	6.7	AK74	AC73	X*	X*	X*	X*	X*	X*	X	X		3/4	1-15/32	23/32	0	1-15/32	3.4	
7.75	7.5	7.2	AK79	AC78			X		X	X			X	3/4	1-15/32	23/32	0	1-15/32	4.0	
7.95	7.7	7.4	AC80	---	X	X	X	X	X	X	X			3/4	1-5/8	7/8	0	1-5/8	3.9	
8.25	8.0	7.7	AK84	AC83	X*	X*	X*	X*	X*	X	X			3/4	1-15/32	23/32	0	1-15/32	3.8	
8.75	8.5	8.2	AK89	---			X		X	X			X	3/4	1-15/32	23/32	0	1-15/32	4.3	
8.95	8.7	8.4	AC90	---	X	X	X	X	X	X		X		3/4	1-5/8	7/8	0	1-5/8	4.4	
9.25	9.0	8.7	AK94	AC93		X*	X*	X*	X*	X	X			3/4	1-15/32	23/32	0	1-15/32	4.5	
9.75	9.5	9.2	AK99	---			X		X				X	3/4	1-15/32	23/32	0	1-15/32	5.3	
9.95	9.7	9.4	AC100	---		X	X	X	X	X				3/4	1-5/8	7/8	0	1-5/8	5.6	
10.25	10.0	9.7	AK104	AC103		X*	X*	X*	X*	X	X			3/4	1-15/32	23/32	0	1-15/32	5.1	
10.75	10.5	10.2	AK109	---			X		X				X	3/4	1-15/32	23/32	0	1-15/32	5.8	
10.95	10.7	10.4	AC110	---			X		X	X				3/4	1-5/8	7/8	0	1-5/8	5.9	
11.25	11.0	10.7	AK114	AC113		X*	X*	X*	X*	X	X		X	3/4	1-15/32	23/32	0	1-15/32	5.6	
11.95	11.7	11.4	AC120	---	X	X	X	X	X	X	X	X		3/4	1-5/8	7/8	0	1-5/8	6.4	
12.25	12.0	11.7	AK124	AC123		X*	X*	X*	X*	X			X	3/4	1-15/32	23/32	0	1-15/32	6.5	
12.95	12.7	12.4	AC130	---			X		X	X				7/8	1-5/8	7/8	0	1-5/8	7.3	
13.25	13.0	12.7	AK134	AC133			X		X	X			X	3/4	1-15/32	23/32	0	1-15/32	7.5	
13.95	13.7	13.4	AK140	---		X	X		X	X	X			7/8	1-5/8	7/8	0	1-5/8	9.7	
14.25	14.0	13.7	AK144	AC143		X	X		X	X	X		X	3/4	1-15/32	23/32	0	1-15/32	8.5	
14.95	14.7	14.4	AC150	---					X	X			X	7/8	1-3/4	1	0	1-3/4	10.4	
15.25	15.0	14.7	AK154	AC153			X		X				X	3/4	1-15/32	23/32	0	1-15/32	9.8	
18.25	18.0	17.7	AK184	AC183			X		X				X	3/4	1-15/32	23/32	0	1-15/32	12.1	

+ No Keyway

^ For Standard Keyway Dimension Refer to Page A-2

* 1" Bore and Smaller C=1/16 and P=25/32

** Bore Size Available in Only Maurey Original Design. Specify Original Maurey Part Number When Ordering.



Hi-Q® cast iron sheaves-single groove for both "A" (4L) and "B" (5L) v-belts

STYLE 1

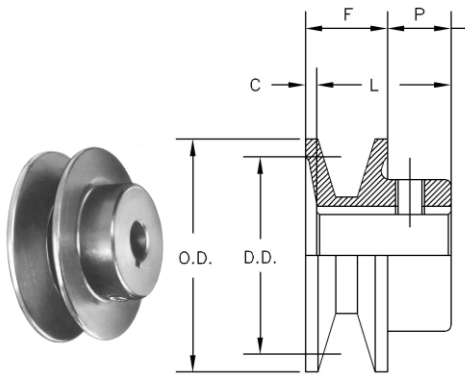

4200 - BK26

STYLE 2

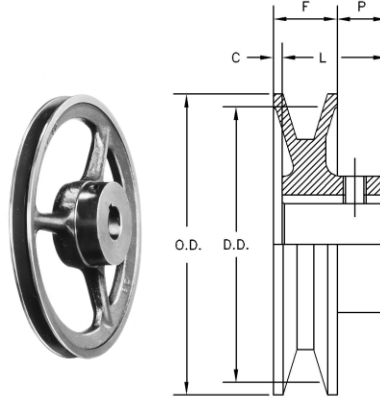

BK27 - BC46

STYLE 3

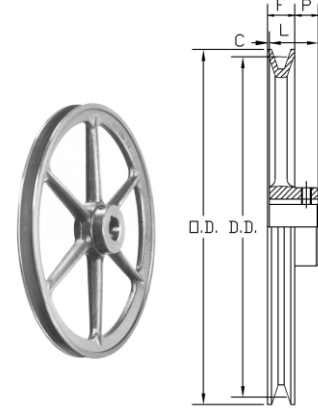

BK50 - BK190

DIAMETERS IN INCHES			Part Number	Original Maurey Number	STOCK BORES MARKED "X" ^										DIMENSIONS IN INCHES				Overall Length Inches	Approx Weight in LBS.
Outside	Datum "B" Belt	Datum "A" Belt			1/2	5/8	3/4	7/8	1	1-1/8	1-3/16	1-1/4	1-3/8	1-7/16	F	L	P	C		
2.00	1.7		4200	---	X	X	X							7/8	1-9/32	1/2	3/32	1-3/8	0.5	
2.25	2.0		4225	---	X	X	X	X						7/8	1-9/32	1/2	3/32	1-3/8	0.7	
2.40	2.2	1.8	BK24	---	X	X	X	X	X					13/16	1-1/16	13/32	5/32	1-7/32	0.4	
2.50	2.1	1.7	BK25	4250	X	X	X	X	X					13/16	1-1/16	13/32	5/32	1-7/32	0.5	
2.60	2.2	1.8	BK26	4260	X	X	X	X	X					13/16	1-1/16	13/32	5/32	1-7/32	0.6	
2.70	2.5	2.1	BK27	---	X	X	X	X	X					13/16	1-1/16	13/32	5/32	1-7/32	0.6	
2.95	2.6	2.2	BK28	BC30/4300	X	X	X	X	X	X				13/16	1-1/16	13/32	5/32	1-7/32	0.8	
3.15	2.8	2.4	BK30	BC32	X	X	X	X	X	X				13/16	1-1/16	13/32	5/32	1-7/32	0.8	
3.35	3.0	2.6	BK32	BC34	X	X	X	X	X	X				13/16	1-1/16	13/32	5/32	1-7/32	0.8	
3.55	3.2	2.8	BK34	BC36	X	X	X	X	X	X				7/8	1-5/32	13/32	1/8	1-9/32	1.3	
3.75	3.4	3.0	BK36	BC38	X	X	X	X	X	X				7/8	1-5/32	13/32	1/8	1-9/32	1.5	
3.95	3.6	3.2	BK40	BC40	X	X	X	X	X	X				7/8	1-5/32	13/32	1/8	1-9/32	1.5	
4.15	3.8	3.4	BC42	---	X	X	X	X	X	X				7/8	1-5/16	5/8	3/16	1-1/2	2.1	
4.25	3.9	3.5	BK45	---	X	X	X	X	X	X				7/8	1-5/32	13/32	1/8	1-9/32	1.8	
4.35	4.0	3.6	BC44	---	X	X	X	X	X	X				7/8	1-7/16	11/16	1/8	1-9/16	2.3	
4.45	4.1	3.7	BK47	---	X	X	X	X	X	X				7/8	1-5/32	13/32	1/8	1-9/32	1.9	
4.55	4.2	3.8	BC46	---	X	X	X	X	X	X				7/8	1-7/16	11/16	1/8	1-9/16	2.6	
4.75	4.4	4.0	BK50	BC48	X	X	X	X	X	X				7/8	1-5/32	13/32	1/8	1-9/32	2.0	
4.95	4.6	4.2	BK52	BC50	X	X	X	X	X	X	X			7/8	1-5/32	13/32	1/8	1-9/32	2.0	
5.15	4.8	4.4	BC52	---	X	X	X	X	X	X				7/8	1-5/8	3/4	-	1-5/8	2.6	
5.25	4.9	4.5	BK55	---	X	X	X	X	X	X				7/8	1-5/32	13/32	1/8	1-9/32	2.2	
5.35	5.0	4.6	BC54	---	X	X	X	X	X	X	X			7/8	1-5/8	3/4	-	1-5/8	2.7	
5.45	5.1	4.7	BK57	---	X	X	X	X	X	X				7/8	1-5/32	13/32	1/8	1-9/32	2.3	
5.55	5.2	4.8	BC56	---	X	X	X	X	X	X	X			7/8	1-5/8	3/4	-	1-5/8	3.0	
5.75	5.4	5.0	BK60	BC58	X	X	X	X	X	X	X			7/8	1-5/32	13/32	1/8	1-9/32	2.3	
5.95	5.6	5.2	BK62	BC60	X	X	X	X	X	X	X			7/8	1-5/32	13/32	1/8	1-9/32	2.4	
6.15	5.8	5.4	BC62	---	X	X	X	X	X	X	X			7/8	1-5/8	3/4	-	1-5/8	4.2	
6.25	5.9	5.5	BK65	---	X	X	X	X	X	X	X			7/8	1-5/32	13/32	1/8	1-9/32	2.7	
6.35	6.0	5.6	BC64	---	X	X	X	X	X	X	X	X		7/8	1-5/8	3/4	-	1-5/8	4.7	
6.45	6.1	5.7	BK67	---	X	X	X	X	X	X	X			7/8	1-5/32	13/32	1/8	1-9/32	2.8	
6.55	6.2	5.8	BC66	---	X	X	X	X	X	X	X			7/8	1-5/8	3/4	-	1-5/8	3.2	
6.75	6.4	6.0	BK70	BC68	X	X	X	X	X	X	X			7/8	1-15/32	21/32*	1/16*	1-17/32	3.3	
6.95	6.6	6.2	BK72	BC70	X	X	X	X	X	X	X			7/8	1-15/32	21/32	1/16	1-17/32	3.9	
7.15	6.8	6.4	BC72	---		X	X	X	X	X	X			7/8	1-5/8	3/4	-	1-5/8	4.1	
7.25	6.9	6.5	BK75	BC73	X	X	X	X	X	X	X			7/8	1-15/32	21/32	1/16	1-17/32	3.9	
7.45	7.1	6.7	BK77	---		X	X	X	X	X	X			7/8	1-15/32	21/32	1/16	1-17/32	4.1	
7.75	7.4	7.0	BK80	BC78		X	X	X	X	X	X	X		7/8	1-15/32	21/32	1/16	1-17/32	4.4	
8.25	7.9	7.5	BK85	BC83		X	X	X	X	X	X	X		7/8	1-15/32	21/32	1/16	1-17/32	5.0	
8.75	8.4	8.0	BK90	BC88			X	X	X	X	X	X		7/8	1-15/32	21/32	1/16	1-17/32	5.0	
8.95	8.6	8.2	BC90	---		X	X	X	X	X	X	X		7/8	1-5/8	3/4	-	1-5/8	4.9	
9.25	8.9	8.5	BK95	BC93		X	X	X	X	X	X	X		7/8	1-15/32	21/32	1/16	1-17/32	5.4	
9.75	9.4	9.0	BK100	BC98		X	X	X	X	X	X	X		7/8	1-15/32	21/32	1/16	1-17/32	5.6	
10.25	9.9	9.5	BK105	---			X	X	X	X	X	X		7/8	1-15/32	21/32	1/16	1-17/32	5.8	
10.75	10.4	10.0	BK110	---			X	X	X	X	X	X		7/8	1-15/32	21/32	1/16	1-17/32	6.4	
11.25	10.9	10.5	BK115	---			X	X	X	X	X	X		7/8	1-15/32	21/32	1/16	1-17/32	6.9	
11.35	11.0	10.6	BC114	---		X	X		X	X	X	X		7/8	1-5/8	3/4	-	1-5/8	7.4	
11.75	11.4	11.0	BK120	BC118			X	X	X	X	X	X		7/8	1-15/32	21/32	1/16	1-17/32	7.4	
12.75	12.4	12.0	BK130	BC128			X	X	X	X	X	X		7/8	1-15/32	21/32	1/16	1-17/32	8.4	
13.75	13.4	13.0	BK140	---			X	X	X	X	X	X		7/8	1-15/32	21/32	1/16	1-17/32	9.4	
13.95	13.6	13.2	BC140	---			X	X	X	X	X	X		7/8	1-3/4	7/8	-	1-3/4	8.0	
15.75	15.4	15.0	BK160	BC158			X	X	X	X	X	X	X	7/8	1-15/32	21/32	1/16	1-17/32	11.4	
18.75	18.4	18.0	BK190	BC188			X	X	X	X	X	X	X	7/8	1-15/32	21/32	1/16	1-17/32	13.4	

^ For Standard Keyway Dimension Refer to Page A-2



Hi-Q® cast iron sheaves-two groove for both "O" (3L) and "A" (4L) belts

STYLE 1

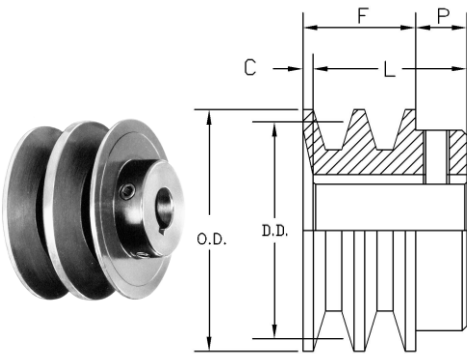

2AK20 - 2AK34

STYLE 2

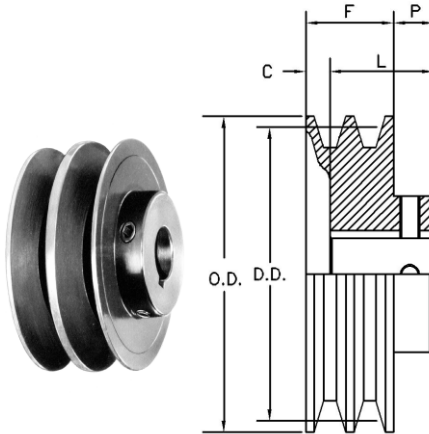

2AK39 - 2AK51

STYLE 3

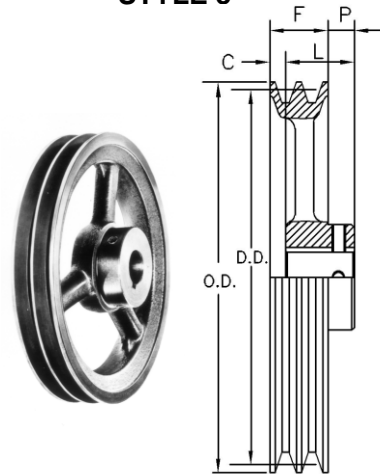

2AK54 - 2AK184

DIAMETERS IN INCHES			Part Number	Original Maurey Number	STOCK BORES MARKED "X" ^										DIMENSIONS IN INCHES				Overall Length Inches	Approx. Weight in LBS.
Outside	Datum "A" Belt	Datum "O" Belt			1/2	5/8	3/4	7/8	1	1-1/8	1-3/16	1-1/4	1-3/8	1-7/16	F	L	P	C		
2.00	1.7		2AK20	D2200	X	X	X	X							1-3/8	1-21/32	15/32	3/16	1-27/32	0.8
2.15	1.9	1.6	2AK21	---	X	X	X	X							1-3/8	1-21/32	15/32	3/16	1-27/32	0.9
2.25	2.0	1.7	2AK22	D2225	X	X	X	X	X						1-3/8	1-21/32	15/32	3/16	1-27/32	0.9
2.35	2.1	1.8	2AK23	---	X	X	X	X	X						1-3/8	1-21/32	15/32	3/16	1-27/32	1.1
2.45	2.2	1.9	D2250	---	X	X	X	X	X	X					1-3/8	1-11/16	7/16	0	1-11/16	1.4
2.55	2.3	2.0	2AK25	---	X	X	X	X	X						1-3/8	1-21/32	15/32	3/16	1-27/32	1.3
2.65	2.4	2.1	2AK26	---	X	X	X	X	X						1-3/8	1-21/32	15/32	3/16	1-27/32	1.4
2.75	2.5	2.2	2AK27	D2275	X	X	X	X	X	D2275**					1-3/8	1-21/32	15/32	3/16	1-27/32	1.5
2.85	2.6	2.3	2AK28	---	X	X	X	X	X						1-3/8	1-21/32	15/32	3/16	1-27/32	1.8
2.95	2.7	2.4	D2300	---	X	X	X	X	X	X					1-3/8	1-7/8	5/8	1/8	2	2.4
3.05	2.8	2.5	2AK30	---	X	X	X	X	X	X					1-3/8	1-21/32	15/32	3/16	1-27/32	1.8
3.25	3.0	2.7	2AK32	D2325	X	X	X	X	X	X					1-3/8	1-21/32	15/32	3/16	1-27/32	2.1
3.45	3.2	2.9	2AK34	D2350	X	X	X	X	X	X					1-3/8	1-21/32	15/32	3/16	1-27/32	2.3
3.75	3.5	3.2	2AK39	D2380	X	X	X	X	X	X					1-3/8	1-11/32	15/32	3/16	1-27/32	2.6
3.95	3.7	3.4	2AK41	D2400	X	X	X	X	X	X					1-3/8	1-11/32	15/32	1/2	1-27/32	2.9
4.25	4.0	3.7	2AK44	D2425		X	X	X	X	X					1-3/8	1-11/32	15/32	1/2	1-27/32	3.0
4.45	4.2	3.9	2AK46	D2450		X	X	X	X	X					1-3/8	1-11/32	15/32	1/2	1-27/32	3.1
4.75	4.5	4.2	2AK49	D2480		X	X	X	X	X					1-3/8	1-11/32	15/32	1/2	1-27/32	3.6
4.95	4.7	4.4	2AK51	D2500		X	X	X	X	X					1-3/8	1-11/32	15/32	1/2	1-27/32	3.8
5.25	5.0	4.7	2AK54	D2525		X	X	X	X	X					1-3/8	1-11/32	15/32	1/2	1-27/32	3.3
5.45	5.2	4.9	2AK56	D2550		X	X	X	X	X					1-3/8	1-11/32	15/32	1/2	1-27/32	3.4
5.75	5.5	5.2	2AK59	D2580			X	X	X	X	X				1-3/8	1-11/32	15/32	1/2	1-27/32	3.5
5.95	5.7	5.4	2AK61	D2600		X	X	X	X	X					1-3/8	1-11/32	15/32	1/2	1-27/32	3.6
6.25	6.0	5.7	2AK64	---			X	X	X	X					1-3/8	1-19/32	11/32	1/8	1-23/32	4.8
6.45	6.2	5.9	D2650	---			X	X	X	X					1-3/8	1-5/8	5/8	3/8	2	5.4
6.95	6.7	6.4	D2700	---			X	X	X	X					1-3/8	1-5/8	5/8	3/8	2	6.1
7.25	7.0	6.7	2AK74	D2725		X	X	X	X	X					1-3/8	1-19/32	11/32	1/8	1-23/32	5.6
7.95	7.7	7.4	D2800	---			X	X	X	X	X				1-3/8	1-5/8	5/8	3/8	2	6.7
8.25	8.0	7.7	2AK84	---			X	X	X	X	X				1-3/8	1-19/32	11/32	1/8	1-23/32	6.4
8.95	8.7	8.4	D2900	---			X	X	X	X	X				1-3/8	1-5/8	5/8	3/8	2	9.0
9.25	9.0	8.7	2AK94	D2925			X	X	X	X	X				1-3/8	1-19/32	11/32	1/8	1-23/32	7.3
9.95	9.7	9.4	D3100	---			X	X	X	X	X	X			1-3/8	1-5/8	5/8	3/8	2	9.9
10.25	10.0	9.7	2AK104	D3103			X	X	X	X	X	X			1-3/8	1-19/32	11/32	1/8	1-23/32	8.1
10.95	10.7	10.4	D3110	---			X	X	X	X	X	X			1-3/8	1-5/8	5/8	3/8	2	11.4
11.25	11.0	10.7	2AK114	---			X	X	X	X	X	X			1-3/8	1-19/32	11/32	1/8	1-23/32	9.0
11.95	11.7	11.4	D3120	---			X	X	X	X	X	X			1-3/8	1-5/8	5/8	3/8	2	11.6
12.25	12.0	11.7	2AK124	D3123			X	X	X	X	X	X			1-3/8	1-19/32	11/32	1/8	1-23/32	9.8
13.25	13.0	12.7	2AK134	---						X	X	X			1-3/8	1-19/32	11/32	1/8	1-23/32	12.3
14.25	14.0	13.7	2AK144	D3143					X	X	X	X			1-3/8	1-19/32	11/32	1/8	1-23/32	13.9
15.25	15.0	14.7	2AK154	D3153					X	X	X	X			1-3/8	1-19/32	11/32	1/8	1-23/32	14.3
18.25	18.0	17.7	2AK184	D3183					X	X	X	X	X		1-3/8	1-19/32	11/32	1/8	1-23/32	17.4

** Bore Size Available in Only Maurey Original Design. Specify Original Maurey Part Number When Ordering.

^ For Standard Keyway Dimension Refer to Page A-2



Hi-Q® cast iron sheaves-two grooves for both "A" (4L) and "B" (5L) belts

STYLE 1

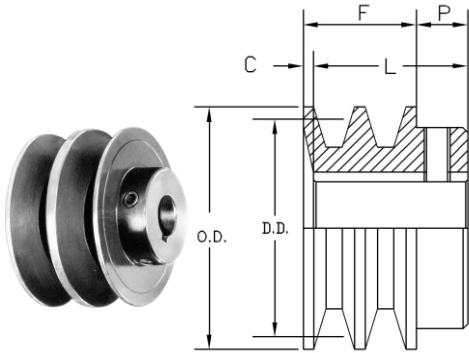

D4250 - 2BK36

STYLE 2

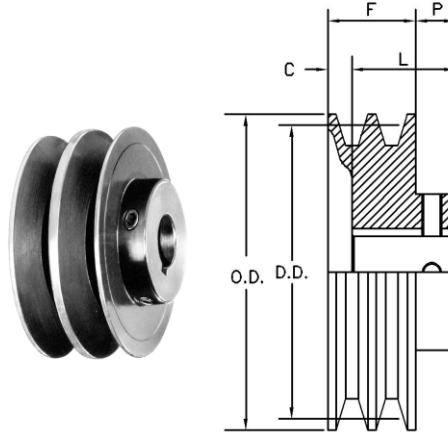

2BK40 - 2BK57

STYLE 3

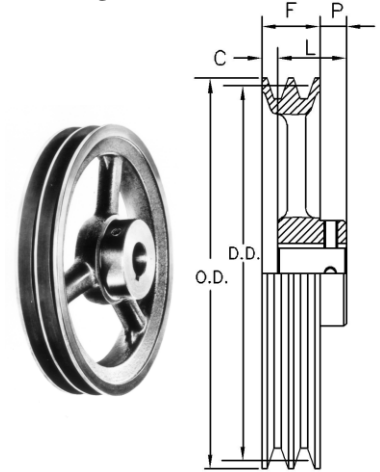

2BK60 - 2BK190

DIAMETERS IN INCHES			Part Number	Original Maurey Number	STOCK BORES MARKED "X" ^										DIMENSIONS IN INCHES				Overall Length Inches	Approx. Weight in LBS.
Outside	Datum "B" Belt	Datum "A" Belt			1/2	5/8	3/4	7/8	1	1-1/8	1-3/16	1-1/4	1-3/8	1-7/16	F	L	P	C		
2.45	2.1	2.0	D4250	----	X	X	X	X	X	X				1-9/16	2	7/16	0	2	1.2	
2.75	2.4	2.0	D4280	----	X	X	X	X	X	X				1-9/16	2	7/16	0	2	1.0	
2.95	2.6	2.2	2BK28	D4300	X	X	X	X	X		X			1-3/4	1-31/32	15/32	1/4	2-7/32	1.9	
3.15	2.8	2.4	2BK30	D4320	X	X	X	X	X		X	X		1-3/4	1-31/32	15/32	1/4	2-7/32	2.3	
3.35	3.0	2.6	2BK32	D4340	X	X	X	X	X	X	X	X		1-3/4	1-31/32	15/32	1/4	2-7/32	2.6	
3.55	3.2	2.8	2BK34	D4360	X	X	X	X	X	X		X	X	1-3/4	1-31/32	15/32	1/4	2-7/32	2.8	
3.75	3.4	3.0	2BK36	D4380	X	X	X	X	X	X		X	X	1-3/4	1-31/32	15/32	1/4	2-7/32	3.3	
3.95	3.6	3.2	2BK40	D4400		X	X	X	X	X	X	X	X	1-3/4	1-15/32	15/32	3/4	2-7/32	3.3	
4.15	3.8	3.4	D4420	----		X	X	X	X	X		X	X	1-3/4	1-9/16	5/8	13/16	2-3/8	4.1	
4.25	3.9	3.5	2BK45	----		X	X	X	X	X		X	X	1-3/4	1-15/32	15/32	3/4	2-7/32	3.3	
4.35	4.0	3.6	D4440	----		X	X	X	X	X		X		1-3/4	1-9/16	5/8	13/16	2-3/8	4.1	
4.45	4.1	3.7	2BK47	----		X	X	X	X	X		X		1-3/4	1-15/32	15/32	3/4	2-7/32	3.7	
4.55	4.2	3.8	D4460	----		X	X	X	X	X	X		X	1-3/4	1-9/16	5/8	13/16	2-3/8	4.5	
4.75	4.4	4.0	2BK50	D4480		X	X	X	X	X		X	X	1-3/4	1-15/32	15/32	3/4	2-7/32	4.1	
4.95	4.6	4.2	2BK52	D4500		X	X	X	X	X	X	X	X	1-3/4	1-15/32	15/32	3/4	2-7/32	4.5	
5.15	4.8	4.4	D4520	----		X	X	X	X	X	X	X		1-3/4	1-9/16	5/8	13/16	2-3/8	5.3	
5.25	4.9	4.5	2BK55	----				X	X	X		X		1-3/4	1-15/32	15/32	3/4	2-7/32	4.5	
5.35	5.0	4.6	D4540	----		X	X	X	X	X		X	X	1-3/4	1-9/16	5/8	13/16	2-3/8	6.3	
5.45	5.1	4.7	2BK57	----			X	X	X	X		X		1-3/4	1-15/32	15/32	3/4	2-7/32	5.1	
5.55	5.2	4.8	D4560	----			X	X	X	X		X		1-3/4	1-5/8	5/8	3/4	2-3/8	5.2	
5.75	5.4	5.0	2BK60	D4580			X	X	X	X		X		1-3/4	1-15/32	15/32	3/4	2-7/32	4.9	
5.95	5.6	5.2	2BK62	D4600			X	X	X	X	X	X	X	1-3/4	1-15/32	15/32	3/4	2-7/32	4.8	
6.15	5.8	5.4	D4620	----			X	X	X	X		X		1-3/4	1-5/8	5/8	3/4	2-3/8	6.1	
6.25	5.9	5.5	2BK65	----				X	X	X	X	X		1-3/4	1-15/32	15/32	3/4	2-7/32	5.0	
6.35	6.0	5.6	D4640	----			X	X	X	X		X	X	1-3/4	1-5/8	5/8	3/4	2-3/8	6.9	
6.45	6.1	5.7	2BK67	----				X	X	X		X		1-3/4	1-15/32	15/32	3/4	2-7/32	5.0	
6.55	6.2	5.8	D4660	----			X	X	X	X				1-3/4	1-5/8	5/8	3/4	2-3/8	6.9	
6.75	6.4	6.0	2BK70	D4680			X	X	X	X	X		X	1-3/4	1-19/32	11/32	1/2	2-7/32	6.6	
6.95	6.6	6.2	D4700	----			X	X	X	X		X		1-3/4	1-5/8	5/8	3/4	2-3/8	7.5	
7.15	6.8	6.4	D4720	----				X	X	X				1-3/4	1-5/8	5/8	3/4	2-3/8	7.9	
7.75	7.4	7.0	2BK80	D4780			X	X	X	X	X		X	1-3/4	1-19/32	11/32	1/2	2-3/32	7.2	
8.75	8.4	8.0	2BK90	D4880				X	X	X	X		X	1-3/4	1-19/32	11/32	1/2	2-3/32	0.4	
8.95	8.6	8.2	D4900	----			X	X	X	X	X		X	1-3/4	1-5/8	5/8	3/4	2-3/8	10.5	
9.75	9.4	9.0	2BK100	D4980				X	X	X	X		X	1-3/4	1-19/32	11/32	1/2	2-3/32	9.4	
10.75	10.4	10.0	2BK110	D5108				X	X	X	X		X	1-3/4	1-19/32	11/32	1/2	2-3/32	10.4	
11.35	11.0	10.6	D5114	----				X	X	X	X		X	1-3/4	1-5/8	5/8	3/4	2-3/8	13.5	
11.75	11.4	11.0	2BK120	D5118				X	X	X	X		X	1-3/4	1-19/32	11/32	1/2	2-3/32	11.8	
12.75	12.4	12.0	2BK130	D5128				X	X	X	X		X	1-3/4	1-19/32	11/32	1/2	2-3/32	14.9	
13.75	13.4	13.0	2BK140	----				X	X	X	X		X	1-3/4	1-19/32	11/32	1/2	2-3/32	16.3	
13.95	13.6	13.2	D5140	----				X	X	X	X		X	1-3/4	1-3/4	5/8	5/8	2-3/8	18.4	
15.75	15.4	15.0	2BK160	D5158				X	X	X	X		X	1-3/4	1-19/32	11/32	1/2	2-3/32	18.0	
18.75	18.7	18.0	2BK190	D5188				X	X	X	X		X	1-3/4	1-19/32	11/32	1/2	2-3/32	23.3	

^ For Standard Keyway Dimension Refer to Page A-2

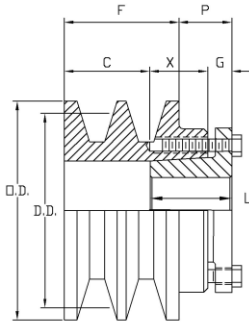

STYLE 1

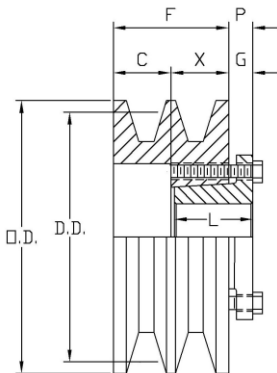

STYLE 2

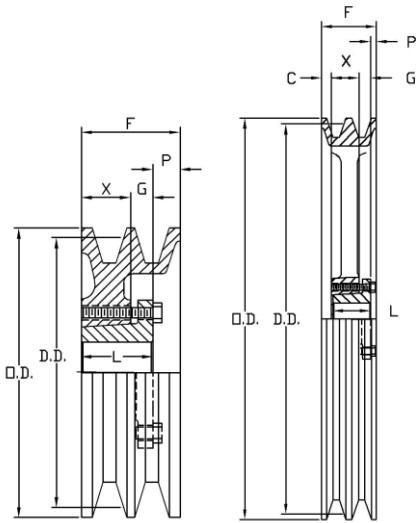

**STYLE 3
(SOLID)**

**STYLE 4
(SPOKED)**

For Both Belt Sections "A" (4L) and "O" (3L)

O.D. Inches	D.D. A Belts Inches	D.D. O Belts Inches	Part Number	Original Maurey Number	Style	Weight (Lbs)	Dimensions - Inches					
							F	L	P	C	X	G
3.05	2.8	2.5	2AK30H	DH2300	1	1.4	1 3/8	1 1/4	7/8	15/16	7/8	7/16
3.25	3.0	2.7	2AK32H	DH2325	1	1.7	1 3/8	1 1/4	7/8	15/16	7/8	7/16
3.45	3.2	2.9	2AK34H	DH2350	2	1.8	1 3/8	1 1/4	7/16	1/2	7/8	7/16
3.75	3.5	3.2	2AK39H	DH2380	2	1.8	1 3/8	1 1/4	7/16	1/2	7/8	7/16
3.95	3.7	3.4	2AK41H	DH2400	3	1.9	1 3/8	1 1/4	1/16	---	7/8	7/16
4.25	4.0	3.7	2AK44H	DH2425	3	2.4	1 3/8	1 1/4	1/16	---	7/8	7/16
4.45	4.2	3.9	2AK46H	DH2450	3	2.5	1 3/8	1 1/4	1/16	---	7/8	7/16
4.75	4.5	4.2	2AK49H	DH2480	3	3.1	1 3/8	1 1/4	1/16	---	7/8	7/16
4.95	4.7	4.4	2AK51H	DH2500	3	3.2	1 3/8	1 1/4	1/16	---	7/8	7/16
5.25	5.0	4.7	2AK54H	DH2525	3	3.4	1 3/8	1 1/4	1/16	---	7/8	7/16
5.45	5.2	4.9	2AK56H	DH2550	3	3.6	1 3/8	1 1/4	1/16	---	7/8	7/16
5.75	5.5	5.2	2AK59H	DH2580	4	3.4	1 3/8	1 1/4	1/16	0	7/8	7/16
5.95	5.7	5.4	2AK61H	DH2600	4	3.3	1 3/8	1 1/4	1/16	0	7/8	7/16
6.25	6.0	5.7	2AK64H	---	4	3.9	1 3/8	1 1/4	1/16	0	7/8	7/16
6.45	6.2	5.9	DH2650	---	4	4.9	1 3/8	1 1/4	1/16	0	7/8	7/16
6.95	6.7	6.4	DH2700	---	4	5.4	1 3/8	1 1/4	1/16	0	7/8	7/16
7.25	7.0	6.7	2AK74H	DH2730	4	4.9	1 3/8	1 1/4	1/16	0	7/8	7/16
7.95	7.7	7.4	DH2800	---	4	5.9	1 3/8	1 1/4	1/16	0	7/8	7/16
8.25	8.0	7.7	2AK84H	---	4	5.8	1 3/8	1 1/4	1/16	0	7/8	7/16
8.95	8.7	8.4	DH2900	---	4	7.2	1 3/8	1 1/4	1/16	0	7/8	7/16
9.25	9.0	8.7	2AK94H	DH2930	4	6.1	1 3/8	1 1/4	1/16	0	7/8	7/16
9.95	9.7	9.4	DH3100	---	4	8.6	1 3/8	1 1/4	1/16	0	7/8	7/16
10.25	10.0	9.7	2AK104H	DH3103	4	7.7	1 3/8	1 1/4	1/16	0	7/8	7/16
10.95	10.7	10.4	DH3110	---	4	10.2	1 3/8	1 1/4	1/16	0	7/8	7/16
11.25	11.0	10.7	2AK114H	---	4	8.5	1 3/8	1 1/4	1/16	0	7/8	7/16
11.95	11.7	11.4	DH3120	---	4	10.7	1 3/8	1 1/4	1/16	0	7/8	7/16
12.25	12.0	11.7	2AK124H	DH3123	4	9.5	1 3/8	1 1/4	1/16	0	7/8	7/16
13.25	13.0	12.7	2AK134H	---	4	11.4	1 3/8	1 1/4	1/16	0	7/8	7/16
14.25	14.0	13.7	2AK144H	DH3143	4	11.9	1 3/8	1 1/4	1/16	0	7/8	7/16
15.25	15.0	14.7	2AK154H	DH3153	4	13.3	1 3/8	1 1/4	1/16	0	7/8	7/16
18.25	18.0	17.7	2AK184H	DH3183	4	16.8	1 3/8	1 1/4	1/16	0	7/8	7/16

For Both Belt Sections "B" (5L) and "A" (4L)

O.D. Inches	D.D. A Belts Inches	D.D. O Belts Inches	Part Number	Original Maurey Number	Style	Weight (Lbs)	Dimensions - Inches					
							F	L	P	C	X	G
3.35	3.0	2.6	2BK32H	DH4340	1	2.1	1 3/4	1 1/4	7/8	1 5/16	7/8	7/16
3.55	3.2	2.8	2BK34H	DH4360	1	2.4	1 3/4	1 1/4	7/8	1 5/16	7/8	7/16
3.75	3.4	3.0	2BK36H	DH4380	1	2.0	1 3/4	1 1/4	7/16	7/8	7/8	7/16
3.95	3.6	3.2	2BK40H	DH4400	1	2.4	1 3/4	1 1/4	7/16	7/8	7/8	7/16
4.15	3.8	3.4	DH4420	---	2	3.5	1 3/4	1 1/4	7/16	15/16	7/8	7/16
4.25	3.9	3.5	2BK45H	---	1	3.0	1 3/4	1 1/4	7/16	7/8	7/8	7/16
4.35	4.0	3.6	DH4440	---	3	3.1	1 3/4	1 1/4	7/16	---	7/8	7/16
4.45	4.1	3.7	2BK47H	---	3	2.8	1 3/4	1 1/4	7/16	---	7/8	7/16
4.55	4.2	3.8	DH4460	---	3	3.8	1 3/4	1 1/4	7/16	---	7/8	7/16
4.75	4.4	4.0	2BK50H	DH4480	3	3.3	1 3/4	1 1/4	7/16	---	7/8	7/16
4.95	4.6	4.2	2BK52H	DH4500	3	3.6	1 3/4	1 1/4	7/16	---	7/8	7/16
5.15	4.8	4.4	DH4520	---	3	4.8	1 3/4	1 1/4	7/16	---	7/8	7/16
5.25	4.9	4.5	2BK55H	---	3	3.9	1 3/4	1 1/4	7/16	---	7/8	7/16
5.35	5.0	4.6	DH4540	---	3	4.9	1 3/4	1 1/4	7/16	---	7/8	7/16
5.45	5.1	4.7	2BK57H	---	3	4.3	1 3/4	1 1/4	7/16	---	7/8	7/16
5.55	5.2	4.8	DH4560	---	4	4.0	1 3/4	1 1/4	7/16	---	7/8	7/16
5.75	5.4	5.0	2BK60H	DH4580	3	4.4	1 3/4	1 1/4	7/16	---	7/8	7/16
5.95	5.6	5.2	2BK62H	DH4600	3	4.5	1 3/4	1 1/4	7/16	---	7/8	7/16
6.15	5.8	5.4	DH4620	---	4	5.1	1 3/4	1 1/4	7/16	---	7/8	7/16
6.25	5.9	5.5	2BK65H	---	4	4.5	1 3/4	1 1/4	7/16	1/4	7/8	7/16
6.35	6.0	5.6	DH4640	---	4	5.9	1 3/4	1 1/4	7/16	---	7/8	7/16
6.45	6.1	5.7	2BK67H	---	4	5.0	1 3/4	1 1/4	7/16	1/4	7/8	7/16
6.55	6.2	5.8	DH4660	---	4	5.2	1 3/4	1 1/4	7/16	---	7/8	7/16
6.75	6.4	6.0	2BK70H	DH4680	4	5.1	1 3/4	1 1/4	7/16	1/4	7/8	7/16
6.95	6.6	6.2	DH4700	---	4	5.6	1 3/4	1 1/4	7/16	---	7/8	7/16
7.15	6.8	6.4	DH4720	---	4	6.9	1 3/4	1 1/4	7/16	---	7/8	7/16
7.75	7.4	7.0	2BK80H	DH4780	4	6.4	1 3/4	1 1/4	7/16	1/4	7/8	7/16
8.75	8.4	8.0	2BK90H	DH4880	4	7.6	1 3/4	1 1/4	7/16	1/4	7/8	7/16
8.95	8.6	8.2	DH4900	---	4	7.4	1 3/4	1 1/4	7/16	---	7/8	7/16
9.75	9.4	9.0	2BK100H	DH4980	4	8.4	1 3/4	1 1/4	7/16	1/4	7/8	7/16
10.75	10.4	10.0	2BK110H	DH5108	4	9.3	1 3/4	1 1/4	7/16	1/4	7/8	7/16
11.35	11.0	10.6	DH5114	---	4	12.0	1 3/4	1 1/4	7/16	---	7/8	7/16
11.75	11.4	11.0	2BK120H	DH5118	4	11.0	1 3/4	1 1/4	7/16	1/4	7/8	7/16
12.75	12.4	12.0	2BK130H	DH5128	4	13.1	1 3/4	1 1/4	7/16	1/4	7/8	7/16
13.75	13.4	13.0	2BK140H	---	4	14.8	1 3/4	1 1/4	7/16	1/4	7/8	7/16
13.95	13.6	13.2	DH5140	---	4	14.1	1 3/4	1 1/4	7/16	1/4	7/8	7/16
15.75	15.4	15.0	2BK160H	DH5158	4	17.5	1 3/4	1 1/4	7/16	1/4	7/8	7/16
18.75	18.4	18.0	2BK190H	DH5188	4	21.5	1 3/4	1 1/4	7/16	1/4	7/8	7/16



HQ Ful-grip Bushings

HQ BUSHING DIMENSIONS (inches)								
A	B	D	E	F	G	L	Bolt Circle	Cap Screws
1/4	1-5/8	2-1/2	1	7/8	1/8	1-1/4	2	2-1/4 x 3/4

STOCK BORES	
BORE (inches)	KEYSEAT
3/8, 7/16, 1/2, 9/16	NONE
5/8, 11/16, 3/4, 3/16, 7/8	3/16 X 3/32
15/16, 1, 1-1/16, 1-1/8, 1-3/16	1/4 X 1/8
1-1/4	1/4 x 1/16
1-5/16, 1-3/8	5/16 X 1/16
1-7/16, 1-1/2	3/8 X 1/16
BORE (mm)	KEYSTOCK
14, 15, 16, 17	5 x 5
18, 19, 20, 22	6 x 6
24, 25, 28, 30	8 x 7
32, 35, 38	10 x 8

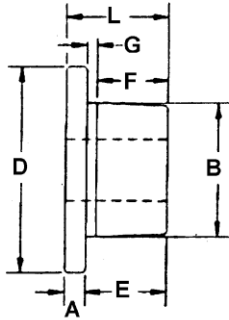

When Ordering Specify Bore Size

For Example: HQ x 3/4"

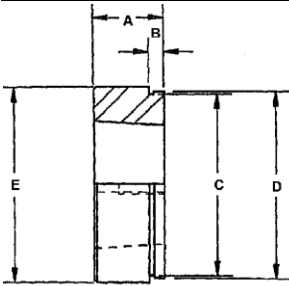

weld-on hub for HQ bushing

Part Number HHQ1 or HHQ2

HUB DIMENSIONS (inches)					
Part Number	A	B	C	D	E
HHQ1	7/8	3/16	2.311	2-3/8	2-1/2
HHQ2	7/8	0.532	2.311	2-3/8	2-1/2



steel shaft collars

steel shaft collars

Made from cold rolled steel precision machined for true Running faces. Locked in position for vibration proof Service with cup point, hollow head set screws.



ORDER IN STANDARD PACKAGE QUANTITIES

Part Number	Bore Inches	Outside Diameter Inches	Width Inches	Size of Set Screw	Weight Ounces Each	Std. Pkg. Qty	Part Number	Bore Inches	Outside Diameter Inches	Width Inches	Size of Set Screw	Weight Ounces Each	Std.* Pkg. Qty
1544	3/16	7/16	1/4	8-32 X 1/8"	1/5	50	1517	1-1/2	2-1/4	3/4	3/8 X 3/8"	7-1/2	25
1542	1/4	5/8	9/32	10-32 X 1/8"	1/4	50	1521	1-9/16	2-1/2	13/16	3/8 X 3/8"	10-3/4	10
1543	5/16	5/8	11/32	10-32 X 1/8"	1/2	50	1522	1-5/8	2-1/2	13/16	3/8 X 3/8"	10	10
1500	3/8	3/4	3/8	1/4 X 3/16"	1/2	50	1518	1-11/16	2-1/2	13/16	3/8 X 3/8"	9-1/4	10
1501	7/16	7/8	7/16	1/4 X 1/4"	1	50	1523	1-3/4	2-3/4	7/8	1/2 X 1/2"	13-1/2	10
1502	1/2	1	7/16	1/4 X 1/4"	1-1/4	50	1524	1-13/16	2-3/4	7/8	1/2 X 1/2"	13	10
1503	9/16	1	7/16	1/4 X 1/4"	1-1/4	25	1525	1-7/8	2-3/4	7/8	1/2 X 1/2"	12-1/4	10
1504	5/8	1-1/8	1/2	5/16 X 1/4"	1-1/2	25	1519	1-15/16	3	7/8	1/2 X 1/2"	16-1/4	10
1505	11/16	1-1/4	9/16	5/16 X 1/4"	2	25	1526	2	3	7/8	1/2 X 1/2"	16	10
1506	3/4	1-1/4	9/16	5/16 X 1/4"	2	25	1530	2-1/8	3	7/8	1/2 X 1/2"	16	5
1507	13/16	1-5/16	9/16	5/16 X 1/4"	2	25	1531	2-3/16	3-1/4	15/16	1/2 X 1/2"	18-1/2	5
1508	7/8	1-1/2	9/16	5/16 X 5/16"	2-1/2	25	1532	2-1/4	3-1/4	15/16	1/2 X 1/2"	17-1/2	5
1509	15/16	1-5/8	9/16	5/16 X 5/16"	3-1/4	25	1533	2-5/16	3-1/4	15/16	1/2 X 1/2"	17-1/4	5
1510	1	1-5/8	5/8	5/16 X 5/16"	4	25	1534	2-3/8	3-1/4	15/16	1/2 X 1/2"	22	5
1511	1-1/16	1-3/4	5/8	5/16 X 5/16"	4-1/4	25	1535	2-7/16	3-1/2	1	1/2 X 1/2"	21-3/4	5
1512	1-1/8	1-3/4	5/8	5/16 X 5/16"	3-3/4	25	1536	2-1/2	3-1/2	1	1/2 X 1/2"	20-3/4	5
1513	1-3/16	2	11/16	3/8 X 3/8"	6	25	1537	2-9/16	3-3/4	1-1/8	1/2 X 5/8"	30	5
1514	1-1/4	2	11/16	3/8 X 3/8"	6	25	1538	2-11/16	4	1-1/8	1/2 X 5/8"	35	5
1520	1-5/16	2-1/8	11/16	3/8 X 3/8"	6-1/2	25	1539	2-3/4	4	1-1/8	1/2 X 5/8"	34	5
1515	1-3/8	2-1/8	3/4	3/8 X 3/8"	6-1/2	25	1540	2-15/16	4-1/4	1-1/8	1/2 X 5/8"	38	5
1516	1-7/16	2-1/4	3/4	3/8 X 3/8"	7-3/4	25	1541	3	4-1/4	1-1/8	1/2 X 5/8"	36	5

* Maurey Steel Shaft Collars Only Sold in Multiples of Standard Package Quantities (No Broken Lots)



Single Groove Sheave



Double Groove Sheave

INSTALLATION AND REMOVAL OF HQ BUSHINGS

INSTALLATION:

1. Make sure the bore of the sheave and the tapered cone surface of the bushing are free of all foreign substances such as paint, dirt, lubricants, etc. Do not use lubricants on installation.
2. Assemble as illustrated, by inserting two cap screws through clearance holes in bushing. Cap Screws are to be loosely inserted in sheave so that bushing easily slides on to shaft.
3. Place keystone in keyseat between shaft and bore of bushing.
4. Tighten screws progressively. (See tightening instructions.)

TIGHTENING INSTRUCTIONS:

When mounting HQ Bushings which are slotted all the way through to maintain even torque (Ful-Grip Design), tightening forces on the screws are multiplied many times by the wedging action of the tapered surface. If extreme screw tightening forces are applied in mounting the HQ Bushing, bursting pressure will be created in the hub of the mounted sheave which may cause it to crack, and void the warranty.

CAUTION: Do not use lubricants on screw threads or tapered surfaces
Refer to the recommended torque ratings.
Tighten bushing screws evenly and progressively

REMOVAL INSTRUCTIONS:

1. Loosen and remove cap screws.
2. Insert cap screws in threaded holes of bushing.
3. Tighten evenly until sheave is loose on shaft.

WRENCH TORQUE VALUE FOR TIGHTENING HQ FUL-GRIP BUSHING

Bushing	Wrench Torque In Pounds	Wrench Length In Inches	Wrench Pull In Pounds
HQ	90	4	22
HQ	90	10	9