

MULTIPIN SPARE PARTS Male Configuration

PN7c pictured

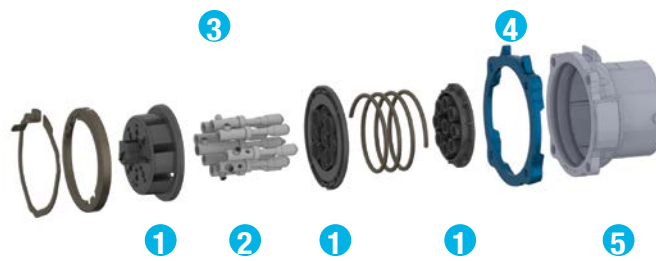

DN9c pictured



	DSN12c POLY	DSN24c POLY	DSN37c POLY	DS24c SS	DS37c SS
Plug Interior	61-AA910	61-BA910	61-CA910	61-BA910-SS	61-CA910-SS
Plug Contact (Qty = 13)*	61-AA113	61-BA113	61-CA113	61-BA113	61-CA113
Plug Casing**	61-1A105	61-3A105	61-6A105	39-1A014-SS	39-CA014-SS
Device Gasket	61-1AM26	61-3AM26	31-3AM26	39-1A026-SS	31-3AM26

* If a DSN24c or 37c device was originally purchased before February 2013, contact Customer Service for parts.

** If a DSN24c or 37c device was originally purchased before March 2015, contact Customer Service for casing parts.

	PN7c POLY	PN7c METAL	PN12c POLY	PN12c METAL
1 Plug Interior, Ground Contact & Connection	01-PA910	09-PA910	01-AA910	09-AA910
2 Plug Contact (PN12c Qty = 13)*	09-PA911	09-PA911	01-AA113	01-AA113
3 Device Gasket	61-1AM26	61-1AM26	61-1AM26	61-1AM26
4 Plug Casing	01-NA014	09-NA014	01-NA014	09-NA014
5 Ground Contact	09-PA919	09-PA919	-	-

* If the PN12c device was purchased before March 2013, contact Customer Service for parts.

	DN9c METAL	DN20c METAL	DS7c/ DR7c POLY	DS7c/ DR7c METAL
1 Plug Interior	19-1A910	19-6A910	Plug Casing	31-6A014
2 Plug Contact (Short/Outside)	19-1A911	19-6A911	Plug Phase Contact	31-3A911
2 Plug Contact (Long/Inside)	19-1A711	19-6A711	Plug Pilot Contact	31-3A911-172
3 Plug Ground Contact	19-1A919	19-6A919	Plug Interior	31-3A910-263
4 Plug Casing	19-1A014	19-6A014	Device Gasket	31-6AM26
5 Device Gasket	31-3A026	31-9A026	Ground Contact	31-3A919