

PN SPARE PARTS Male Configuratio

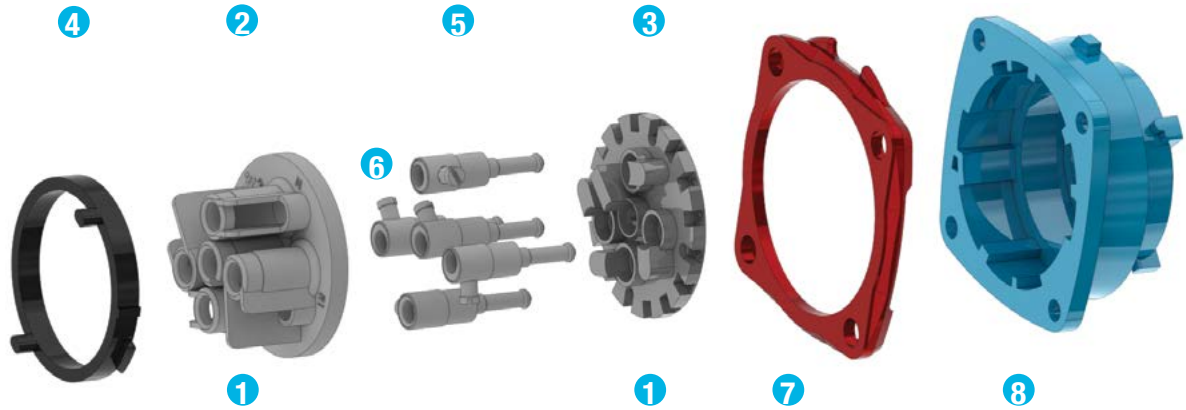

		PN20 POLY	PN20 METAL	PNHT HT METAL
1	Plug Interior**	01-2A010*	01-2A010*	01-2A010-185*
2	Interior Bottom**	01-2A010-B	01-2A010-B	01-2A010-185-B
3	Interior Top**	01-2A010-T*	01-2A010-T*	01-2A010-185-T*
4	Locking Ring	01-NA583	09-2A583	09-2A583-185
5	Plug Contact	01-2A011	01-2A011	01-2A011-185
6	Ground Contact	01-2A019	01-2A019	01-2A019-185
7	Color-Coded Voltage Gasket	125V	61-1AC26	-
		208V	61-1AB26	-
		250V	61-1AC26	-
		480V	61-1AR26	-
8	Plug Casing	01-NA014**	09-NA014**	09-2A014-185**

* Voltage and phasing positions must be specified (5th, 6th & 7th digit of Part #) to duplicate your shutter and alignment notches.

** For appropriate labeling on a device, please specify voltage, phasing, and product type.