

# MULTIPIN PXN12c

## PRODUCT FEATURES



### Metal Casing

Provides excellent durability and protection.

### IP65/IP66 Watertightness

Environmental rating is achieved as soon as the plug is latched to the receptacle. There is no additional rings to tighten.

### Lid

Provides additional protection from harsh environments.

### Recessed Contacts

Provides IP2X protection from live electrical parts.

### Locking Provision

Turn triangular screw with special tool (provided) to prevent plug removal.

### Spring-Loaded Butt-Style Contacts

Ensures optimal contact force and superior electrical performance over thousands of operations.

### Silver-Nickel Contacts

Silver-nickel contact material provides superior conductivity, durability and corrosion resistance.

## Hazardous Location Listings

ATEX		
II 2 G D	Ex e IIC Gb	Ex tb IIIC Db
Suitable for Zone 1 & 2 (gas) 21 & 22 (dust)		
-40°C ≤ Ta ≤ +55°C	T5	T69°C
Ex ia or ib IIC T6 Gb		
IECEX LCIE 14.0041X/LCIE 07 ATEX 6070X		

### Highlighted Feature

- Crimped Contacts**  
 PXN12c devices now feature contacts that can be crimped or soldered. Each device is supplied with 13 contacts so that the product can be set up to suit application needs.

## Simple Assembly and Disassembly

DSN37c shown

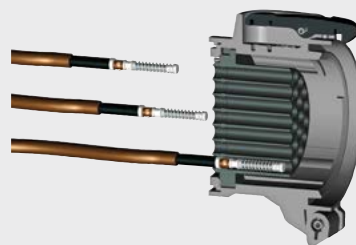

### Assembly

To insert contacts when they have been wired is simple. Push wired contact into rear of insulator until it stops to complete the installation.

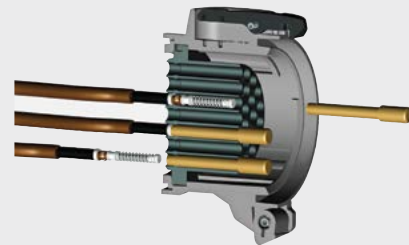

### Disassembly

To remove, use the tool provided. Push tool from front onto contact until tool stops. Contact is then released at rear of insulator.

# PXN12c Hazardous Location Multipin – 10 A

Devices rated for hazardous locations are not returnable.

### Ratings

- **Voltage**  
220 VAC or VDC
- **Amperage Ratings**  
10 A Not for disconnection of a live circuit
- **Environmental Ratings**  
IP65/IP66
- **Temperature Range**  
Min -40°F/Max 131°F  
See pg 258 for temps below -15°F.
- **Wiring Capacity**  
Min 16 AWG Max 14 AWG  
\* Based on THHN wiring connection type solder
- **Terminal Type**  
Solder/Crimp
- **Applicable Standards**  
ATEX, IECEx

### Connector (female recept w/handle)



or

### Receptacle/Angle (female)



or

### Recept/Angle/Box (female)



Voltage	Polarity	Cable Range	Part # Metal	Part # Metal	Part # Metal
220V	11P+G	.35 - .63"	06-A3001-25M	06-A7001	06-A0001-25M
220V	11P+G	.47 - .82"	06-A3001	06-A7001	06-A0001

### Plug (male inlet w/handle)



or

### Inlet/Angle (male)



or

### Inlet/Angle/Box (male)



Voltage	Polarity	Cable Range	Part # Metal	Part # Metal	Part # Metal
220V	11P+G	.35 - .63"	06-A1001-25M	06-A9001	06-A6001-25M
220V	11P+G	.47 - .82"	06-A1001	06-A9001	06-A6001

### ACCESSORIES

#### PROTECTIVE INLET/PLUG CAP



01-NA426

#### EUROPEAN CRIMPING TOOL



61-CA500

#### BAG OF 13 FEMALE CONTACTS



01-AA213

Includes insulation sleeves and ferrules

#### MULTI-CONTACT REMOVAL TOOL



61-CA593

#### CRIMPER TOOL (Greenlee or equal)



4CN30

#### BAG OF 13 MALE CONTACTS



01-AA113

Includes insulation sleeves and ferrules

# PXN12c DIMENSIONS – Provided in inches

Dimensions are for reference only and may change depending on accessories used. For precise dimensions contact MELTRIC Engineering.

### Plug

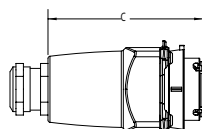
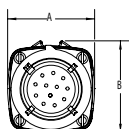

### Wall box/angle/receptacle/plug

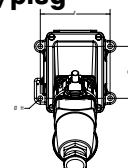
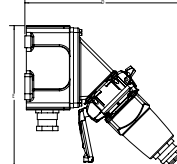

PRODUCT	A	B	C	D	E	F	G	H
PXN12c	2.3	2.42	4.09	8.37	7.54	3.7	2.76	0.26