



# Panel Interface Connectors

*Hundreds of Components and Unlimited Possibilities*

Port Adapters | Panel Mount Junction Blocks | Components | Accessories

UL File #:

**E183955**

A panel interface connector(PIC) is a device that typically mounts to the outside of a control panel housing a PLC, computer, or other type of programmable device. Once in place, the PIC, which houses convenient pass through connections, allows quick, easy, safe access to the controls inside the cabinet.

D-sub  
Connectors



Resets

Power Port



Data Highways

Communication  
Port



Housings

## Benefits of PICs

- The ability to quickly interface directly with the contents of the cabinet without opening the main cabinet door
- Easily match the communication system of programmable components, with thousands of component options
- Avoid potential safety hazards, such as Arc Flash, associated with opening a panel under load

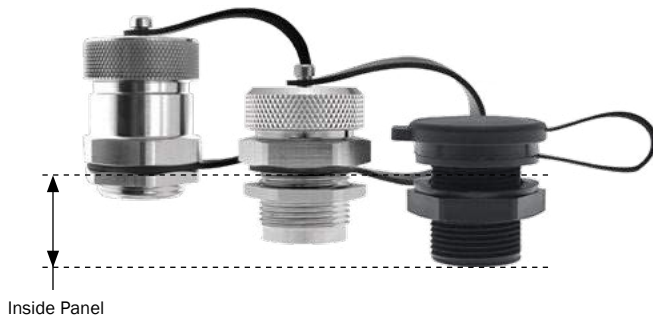

Low Profile Versions



**Front**

120V GFCI Receptacle

**Back**

120V Simplex Receptacle



# Panel Interface Connectors

## Panel Interface Connectors Part Number Matrix

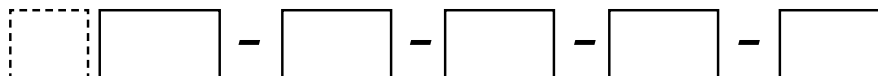

### Prefix

Blank	=	N/A
DH	=	Data Highway
LP1	=	Low Profile Housing with Single Cover
LP2	=	Low Profile Housing with Two Single Covers
LP3	=	Low Profile Housing with Double Cover

### Power Ports

#### 120V/250V

D	=	No Power Receptacle
DP	=	120V Duplex Receptacle
DP1	=	120V Simplex Receptacle
DPT	=	120V "Twist Lock" Duplex Receptacle
DPIG	=	120V Isolated Ground Duplex Receptacle
GF	=	120V GFCI Receptacle
DEC	=	250V/15A Female Receptacle
DMC	=	250V/15A Male Receptacle

#### International

EP	=	Continental European Receptacle
DIN	=	India Receptacle
DUK	=	United Kingdom Receptacle
DAS	=	Australian Receptacle
DCH1	=	China 10 AMP
DCH2	=	China 16 AMP
FR	=	French Receptacle

### D-Sub Connectors

#### 9 Pin

DB9	=	9 Pin D-Sub Female Ext/Male Interior
DB9M	=	9 Pin D-Sub Male Ext/Male Interior
MDB9	=	9 Pin D-Sub Male Ext/Female Interior
DB9F	=	9 Pin D-Sub Female Ext/Female Interior

#### 15 Pin

DB15	=	15 Pin D-Sub Female Ext/Male Interior
DB15M	=	15 Pin D-Sub Male Ext/Male Interior
MDB15	=	15 Pin D-Sub Male Ext/Female Interior
DB15F	=	15 Pin D-Sub Female Ext/Female Interior
DDB15	=	Hi-Density 15 Pin D-Sub Female Ext/Male Interior
DDB15M	=	Hi-Density 15 Pin D-Sub Male Ext/Male Interior
MDDb15	=	Hi-Density 15 Pin D-Sub Male Ext/Female Interior
DDB15F	=	Hi-Density 15 Pin D-Sub Female Ext/Interior

#### 25 Pin

DB25	=	25 Pin D-Sub Female Ext/Male Interior
DB25M	=	25 Pin D-Sub Male Ext/Male Interior
MDB25	=	25 Pin D-Sub Male Ext/Female Interior
DB25F	=	25 Pin D-Sub Female Ext/Female Interior

#### 37 Pin

DB37	=	37 Pin D-Sub Female Ext/Male Interior
DB37M	=	37 Pin D-Sub Male Ext/Male Interior
MDB37	=	37 Pin D-Sub Male Ext/Female Interior
DB37F	=	37 Pin D-Sub Female Ext/Female Interior

#### D-Sub to Screw Terminal Block

DB9-PC9	=	9 Pin D-Sub Female to a Discrete Wire Pluggable Screw Terminal Block
DB25-PC25	=	25 Pin D-Sub Female to a Discrete Wire Pluggable Screw Terminal Block

### Housings

06(LS)	=	Size 6 Bulkhead Housing
10(LS)	=	Size 10 Bulkhead Housing
16(LS)	=	Size 16 Bulkhead Housing
24(LS)	=	Size 24 Bulkhead Housing
32(LS)	=	Size 32 Bulkhead Housing
48(LS)	=	Size 48 Bulkhead Housing
P32(LS)	=	Size 32 Surface Mount Housing

### Resets

NR (Blank)	=	No Reset
R	=	3 AMP Reset
5R	=	5 AMP Reset
10R	=	10 AMP Reset
15R	=	15 AMP Reset

### Communication Ports

#### Ethernet

RJ45	=	Ethernet Female/Female
RJ11/12	=	Standard Phone Female/Female
RJ22	=	Handset Jack Female/Female

#### Radio-Frequency

BNC	=	BNC Female/Female
CX	=	Coaxial Female/Female

#### Mini-Din

8M	=	8 Pin Mini-DIN Female/Female
6M	=	6 Pin Mini-DIN Female/Female

#### USB

USB	=	2 USB 3.0 Form A to USB 3.0 Form A Female/Female
USB-*	=	Female Form A to Male Form A Cable by the Foot
USB-AFAF	=	Single USB 3.0 Form A Female to USB 3.0 Form A Female
USB-AFBF	=	Single Form A Female to Form B Female
USB-BFBF	=	Single Form B Female to Form B Female
USB-BFAF	=	Single Form B Female to Form A Female

\* Length in feet.

#### Others

FOPT	=	Fiber Optic
HDMI	=	High-Definition Multimedia Interface



Clear Cover | Seamless Low Profile Design | Solid Construction | IP66 Rating



### Profile Comparison

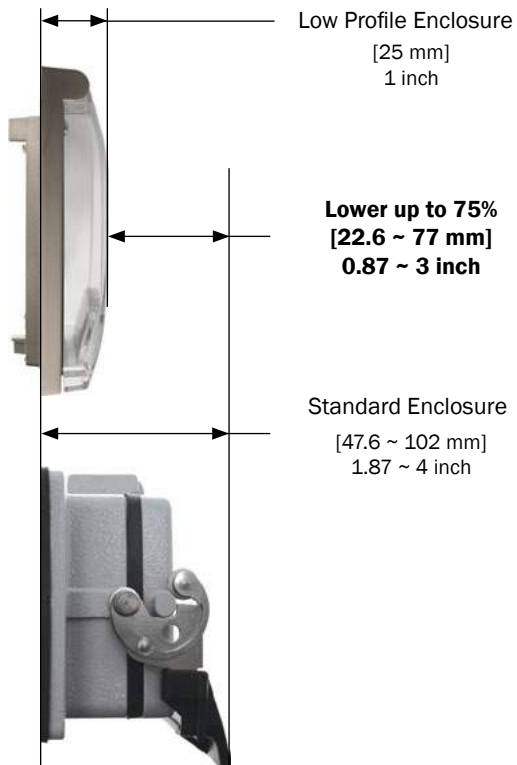

### Latch & Lock Mechanism

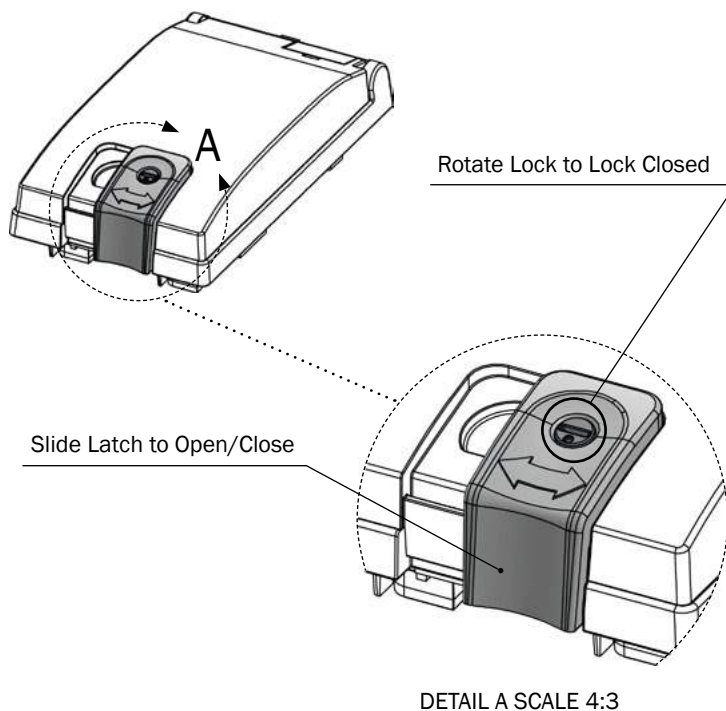



# Panel Interface Connectors

Low Profile PIC Housings



Clear Cover | Seamless Low Profile Design | Solid Construction | IP66 Rating

Code	Description	Screw Size	Torque	Dimension	Panel Cut-Out		
					A1	A2	R
LP1	Single Cover	M3	0.9 N-m (0.675 Lb-Ft)		52mm 2.05"	91mm 3.58"	2.0mm 0.08"
LP2	Two Single Covers	M3	0.9 N-m (0.675 Lb-Ft)		117mm 4.61"	91mm 3.58"	2.0mm 0.08"
LP3	Double Cover	M3	0.9 N-m (0.675 Lb-Ft)		117mm 4.61"	91mm 3.58"	2.0mm 0.08"

## Specifications:

Body: Nickel Plated Zinc  
 Front Cover: Polycarbonate  
 Latch & Lock: PBT  
 Back Cover: Polypropylene  
 Panel Thickness: 5.0mm max  
 Gasket: Nitrile/UL70

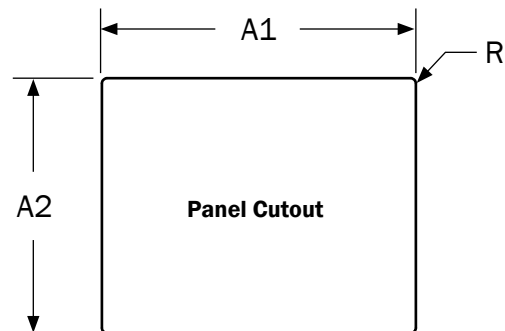



Code	Description	Screw Size	Torque	Dimension	Panel Cut-Out				
					A1	A2	B1	B2	D
06LS	Size 6 Bulkhead Housing	M4	0.8 ~ 1.2 Nm (0.6 ~ 0.9 Lb-Ft)		52mm 2.05"	35mm 1.38"	70mm 2.76"	32mm 1.26"	4.5mm .177"
10LS	Size 10 Bulkhead Housing	M4	0.8 ~ 1.2 Nm (0.6 ~ 0.9 Lb-Ft)		67.1mm 2.64"	37.1mm 1.46"	83.1mm 3.27"	32mm 1.26"	4.5mm .177"
16LS	Size 16 Bulkhead Housing	M4	0.8 ~ 1.2 Nm (0.6 ~ 0.9 Lb-Ft)		86mm 3.39"	35mm 1.38"	86mm 3.39"	32mm 1.26"	4.5mm .177"
24LS	Size 24 Bulkhead Housing	M4	0.8 ~ 1.2 Nm (0.6 ~ 0.9 Lb-Ft)		112mm 4.41"	35mm 1.38"	130mm 5.12"	32mm 1.26"	4.5mm .177"
32LS	Size 32 Bulkhead Housing	M4	1.2 ~ 1.8 Nm (0.9 ~ 1.3 Lb-Ft)		88mm 3.46"	76mm 2.99"	110mm 4.33"	65mm 2.56"	4.5mm .177"
48LS	Size 48 Bulkhead Housing	M6	3.0 ~ 3.6 Nm (2.2 ~ 2.7 Lb-Ft)		125mm 4.92"	81mm 3.19"	148mm 5.83"	70mm 2.76"	.256"

Aggressive environment housings available, contact the factory.

Panel Cutout

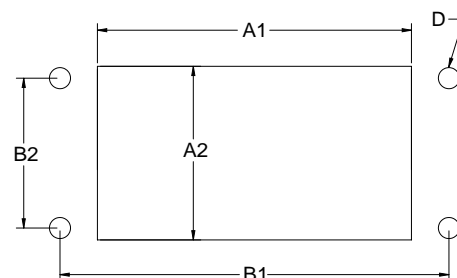



# Panel Interface Connectors

PIC Housings



Other Housings | IP66 Rating

Code	Description	Dimension
DFD	Size 24 housing for mounting floppy drives and zip drives.	
P32	Fully enclosed size 32 surface mount housing to allow unit to mount away from the control cabinet	
TS	For easy mounting inside the cabinet on DIN rails. This non-watertight version will only accommodate the size 6, 10, 16 and 24 versions.	