

**T-COUPLER SLIMLINE M12 MALE / 2X M12 FEMALE**

T-coupler (Slim Line)

Male straight – females straight

M12 – M12

5-pole

Distribution function (NO)

Plastic housings with good resistance against chemicals and oils.

The resistance to aggressive media should be individually tested for your application. Further details on request.

**Illustration**

Product may differ from Image

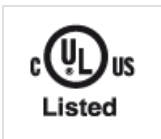
**Approvals****Form**

Form 41131

**General data**

Temperature range -25...+85 °C

**Technical Data**

Operating voltage max. 60 V AC/DC

Operating voltage (only UL listed) 30 V AC/DC

Rated surge voltage 1.5 kV

Operating current per contact max. 4 A

Locking of ports Screw thread (M12×1 mm) recommended torque 0.6 Nm, self-securing

Protection IP67 inserted and tightened (EN 60529)

**Commercial data**

country of origin DE

customs tariff number 85366990

EAN 4048879144865

eClass 27143423

Packaging unit 1

**Sketch**

*stay connected*

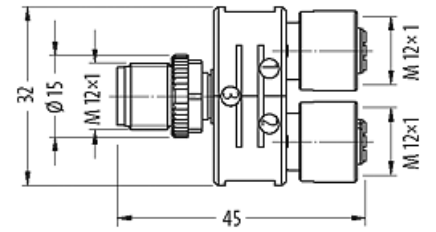
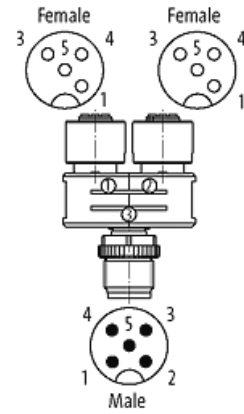

1. Female M12 2. Female

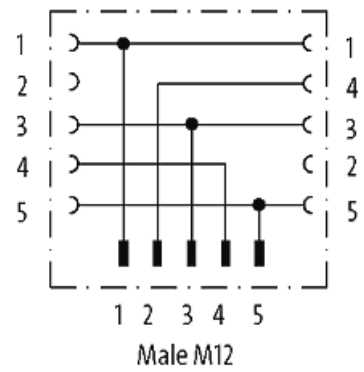

Product may differ from Image