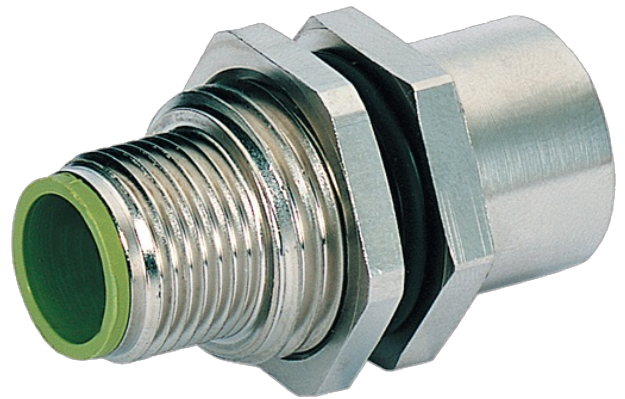

M12 BULKHEAD FLANGE PLUGS 5 POLE A CODED V2A

Control cabinet entry system
 Male - female
 M12, 5-pole
 A-coded
 shielded
 Stainless steel 1.4305 (V2A)

[Link to Product](#)**Illustration**

Product may differ from Image

Form

Form 42111

General data

Mounting set M16×1.5 mm
 Temperature range -25...+85 °C

Technical Data

Operating voltage max. 60 V AC/DC
 Operating current per contact max. 4 A
 Locking of ports Screw thread (M12×1 mm) recommended torque 0.6 Nm, self-securing
 Protection IP65, IP66K, IP67, IP68, IP69K inserted and tightened (EN 60529)
 Material Stainless steel 1.4305 (V2A)

Commercial data

country of origin CZ
 customs tariff number 85366990
 EAN 4048879314435
 eClass 27279220
 Packaging unit 1

Sketch

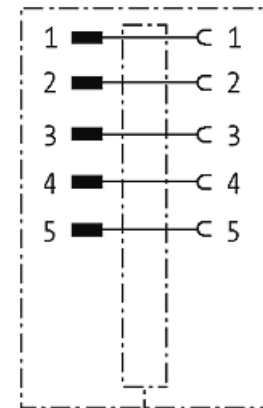
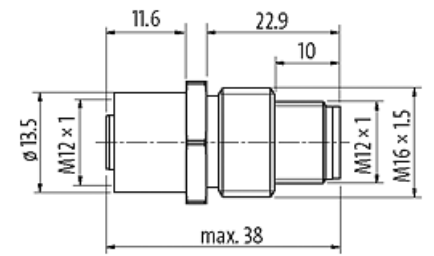
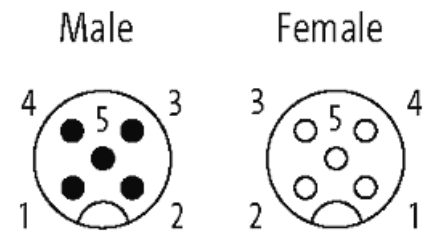

Product may differ from Image