

THIS COPY IS PROVIDED ON A RESTRICTED BASIS AND IS NOT TO BE USED IN ANY WAY DETRIMENTAL TO THE INTERESTS OF PANDUIT CORP.

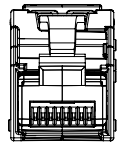

.54
[13.6]

WITHOUT PROTECTIVE CAP

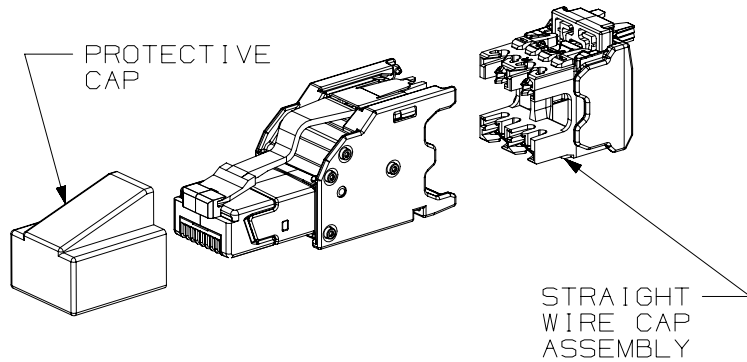
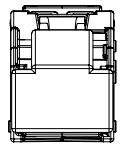

.54
[13.6]

WITH PROTECTIVE CAP

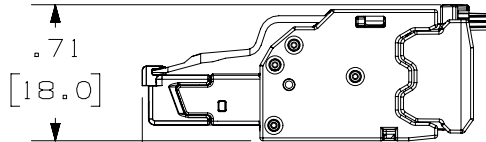

.71
[18.0]

1.83
[46.4]

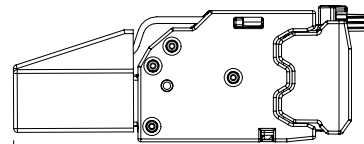

1.86
[47.3]

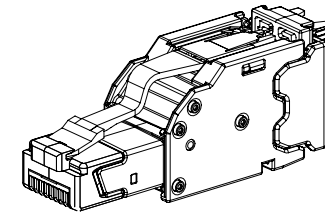

ACTUAL SIZE

NOTES:

1. VISIT OUR ON-LINE CATALOG AT WWW.PANDUIT.COM FOR A LIST OF CURRENT PARTS APPLICABLE FOR USE WITH THIS PRODUCT.
2. DIMENSIONS IN [] ARE METRIC.
3. ALL MATERIALS AND COMPONENTS USED MEET THE MATERIAL RESTRICTIONS OF RoHS (EUROPEAN DIRECTIVE 2011/65/EU ON THE RESTRICTION OF HAZARDOUS SUBSTANCES) AS PROPOSED BY THE RoHS TECHNICAL ADAPTATION COMMITTEE.
4. WEIGHT: 3.42LBS/ 100 PCS (1.55kg/ 100 PCS).
5. PART INCLUDES:
PLUG ENCLOSURE: POLYCARBONATE W/ UL94V-0 FLAME RATING
Ni-PLATED ZINC ALLOY
CONTACTS & IDCs: PHOSPHOR BRONZE
6. MEETS OR EXCEEDS PROPOSED TIA CATEGORY 6A, 6, AND 5E MODULAR PLUG TERMINATED LINK REQUIREMENTS WITH UP TO TWO FIELD TERMINABLE PLUGS IN LINK.
7. TERMINATES 22-26AWG SOLID OR STRANDED STP CABLE.
8. SEE INSTALLATION INSTRUCTIONS FOR PROPER TERMINATION METHODS.
9. OPERATIONAL TEMPERATURE: -40°F TO +185°F (-40°C TO +85°C)
10. STORAGE TEMPERATURE: -40°F TO +185°F (-40°C TO +85°C)
11. 8 POSITION, 8 WIRE STP RJ45 PLUG W/STRAIGHT WIRE CAP ASSEMBLY, WIRE CAP LABEL IS CODED FOR T568A & T568B WIRING SCHEMES.
12. REPLACEMENT WIRE CAP PART NUMBERS:
1. STRAIGHT WIRE CAP ASSEMBLY: CPSCAPBL-X

PART NUMBER		FPS6X88MTG		
TITLE		TX6A FIELD TERMINABLE STP RJ45 PLUG W/STRAIGHT WIRE CAP ASSEMBLY		
ITEM REVISION NAME		CUSTOMER DRAWING		
DATASET FILE NAME		00067EAA/01		
MATERIAL		SEE NOTE 5		
DRAWING NUMBER		00067EAA-DC		
THIRD ANGLE PROJECTION				
DRAWN BY		DATE		SCALE
BJN		10-10-18		FULL
SHEET 1 OF 1		A		

REV	DATE	BY	CHK	APR	DESCRIPTION	ECN
01A	12-6-18	BJN	KZU	TMBA	UPDATED	00067EAA-DC
00A	10-10-18	BJN	KZU	TMBA	RELEASED TO PRODUCTION	00067EAA-DC