

# PHE-3FB3



- Signal tower features 3 LED colors and 2 flashing patterns
- Send ASCII commands over USB or RS-232C to control built-in signal tower
- Receive power over USB or a 24V DC supply source
- 4 built-in alarm sounds with adjustable volume up to 80 dB
- Built-in "Clear" button for quickly reverting the PHC to "default state" once an alert is confirmed



\* N Type only

\* N Type only

## Specifications

|                               |   |   |
|-------------------------------|---|---|
| Model                         | PHE-3FB3-RYG / PHE-3FB3N-RYG (AC adaptor not included)  |   |
| Rated Voltage                 | Main Unit   | 24V DC, 5V DC (USB bus power)                                     |
|                               | AC Adaptor  | Input: 100-240V AC (50/60Hz), Output: 24V DC                      |
| Operating Voltage Range       | 90 - 264V AC (When using AC adaptor)  |   |
| Rated Power Consumption       | Standby mode  | 1.2W (at 100V AC)   |
|                               | Operating at Maximum  | 4.4W (at 100V AC)   |
| Ambient Operating Temperature | 0-40 degree (Celsius)   |   |
| Ambient Operating Humidity    | 20%-85% RH (no condensation)  |   |
| Mounting location / direction | Indoors, Upright  |   |
| Protection Rating             | IP20  |   |
| Mass                          | 545g (not including adaptor)  |   |
| Interface                     | USB port  | Conforms to USB 2.0 (bus power support), Standard B type (female) |
|                               | Serial port   | Conforms to RS-232C, D-Sub 9-pin (male)                           |
| Signal Tower *                | Red, Amber, Green, Clear Lens   |   |
| Audible sound pressure        | 80dB or more (at a distance of 1m, in front of Main Unit)   |   |
| Accessory                     | AC adaptor (except N type), installation manual, rubber feet  |   |
| Supported operating systems   | Windows®7 (32bit, 64bit), Windows®8 (32bit, 64bit), Windows®8.1 (32bit, 64bit), Windows®10 (32bit, 64bit), Windows Server® 2008 R2, Windows Server® 2012, Windows Server® 2012 R2 |   |

\* When operating on USB bus power, signal light is not as bright.

## Dimensions (mm)

### ■ PHE-3FB3

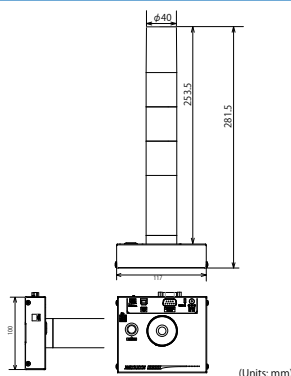

### ■ AC adaptor enclosed (except N type)

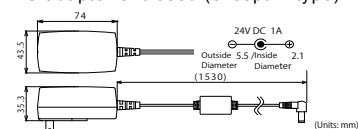

### ■ Wiring for RS-232C port

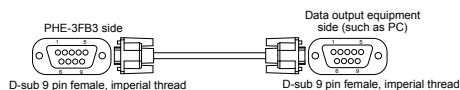

| Signal name | Pin number | Pin number | Signal name |
|-------------|------------|------------|-------------|
| TXD         | 2          | 2          | RXD         |
| RXD         | 3          | 3          | TXD         |
| GND         | 5          | 5          | GND         |
| CTS         | 7          | 7          | RTS         |
| RTS         | 8          | 8          | CTS         |

\* RS-232C straight cable is not included in this product. Please provide your own.

## Model Code

# PHE-3FB3□-RYG

AC Adaptor

Blank: AC adaptor included

N: AC adaptor not included

## Adjusting Buzzer Volume

- Using enclosed Sound Reduction sheet  
Please attach the Sound Reduction sheet on top of the Buzzer Unit.

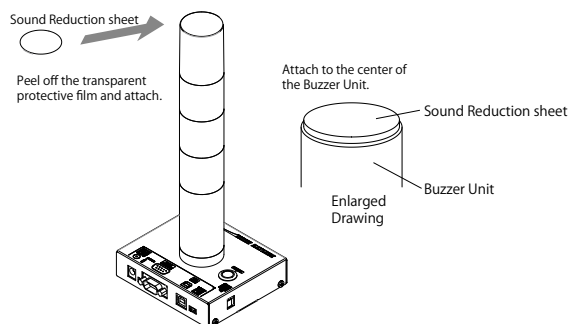

- Using the DIP switch in the Buzzer Unit  
As shown below, please turn on the DIP switch 1 and 3 in order to reduce sound volume.

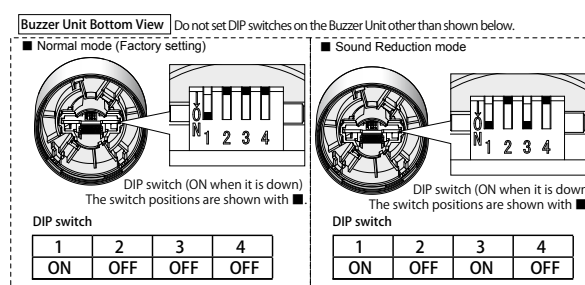

## Optional Parts

Dimmer Film  
NHP-TF (for NHP-FV2/FB2/PHE-3FB3)

