

# Standard Barrel - Two Hole Tongue

## Type BLUA-D

- Manufactured from seamless aluminum tubing
- Tin-plated and factory prefilled with oxide inhibitor compound
- Beveled entry for easy cable insertion
- Color coding conforms to industry standards ensuring proper die selection and providing for a faster installation
- Connectors are marked with catalog number, wire size, die index and crimp locations
- Connectors are suitable for voltages up to 35 KV
- End caps provided to prevent foreign materials from entering and contaminating the connector prior to usage
- Connectors are UL listed and CSA certified with Penn-Union, Burndy, T&B, Huskie and Greenlee tooling

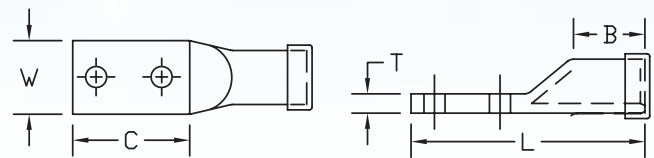

### BLUA-D DIMENSIONS & INSTALLATION TOOLING INFORMATION

CATALOG NUMBER	ALUMINUM & COPPER CONDUCTOR SIZE	STUD HOLE SIZE	FIGURE DIMENSIONS (IN.)							COLOR CODE	INSTALLATION TOOLING					
			STUD HOLE SPACING	TONGUE WIDTH "W"	TONGUE LENGTH "C"	TONGUE THICKNESS "T"	BARREL LENGTH "B"	OVERALL LENGTH "L"	PENN-UNION DIELESS MECHANICAL TOOLS		BURNDY DIE INDEX NO.	PENN-UNION DIE CATALOG NO.	WIRE STRIP LENGTH			
BLUA-1D1	1 AWG	1/2"	1.75	.82	2.90	.26	.90	4.04	Gold	TDM-250 or TDM-500	471	T-471	1-1/16"			
BLUA-1/0D1	1/0 AWG	3/8"	1.00	.85	1.87	.23	1.00	3.53	Tan		296	T-296	1-1/8"			
BLUA-1/0D2		3/8"	1.06	.85	2.18	.23	1.00	3.84			297	T-297	1-1/4"			
BLUA-1/0D3		1/2"	1.75	.84	3.00	.24	1.00	4.57			467	T-467	1-3/8"			
BLUA-2/0D2	2/0 AWG	3/8"	1.00	.93	1.87	.25	1.09	3.37	Olive		298	T-298	1-7/16"			
BLUA-2/0D		1/2"	1.75	.94	3.18	.25	1.09	4.62			324	T-324	1-9/16"			
BLUA-3/0D1	3/0 AWG	3/8"	1.00	1.03	1.87	.26	1.25	3.90	Ruby		TDM-500	470	T-470	1-5/8"		
BLUA-3/0D		1/2"	1.75	1.03	2.97	.26	1.25	4.66				299	T-299	1-3/4"		
BLUA-4/0D2	4/0 AWG	3/8"	1.00	1.17	2.06	.29	1.31	3.87	White			472	T-472	2"		
BLUA-4/0D		1/2"	1.75	1.16	2.94	.30	1.29	4.73				300	T-300	2-1/16"		
BLUA-025D1	250 kcmil	3/8"	1.00	1.26	2.06	.32	1.40	4.00	Red	TDM-500		473	T-473	2-1/8"		
BLUA-025D		1/2"	1.75	1.25	2.91	.33	1.79	5.20				301	T-301P	2-3/8"		
BLUA-030D1	300 kcmil	3/8"	1.00	1.39	2.37	.35	1.50	4.46	Blue			474	T-474P	2-7/16"		
BLUA-030D		1/2"	1.75	1.38	3.00	.36	1.47	5.34				303*	-	2-9/16"		
BLUA-035D1	350 kcmil	3/8"	1.00	1.48	2.06	.39	1.63	4.44	Brown			TDM-500	302	T-302P	2-11/16"	
BLUA-035D		1/2"	1.75	1.48	2.94	.39	1.59	5.31					302	T-302P	2-11/16"	
BLUA-040D1	400 kcmil	3/8"	1.00	1.62	2.06	.42	1.81	4.56	Green		TDM-500		302	T-302P	2-11/16"	
BLUA-040D2		1/2"	1.75	1.62	3.12	.42	1.81	5.62					302	T-302P	2-11/16"	
BLUA-040D	5/8"	1.75	1.62	3.09	.42	1.81	5.59	Pink	TDM-500				302	T-302P	2-11/16"	
BLUA-050D1	500 kcmil	3/8"	1.00	1.79	2.06	.46	1.87						4.87	302	T-302P	2-11/16"
BLUA-050D2		1/2"	1.75	1.79	3.13	.46	1.88	5.94		302			T-302P	2-11/16"		
BLUA-050D	5/8"	1.75	1.80	3.22	.47	1.87	6.03	Black		TDM-500			302	T-302P	2-11/16"	
BLUA-060D1	600 kcmil	3/8"	1.00	1.96	2.06	.51	2.00						5.18	302	T-302P	2-11/16"
BLUA-060D2		1/2"	1.75	1.97	3.13	.52	2.00	6.25					302	T-302P	2-11/16"	
BLUA-060D	5/8"	1.75	1.96	3.21	.51	2.00	6.34	Red				TDM-500	302	T-302P	2-11/16"	
BLUA-075D1	750 kcmil	1/2"	1.75	2.14	3.12	.57	2.25						6.31	302	T-302P	2-11/16"
BLUA-075D		5/8"	1.75	2.14	3.21	.57	2.25	6.40			302		T-302P	2-11/16"		
BLUA-080D1	800 kcmil	1/2"	1.75	2.37	3.21	.62	2.31	7.12			Gray		TDM-500	302	T-302P	2-11/16"
BLUA-080D		5/8"	1.75	2.37	3.21	.62	2.31	7.12	302					T-302P	2-11/16"	
BLUA-090D+	900 kcmil AL 600 kcmil CU	3/8"	1.00	2.14	2.00	.37	2.46	5.96	Gray		TDM-500			302	T-302P	2-11/16"
BLUA-100D2	1000 kcmil	1/2"	1.75	2.50	3.13	.66	2.56	7.34	Brown					TDM-500	302	T-302P
BLUA-100D		5/8"	1.75	2.50	3.21	.65	2.56	7.43		302					T-302P	2-11/16"

+ The following dieless compression tools are approved to be used on 600-900 kcmil aluminum and 600 kcmil copper: TPU-6FT, TFU-6FTB, TPU-6FTH, HDT-1000 and HDT-1000B

\* The Burndy 303 die is for use with 900 kcmil aluminum only

- Connectors from 8 AWG - 1000 kcmil are UL listed per UL486A-B and CSA certified per C22.2 No.65 for POWER applications