



### Model Number

#### V31-GM-Q4

Female connector, M8, 4-pin, field attachable

### Features

- Insulation displacement connection

### Accessories

**MH V3-SCREWDRIVER**  
torque screwdriver (0.2 Nm)

**MH V3-BIT M8**  
plug-in cap for M8

### Dimensions

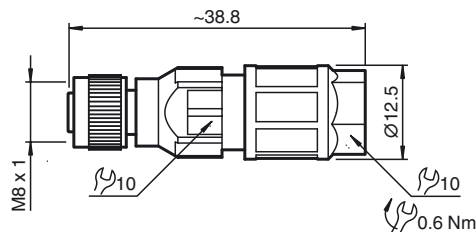

### Technical data

#### General specifications

Number of pins	4
Connection 1	socket
Construction type 1	straight
Threading 1	M8
UL File Number	E191152

#### Electrical specifications

Operating voltage	$U_B$	max. 30 V AC/DC
Operating current	$I_B$	max. 4 A
Volume resistance		< 5 mΩ

#### Ambient conditions

Ambient temperature	-25 ... 80 °C (-13 ... 176 °F)
Pollution degree	3

#### Mechanical specifications

Degree of protection	IP65/IP67
Connection	1 x M8 socket, straight Insulation displacement connection for 0.25 ... 0.5 mm <sup>2</sup>
Material	
Contacts	CuSn
Contact surface	Ni/Au
Body	PA 6
Slotted nut	Zinc die-casting, nickel-plated
Seal	NBR
Core insulation	PVC/PE/PP
Cable	
Sheath diameter	2.5 ... 5 mm ± 0.2 mm

#### Compliance with standards and directives

Standard conformity	
Degree of protection	EN 60529:2000
Standards	IEC 61076-2-104:2008

#### Approvals and certificates

UL approval	UL Recognized
Maximum permissible operating voltage	≤ 29 V

### Electrical connection

