

# Direct Drive Fan Single & Double Shaft 5.0" Diameter, Open Air Over

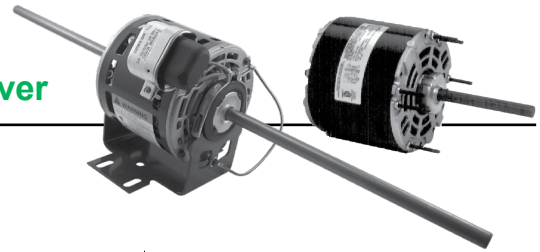

## APPLICATIONS:

Designed to meet manufacturer's requirements for direct drive fans and blowers.

## FEATURES:

- Bearings Have All Angle Thrust System
- Continuous Duty, Air Over
- 24" Line Leads Unless Otherwise Noted
- Automatic Reset Thermal Overload Protector
- Connection Information Furnished in the Nameplate Data
- Shaded Pole Design Except Where Noted
- **Discount Symbol: DS-3FMP (Stud or Hub Ring Mount)**
- **Discount Symbol: DS-3HAC (Resilient Base)**

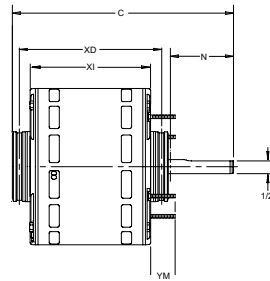

Figure A

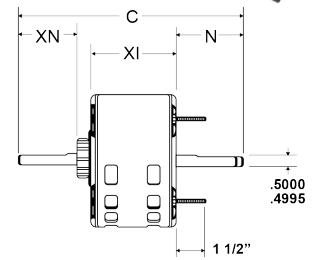

Figure B

## 5.0" Diameter, Stud or Hub Ring Mount (2.5") (Fig. A)

HP	RPM/ Spds.	Voltage	Catalog Number	Bearings	NEMA Frame	Amps	Shaft N	Base XD	Shell XI	Total C	Stud YM	Ship Wt.	Notes
1/15	1050	115	1342	Sleeve	42	2.6	2.8	N/A	3.8	6.6	0.6	10	84, H16, H19
1/10	1050	115	1336	Sleeve	42	3.7	1.8	N/A	3.8	5.7	0.6	11	84, H3, H6, H16
1/8	1050	115	1337	Sleeve	42	5.5	5	5	4.5	10.4	0.9	13	84, H3, H16
1/6	1050	115	1127P	SAB	42	3.0	4.0	4.6	4.1	9.1	N/A	8.4	84, H3, H16, H38
	1050	115	2166P	SAB	42	2.6	3.5	4.2	3.6	8.2	-	8.4	84, H16, H38
1/5	1050	115	1340	Sleeve	42	7.1	2.2	5.2	4.7	7.9	0.9	14	84, H3, H16
	1050/3	115	1338P	SAB	42	3.2	4.9	5.5	5.0	10.9	0.8	8.6	84, H3, H16, H38
1/4	1050	115	1341	Sleeve	42	8.9	2.6	5.7	5.2	8.7	0.9	15	84, H3, H16

## 5.0" Diameter, Resilient Base, Double Shaft (Fig. B)

HP	RPM/ Spds.	Voltage	Catalog Number	Bearings	Rotation LE	Amps	Shaft N	Shaft XN	Shell XI	Total C	Ship Wt.	Notes
1/20	1075/4	115	1270	Ball	CW	0.9	10.1	10.1	4.9	25.6	8.0	H38
1/15	1050/3	208-230	1261	SAB	CW	0.5	8.3	8.3	4.6	22.2	7.8	H38
	1100/3	115	1090	SAB	CW	0.8	9.9	10.8	3.8	25.4	13	
1/12	1375/3	115-120	1256	Ball	CCW	1.4	8.25	8.25	4.9	21.9	11	
1/10	1050/4	115	1182	Ball	CW	1.7	10.5	10.0	4.1	24.6	7.0	H38, H34, H6
	1050/5	115	2832	SAB	CW	2.5	10.0	10.0	4.3	24.3	14.4	H38, H34
	1050/5	115	2827P	SAB	CW	2.5	10.0	10.0	4.1	25.2	9	H34, H38
	1550/3	115	2817	SAB	CCW	3.8	8.4	8.4	4.6	22.4	8	
1/8	1550/4	115	1180*	Ball	CW	2.0	10.2	10.2	3.6	24.0	7.1	H37
	1500/3	277	1964	SAB	CCW	0.8	7.8	8.3	4.1	21.2	9	
1/6	1500/3	115	1192	Ball	CW	2.3	10.5	10.5	4.1	25.1	10	
	1625/4	115	8525	SAB	CCW	2.2	9.4	9.4	4.8	24.0	9	
	1450/3	115-120	1257	Ball	CCW	2.5	8.25	8.25	5.7	21.9	11	
1/5	1075	208-230	1124*	SAB	CW	1.3	5.7	5.7	4.1	16.5	23	H37
1/4	1550/3	230	1221P	SAB	CCW	1.6	8.0	8.0	4.3	20.9	8.4	H3, H21, H38
1/2	1075/4	115	CA3414	SAB	CCW	7.9	4.1	7.6	5.3	17.0	15	

Note 84: Non-reversible  
 Note H3: 20" Leads  
 Note H6: 3/8" Shaft  
 Note H16: Rotation CCW L.E.  
 Note H19: Conduit Box on Motor  
 Note H21: Fig. B Type, Includes Mounting Kit; Non-Reversible

Note H34: Non-Reversible; 54" Leads; Includes Resilient Base  
 Note H37: PSC, 5.0 MFD Capacitor Required  
 Note H38: PSC, Capacitor Included and Attached  
 \* Not RB  
 + No base Included