

General

Designated use:

Intended purpose:

Stationary light for metal-working machines.

Place of use:

Only for use on metal-working machines.

Operating mode:

The light is designed for continuous operation.



Safety instructions:

The light may **be operated only on metal-working machines !**

No combustible materials may be worked on the machines!



Lights of international protection class III must be operated only with safety extra-low voltage.

Do not touch the glass shade while the light is switched on and for some time afterwards - danger of burns.



A defective protection pane must be replaced - danger of injury.

Abbreviations and symbols:



Attention: Take note of the accompanying documents!



Device of protection class II (Isolation)



Device of protection class III (safety extra-low voltage)



Observe the disposal instructions!



Risk of fire!



Attention: hot surface



A defective protection pane must be replaced



VDE Approval



CE-Conformity mark



The manufacturer cannot be held liable for damage caused by using the device for purposes other than the designated use or by ignoring safety instructions and warnings.

Mounting

The light must be mounted in a stable position on an even, non-flammable surface (e.g. with the included screws).

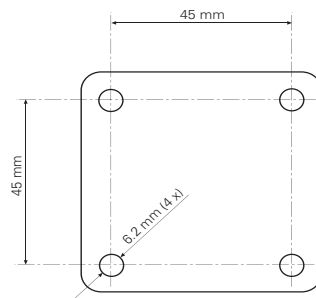

The user has to verify the reliability when using mounting elements which have been not proposed by the manufacturer.

Mains supply

The light is connected in the connection box on the base of the light (see fig. 3 on page 3).

Putting into operation

Before putting the light into operation, the user has to check whether the mains voltage is identical to the rated voltage specified on the rating plate.

Operation

For lights with built-in off-switch, the light can be turned on and off by actuating the switch lever [2.2] (see fig. 2 on page 3).

Adjusting the articulation joints

All articulation joints, except for the joint directly on the reflector casing, can be adjusted. Each joint must be adjusted so that the light is - on the one hand - easily movable and - on the other hand - remains in the position adjusted by the user.

Maintenance and repair

Disconnect the light from the mains before carrying out any maintenance or repair work! This work may only be carried out by a qualified **electrician!**

The mains cable may only be replaced by the manufacturer!

Only parts approved by the manufacturer may be used as spare parts.

Changing the lamp

Attention: Let lamp cool down!

See also fig. 4 on page 3.

- Disconnect the light from the power source.
- Turn shade [4.2] to the left and detach it (bayonet technique).
- Pull the lamp [4.4] out of the socket.
- Hold the new lamp with a clean cloth and press it in the socket.
- Turn on the shade [4.2].

Important! Please only use lamp types approved by the manufacturer.

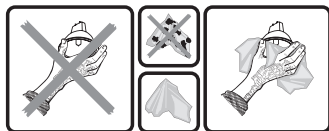

Only change the lamp using a clean cloth!

Cleaning

Note: Clean the transparent shade regularly to ensure maximum brightness.

Please use a cloth impregnated with a normal household cleaning agent to clean the lamp components.

Please ensure that the cleaning agents used are compatible with paints and plastics.

Disposal



Return the unit at the end of its service life to the available recycling systems.

Defective halogen lamps must be disposed of as special refuse.

Technical data

General

Dimensions

Light body Ø 140 x 160 mm

Classification

Protection class II or III
Protection type IP 65

Light HSW (K) 75 (230 V AC)

Protection class II
fitted with
- halogen lamp 12 V / 75 W

Light HSW (K) 75 (12 V)

Protection class III
fitted with
- halogen lamp 12 V / 75 W

Light HSW (K) 75 (24 V)

Protection class III
fitted with
- halogen lamp 24 V / 75 W

Further variants

If required, this series of units will be supplemented by further variants. The technical data may therefore be subject to modifications.



Always observe the indications and symbols given on the rating plate.